

F.A.U. RTE.	SECTION	COUNTY	TOTAL SHEETS	SHEET NO.
6713	05-00148-00-PV	TAZEWELL	74	11
STA. 145+50.00		TO STA. 156+60.00		
FED. ROAD DIST. NO. 4 ILLINOIS FED. AID PROJECT				

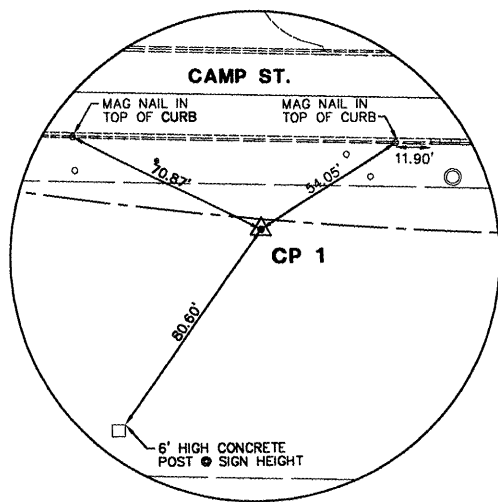

**CP 1**  
 P.I. STA. 138+92.87  
 (CAMP STREET)  
 1/2" ROD W/ CAP  
 N. 11985.47  
 E. 9242.25

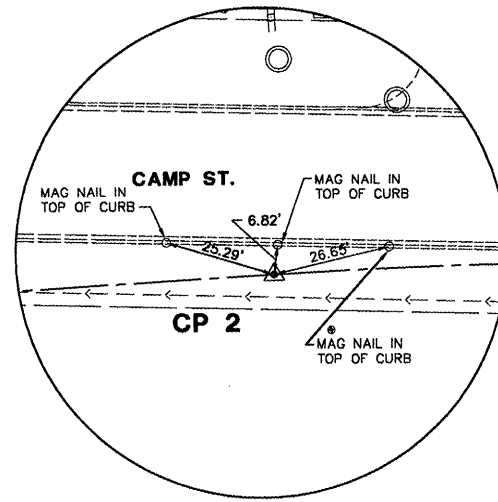

**CP 2**  
 P.C. STA. 147+03.27  
 (CAMP STREET)  
 5/8" IRON ROD  
 N. 11324.25  
 E. 9710.37

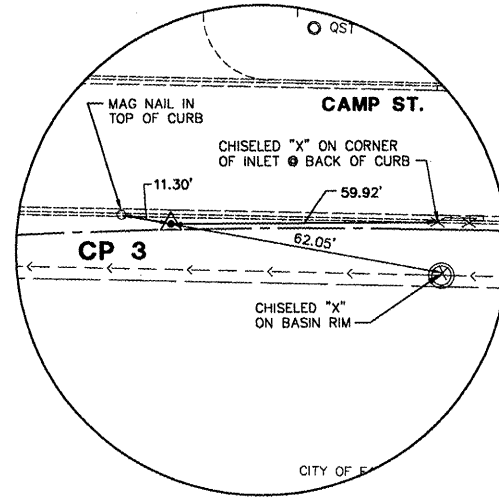

**CP 3**  
 P.I. STA. 147+65.29  
 (CAMP STREET)  
 1/2" IRON ROD W/ CAP  
 N. 11275.65  
 E. 9748.90

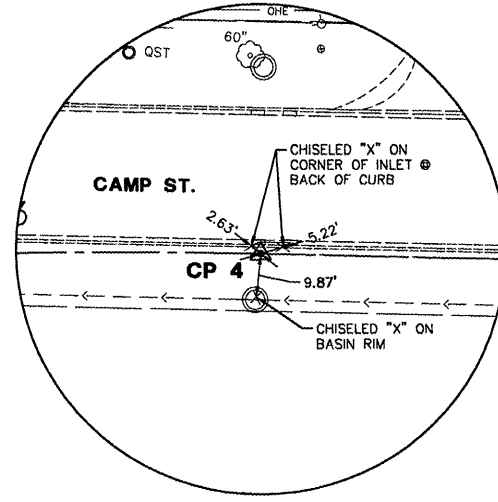

**CP 4**  
 P.T. STA. 148+27.24  
 (CAMP STREET)  
 5/8" IRON ROD  
 N. 11224.04  
 E. 9783.29

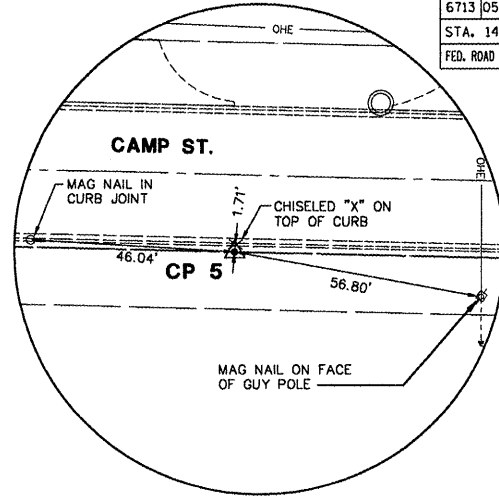

**CP 5**  
 E.O.P. STA. 152+00.00  
 (CAMP STREET)  
 5/8" IRON ROD W/ CAP  
 N. 10913.82  
 E. 9989.96

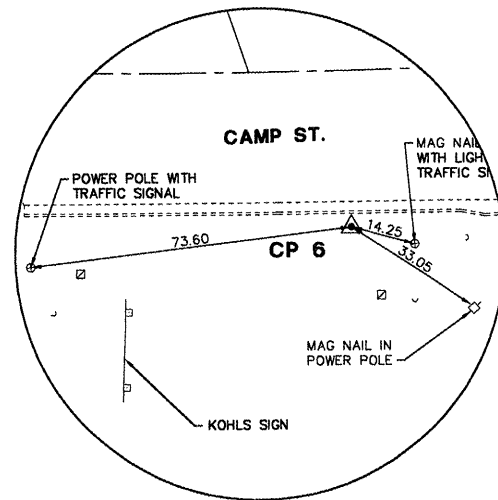

**CP 6**  
 P.C. STA. 155+06.92  
 (CAMP STREET)  
 1/2" IR WITH CAP  
 N. 10565.03  
 E. 10182.69

**BENCHMARKS**

BENCHMARK	DESCRIPTION	ELEVATION	STATION	OFFSET
BM 12	CHISELED "X" ON SANITARY MANHOLE NORTH OF UPS ENTRANCE	454.86	138+21.17	LT. 19.18'
BM 14	CHISELED "X" SANITARY SEWER MANHOLE IN CONCRETE DRIVEWAY	454.67	147+26.32	LT. 17.60'
BM 15	CHISELED "X" ON SANITARY MANHOLE LID NORTH OF NORTHMOST FAMILY FURNITURE ENTRANCE	456.18	150+30.11	LT. 19.30'

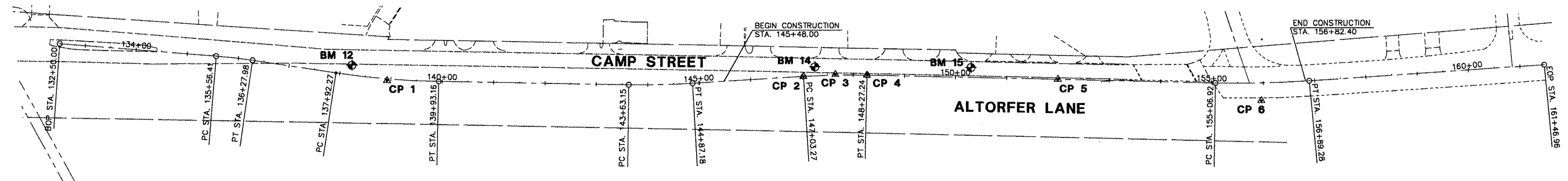
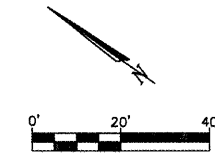

**HORIZONTAL ALIGNMENTS**

SCALE: 1" = 100'

REVISIONS	
NAME	DATE

ILLINOIS DEPARTMENT OF TRANSPORTATION  
**CAMP STREET CONNECTOR**  
 ALIGNMENT TIES AND BENCHMARKS

SCALE: VERT. 1" = 20'  
 HORIZ. 1" = 20'  
 DATE 12/22/2008

DRAWN BY JLT  
 CHECKED BY CSA

L:\8302181\DWG\TRCP1.dwg