

F.A.U. RTE.	SECTION	COUNTY	TOTAL SHEETS	SHEET NO.
6713	05-00148-00-PV	TAZEWELL	74	16
STA. 145+50.00		TO STA. 156+60.00		
FED. ROAD DIST. NO. 4		ILLINOIS		FED. AID PROJECT

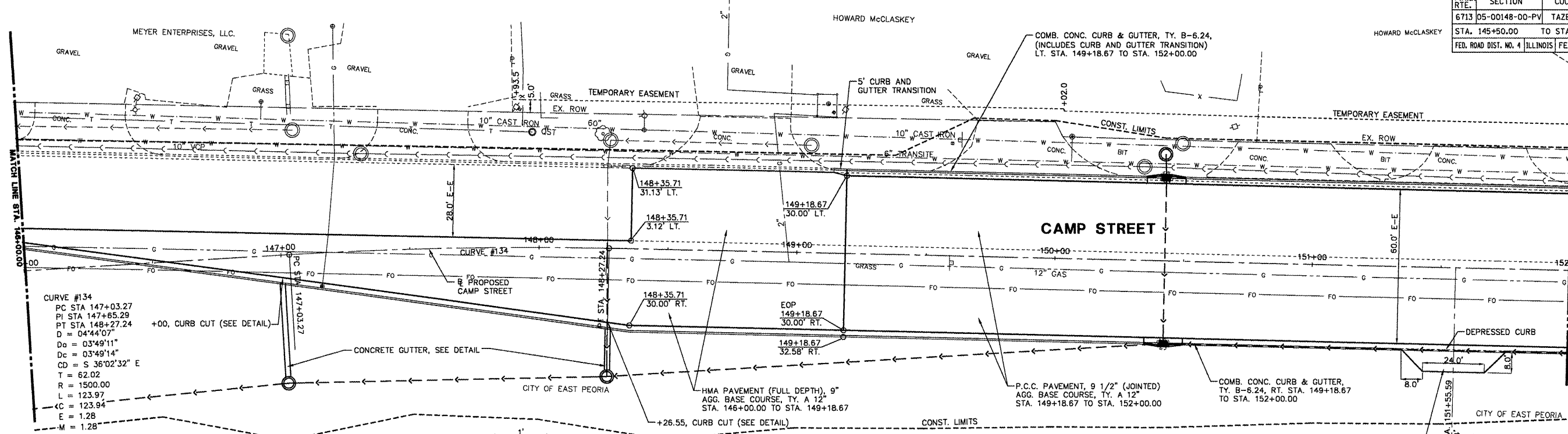

CURVE #134
 PC STA 147+03.27
 PI STA 147+85.29
 PT STA 148+27.24
 D = 04°44'07"
 D_a = 03°49'11"
 D_c = 03°49'14"
 CD = S 36°02'32" E
 T = 82.02
 R = 1500.00
 L = 123.97
 ΔC = 123.94
 E = 1.28
 M = 1.28

CURB CUT DETAIL
 SCALE: NTS

CONCRETE GUTTER DETAIL
 SCALE: NTS

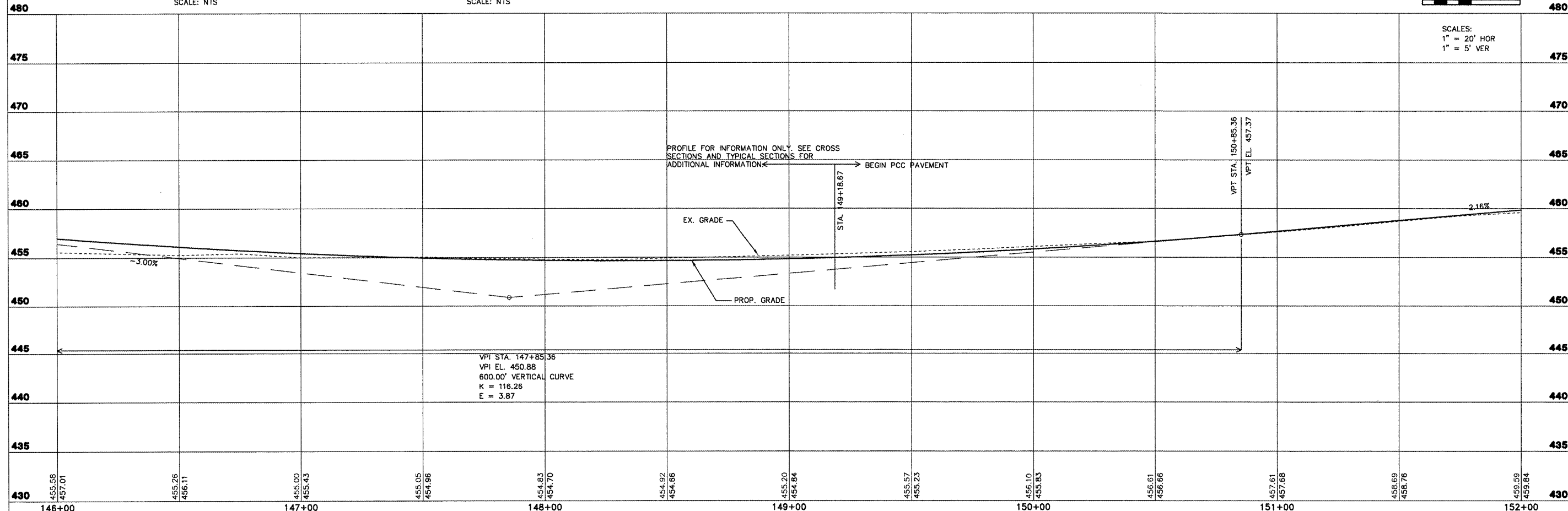
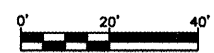

SCALES:
 1" = 20' HOR
 1" = 5' VER

CAMP STREET - PLAN AND PROFILE - STA. 146+00 TO STA. 152+00

L:\330218\LEPA\1502001.dwg