

F.A.U. RTE.	SECTION	COUNTY	TOTAL SHEETS	SHEET NO.
6713	05-00148-00-PV	TAZEWELL	74	18
STA. 145+50.00		TO STA. 156+60.00		
FED. ROAD DIST. NO. 4		ILLINOIS FED. AID PROJECT		

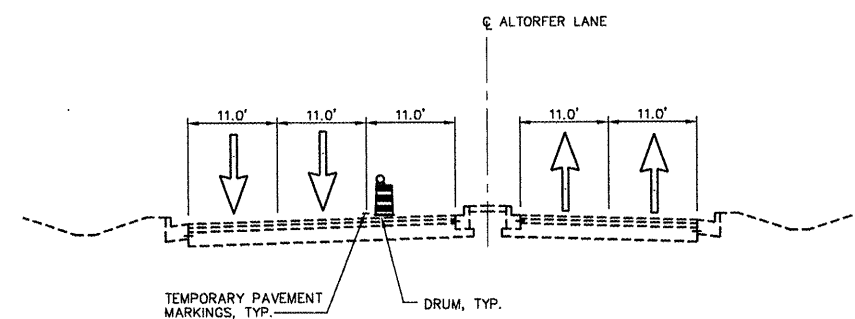

TYPICAL SECTION - ALTORFER LN.
SCALE: N.T.S.

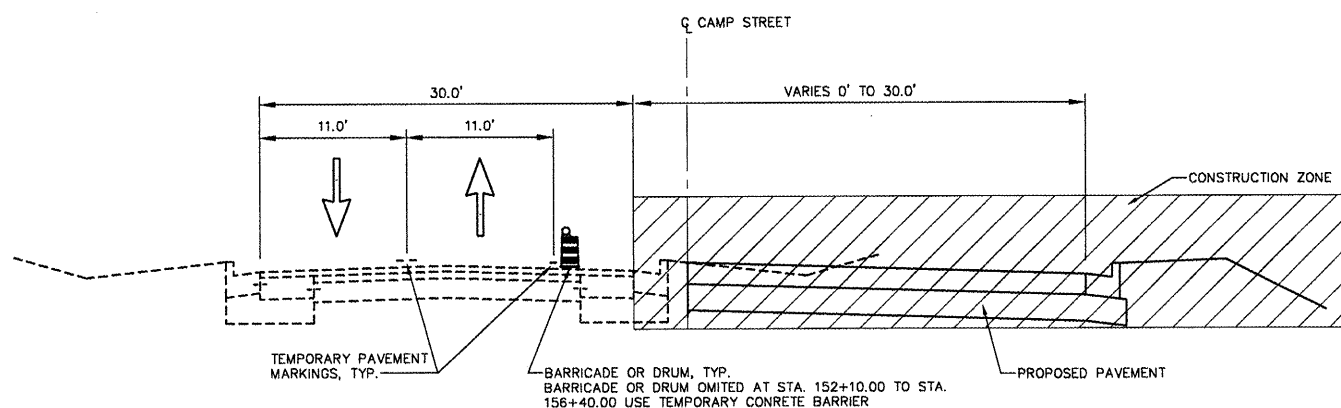

TYPICAL SECTION - CAMP ST.
SCALE: N.T.S.
STA. 145+50.00 TO STA. 154+72.84

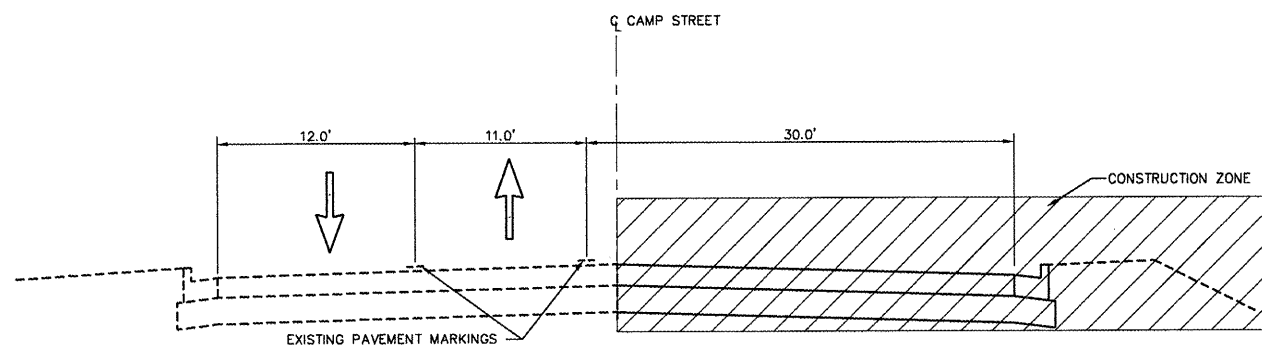

TYPICAL SECTION - CAMP ST.
SCALE: N.T.S.
STA. 154+72.84 TO STA. 156+10.00

STAGE 1

GENERAL NOTES:

ALL TRAFFIC CONTROL DEVICES INCLUDING SIGNS, CHANNELIZING DEVICES, TEMPORARY PAVEMENT MARKINGS, TRAFFIC SIGNALS, AND LIGHTING DEVICES ALONG WITH THE PLAN TO MAINTAIN TRAFFIC DURING CONSTRUCTION SHALL CONFORM TO THE APPLICABLE PORTIONS OF THE "MANUAL ON UNIFORM TRAFFIC CONTROL DEVICES FOR STREETS AND HIGHWAYS", "STANDARD SPECIFICATIONS FOR ROAD AND BRIDGE CONSTRUCTION", "STANDARD SPECIFICATIONS FOR TRAFFIC CONTROL DEVICES", "HIGHWAY STANDARDS" AND OTHER APPLICABLE IDOT MANUALS AND POLICIES.

NIGHT TIME LANE CLOSURES ARE NOT ALLOWED.

ACCESS TO ENTRANCES AND LOCAL ROADS WITHIN THE PROJECT AREA WILL BE MAINTAINED AT ALL TIMES, UNLESS OTHERWISE SPECIFIED IN TRAFFIC NOTES.

DRAINAGE TO EXISTING AND PROPOSED DRAINAGE STRUCTURES TO BE MAINTAINED AT ALL TIMES.

ALL TEMPORARY PAVEMENT MARKINGS FOR STAGES 1, 2, SUBSTAGE 2A AND SUBSTAGE 2B INCLUDING EDGE LINES, CENTER LINES, LANE LINES, TAPERS, MEDIAN DIAGONALS, STOP BARS, LETTERS & SYMBOLS, AND ANY OTHER TEMPORARY MARKINGS AS REQUIRED BY THE ENGINEER, AND THEIR REMOVAL SHALL BE INCLUDED IN THE COST OF TRAFFIC CONTROL AND PROTECTION.

THIS WORK SHALL BE PERFORMED ACCORDING TO SECTIONS 701 AND 703 OF THE STANDARD SPECIFICATIONS AND AS DIRECTED BY THE ENGINEER.

ALL TRAFFIC SIGNAL HEAD ADJUSTMENTS SHALL BE INCLUDED IN THE COST OF TRAFFIC CONTROL AND PROTECTION.

TRAFFIC NOTES:

SHIFT TRAFFIC AS SHOWN ON THE PLANS UTILIZING TEMPORARY PAVEMENT MARKINGS AND TRAFFIC CONTROL DEVICES SHOWN ON THE STAGING PLANS AND APPLICABLE TRAFFIC CONTROL STANDARDS.

MAINTAIN ONE (1) LANE OF TRAFFIC IN EACH DIRECTION WHILE MAINTAINING ACCESS TO ALL ENTRANCES AND EXITS AS SHOWN ON THE STAGING PLANS.

UTILIZE TRAFFIC CONTROL STANDARDS AS SHOWN ON THE STAGING PLANS.

CONSTRUCTION SEQUENCE OF STAGING NOTES:

INSTALL PERMANENT AND TEMPORARY DRAINAGE SYSTEMS AS SHOWN ON THE STAGING PLANS.

ONE TRAFFIC LANE MAY BE CLOSED TO CONSTRUCT THE PROPOSED INLETS AND STORM SEWER AT STA. 150+42.80 HOWEVER TWO WAY TRAFFIC SHALL BE MAINTAINED.

PLACE TEMPORARY PAVEMENT MARKINGS AS SHOWN ON THE STAGING PLANS AND REMOVE ANY CONFLICTING EXISTING PAVEMENT MARKINGS.

REMOVE EXISTING CURB AND GUTTER.

CONSTRUCT THE PERMANENT PAVEMENT, WIDENING, BRIDGE, AND CURB AND GUTTER AS SHOWN ON THE STAGING PLANS.

CAMP STREET TRAFFIC TO REMAIN ON EXISTING PAVEMENT WITH ONE (1) LANE OPEN IN BOTH DIRECTIONS AT ALL TIMES.

REVISIONS	
NAME	DATE

ILLINOIS DEPARTMENT OF TRANSPORTATION
CAMP STREET CONNECTOR
MAINTENANCE OF TRAFFIC
TYPICAL SECTIONS
STAGE 1

SCALE: VERT.
HORIZ.
DATE 12/22/2008

DRAWN BY JLT
CHECKED BY CSA