

STATE OF ILLINOIS  
DEPARTMENT OF TRANSPORTATION  
DIVISION OF HIGHWAYS  
**PLANS FOR PROPOSED  
HIGHWAY BRIDGE PROGRAM**  
SARATOGA – MILO ROAD DISTRICTS  
SECTION 05-10116-00-BR AND SECTION 08-16114-00-BR  
MARSHALL – BUREAU COUNTIES  
PROJECT NO. BROS-123(022)  
T.R. 3  
JOB NO. C94-080-06

ROUTE NO.	SECTION	COUNTY	TOTAL SHEETS	SHEET NO.
T.R. 3	*	MARSHALL/ BUREAU	14	1
ROAD DIST.		ILLINOIS	SARATOGA/MILO	

\*05-10116-00-BR  
08-16114-00-BR  
CONTRACT NO. 89398

SHEET NO.	TITLE
1.	COVER SHEET
2.	SUMMARY OF QUANTITIES, GENERAL NOTES & TYPICAL SECTIONS
3.	PLAN AND PROFILE SHEET
4.-9.	BRIDGE PLANS
10.-14.	STATION CROSS SECTIONS

**STANDARDS:**

- 280001-04
- 515001-03
- 635006-03
- 701301-03
- 701901-01
- BLR 21-8

**SCALES**

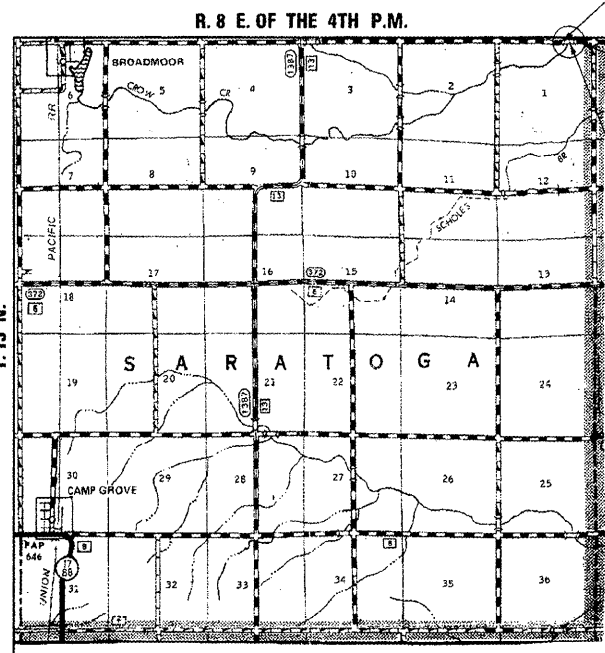

LOCATION PLAN

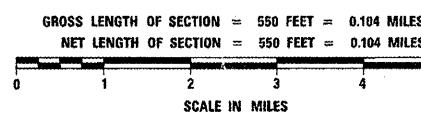

IMPROVEMENT BEGINS  
STA. 11 + 50

IMPROVEMENT ENDS  
STA. 17 + 00

STA. 15 + 05 - SPECIAL BRIDGE DESIGN  
PRECAST PRESTRESSED CONCRETE  
DECK BEAM BRIDGE, SINGLE SPAN @  
80'-0"; 27'-0" ROADWAY; 0° SKEW  
EXISTING S.N. 062-3008  
PROPOSED S.N. 006-4234

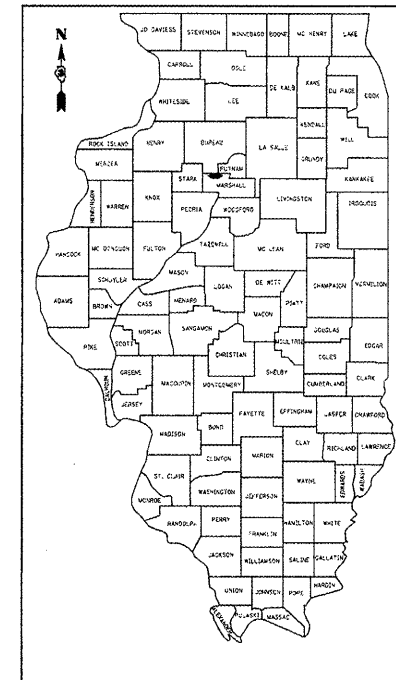

LOCATION OF SECTION INDICATED THUS: [Symbol]

CLASSIFICATION: LOCAL ROAD NON-URBAN  
DESIGN VOLUME: UNDER 250 ADT  
CURRENT ADT: 125 ADT (2008)  
DESIGN SPEED: 30 MPH

TOLL FREE JOINT UTILITY LOCATING  
INFORMATION FOR EXCAVATORS (J.U.L.I.E.)  
TELEPHONE NUMBER 1-800-892-0123

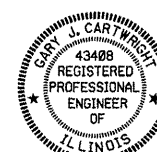

*Gary J. Cartwright* 12-5-08  
ILLINOIS PROFESSIONAL NO. 43408  
EXPIRES 11-30-09

PASSED *December 3* 2008  
ROAD DISTRICT COMMISSIONER  
APPROVED *December 2* 2008  
COUNTY ENGINEER  
PASSED *Dec 17* 2008  
DISTRICT FOUR ENGINEER OF LOCAL ROADS & STREETS  
RELEASED FOR BID *Dec 13* 2008  
BASED ON LIMITED REVIEW  
DEPUTY DIRECTOR OF HIGHWAYS, REGION THREE ENGINEER  
STATE OF ILLINOIS  
DEPARTMENT OF TRANSPORTATION