

DATE	
BY	
FINAL SURVEY	
PLOTTED	
NOTE BOOK	
AREAS CHECKED	
NO.	

DATE	
BY	
ORIGINAL SURVEY	
PLOTTED	
NOTE BOOK	
AREAS CHECKED	
NO.	

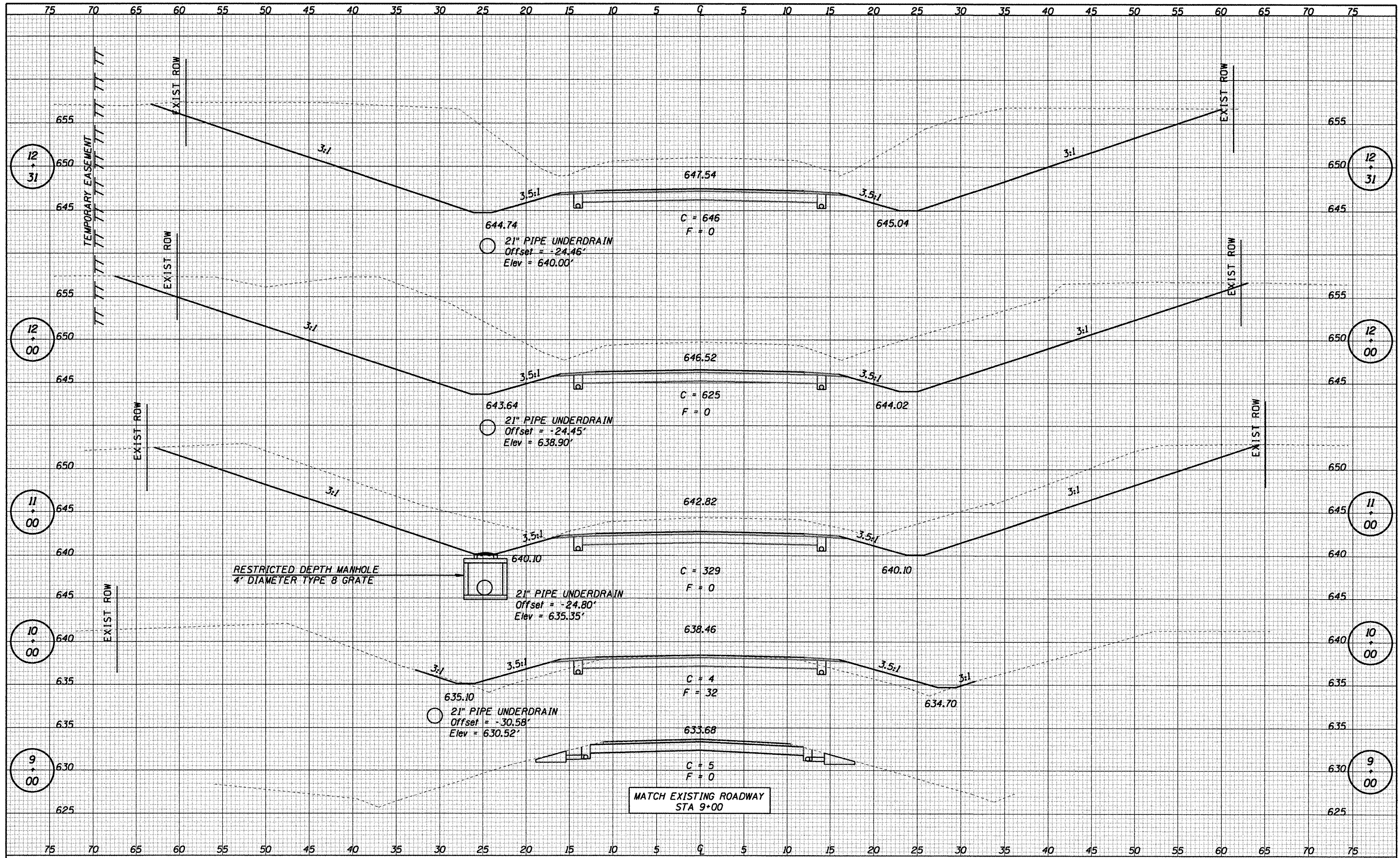

CUMMINS ENGINEERING CORPORATION

JOB - 2096.1
 FILE NAME = 2096xsecCH13.dgn
 PLOT SCALE = 10.00 Ft / IN.
 PLOT DATE = 12/22/2008

DESIGNED - NAK
 DRAWN - AJH
 CHECKED - NAK
 DATE - 10/15/2008

REVISED -
 REVISED -
 REVISED -
 REVISED -

MOULTRIE COUNTY
BETHANY FINDLAY RD. IMPROVEMENTS

CROSS SECTIONS - CH 13

SCALE: SHEET NO. OF SHEETS STA. 9+00 TO STA. 12+31

F.A.S. RTE.	SECTION	COUNTY	TOTAL SHEETS	SHEET NO.
650	02-0062-01-PV	MOULTRIE	44	24
CH 13, BETHANY FINDLAY RD.		CONTRACT NO. 95568		
FED. ROAD DIST. NO. ILLINOIS FED. AID PROJECT				