

F.A.U. RTE.	SECTION	COUNTY	TOTAL SHEETS	SHEET NO.
8894	05-00073-01-PV	MADISON	68	40
STA. 92+50.00		TO STA. 103+79.86		
FED. ROAD DIST. NO.		ILLINOIS	FEDERAL AID PROJECT	

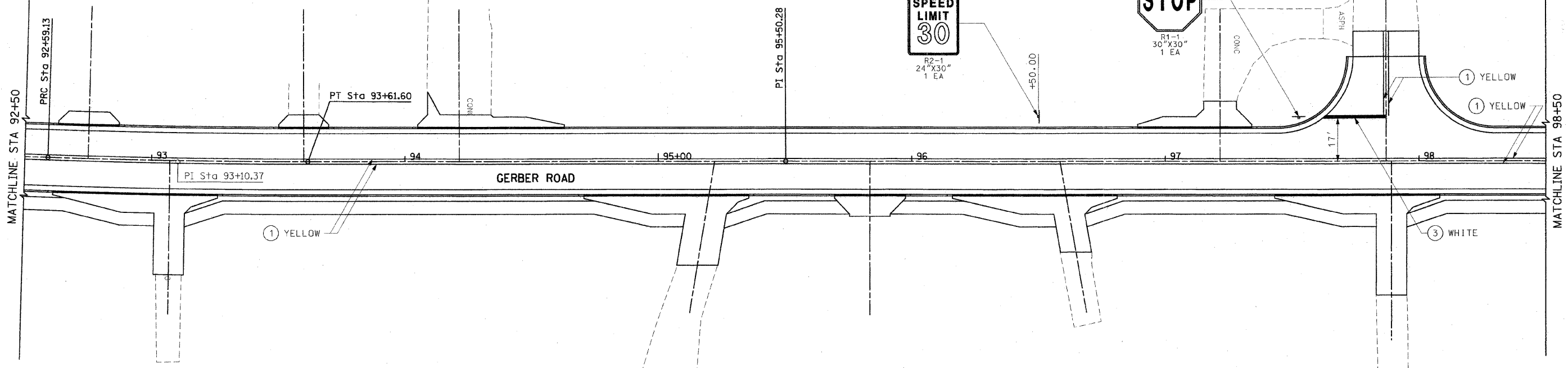

**LEGEND**

- ① THERMOPLASTIC PAVEMENT MARKING - LINE 4"
- ② THERMOPLASTIC PAVEMENT MARKING - LINE 6"
- ③ THERMOPLASTIC PAVEMENT MARKING - LINE 12"

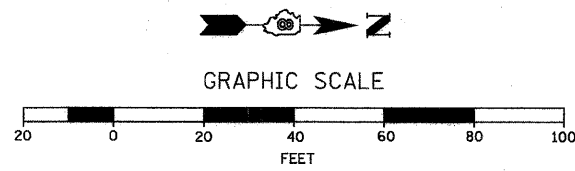
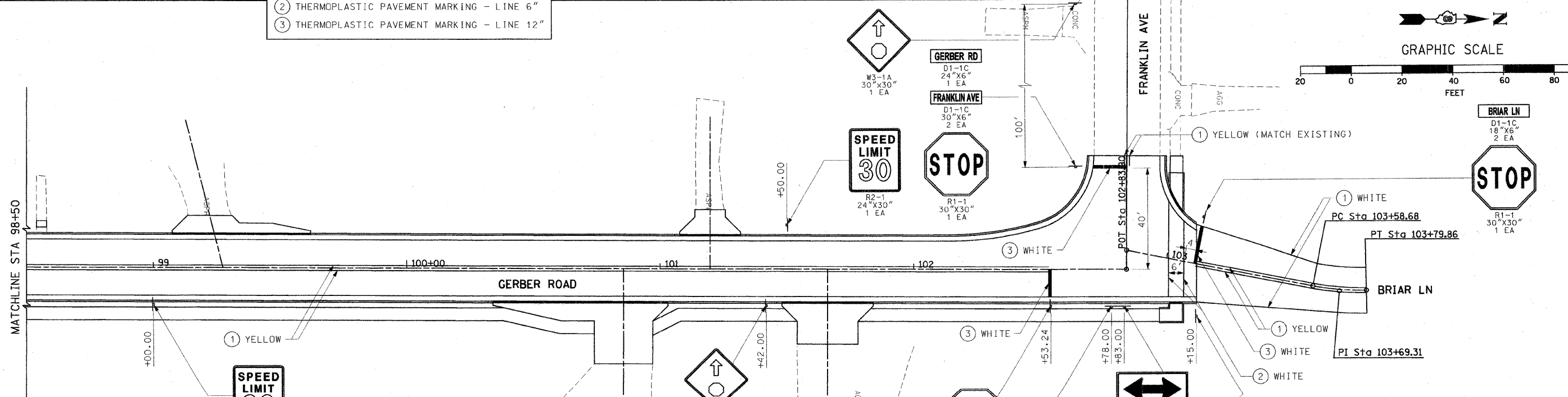
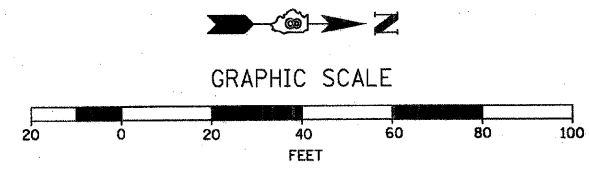

REVISIONS	
NAME	DATE

ILLINOIS DEPARTMENT OF TRANSPORTATION

**PAVEMENT MARKING AND SIGNING PLAN**

SCALE: VERT. N/A  
 HORIZ. 1"=20'  
 DATE 11/5/03

DRAWN BY AJK, RJM  
 CHECKED BY JWB

PAVEMENT MARKING AND SIGNING PLAN: GERBER ROAD - STA. 92+50.00 TO STA. 103+79.86