

B.M. No. 1: Spike in Power Pole, 406.08' Lt. of Station 100+54.44, Elev. 531.01

Note: No freefall deck drains will be permitted in the span over the tracks or within 10 ft. of cross arms of a railroad pole line.

Existing Structure: None

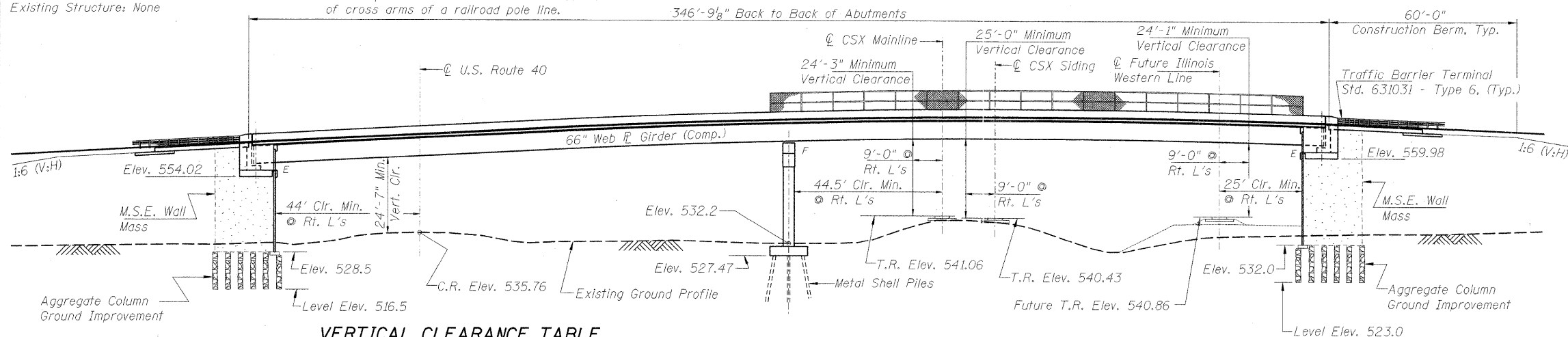

VERTICAL CLEARANCE TABLE

C.P.	Vertical Clearance Point	U.S. Route 40	116+39.23	14'-6" Lt.
C.P.-1	Vertical Clearance Point	U.S. Route 40	116+39.23	14'-6" Lt.
C.P.-2	Vertical Clearance Point	CSX Mainline Track	118+07.95	14'-6" Lt.
C.P.-3	Vertical Clearance Point	CSX Siding Track	118+22.84	14'-6" Lt.
C.P.-4	Vertical Clearance Point	Future Ill Western RR	119+23.95	14'-6" Rt.

ELEVATION

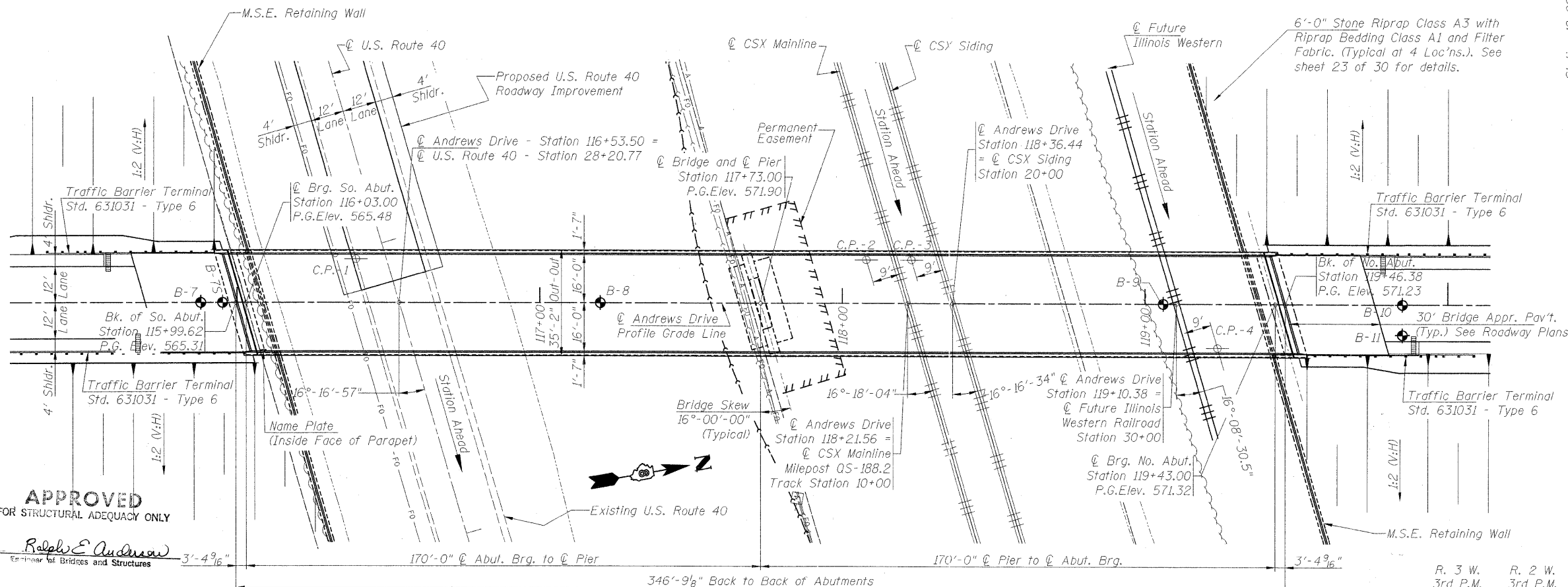

PLAN

DESIGN STRESSES

FIELD UNITS

$f'_c = 3,500$ psi
 $f_y = 60,000$ psi (Reinforcement)
 $f_y = 50,000$ psi (M270 Grade 50, Primary Members)
 $f_y = 36,000$ psi (M270 Grade 36, Secondary Members)

PRECAST UNITS

$f'_c = 4,500$ psi

DESIGN SPECIFICATIONS

2002 (7th Edition) AASHTO Standard Specifications for Highway Bridges

SEISMIC DATA

Seismic Performance Category (SPC) = A
 Bedrock Acceleration Coefficient (A) = 0.085 g
 Site Coefficient (S) = 1.0

LOADING HS20-44

Allow 50#/sq. ft. for future wearing surface.

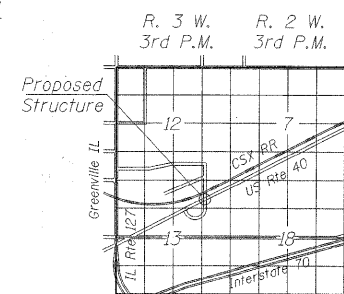

LOCATION SKETCH

ROUTE NO.	SECTION	COUNTY	DATE	SHEET NO.	SHEET NO.
---	---	BOND	99	39	30 SHEETS

Contract #97366 ***99-00036-00-BR

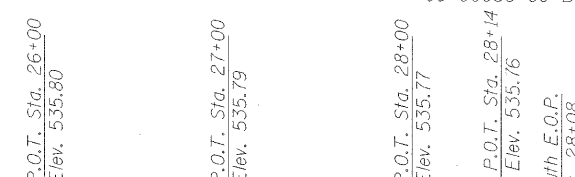

EXISTING PROFILE GRADE @ U.S. Route 40

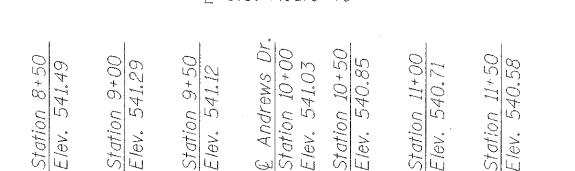

EXISTING PROFILE GRADE @ CSX Railroad Mainline (Top of Rail)

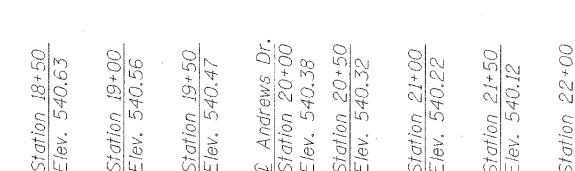

EXISTING PROFILE GRADE @ CSX Railroad Siding (Top of Rail)

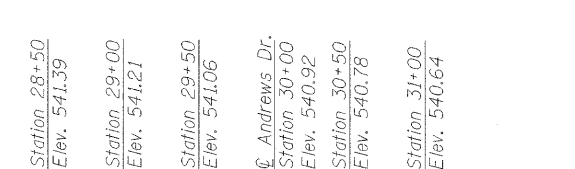

PROPOSED PROFILE GRADE @ Future Illinois Western Railroad (Top of Rail)

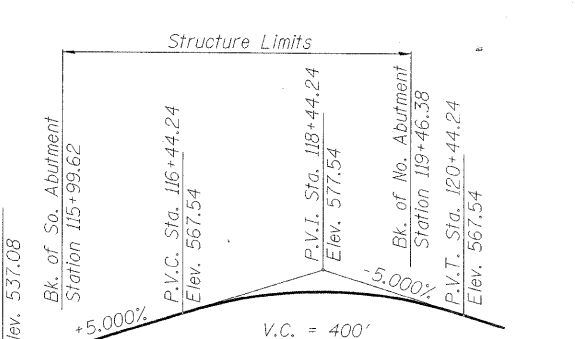

PROPOSED PROFILE GRADE @ Proposed Andrews Drive



"I certify that to the best of my knowledge, information and belief, this bridge design is structurally adequate for the design loading shown on the plans. The design is an economical one for the style of structure and complies with requirements of the current 'AASHTO Standard Specifications for Highway Bridges.'"

Signature: Michael N. Mendenhall
 Date: 11/30/09
 License No.: 081-006657

GENERAL PLAN
 ANDREWS DRIVE over
 U.S. ROUTE 40 ; CSX RR and IL. WESTERN RR
 SEC. 99-00036-00-BR
 STR. NO. 003-6000
 CITY OF GREENVILLE
 BOND COUNTY
 STATION 117+73.00

PROFESSIONAL DESIGN FIRM LICENSE #184-001084
 Copyright Hanson Professional Services Inc. 2009



04S2012

DATE 12/10/08

01/20/09 03/07/08 03/07/08 03/07/08
 LAYOUT DRAWN REVIEWED
 MMH DAP MMH
 01/21/09 DATE
 L.I.C. EXP. DATE: 11/30/10