

THOUVENOT, WADE & MOERCHEN, INC.
ENGINEERS ♦ SURVEYORS ♦ PLANNERS



CORPORATE OFFICE
4940 OLD COLLINSVILLE RD.
SWANSEA, ILLINOIS 62226
TEL (618) 624-4488
FAX (618) 624-6688
corp@twm-inc.com

WATERLOO OFFICE
113 SOUTH MAIN STREET
WATERLOO, ILLINOIS 62298
TEL (618) 939-5050
FAX (618) 939-3938
waterloo@twm-inc.com

ST. LOUIS OFFICE
1001 CRAIG ROAD, SUITE 260
ST. LOUIS, MISSOURI 63146
TEL (314) 236-5052
FAX (314) 872-2194
stlouis@twm-inc.com

| PROFESSIONAL REGISTRATIONS | LICENSE NO. |
|-------------------------------------|-------------|
| ILLINOIS PROFESSIONAL DESIGN FIRM | 184-011220 |
| PROFESSIONAL ENGINEERING CORP. | 02-035370 |
| PROFESSIONAL STRUCTURAL ENGR. CORP. | 01-000202 |
| ILLINOIS PROF. LAND SURVEYING CORP. | 048-000029 |
| MISSOURI PROFESSIONAL ENGR. CORP. | NC 001528 |
| MISSOURI LAND SURVEYING CORP. | NC 000346 |

MISSOURI LAND SURVEYING CORP. NC 000346

SEAL

Signature: _____
Signature Date: _____
Expiration Date: _____

STATEMENT OF RESPONSIBILITY
I hereby confirm that the document herein to be authenticated by my seal is restricted to this sheet, and I hereby disclaim any responsibility for all other drawings, specifications, estimates, reports or other documents or instruments relating to or intended to be utilized for any other part of the architectural, engineering or survey project.

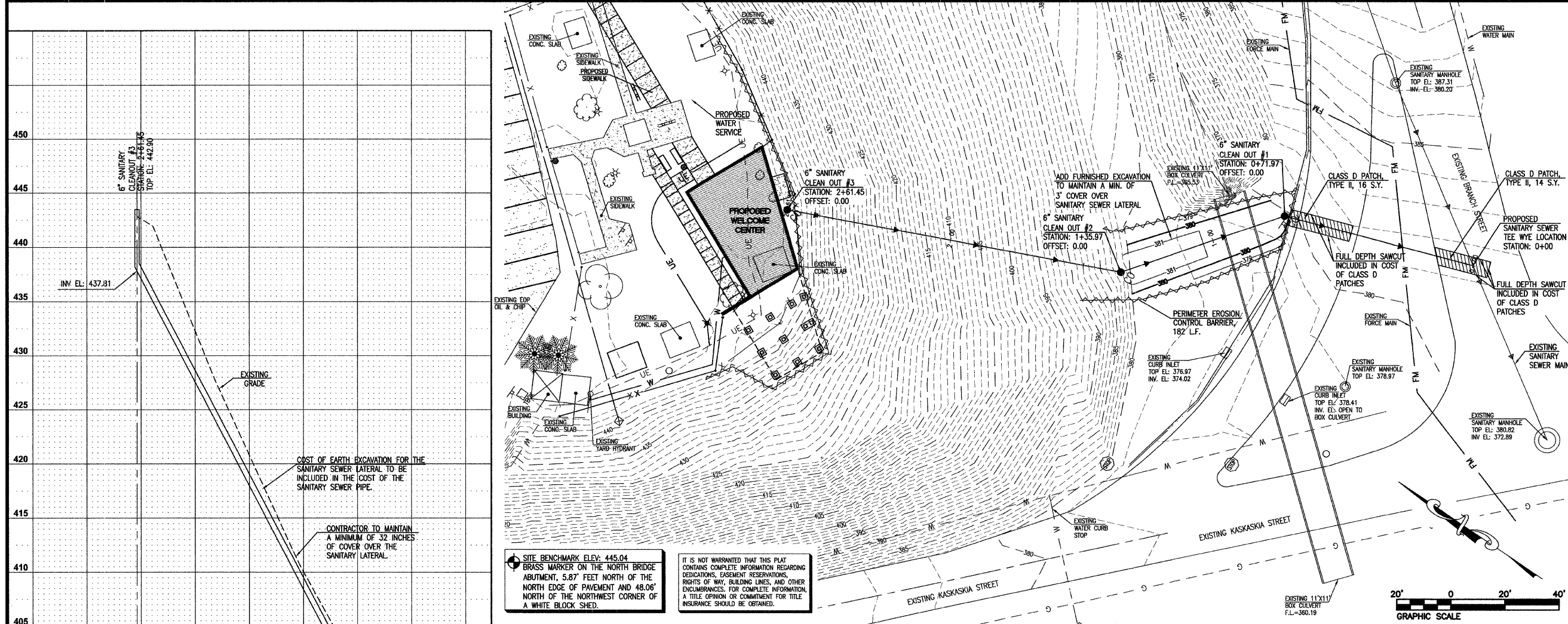

SITE BENCHMARK ELEV: 445.04
BRASS MARKER ON THE NORTH BRIDGE ABUTMENT, 5.87 FEET NORTH OF THE NORTH EDGE OF PAVEMENT AND 48.06' NORTH OF THE NORTHWEST CORNER OF A WHITE BLOCK SHED.

IT IS NOT WARRANTED THAT THIS PLAT CONTAINS COMPLETE INFORMATION REGARDING DEDICATIONS, EASEMENT RESERVATIONS, RIGHTS OF WAY, BUILDING LINES, AND OTHER ENCUMBRANCES. FOR COMPLETE INFORMATION, A TITLE OPINION OR COMMITMENT FOR TITLE INSURANCE SHOULD BE OBTAINED.

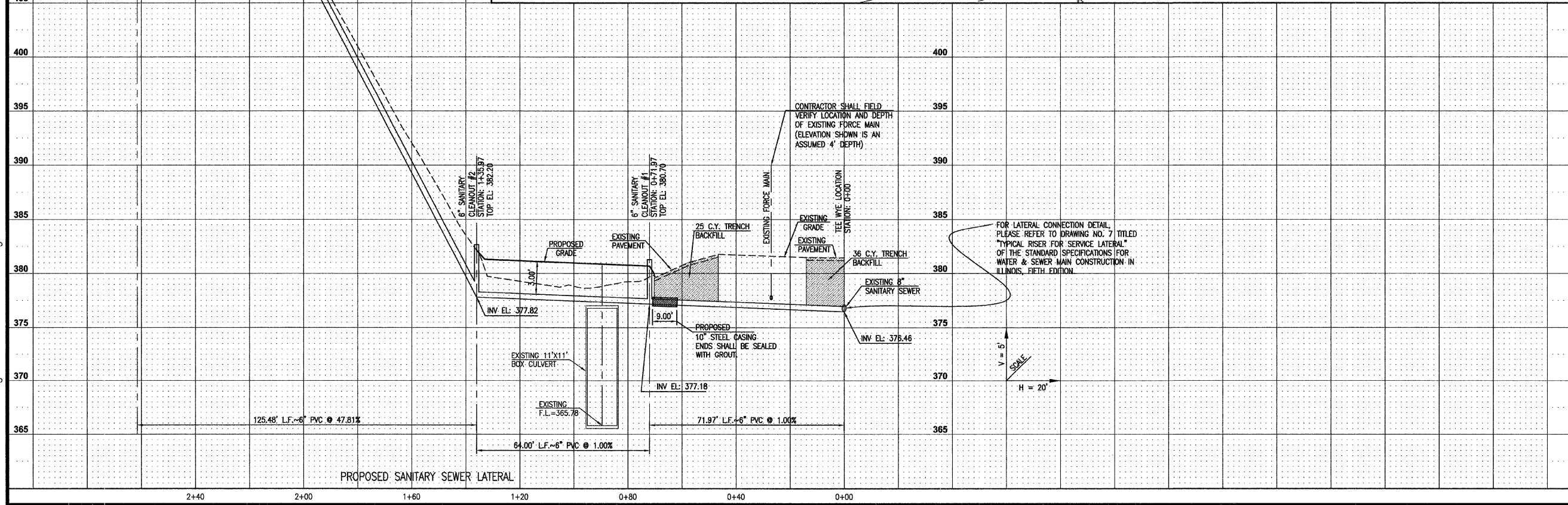

G:\SDSK\PREL\050421\dwg\PLANS\050421-PPSAN-01.dwg 1/8/2009 7:31:12 PM CST

SANITARY SEWER LATERAL PLAN AND PROFILE
CHESTER WELCOME CENTER
CITY OF CHESTER
RANDOLPH COUNTY, ILLINOIS

| REV. | DATE | DESCRIPTION |
|------|----------|-------------------------------|
| 01 | 01/08/08 | REVISIONS PER I.D.O.T. |
| 02 | 09/02/08 | REVISIONS PER CITY OF CHESTER |
| 03 | 12/16/08 | REVISIONS PER I.D.O.T. |

| | |
|---------------------------|------------|
| DRAWN BY: KAK | SHEET |
| DESIGNED BY: | C-5 |
| CHECKED BY: | |
| APPROVED BY: | |
| PROJECT NUMBER: D33050421 | |
| ISSUED FOR REVIEW | OF SHEETS |
| RECORD DRAWING | |