

**ELECTRICAL NOTES**

E1. ELECTRICAL SYSTEMS ARE TO BE PROVIDED AS A DESIGN/BUILD SYSTEM. THESE DRAWINGS ARE INTENDED TO PROVIDE A BASE SCOPE OF PROJECT APPROACH. CONTRACTOR SHALL BE RESPONSIBLE FOR SIZING SERVICE, PANEL AND BRANCH CIRCUITING. ALL WORK SHALL COMPLY WITH APPLICABLE CODES AND REGULATIONS, INCLUDING THE NATIONAL ELECTRICAL CODE, INTERNATIONAL ENERGY CODE, AND UTILITY PROVIDER STANDARDS. ELECTRICAL SYSTEM TO BE COMPLETE, PROPERLY GROUNDED WORKING SYSTEM COMPRISED OF NEW EQUIPMENT FROM END OF UTILITY COMPANY SERVICE THROUGHOUT BUILDING. EXISTING MATERIALS MEETING THE REQUIREMENTS OF CURRENT CODES MAY BE RE-USED IN PLACE. DO NOT REMOVE AND REINSTALL ITEMS WITHOUT APPROVAL OF OWNER AND ARCHITECT.

E2. CONTRACT TO INCLUDE ALL TAP FEES, CONNECTION FEES, PERMIT, AND INSPECTION FEES, UNLESS NOTED OTHERWISE IN BID FORM. COORDINATE WITH GENERAL CONTRACTOR. INCLUDE CONDUITS AND SERVICE CABLES REQUIRED BY CODE OR UTILITY COMPANY.

E3. ALLOW FOR EXPANSION WITHIN PANEL FOR FUTURE USE - MINIMUM 30 AMP SERVICE AND 4 CIRCUITS.

E4. LIGHTING SYSTEMS IN THIS PROJECT ARE REQUIRED TO COMPLY WITH THE 2006 INTERNATIONAL ENERGY CONSERVATION CODE.

E5. NUMBER NOT USED

E6. PROVIDE SUBMITTALS THROUGH GENERAL CONTRACTOR AS REQUIRED BY FULL SPECIFICATIONS. AT A MINIMUM, PROVIDE OWNER (THROUGH ARCHITECT) A 3-RING BINDER WITH CUT SHEETS, INSTALLATION AND OPERATIONS MANUALS, PARTS LISTS, WARRANTY INFORMATION, ETC. FOR ALL FIXTURES AND EQUIPMENT INSTALLED. ALSO MARK COPY OF THIS PLAN WITH FINAL DEVICE LOCATIONS AND CIRCUIT NUMBERS UPON COMPLETION OF WORK AND SUBMIT WITH 3 RING BINDER. CONTRACTOR TO PUT ALL IN A 3 RING OR 3 CLIP BINDER AND GIVE TO OWNER AT COMPLETION OF WORK.

E7. WHEREVER TELECOM, DATA, OR CENTRAL ALARM DEVICES ARE INDICATED, PROVIDE EMPTY BOX AND CONDUITS WITH FULL WIRE AS NOTED IN SYMBOL LEGEND. LABEL ALL CABLES AT BOTH ENDS. AT A MINIMUM, USE DIFFERENT COLORS FOR PHONE, DATA, AND ALARM WIRING. SEE SYMBOL LEGEND FOR COMPLETE INFORMATION CONCERNING CABLING TO BE INCLUDED IN THIS CONTRACT.

E8. MOUNT ALL ELECTRICAL DEVICES AT ADA + OTHER ACCESSIBILITY CODE COMPLIANT HEIGHTS. CONTACT ARCHITECT IF REQUIREMENTS ARE NOT CLEAR.

E9. VERIFY WITH OWNER WHETHER ANY DEDICATED CIRCUITS ARE NEEDED FOR LARGE APPLIANCES, COPIERS, OR COMPUTERS BEFORE INSTALLATION. ISOLATE ALL POWER DEVICES WITH MOTOR LOADS FROM CIRCUITS SERVING OFFICE AREAS OR COMPUTERS.

E10. ALL WIRING IN CONDUIT SHALL BE COPPER AND COLOR CODED THW, THWN, OR THHN. CONDUIT SHALL BE EMT OR RIGID CONDUIT AS PER CODE.

E11. OWNER DOES NOT OBJECT TO USE OF NON-METALLIC CABLE (ROMEX, ETC), METALLIC CABLE, OR ARMORED CABLE WHERE ALLOWED BY CODE. SEE NEC 334 FOR NON-METALLIC CABLE RESTRICTIONS. SUPPORT AND PROTECT NON-METALLIC CABLE AS REQUIRED.

E12. ELECTRICAL CONTRACTOR TO PROVIDE ALL CUTTING AND PATCHING FOR THE INSTALLATION OF THEIR OWN WORK. DO NOT COMPROMISE THE INTEGRITY OF STRUCTURAL ELEMENTS. SEE GENERAL M-E-P SPECS AND NOTES FOR PRIORITIES OF ELECTRICAL ROUTING RELATED TO OTHER TRADES.

E13. START-UP AND GUARANTEE: CHECK AND ADJUST SYSTEMS FOR PROPER OPERATION. GUARANTEE LABOR AND MATERIAL OF MANUFACTURER'S WARRANTY.

E14. NUMBER NOT USED

E15. PROVIDE HARDWIRED SMOKE ALARMS WITH BATTERY BACK-UP (INTERCONNECTED) AS NOTED ON PLANS WITH STROBE NOTIFICATION. USE CARBON MONOXIDE DETECTOR COMPATIBLE WITH UNITS. NOTE SMOKE ALARMS ARE NOT AN APPROVED NFPA ALARM SYSTEM.

E16. ELECTRICIAN TO PROVIDE MECHANICAL CONTROL / THERMOSTAT WIRING. VERIFY REQUIRED WIRES WITH MECHANICAL CONTRACTOR. SEE MECH. PLANS FOR THERMOSTAT LOCATIONS. MECHANICAL CONTRACTOR TO PROVIDE THERMOSTAT UNITS AND MAKE FINAL CONNECTIONS. MOUNT THERMOSTAT AT AN ACCESSIBLE HEIGHT (48" AFF), U.N.O.

E17. PROVIDE POWER AS REQUIRED FOR SPECIALTY EQUIPMENT NOTED ON PLANS AND MECHANICAL SYSTEMS.

E18. RUN EXPOSED CONDUITS PARALLEL TO OR PERPENDICULAR TO FRAMING. WHEN RUNNING PARALLEL TO FRAMING, LOCATE CONDUIT ON SIDE OF FRAMING MEMBERS FURTHER FROM VIEW. DO NOT MOUNT CONDUITS TO UNDERSIDE OF TRUSS BOTTOM CHORD.

E19. COORDINATE FINAL JUNCTION BOX LOCATIONS W/ APPLIANCE OR EQUIPMENT MANUFACTURER'S CUT SHEETS. REQUEST FROM GENERAL CONTRACTOR AT LEAST 10 WORKING DAYS BEFORE INFORMATION IS NEEDED.

E20. CONNECT MICROWAVE OVENS, REFRIGERATORS, DISHWASHERS, ETC TO APPLIANCE CIRCUITS.

E21. VERIFY RECESSED POWER PANEL DEPTH(S) FITS WITH PARTITION TYPES BEFORE ORDERING EQUIPMENT. NOTIFY ARCHITECT OF CONFLICTS.

E22. PROVIDE CIRCUIT(S) FOR EXTERIOR SITE LIGHTING, MONUMENTS SIGNS, ETC. NOT ATTACHED TO BUILDING.

E23. VERIFY LOCATION OF AIR CONDITIONER DISCONNECTS WITH GENERAL CONTRACTOR.

E24. POSITIVELY ATTACH LIGHT FIXTURES TO ACOUSTIC CEILING GRID WITH CAPACITY OF FIXTURE WEIGHT APPLIED IN ANY DIRECTION. VERIFY THAT SUPPLEMENTARY HANGERS ARE INSTALLED WITHIN 3" OF EACH FIXTURE CORNER BEFORE PLACING ANY LIGHT INTO CEILING.

**ELECTRICAL SYMBOL LEGEND**

	DUPLEX OUTLET, LEVITON COMMERCIAL GRADE SERIES OR APP. EQUIV. - COLOR SELECTED BY ARCH. USE DECORA SERIES AT COUNTERS.		THERMOSTAT WITH LOCKING COVER. SEE MECHANICAL NOTES. WIRING BY ELECTRICIAN.
	WATER PROOF GFI DUPLEX OUTLET, COMMERCIAL GRADE - COLOR SELECTED BY ARCH.		POWER DISCONNECT. SIZE FOR CONNECTED EQUIPMENT LOAD.
	GFI DUPLEX OUTLET, COMMERCIAL GRADE - COLOR SELECTED BY ARCH.		RECESSED POWER PANEL. VERIFY DEPTH WITH PARTITION BEFORE ORDERING.
	DOUBLE DUPLEX. SEE DUPLEX DESCRIPTION		EXHAUST FAN TO BE PROVIDED AND INSTALLED BY ELECTRICIAN. SEE LIGHT FIXTURE SCHEDULE FOR FAN. MECHANICAL CONTRACTOR TO PROVIDE AND INSTALL DUCTING, OUTLETS, AND DAMPERS.
	DEDICATED CIRCUIT. VERIFY LOCATION + LOADS WITH SPECIFIC EQUIPMENT		DUPLEX BOX, COVER PLATE, AND 3/4" CONDUIT WITH FULL WIRE TO TV SPLITTER IN RM 101
	LEVITON DECORA COMMERCIAL GRADE. SINGLE POLE SWITCH OR APP. EQUIV. COLOR SELECTED BY ARCH. SIZE SWITCH WITH LOAD.		
	LEVITON DECORA COMMERCIAL GRADE THREE WAY SWITCH OR APP. EQUIV. SIZE SWITCH WITH LOAD. COLOR SELECTED BY ARCH.		
	LEVITON DECORA MOTION DETECTOR SWITCH WITH MANUAL OVERRIDE. SET TIMER FOR 15 MINUTES.		
	LEVITON CEILING MOUNT MOTION DETECTOR SWITCH WITH 30 MINUTE TIMER		
	JUNCTION BOX		
	RECESSED WALL BOX FOR FUTURE CAMERA. PROVIDE DUPLEX BOX, BLANK COVER PLATE, AND 3/4" CONDUIT WITH FULL WIRE TO ROUTER LOCATION IN RM 101		
	COMBINATION TELEPHONE + COMMUNICATION OUTLET. PROVIDE DOUBLE BOX WITH BLANK COVER PLATE AND TWO CONDUITS WITH CAT 5E CABLES, ONE EACH TO PHONE PANEL AND ROUTER LOCATIONS IN RM 101. SEE ALSO NOTE E1.		

Contract # 97367  
GENERAL NOTES

1. NO GENERAL NOTES ON THIS SHEET.

01.09.09	IDOT Submittal
issued	description

**POWER & COMMUNICATIONS PLAN & NOTES**

**CHESTER WELCOME CENTER**

Chester, Illinois

**QUADRANT** design  
architects & planners

135 south main street  
waterloo, illinois 62298  
phone 618.939.0606

job number 20525  
drawn by JE  
checked by MS  
file name  
scale

sheet **E1.1**

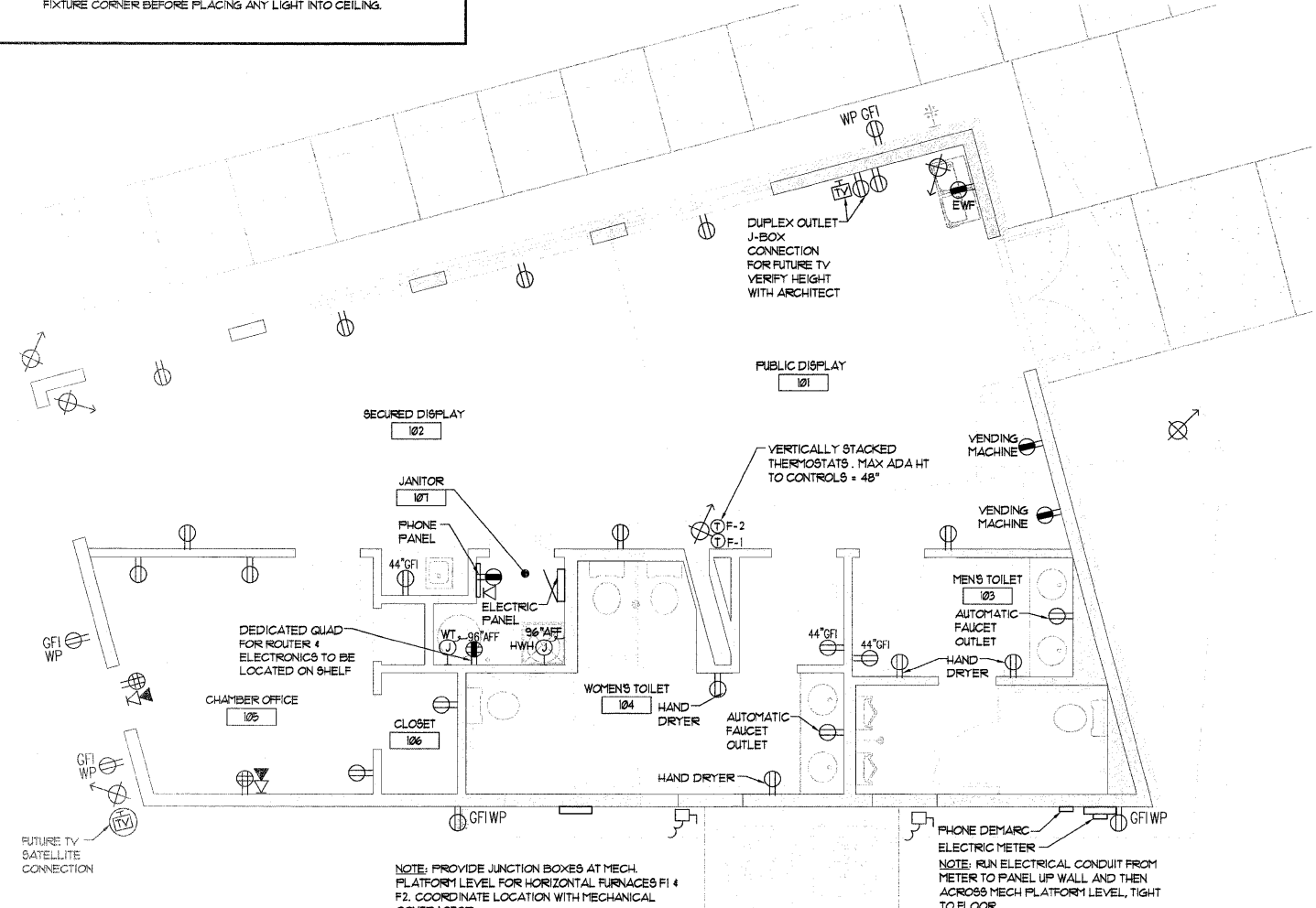

NOTE: PROVIDE JUNCTION BOXES AT MECH. PLATFORM LEVEL FOR HORIZONTAL FURNACES F1 + F2. COORDINATE LOCATION WITH MECHANICAL CONTRACTOR

NOTE: RUN ELECTRICAL CONDUIT FROM METER TO PANEL UP WALL AND THEN ACROSS MECH PLATFORM LEVEL, TIGHT TO FLOOR

**1 POWER & COMMUNICATIONS PLAN**

SCALE: 1/4" = 1'-0"

