



CORPORATE OFFICE  
4940 OLD COLLINSVILLE RD.  
SWANSEA, ILLINOIS 62226  
TEL (618) 624-4488  
FAX (618) 624-6688  
corp@twm-inc.com

WATERLOO OFFICE  
113 SOUTH MAIN STREET  
WATERLOO, ILLINOIS 62298  
TEL (618) 939-5050  
FAX (618) 939-3938  
waterloo@twm-inc.com

EDWARDSVILLE OFFICE  
1015B CENTURY DRIVE  
EDWARDSVILLE, ILLINOIS 62025  
TEL (618) 656-4040  
FAX (618) 656-4343  
edwardsville@twm-inc.com

ST. LOUIS OFFICE  
1001 CRAIG ROAD, SUITE 260  
ST. LOUIS, MISSOURI 63146  
TEL (314) 236-5052  
FAX (314) 872-2194  
stlouis@twm-inc.com

| PROFESSIONAL REGISTRATIONS          | LICENSE NO. |
|-------------------------------------|-------------|
| ILLINOIS PROFESSIONAL DESIGN FIRM   | 184-011220  |
| PROFESSIONAL ENGINEERING CORP.      | 62-005370   |
| PROFESSIONAL STRUCTURAL ENGR. CORP. | 81-005202   |
| ILLINOIS PROF. LAND SURVEYING CORP. | 048-000029  |
| MISSOURI PROFESSIONAL ENGR. CORP.   | NC 001528   |
| MISSOURI LAND SURVEYING CORP.       | NC 000346   |

SEAL

Signature: \_\_\_\_\_  
Signature Date: \_\_\_\_\_  
Expiration Date: \_\_\_\_\_

**STATEMENT OF RESPONSIBILITY**  
I hereby confirm that the document herein to be authenticated by my seal is restricted to this sheet, and I hereby disclaim any responsibility for all other drawings, specifications, estimates, reports or other documents or instruments relating to or intended to be utilized for any other part of the architectural, engineering or survey project.

TITLE:  
**SHEAR WALL DETAILS**

PROJECT:  
**CHESTER WELCOME CENTER**

| REV. | DATE     | DESCRIPTION                 |
|------|----------|-----------------------------|
| ▲    | 12/16/08 | REVISIONS PER IDOT COMMENTS |
| ▲    |          |                             |
| ▲    |          |                             |

|                           |                     |
|---------------------------|---------------------|
| DRAWN BY: DJH             | SHEET               |
| DESIGNED BY: DJH          | <b>S6</b>           |
| CHECKED BY: KPC           | OF 9 SHEETS         |
| APPROVED BY: KPC          | PROJECT DESCRIPTION |
| PROJECT NUMBER: T33050421 |                     |

ISSUED FOR REVIEW     ISSUED FOR BIDDING  
 ISSUED FOR CONSTR.     RECORD DRAWING

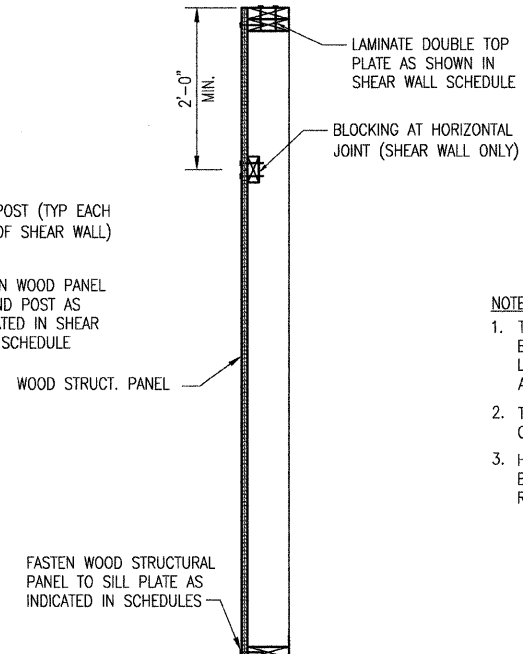
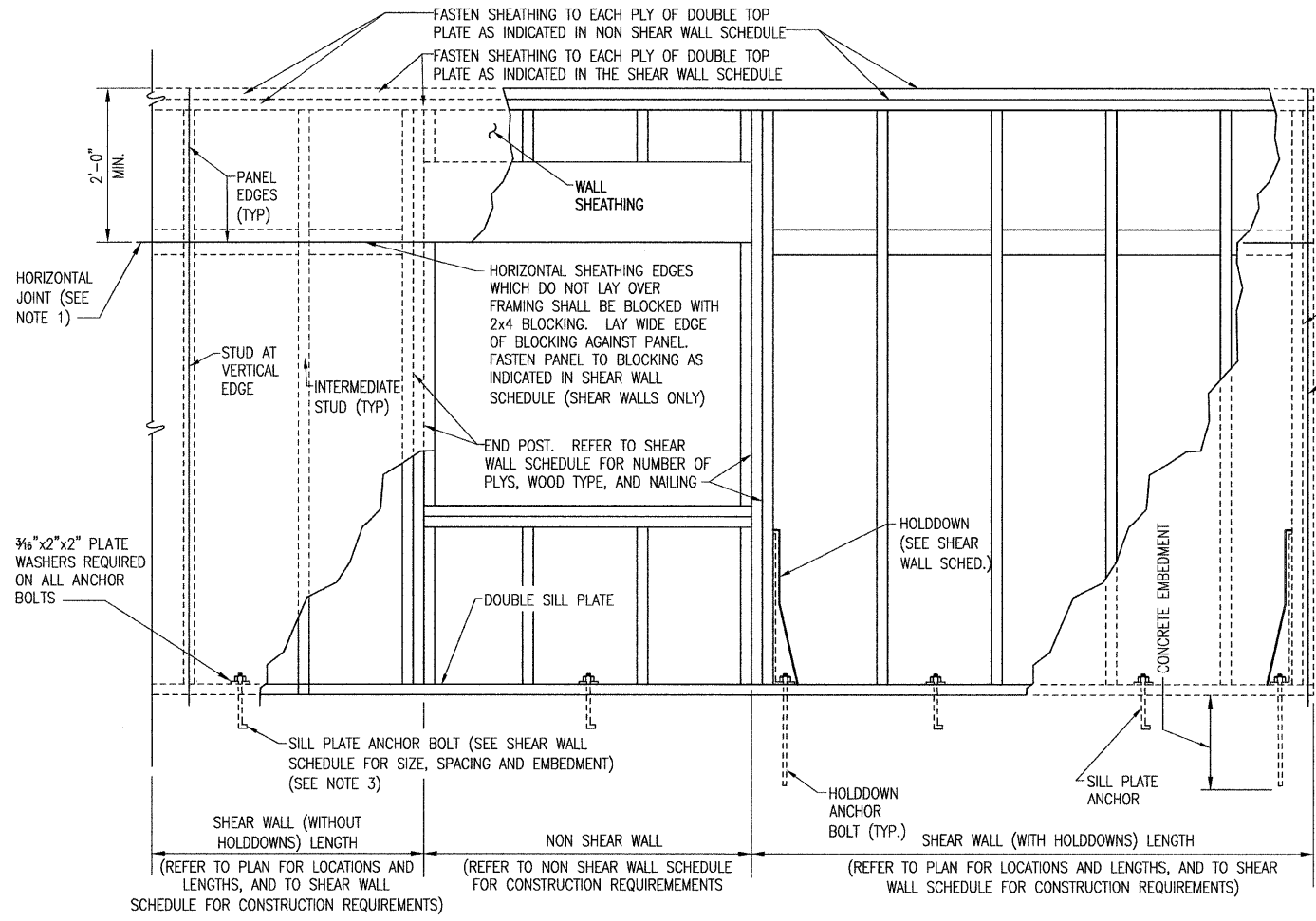

**TYP. EXT. WALL SECTION FOR SHEAR & NONSHEAR WALLS**

**NOTES:**

1. THE INDICATED HORIZONTAL JOINTS ARE NOT REQUIRED, AND MAY BE ELIMINATED BY FULL HEIGHT PANELS WHERE PRACTICAL. CONTRACTOR LOCATE PANEL JOINTS, SUBJECT TO LIMITATIONS SHOWN ON DETAILS AND AS NOTED ON SHEAR WALL SCHEDULE AND NONSHEAR WALL SCHEDULE.
2. THIS IS A GENERIC SKETCH INTENDED TO ILLUSTRATE THE TYPICAL DETAILS OF WALL CONSTRUCTION AND IS NOT A DETAIL OF ANY PARTICULAR WALL.
3. HOLDDOWN ANCHOR BOLTS SHALL NOT BE CONSIDERED AS SILL PLATE ANCHOR BOLTS. SILL PLATE ANCHOR BOLTS WILL BE SPACED AS SHOWN WITHOUT REGARD TO THE PRESENCE OF HOLDDOWN ANCHOR BOLTS.

**GENERIC PARTIAL WALL ELEVATION**