

DATE	
BY	
SURVEYED	
NOTED	
TEMPLATE	
AREAS CHECKED	
NO.	

DATE	
BY	
ORIGINAL SURVEY	
NOTED	
TEMPLATE	
AREAS CHECKED	
NO.	

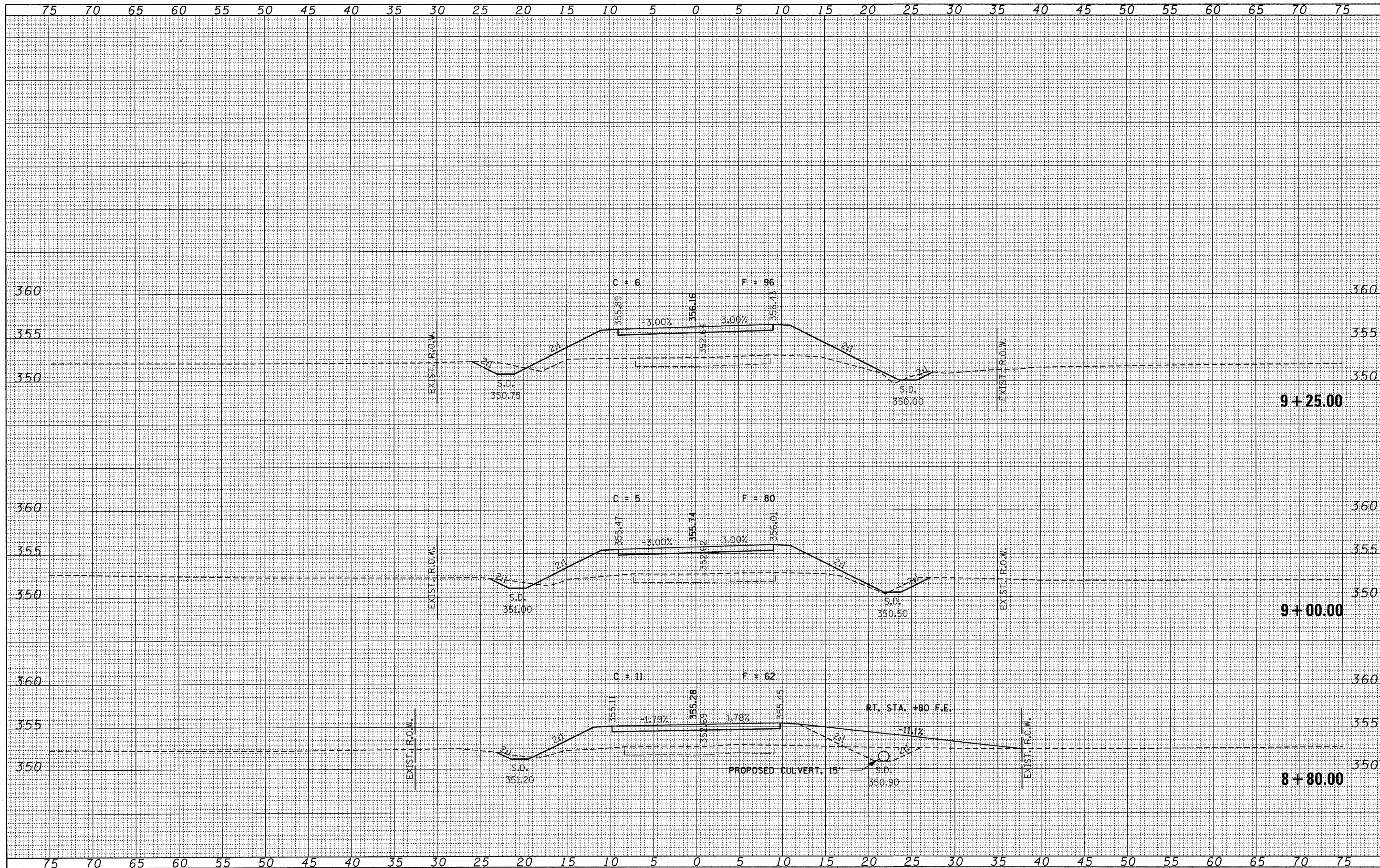

FILE NAME =
#FILE#

USER NAME = #USER#
DESIGNED - J.W.F.
DRAWN - D.T.M.
CHECKED - S.W.M.
DATE - 07/16/08

REVISIONS
REVISED -
REVISED -
REVISED -

STATE OF ILLINOIS
GALLATIN COUNTY HIGHWAY DEPARTMENT

HLR HAMPTON, LENZINI & RENWICK, INC.
CIVIL & STRUCTURAL ENGINEERS
LAND SURVEYORS
SCALE: 5 SHEET NO. OF SHEETS

**CROSS SECTIONS
EQUALITY ROAD DISTRICT**
STA. 8+80.00 TO STA. 9+25.00

T.R.	SECTION	COUNTY	TOTAL SHEETS	SHEET NO.
98	06-04109-00-BR	GALLATIN	16	5
FED. ROAD DIST. NO.			ILLINOIS FED. AID PROJECT	

9+25.00

9+00.00

8+80.00