

**NOTES:**  
 1. SEE EXISTING CONDITIONS & REMOVALS  
 LEGEND & NOTES FOR LEGEND OF  
 EXISTING CONDITIONS & REMOVALS.

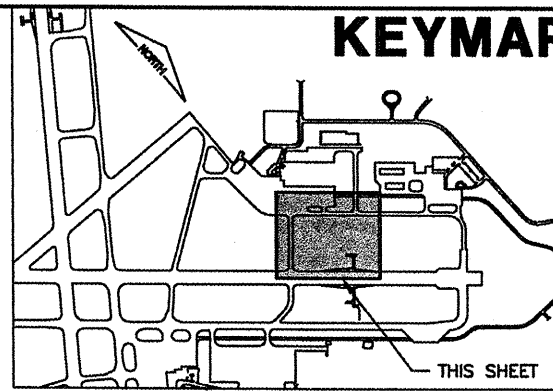
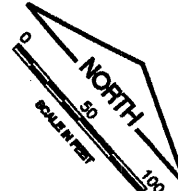

K:\Springfield\0703509\Draw\Sheets\Phase 2 Full  
 FILE: EXISTCONREML.dwg  
 UPDATE BY: Kristy Brod  
 PLOT DATE: 1/23/2009 1:50 PM  
 BASE\_EXISTGEO  
 BASE\_EXISTTOPO  
 KEY  
 Utl98  
 BASE\_PROPGEO

**CA007**

REVISIONS		
NUMBER	BY	DATE

0 1 2  
 THIS BAR IS EQUAL TO 2"  
 AT FULL SCALE (34x22).



SPRINGFIELD AIRPORT AUTHORITY  
 ABRAHAM LINCOLN CAPITAL AIRPORT  
 SPRINGFIELD, ILLINOIS

WIDEN TAXIWAY G - PHASE 2  
 EXISTING CONDITIONS & REMOVALS 1

© Copyright, CMT, Inc.  
**CMT**  
 CRAWFORD, MURPHY & TILLY, INC.  
 CONSULTING ENGINEERS  
 License No. 784-000678



DESIGN BY:	CBG
DRAWN BY:	CMT
CHECKED BY:	<i>RLW</i>
APPROVED BY:	<i>RLW</i>
DATE:	01/30/2009
JOB No:	07035-09-00
IL PROJ. NO.	SPI-3860
AIP PROJ. NO.	3-17-0096-XX
SHEET 12 OF 65 SHEETS	

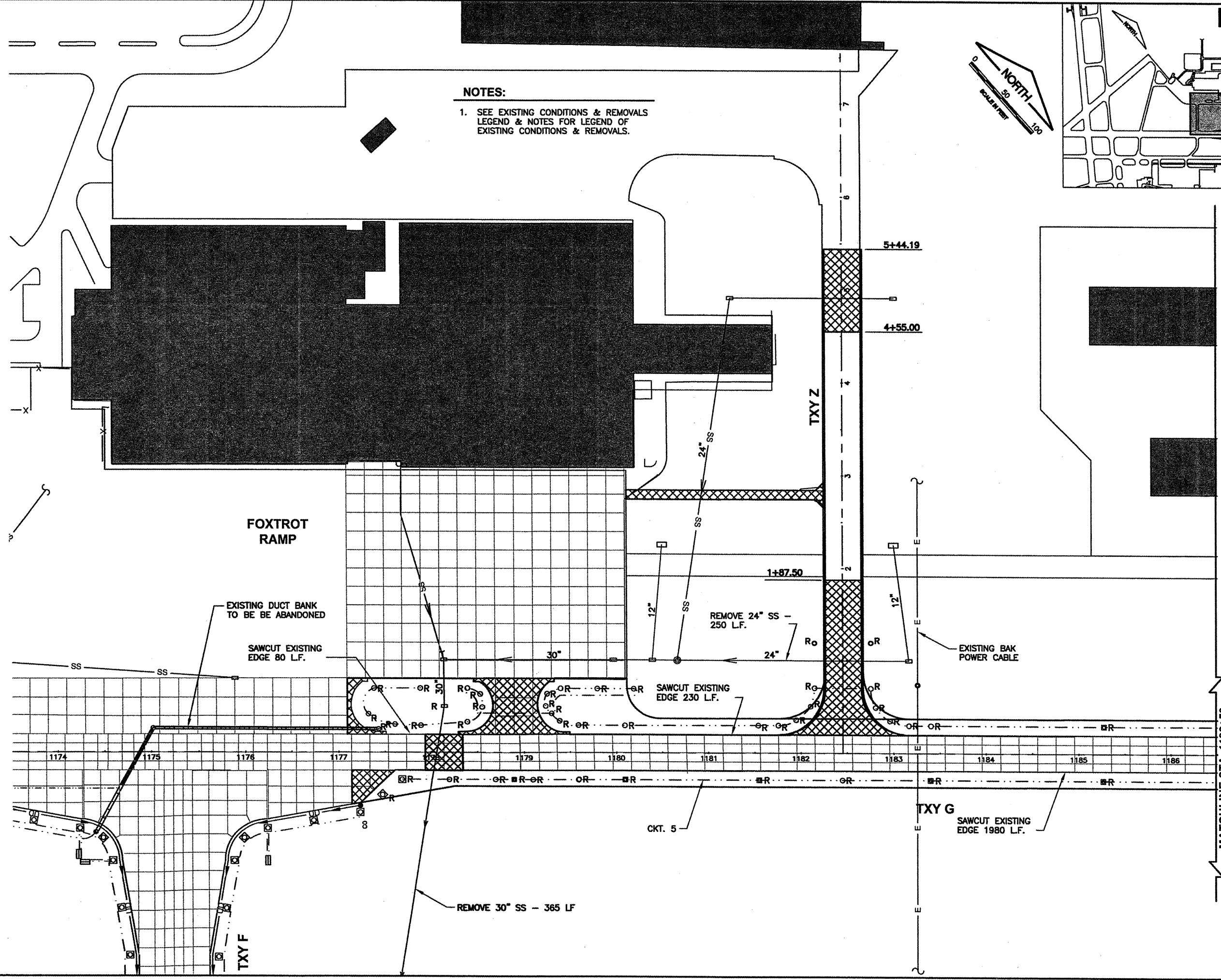

MATCHLINE STA. 1186+50