

**CA008**

REVISIONS		
NUMBER	BY	DATE

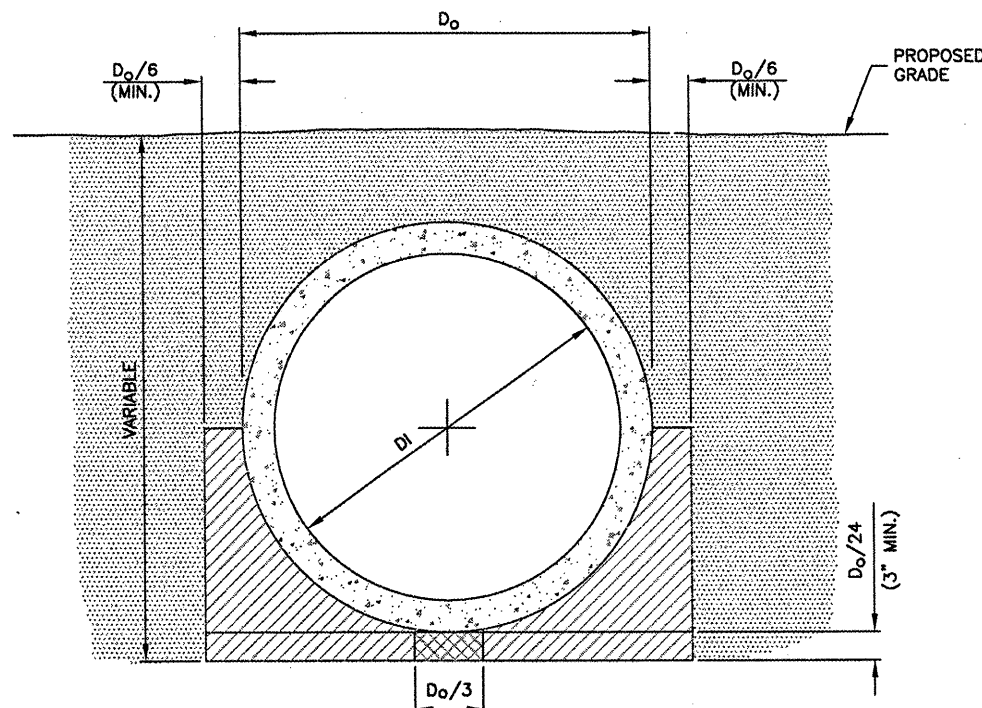

**STANDARD TRENCH INSTALLATION  
 NON-PAVED AREA**  
 N.T.S.

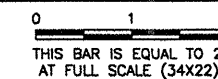
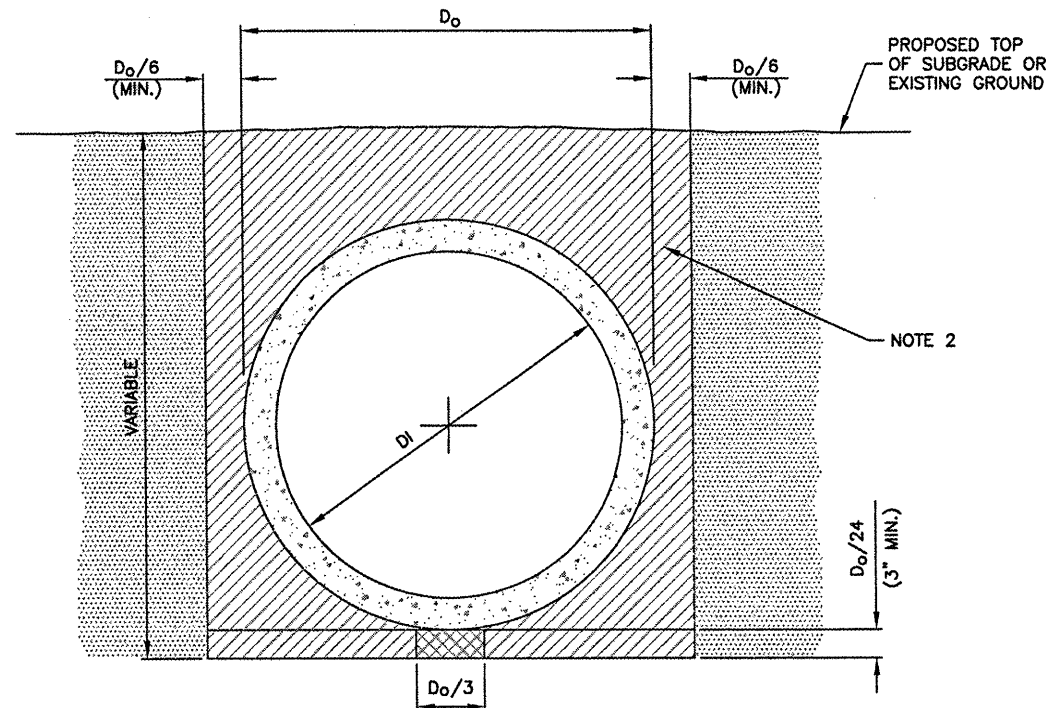

**STANDARD TRENCH INSTALLATION  
 PROPOSED PAVED AREA**  
 N.T.S.

**TRENCH INSTALLATION LEGEND**

- DRAINAGE CONDUIT MATERIAL—CONCRETE
- MIDDLE BEDDING LOOSELY PLACED UNCOMPACTED BEDDING
- HAUNCH AND OUTER BEDDING COMPACTION— TO ENGINEER'S SATISFACTION OR 95% STANDARD PROCTOR
- LOWER SIDE AND OVERFILL COMPACTION— SAME AS EMBANKMENT REQUIREMENTS
- $D_o$  PIPE OUTSIDE DIAMETER
- $D_1$  PIPE INSIDE DIAMETER

**TRENCH INSTALLATION NOTES**

1. BEDDING SHOWN IS IN ACCORDANCE WITH "STANDARD EMBANKMENT INSTALLATIONS", STANDARD INSTALLATION & BEDDING FACTORS FOR THE INDIRECT DESIGN METHOD (DESIGN DATA 40), AMERICAN CONCRETE PIPE ASSOCIATION.
2. BACKFILL TO EXTEND 3' BEYOND EDGES OF PROPOSED PAVEMENT.

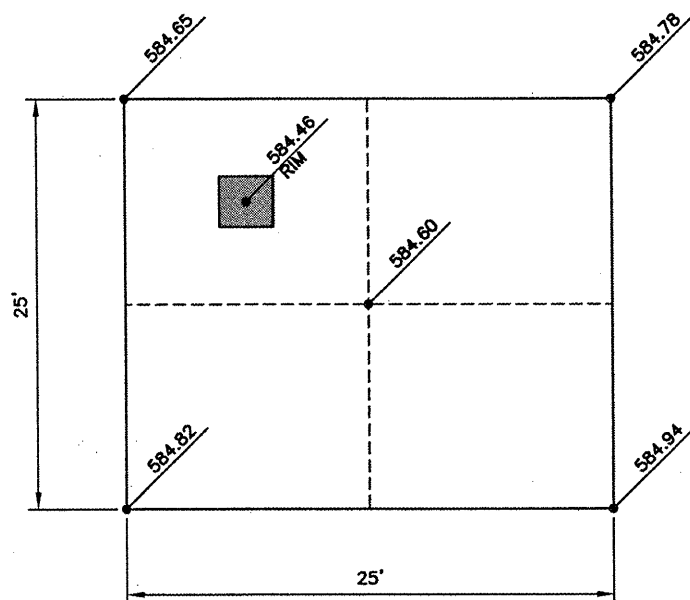

**(IN-1)**  
**INLET STAKING PLAN**  
 N.T.S.

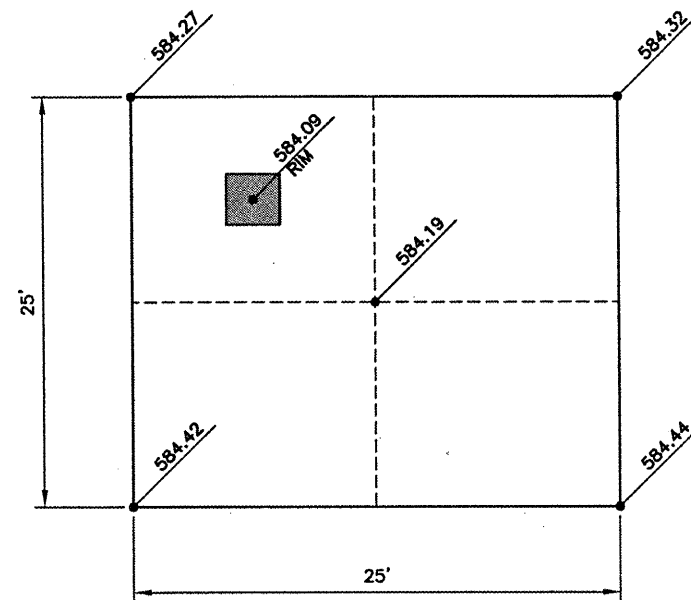

**(IN-2)**  
**INLET STAKING PLAN**  
 N.T.S.

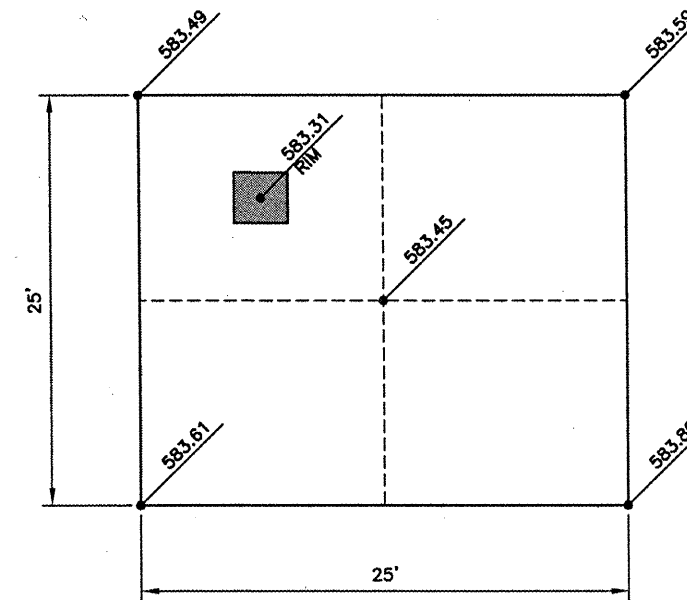

**(IN-3)**  
**INLET STAKING PLAN**  
 N.T.S.



SPRINGFIELD AIRPORT AUTHORITY  
 ABRAHAM LINCOLN CAPITAL AIRPORT  
 SPRINGFIELD, ILLINOIS

RECONSTRUCT AND EXPAND THE SOUTHEAST RAMP  
 DRAINAGE DETAILS

© Copyright CMT, Inc.  
**CMT**  
 CRAWFORD, MURPHY & TILLY, INC.  
 CONSULTING ENGINEERS  
 License No. 84-00663

DESIGN BY:	RLV/KLB
DRAWN BY:	CMT
CHECKED BY:	REN
APPROVED BY:	REN
DATE:	JANUARY 27, 2009
JOB No:	08035-08
IL PROJ. NO.	SPI-3885
AIP PROJ. NO.	3-17-0096-XX
SHEET	23 OF 40 SHEETS