

FENCE INSTALLATION NOTES

THE PROPOSED FENCE SHALL BE A 10 FOOT CLASS E FENCE WITH THREE STRANDS OF BARB WIRE. THE PROPOSED FENCE IN THE FRONTAL AREA SHALL BE A 8 FOOT CLASS E FENCE WITHOUT BARB WIRE. THIS WORK WILL INCLUDE WALK GATES, DRIVE GATES AND SLIDE GATES. THE PROPOSED FENCE SHALL MEET THE REQUIREMENTS PROVIDED IN THE SPECIAL PROVISIONS.

THE CONTRACTOR IS REQUIRED TO REMOVE THE EXISTING FENCE IN A MANNER THAT WILL NOT COMPROMISE THE SECURITY AT THE AIRPORT. THE EXISTING FENCE WILL NOT BE REMOVED UNTIL THE PROPOSED FENCE CAN BE INSTALLED IN ITS PLACE.

THE CONTRACTOR WILL BE ALLOWED TO REMOVE THE EXISTING FABRIC FROM THE EXISTING POSTS. THE FABRIC WILL BE LAID DIRECTLY ON THE GROUND TO ALLOW THE REMOVAL OF THE EXISTING POSTS AND THE INSTALLATION OF THE PROPOSED POSTS. ONCE THE CONCRETE ON THE PROPOSED POSTS HAS CURED FOR AT LEAST 3 HOURS THE CONTRACTOR WILL TIE THE EXISTING FABRIC TO THE PROPOSED POSTS. THIS WILL PROVIDE AIRPORT SECURITY WHILE THE PROPOSED CONCRETE CURES AND OBTAINS THE REQUIRED STRENGTH (MINIMUM 3,500 POUNDS IN 14 DAYS). ONCE THE CONCRETE HAS REACHED 3,500 POUNDS THE CONTRACTOR WILL BE ALLOWED TO REMOVE THE EXISTING FABRIC AND STRETCH AND TIE THE PROPOSED FABRIC TO THE PROPOSED POSTS. IN THIS FASHION THE CONTRACTOR WILL REMOVE AND REPLACE THE EXISTING FENCE. ONLY THE EQUIVALENT AMOUNT OF FENCE THAT CAN BE ERECTED IN A DAY'S TIME CAN BE REMOVED IN ORDER TO AVOID UNACCEPTABLE GAPS. THE CONTRACTOR IS CAUTIONED TO BE COGNIZANT OF INCLEMENT WEATHER, EQUIPMENT TROUBLE, OR OTHER UNEXPECTED EVENTS THAT WOULD INTERFERE WITH THE COMPLETION OF A DAYS WORK. A GAP IN THE FENCE WILL NOT BE PERMITTED TO REMAIN OVERNIGHT.

EXISTING UTILITY LOCATIONS

NONE OF THE EXISTING UTILITIES LOCATED ALONG THE PROPOSED ALIGNMENT HAVE BEEN SHOWN. THE CONTRACTOR MUST CONTACT J.U.L.I.E. (1-800-892-0123) PRIOR TO INSTALLING ANY PROPOSED FENCING. ANY EXISTING UTILITY DAMAGED BY THE CONTRACTOR WILL BE REPAIRED TO THE SATISFACTION OF THE UTILITY OWNER. THE REPAIRS WILL BE MADE AT THE CONTRACTOR'S OWN EXPENSE.

FENCING ALONG OLD STATE ROAD

THE PROPOSED FENCE SHALL BE PLACED AT A DISTANCE OF 35' FROM THE CENTERLINE OF THE OLD STATE ROAD. THIS DISTANCE CAN BE VARIED TO MISS UTILITIES OR OTHER OBSTRUCTIONS. THE RESIDENT ENGINEER WILL DETERMINE THE DISTANCE THE FENCE WILL BE MOVED.

NOTE

THE CONTRACTOR WILL BE PERMITTED TO ACCESS THE AIRPORT PROPERTY THROUGH ANY OF THE EXISTING GATES THAT ARE IN CLOSE PROXIMITY TO THE WORK TO BE COMPLETED THAT DAY. THE CONTRACTOR WILL BE REQUIRED TO COORDINATE HIS DAILY ACCESS WITH THE RESIDENT ENGINEER AND THE AIRPORT DIRECTOR.

EARTHWORK

MINOR EARTHWORK GRADING MAY BE NECESSARY TO ESTABLISH ADEQUATE CLEARANCE FOR THE PROPOSED FENCE. HOWEVER, THIS WORK IS ANTICIPATED TO BE MINIMAL SINCE THE MAJORITY OF THE PROPOSED ALIGNMENT FOLLOWS THAT OF THE EXISTING FENCE. THEREFORE, EARTHWORK WILL BE CONSIDERED INCIDENTAL TO THE INSTALLATION OF THE PROPOSED FENCE.

THE CONTRACTOR IS RECOMMENDED TO VISIT THE SITE AND INSPECT THE PROPOSED ALIGNMENT.

SEEDING AND MULCHING

ALL AREAS ALONG THE PROPOSED FENCE ALIGNMENT DISTURBED BY THE CONSTRUCTION OPERATIONS SHALL BE SEEDED IN ACCORDANCE WITH THE SPECIAL PROVISIONS. PROPOSED SEEDING WILL BE CONSIDERED AS AN INCIDENTAL ITEM TO THE PROPOSED FENCING.

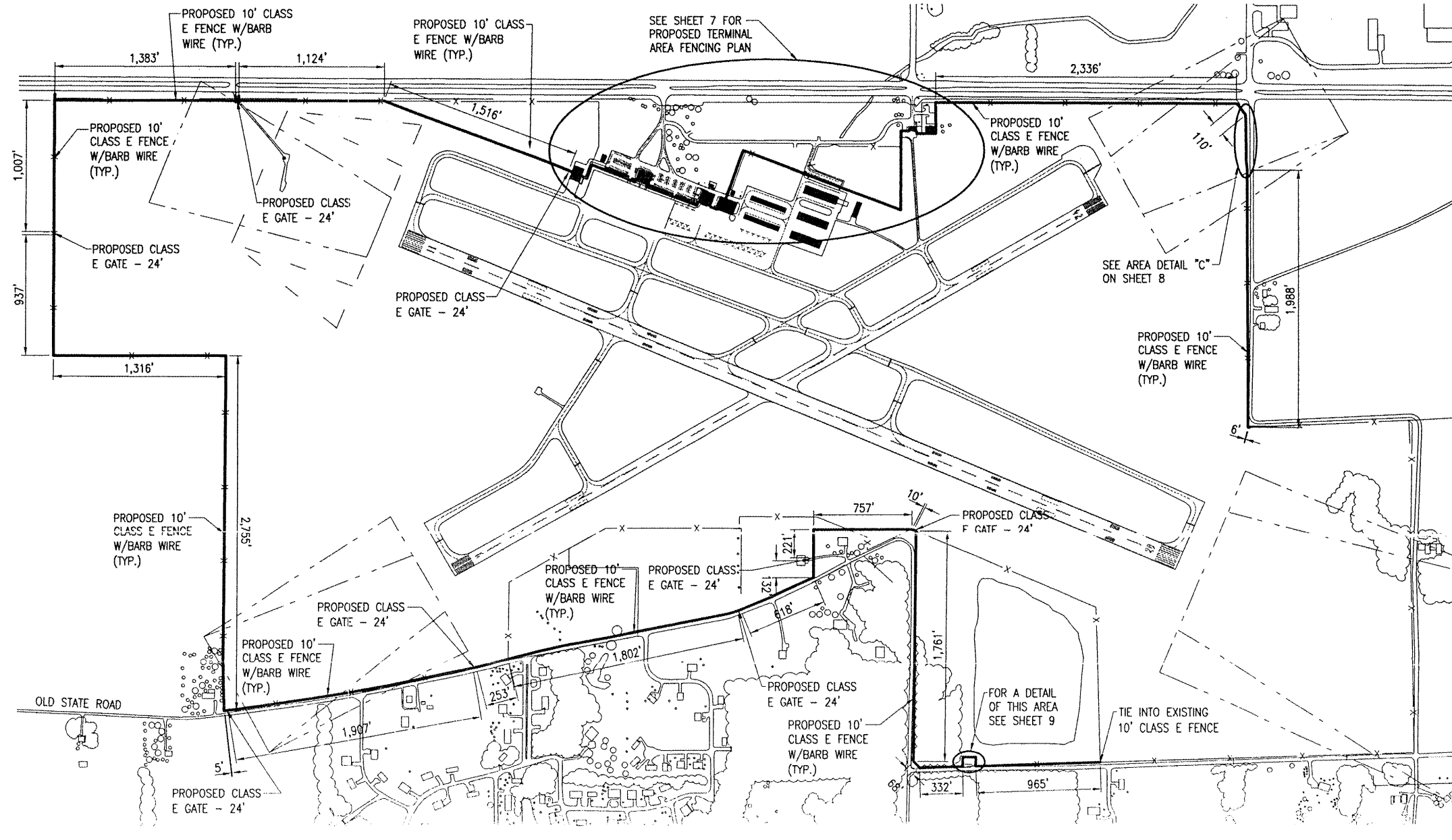

| QUANTITY SCHEDULE | | | |
|-------------------|-------------------|------|----------|
| ITEM NO. | DESCRIPTION | UNIT | QUANTITY |
| AR162508 | CLASS E FENCE 8' | EACH | 3,621 |
| AR162510 | CLASS E FENCE 10' | EACH | 23,949 |
| AR162604 | CLASS E GATE-4' | EACH | 2 |
| AR162606 | CLASS E GATE-6' | EACH | 9 |
| AR162624 | CLASS E GATE-24' | EACH | 12 |
| AR162720 | ELECTRIC GATE-20' | EACH | 1 |
| AR162724 | ELECTRIC GATE-24' | EACH | 1 |

LEGEND

- EXISTING IMPROVEMENTS
- EXISTING BUILDINGS
- EXISTING FENCE
- PROPOSED FENCE

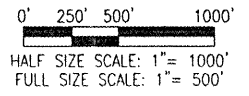

| | |
|----------|--|
| BY | |
| | |
| REVISION | |
| | |
| DATE | |

COLES COUNTY AIRPORT AUTHORITY
COLES COUNTY MEMORIAL AIRPORT
A.I.P. PROJ.: 3-17-0666-822
IL PROJ.: MTO-3831

Hanson Project No. 08A0147D.0800
Filename: R-172FEN.DWG
Scale: 1"=500'
Date: 08/04/08

| | | |
|----------|-----|----------|
| LAYOUT | CAH | 08/04/08 |
| DRAWN | BAK | 08/04/08 |
| REVIEWED | CAH | 01/07/09 |



PERIMETER FENCE INSTALLATION

PROPOSED FENCING PLAN

6

FEB 06, 2009 10:46 AM HAGL000362
D:\PROJECTS\COLES\08A0147\AIRPORT\1\08A0147\PROPOSED\SHEETS\R-172FEN.DWG - Layout1