

NOTES

- CONTRACTOR SHALL FIELD VERIFY EXISTING UNDERDRAIN INVERTS BEFORE INSTALLING NEW UNDERDRAIN CONNECTIONS.
- ALL UNDERDRAIN CONNECTIONS, CORING INTO STRUCTURES, TEES, BENDS, ETC. SHALL BE CONSIDERED INCIDENTAL TO THE COST OF THE UNDERDRAIN.
- UNDERDRAIN SLOPES FOLLOW EDGE OF PAVEMENT SLOPE UNLESS OTHERWISE NOTED.
- INSTALL NEW ELECTRICAL DUCTS/CONDUITS TO BE CLEAR OF UNDERDRAIN, COST INCIDENTAL.
- UNDERDRAIN CONFLICTS WITH EXISTING CONDITIONS SHALL BE RESOLVED AND COST SHALL BE INCIDENTAL TO UNDERDRAIN.
- REMOVAL OF EXISTING STORM SEWER MANHOLE/INLET CONCRETE BENCHES, CORING AND CONCRETE COLLARS TO FACILITATE CONNECTIONS OF NEW STORM SEWER PIPE SHALL BE CONSIDERED INCIDENTAL TO THE COST OF THE PIPE.
- IN AREAS WHERE UNDERDRAIN AND/OR STORM SEWER PIPE BEING REMOVED IS BELOW LIMITS OF PROPOSED PAVEMENTS, TRENCH SHALL BE BACKFILLED WITH COMPACTED CRUSHED AGGREGATE BACKFILL (208). COST OF BACKFILLING SHALL BE INCIDENTAL TO THE COST OF THE PIPE REMOVAL.

LEGEND

- NEW 10" PCC PAVEMENT
- PCC PAVEMENT REMOVAL
- NEW BITUMINOUS PAVEMENT
- BITUMINOUS PAVEMENT REMOVAL
- NEW MANHOLE
- NEW SLOPE BOX
- NEW STORM SEWER
- NEW UNDERDRAIN
- NEW UNDERDRAIN COLLECTION STRUCTURE
- EXISTING STORM SEWER
- EXISTING MANHOLE/INLET/SLOPE BOX
- EXISTING SANITARY SEWER
- EXISTING UNDERDRAIN
- EXISTING HEADWALL
- ITEM TO BE REMOVED
- ITEM TO BE RELOCATED
- ITEM TO BE ADJUSTED/RECONSTRUCTED

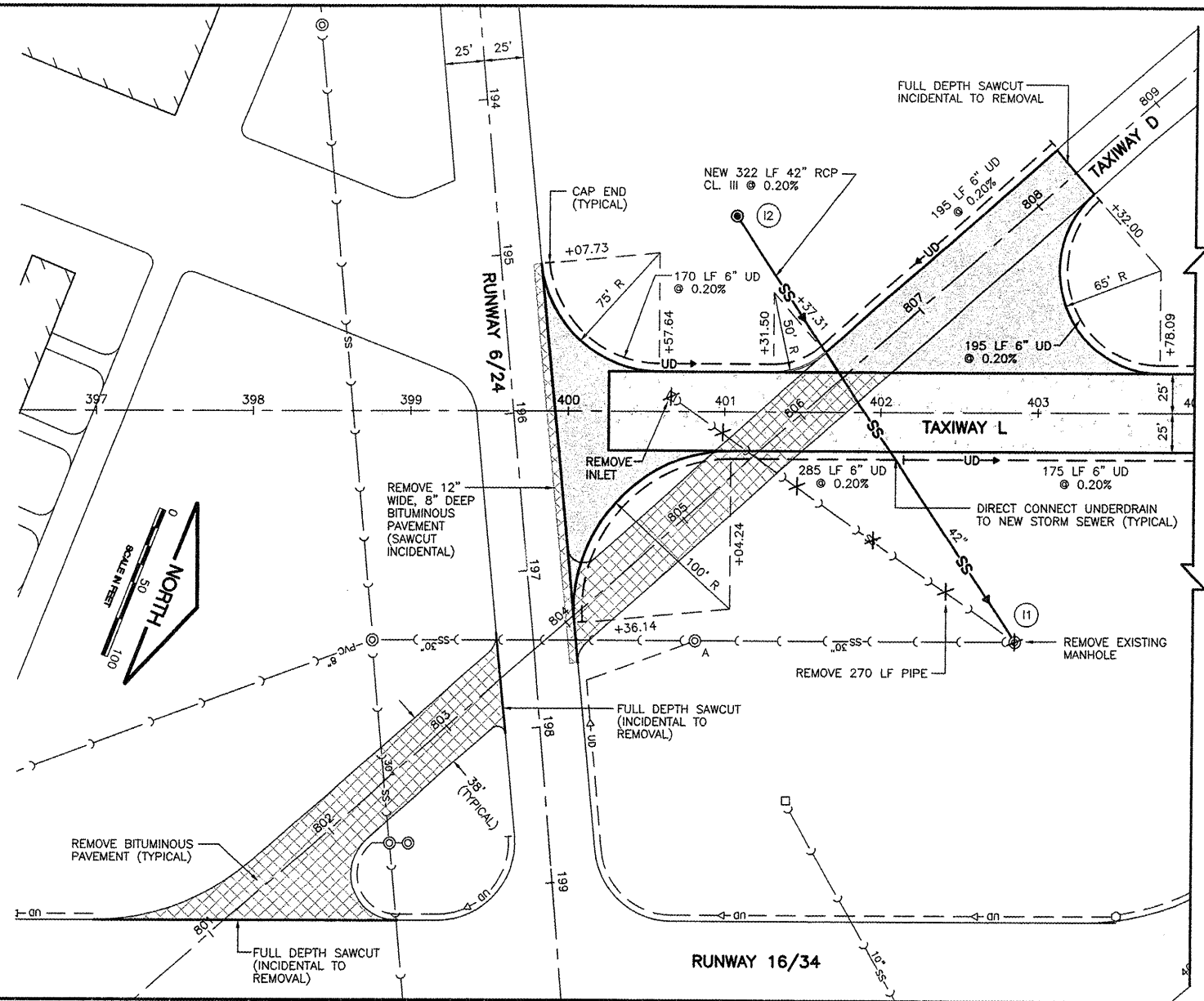

PA050

R:\P\air\062907 Extend Txy L\Draw\Sheets\FILE: txy-pp1.dwg
 LAYOUT: Layout1
 UPDATE BY: mkatz
 SURVEY BOOK #
 DATE: Fri 6/30/06 6:58am
 XREF DWG: tbcInt.dwg
 tb.dwg
 tbrpfgrd.dwg
 rcpf002.dwg
 taxiway-base.dwg

REVISIONS

NUMBER	BY	DATE

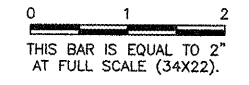

CHICAGO EXECUTIVE AIRPORT
WHEELING/PROSPECT HEIGHTS, ILLINOIS
PLAN AND PROFILE
TAXIWAY L
STA. 393+00 TO STA. 404+00

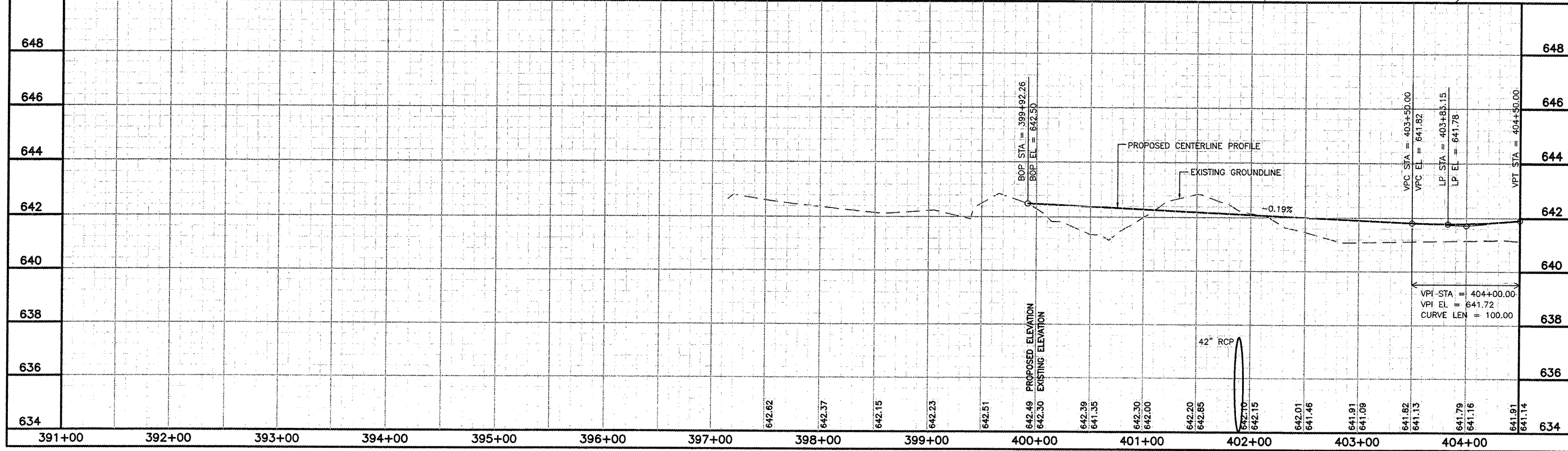

© Copyright CMT, Inc.
CMT
 CRAWFORD, MURPHY & TILLY, INC.
 CONSULTING ENGINEERS
 License No. 184-000618

DESIGN BY:	MJS
DRAWN BY:	JRO
CHECKED BY:	
APPROVED BY:	
DATE:	11/21/08
JOB No:	06290-07
ILLINOIS PROJECT:	PWK-3613
A.I.P. PROJECT:	3-17-0018-B39
SHEET	12 OF 40 SHEETS