

K:\Pawka\0629007 Extend Try L\Draw\Sheets\FILE: by-lighting-1.dwg  
LAYOUT: Layout1  
UPDATE BY: mkatz  
SURVEY BOOK #  
DATE: Mon 11/17/08 12:54pm  
XREF DWG: tbcInt.dwg  
tb.dwg  
taxiway-base.dwg

SEE SHEET 25 FOR NOTES

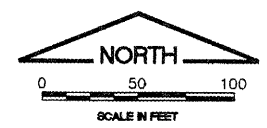

**LEGEND**

- AIRPORT PROPERTY LINE
- x- EXISTING FENCE LINE
- ▣ EXISTING MITL
- ▩ EXISTING TAXI GUIDANCE SIGN
- ▬ EXISTING DUCT
- ▬ NEW TAXI GUIDANCE SIGN
- ▬ NEW 1/C #8 5KV CABLE IN 2" PVC DUCT
- ▣ NEW ELECTRICAL HANDHOLE
- ▬ NEW DUCT, SIZE AS SHOWN
- NEW RETROREFLECTIVE MARKER
- EXISTING PAVEMENT MARKING
- NEW PAVEMENT MARKING
- x- EXISTING GATE
- x- ITEM TO BE REMOVED

**REVISIONS**

NUMBER	BY	DATE

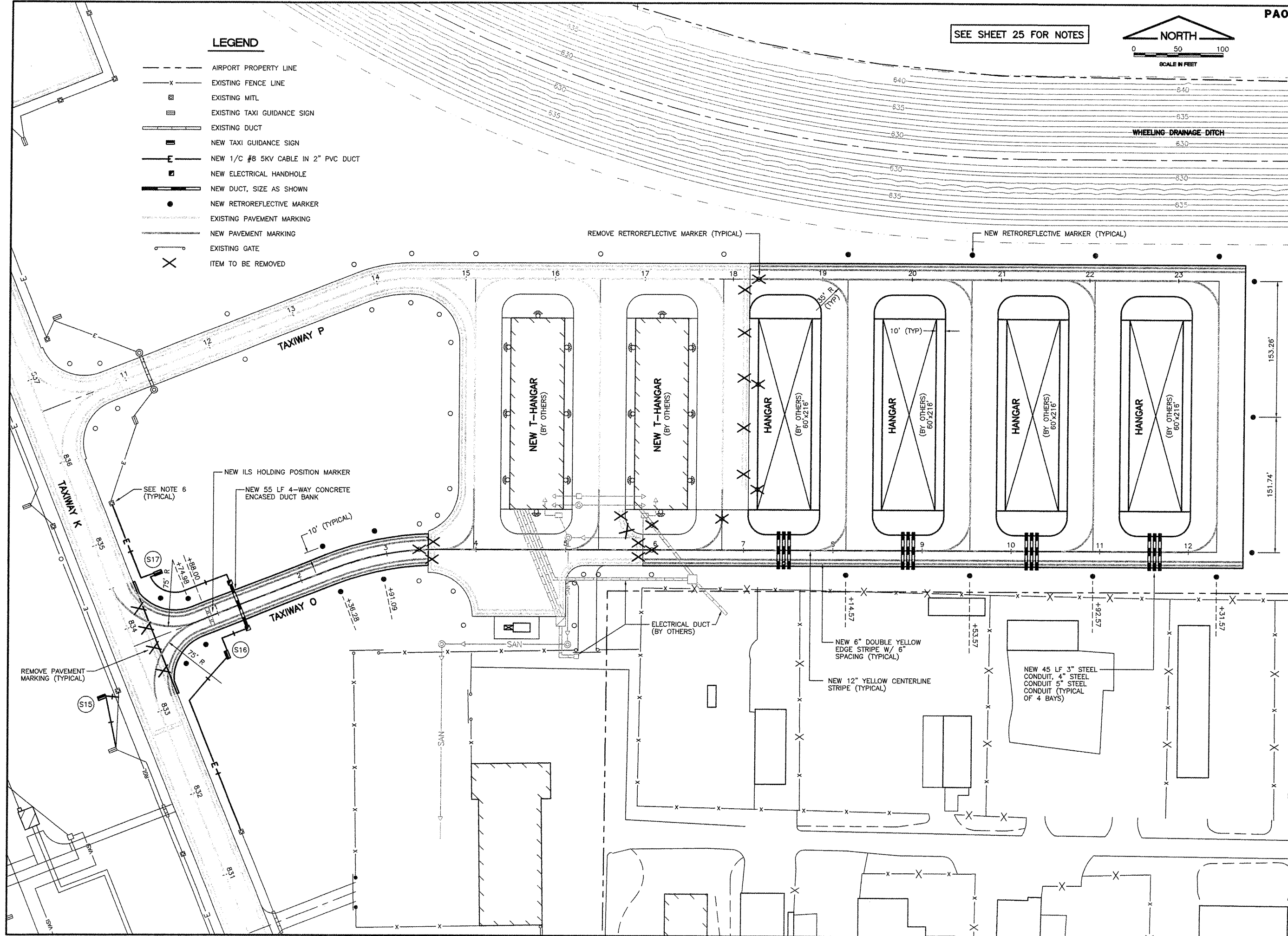
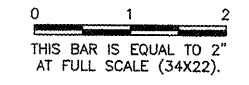

**CHICAGO EXECUTIVE AIRPORT  
WHEELING/PROSPECT HEIGHTS, ILLINOIS**

**LIGHTING AND PAVEMENT MARKING PLAN  
NORTHEAST QUADRANT**

**CMT**  
CRAWFORD, MURPHY & TILLY, INC.  
CONSULTING ENGINEERS  
License No. 784-000613



DESIGN BY:	MJS
DRAWN BY:	JRO
CHECKED BY:	
APPROVED BY:	
DATE:	11/21/08
JOB No:	06290-07
ILLINOIS PROJECT:	PWK-3613
A.I.P. PROJECT:	3-17-0018-B39
SHEET	28 OF 40 SHEETS