

PE089

REVISIONS

NUMBER	BY	DATE

0 1 2  
 THIS BAR IS EQUAL TO 2"  
 AT FULL SCALE (34X22).  
 PLOT 1

GENERAL WAYNE A. DOWNING  
 PEORIA INTERNATIONAL AIRPORT

CONSTRUCT NEW PERIMETER ROAD AND  
 PERIMETER FENCE - PROJECT 3

**CMT**  
 CRAWFORD, MURPHY & TILLY, INC.  
 CONSULTING ENGINEERS  
 License No. 184-00618

IL PROJECT: PIA-3865  
 AIP PROJ: 3-17-0080-XX

FILE: FENCE\_PLAN10  
 DESIGN BY: TJH/SMS  
 DRAWN BY: CMT  
 CHECKED BY: CET  
 APPROVED BY: CET  
 DATE: 02-13-2009  
 JOB No: 07061-04-00

SOUTH FENCE PLAN  
 SHEET 4 OF 10  
 SHEET 63 OF 151 SHEETS

N: 1453220.21  
 E: 2429183.00

N: 1453098.14  
 E: 2429341.11

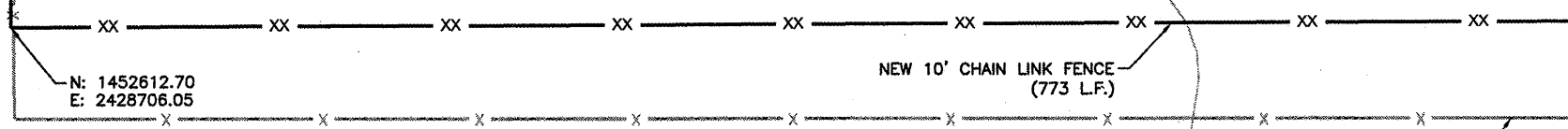

NEW 10' CHAIN LINK FENCE  
 (773 L.F.)

EXISTING FENCE  
 TO BE REMOVED

REMOVE EXISTING 20' DOUBLE SWING  
 GATE INSTALL NEW 20' x 10' DOUBLE  
 SWING GATE

NEW 10' CHAIN LINK FENCE  
 (200 L.F.) EXCLUDING SWING GATES

REMOVE EXISTING 4' SWING  
 GATE

CONTRACTOR SHALL COORDINATE WORK IN  
 THIS AREA WITH TENANT THROUGH RESIDENT  
 ENGINEER. WORK SHALL BE EXPEDITED TO  
 MINIMIZE IMPACT ON TENANT OPERATIONS.

CARGO  
 BUILDING 2  
 EXPANSION

CARGO  
 BUILDING 2

GATE 10  
 REMOVE EXISTING 24' SLIDE GATE  
 AND INSTALL NEW 24' SLIDE GATE

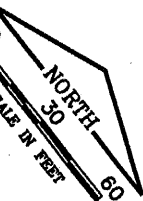

LEGEND

- X — EXISTING CHAIN LINK FENCE TO BE REMOVED
- XX — EXISTING CHAIN LINK FENCE TO REMAIN
- XX — NEW 10' CHAIN LINK FENCE

NOTES:

1. WHERE NEW FENCE IS TO BE INSTALLED ALONG THE SAME LAYOUT OF EXISTING FENCE IT SHALL BE OFFSET 1' TOWARD THE LANDSIDE, UNLESS OTHERWISE NOTED.
2. WHEN CONNECTING TO EXISTING FENCE, THE CONTRACTOR MUST GUARD THE FENCE SO THAT NO UNAUTHORIZED ACCESS IS ALLOWED.

EXISTING FENCE TO BE REMOVED AND  
 REPLACED IN SAME ALIGNMENT WITH NEW 10'  
 CHAIN LINK FENCE—SEE REQUIREMENTS FOR  
 MAINTAINING AIRPORT PERIMETER FENCING.

K:\Peoria\07061-04-00\Draw\Sheets\1\_West\_South\_Fence\Phase 3 Sheets  
 FILE: FENCE\_PLAN10.dwg  
 DATE: 2/12/2009 10:04 AM