

PE089

REVISIONS		
NUMBER	BY	DATE

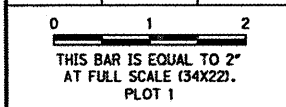

LEGEND

- EXISTING CHAIN LINK FENCE TO BE REMOVED
- EXISTING CHAIN LINK FENCE TO REMAIN
- NEW 10' CHAIN LINK FENCE
- NEW 12" CRUSHED AGGREGATE OVER SEPARATION FABRIC

NOTES:

1. WHERE NEW FENCE IS TO BE INSTALLED ALONG THE SAME LAYOUT OF EXISTING FENCE IT SHALL BE OFFSET 1' TOWARD THE LANDSIDE, UNLESS OTHERWISE NOTED.
2. WHEN CONNECTING TO EXISTING FENCE, THE CONTRACTOR MUST GUARD THE FENCE SO THAT NO UNAUTHORIZED ACCESS IS ALLOWED.

EXISTING FENCE TO BE REMOVED AND REPLACED IN NEW ALIGNMENT AS SHOWN

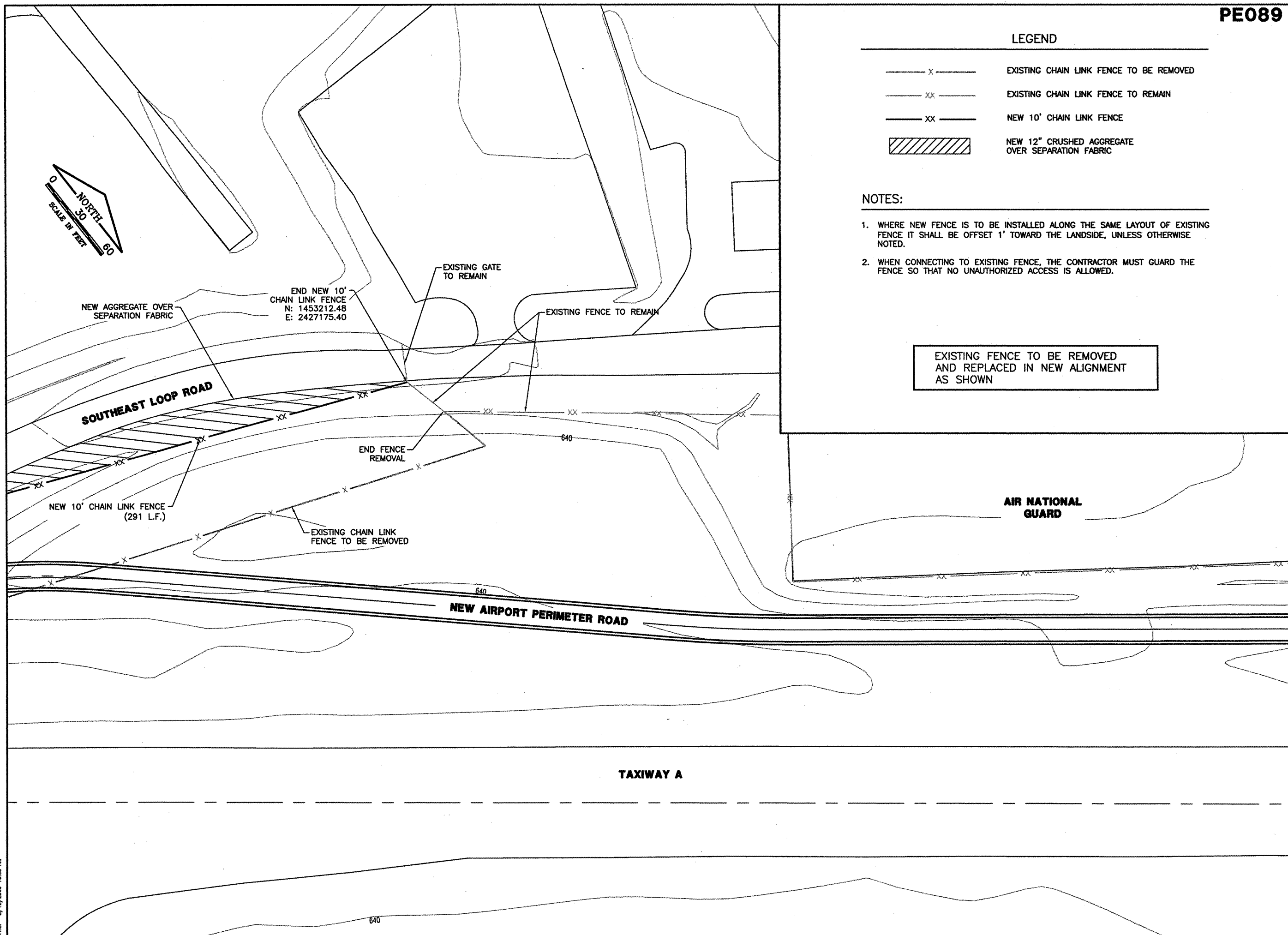

GENERAL WAYNE A. DOWNING
PEORIA INTERNATIONAL AIRPORT

CONSTRUCT NEW PERIMETER ROAD AND PERIMETER FENCE - PROJECT 3

© Copyright CMT, Inc.

CMT
CRAWFORD, MURPHY & TILLY, INC.
CONSULTING ENGINEERS
License No. 184-000613

IL PROJECT: PIA-3865
AIP PROJ: 3-17-0080-XX

FILE:	FENCE_PLAN16
DESIGN BY:	TJH/SMS
DRAWN BY:	CMT
CHECKED BY:	CET
APPROVED BY:	CET
DATE:	02-13-2009
JOB No:	07061-04-00

SOUTH FENCE PLAN
SHEET 10 OF 10

SHEET 69 OF 151 SHEETS

K:\Peoria\PIA\07061\Draw\Sheets\1_West_South_Fence\Phase 3_Sheets
FILE: FENCE_PLAN16.dwg
DATE: 2/12/2009 10:09 AM