

INDEX OF SHEETS

1. COVER SHEET
2. JOB SPECIFIC NOTES & COMMITMENTS
3. SUMMARY OF QUANTITIES
4. LINE DIAGRAM
5. TYPICAL SECTION
6. SCHEDULE OF QUANTITIES
- 7-8. TYPICAL PAVEMENT MARKINGS STANDARD 780001 - D4

HIGHWAY STANDARDS

- 701301-04
- 701306-03
- 701311-03
- 701901-04

STATE OF ILLINOIS
DEPARTMENT OF TRANSPORTATION
DIVISION OF HIGHWAYS
PROPOSED
HIGHWAY PLANS

F.A.P. ROUTE 705 (IL 122)
SECTION (M-15)RS

CONTRACT MAINTENANCE
TAZEWELL COUNTY

C-94-033-15



R 7 W

IMPROVEMENT ENDS
STA. 237+05

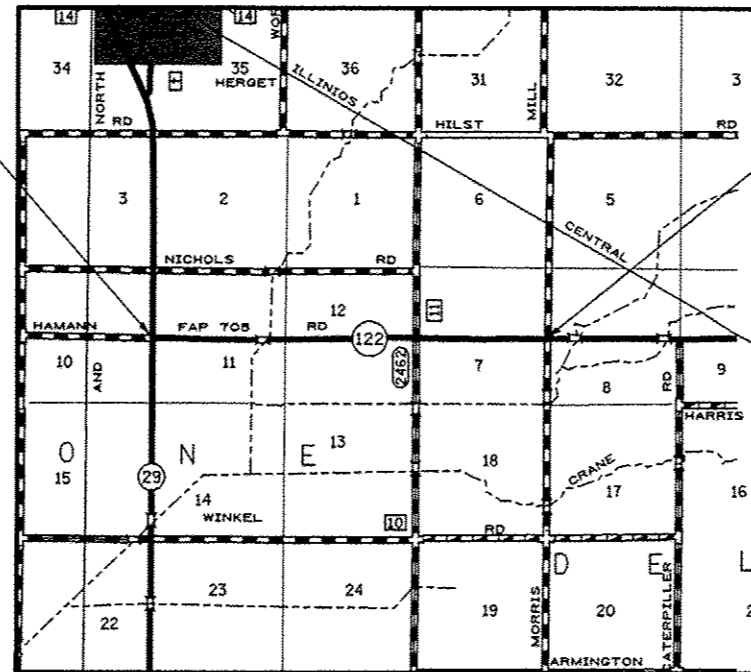

IMPROVEMENT BEGINS
STA. 82+60

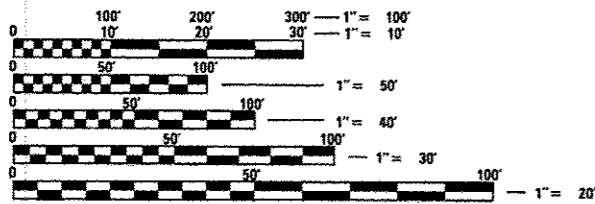

FULL SIZE PLANS HAVE BEEN PREPARED USING STANDARD ENGINEERING SCALES. REDUCED SIZED PLANS WILL NOT CONFORM TO STANDARD SCALES. IN MAKING MEASUREMENTS ON REDUCED PLANS, THE ABOVE SCALES MAY BE USED.

J.U.L.I.E.
 JOINT UTILITY LOCATION INFORMATION FOR EXCAVATION
 1-800-892-0123
 OR 811

PROJECT ENGINEER MIKE LEWIS (309) 671-3454
PROJECT MANAGER RAYMOND SAMARA (309) 671-3459
 CATALOG NO. 035218-00D
CONTRACT NO. 68C42

GROSS LENGTH = 15,445 FT. = 2.92 MILE
 NET LENGTH = 15,445 FT. = 2.92 MILE

F.A.P. RTE.	SECTION	COUNTY	TOTAL SHEETS	SHEET NO.
705	(M-15)RS	TAZEWELL	8	1
		ILLINOIS	CONTRACT NO. 68C42	

D-94-023-15

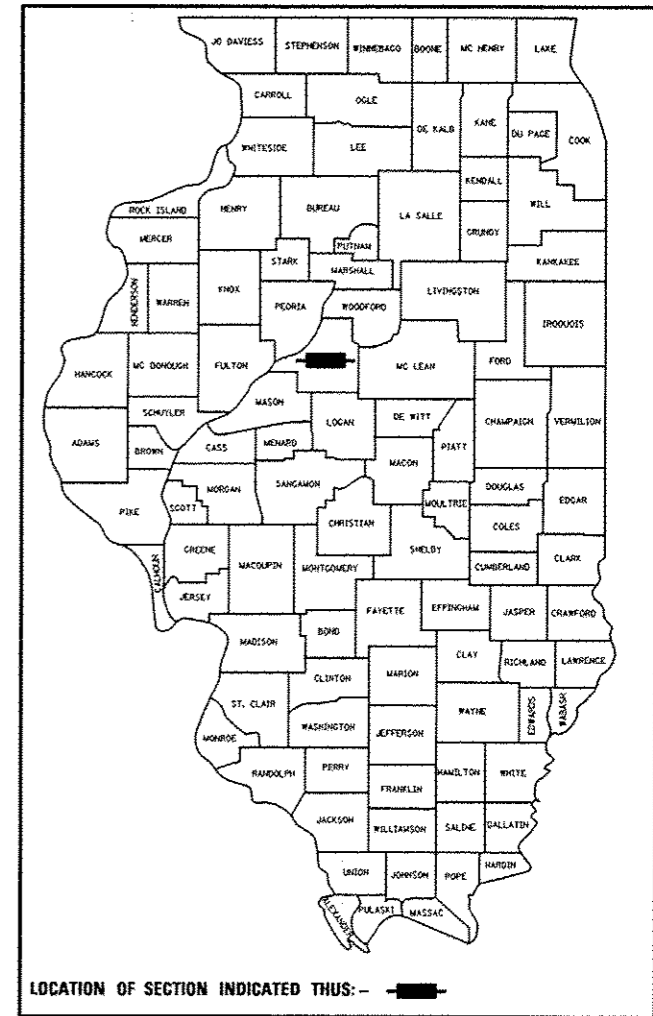

DESCRIPTION:
 CAPE SEAL ON IL 122 FROM IL 29 TO MORRIS MILL ROAD, 2 MILES WEST OF DELAVAN

STATE OF ILLINOIS
 DEPARTMENT OF TRANSPORTATION
 DIVISION OF HIGHWAYS

SUBMITTED Dec 5 20 14
Kenneth A. Bennett
 DEPUTY DIRECTOR OF HIGHWAYS, REGION ENGINEER

Jan 30 20 15
John D. Baranzelli, P.E.
 ENGINEER OF DESIGN AND ENVIRONMENT

Jan 30 20 15
Omer Osman, P.E.
 DIRECTOR OF HIGHWAYS, CHIEF ENGINEER

PRINTED BY THE AUTHORITY
OF THE STATE OF ILLINOIS

JOB SPECIFIC NOTES

NO PASSING ZONE VERIFICATION

THE RESIDENT SHALL CONTACT OPERATIONS TO VERIFY THE LOCATION OF NO PASSING ZONES PRIOR TO PLACEMENT OF CENTERLINE STRIPING.

SURFACE TESTS APPLICATION

SMOOTHNESS TESTS ON THE COMPLETED SURFACE WILL NOT BE REQUIRED; BUT THE ENGINEER RESERVES THE RIGHT TO REQUIRE CORRECTIVE MEASURES WHEN OBVIOUS SURFACE VARIATIONS ARE PRESENT.

CAPE SEAL TREATMENT

THE MATERIALS FOR THE A-1 SURFACE SHALL BE CA 20.
 THE MICRO-SURFACING APPLICATION SHALL BE SINGLE PASS, TYPE II, 24 LB./SQ. YD.
 THE AGGREGATE FOR THE MICROSURFACING SHALL MEET THE FRICTION AGGREGATE REQUIREMENTS FOR THE MIXTURE C IN ARTICLE 1004.03 (d)

EXISTING PAVEMENT MARKINGS

THE EXISTING PAVEMENT MARKINGS AND RAISED REFLECTIVE PAVEMENT MARKERS SHALL BE REMOVED PRIOR TO THE CAPE SEAL APPLICATION. THE HOLE RESULTING FROM THE REMOVAL SHALL BE FILLED WITH COLD MIXED MATERIAL (UPM). THIS WORK SHALL BE INCLUDED IN THE COST OF THE "RAISED REFLECTIVE PAVEMENT MARKER REMOVAL"

STATIONING

THE EXISTING ROADWAY STATIONS SHALL BE COVERED PRIOR TO THE CAPE SEAL APPLICATIONS. THE COVER SHALL BE REMOVED AFTER WORK IS COMPLETED. THIS WORK SHALL BE INCLUDED IN THE COST OF THE "CAPE SEAL".

COMMITMENTS:

NO COMMITMENTS HAVE BEEN MADE FOR THIS PROJECT.

FILE NAME = 0468C42-10po.dgn	USER NAME = abuhannaw	DESIGNED -	REVISED -	STATE OF ILLINOIS DEPARTMENT OF TRANSPORTATION	JOB SPECIFIC NOTES & COMMITMENTS	F.A.P. RTE.	SECTION	COUNTY	TOTAL SHEETS	SHEET NO.	
Default	PLOT SCALE = 48.0000 ' / in.	DRAWN -	REVISED -			705	GM-15IRS	TAZEWELL	8	2	
	PLOT DATE = 11/19/2014	CHECKED -	REVISED -			SCALE: SHEET 1 OF 1 SHEETS STA. TO STA.		CONTRACT NO. 68C42			
		DATE -	REVISED -			ILLINOIS FED. AID PROJECT					

CODE NO.	ITEM	UNIT	TOTAL QUANTITY	CONST. CODE	
				RURAL	TAZEWELL
			100% STATE	0005	
67100100	MOBILIZATION	L SUM	1	1	
70100460	TRAFFIC CONTROL AND PROTECTION, STANDARD 701306	L SUM	1	1	
70300100	SHORT-TERM PAVEMENT MARKING	FOOT	1545	1545	
70300220	TEMPORARY PAVEMENT MARKING - LINE 4"	FOOT	34819	34819	
70301000	WORK ZONE PAVEMENT MARKING REMOVAL	SQ FT	515	515	
* 78009004	MODIFIED URETHANE PAVEMENT MARKING - LINE 4"	FOOT	34819	34819	
78300200	RAISED REFLECTIVE PAVEMENT MARKER REMOVAL	EACH	146	146	
X7810400	TEMPORARY RAISED PAVEMENT MARKER	EACH	772	772	
Z0064265	CAPE SEAL	SQ YD	41187	41187	

* SPECIALTY ITEM

FILE NAME *
046042-topo.dgn

USER NAME = abuhannaw
PLOT SCALE = 48.1825' / 1" = 1" = 48.1825'
PLOT DATE = 11/17/2014

DESIGNED -
DRAWN -
CHECKED -
DATE -

REVISED -
REVISED -
REVISED -
REVISED -

STATE OF ILLINOIS
DEPARTMENT OF TRANSPORTATION

SUMMARY OF QUANTITIES

F.A.P. RTE.	SECTION	COUNTY	TOTAL SHEETS	SHEET NO.
705	04-151RS	TAZEWELL	8	3
CONTRACT NO. 68C42				
ILLINOIS FEED AID PROJECT				

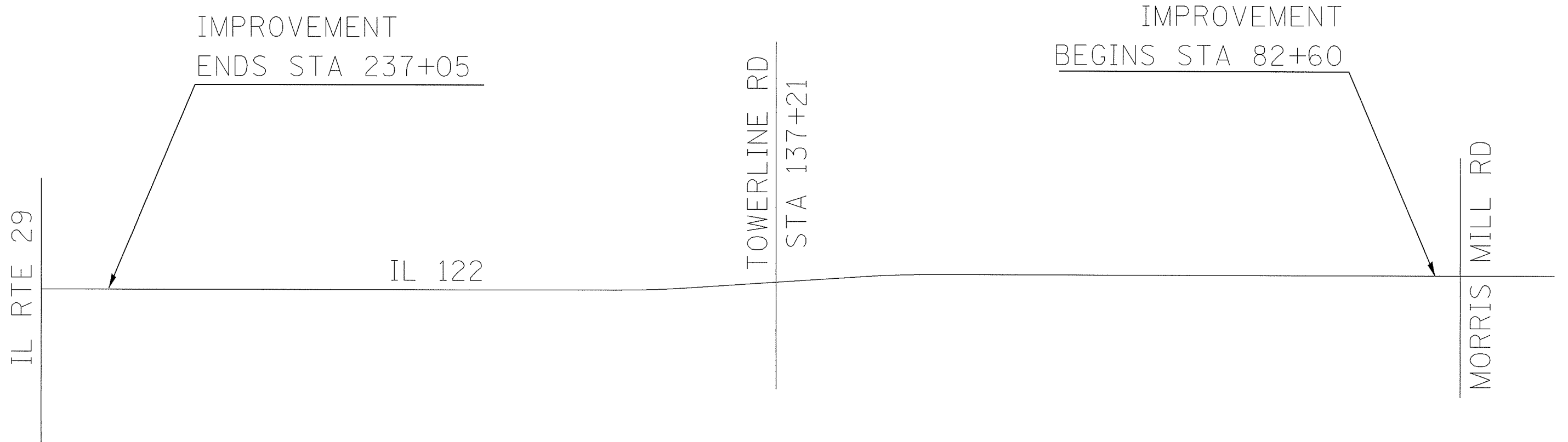

FILE NAME = D468C42-topo.dgn Default	USER NAME = abuhennaw	DESIGNED -	REVISED -	STATE OF ILLINOIS DEPARTMENT OF TRANSPORTATION	LINE DIAGRAM				F.A.P. RTE. 705	SECTION (M-15)RS	COUNTY TAZEWELL	TOTAL SHEETS 8	SHEET NO. 4
	PLOT SCALE = 40.1826' / in.	CHECKED -	REVISED -						CONTRACT NO. 68C42				
	PLOT DATE = 11/17/2014	DATE -	REVISED -		SCALE:	SHEET 1	OF 1	SHEETS	STA.	TO STA.	ILLINOIS FED. AID PROJECT		

LEGEND

- Ⓐ EXISTING AGGREGATE SHOULDER
- Ⓑ EXISTING PAVEMENT & OVERLAY
- Ⓒ PROPOSED CAPE SEAL

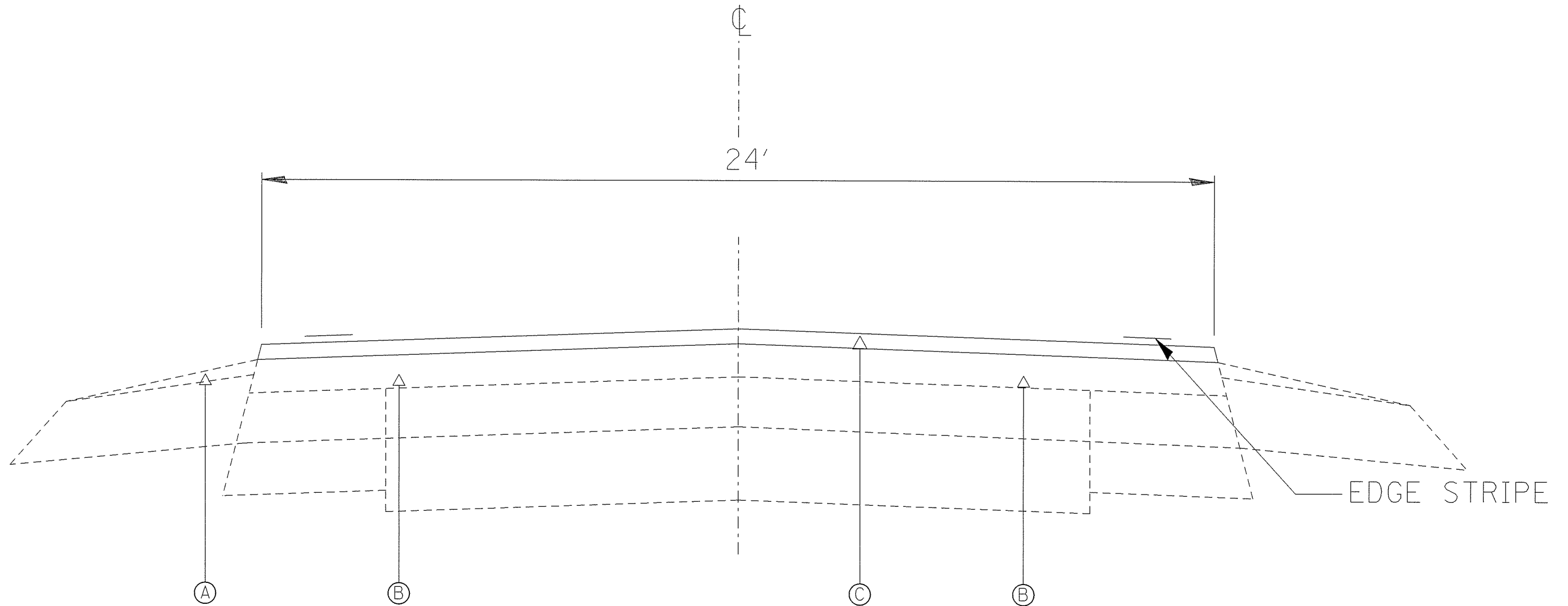

STA 82+60 TO STA 237+05

FILE NAME = D468C42-topo.dgn	USER NAME = abuhannan	DESIGNED -	REVISED -	STATE OF ILLINOIS DEPARTMENT OF TRANSPORTATION	TYPICAL SECTION			F.A.P. RTE.	SECTION	COUNTY	TOTAL SHEETS	SHEET NO.
	PLOT SCALE = 40.0000' / 1"	CHECKED -	REVISED -					705	(M-15)RS	TAZEWELL	8	5
Default	PLOT DATE = 11/19/2014	DATE -	REVISED -	SCALE: SHEET 1 OF 1 SHEETS STA. TO STA.			ILLINOIS FED. AID PROJECT CONTRACT NO. 68C42					

LOCATION				TEMPORARY PAVEMENT MARKING - LINE 4"	MODIFIED URITHANE PAVEMENT MARKING - LINE 4"	RAISED REF PAV MARKERS REMOVAL
LT/RT	STA	TO	STA	FT	FT	EACH
	82+60	-	237+05			146
WHITE EDGE LINE						
LT	82+45	-	237+20	15475	15475	
RT	82+45	-	237+20	15475	15475	
YELLOW (SKIP DASH)						
	82+45	-	237+20	3869	3869	
TOTAL				34819	34819	146

CAPE SEAL					
STA	TO	STA	LENGTH	WIDTH	AREA
			FT	FT	SQ YD
82+60	-	237+05	15445	24	41187
TOTAL					41187

SHORT TERM PAVEMENT MARKING			
STA	TO	STA	LENGTH
			FOOT
82+60	-	237+05	1545
TOTAL			1545

MOBILIZATION	
LOCATION	L SUM
JOBSITE	1
TOTAL	1

WORK ZONE PAVEMENT MARKING REMOVAL				
STA	TO	STA	LENGTH	AREA
			FOOT	SQ FT
82+60	-	237+05	1545	515
TOTAL				515

TRAFFIC CONTROL AND PROTECTION, STANDARD 701306	
LOCATION	L SUM
JOBSITE	1
TOTAL	1

TEMPORARY RAISED PAVEMENT MARKER				
STA	TO	STA	LENGTH	EACH
82+60	-	237+05	15445	772
TOTAL				772

DESIGNER NOTES:
1. Include State Standard 780001 (Typical Pavement Markings)

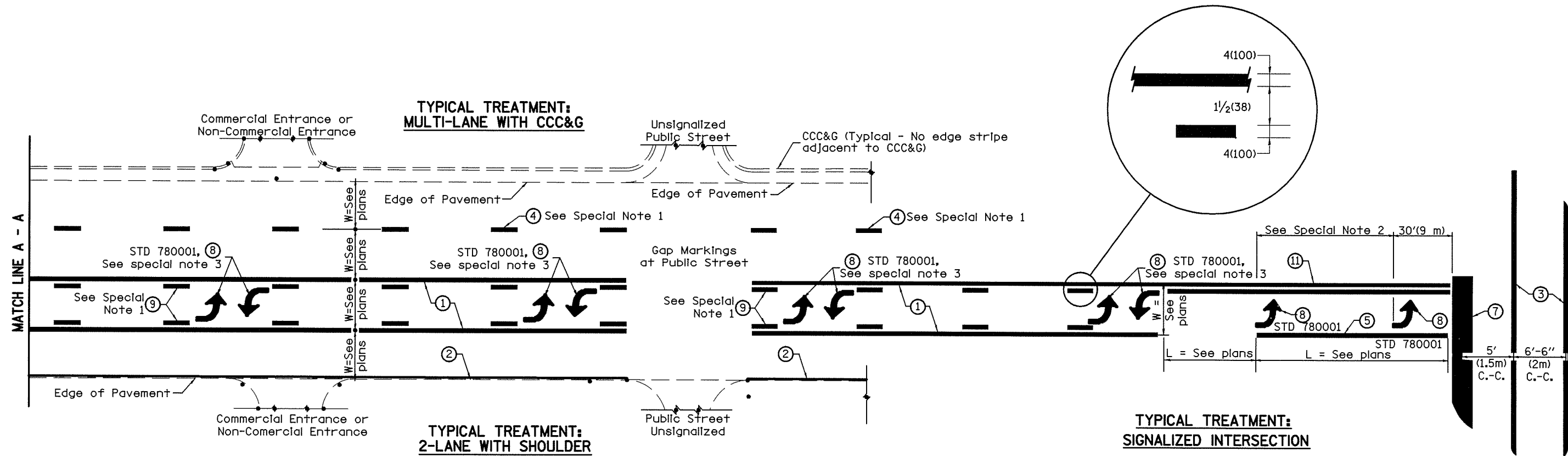

FLUSH PAVED MEDIAN: TWO-WAY LEFT TURN LANE WITH ONE-WAY LEFT TURN LANE AT SIGNALIZED INTERSECTION

TYPICAL PAVEMENT MARKING LEGEND

(Note: This is a District Standard Legend. Some elements may not apply to specific project.)

- ① 4(100) Solid (Yellow)
- ② 4(100) Solid (White)
- ③ 2-6(150) Crosswalk @ 6'-6" (2m)min C.-C. (White)
2-8(200) Crosswalk @ 6'-6" (2m)min C.-C. (White) (When traffic signals are present.)
- ④ 6(150) Skip-Dash (White) (See Special Note 1)
- ⑤ 8(200) Solid (White)
- ⑥ 12(300) Diagonal (White) (Item ⑥ is shown on Std. 780001)
- ⑦ 24(600) Stop Bar (White)
- ⑧ Letters & Arrows (See Std. 780001 and Special Notes 2 & 3)
- ⑨ 4(100) Skip-Dash (Yellow) (See Special Note 1)
- ⑩ 12(300) Diagonal (Yellow) (See Table A)
- ⑪ 4(100) Double Solid (Yellow) (See Table A)

SPECIAL NOTES

1. Skip-Dash markings will be centered between both ends of city blocks and shall be placed in alignment transversely across the pavement.
2. The following shall apply to arrows located in one-way left turn lanes:
 - A. A minimum of two (2) arrows is required.
 - B. The maximum spacing between arrows is 80' (24 m).
 - C. Arrows shall be evenly spaced if three (3) or more are required.
3. The following shall apply to arrow pairs located in two-way left turn lanes:
 - A. A minimum of two (2) arrow pairs is required.
 - B. The maximum spacing between arrow pairs is 200' (61 m).
 - C. Arrow pairs shall be evenly spaced if three (3) or more are required.
 - D. The spacing between Bi Directional Left Turn Arrows is 33' (10 m).

GENERAL NOTES

1. Refer to State Standard 780001 for additional Pavement Markings including letters & arrows.
2. See Plans for Pavement Markings adjacent to curbed islands and medians, and through lane reductions.

01-01-97	RENUM. F-8.03, NEW REVISION BOX	T.P.	10-16-06	REVISED TO 2007 SPEC.	STATE OF ILLINOIS DEPARTMENT OF TRANSPORTATION	TYPICAL PAVEMENT MARKINGS	F.A.P. RTE.	SECTION	COUNTY	TOTAL SHEETS	SHEET NO.
02-07-97	ADD BI DIRECTIONAL DIMENSION	J.A.					705	(M-15)RS	TAZEWELL	8	7
10-97	CORRECT BI DIRECTIONAL DIMENSION	J.A.									
08-02	ADD CROSSWALK DIMS. WITH T.S.	M.A.									
NOT TO SCALE						SHT. 1 OF 2 CADD STD. 780001-D4		CONTRACT NO. 68C42 FED. ROAD DIST. NO. ILLINOIS FED. AID PROJECT			

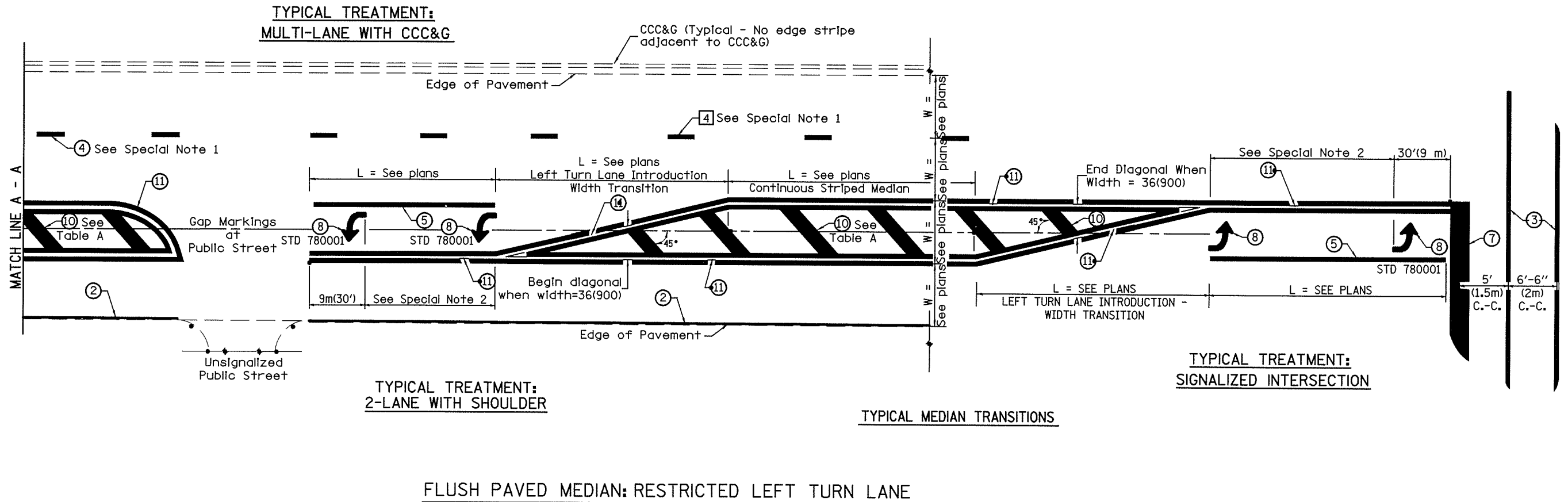

TYPICAL MEDIAN TRANSITIONS

FLUSH PAVED MEDIAN: RESTRICTED LEFT TURN LANE

TABLE A
RECOMMENDED SPACING BETWEEN DIAGONAL LINES

SPEED LIMIT RANGE	INTERSECTION CHANNELIZATION (Includes Width Transitions for Median and Left Turn Lane Introductions)	
	CONTINUOUS	
Less Than 30 mph (50 km/h)	50' (15m)	15' (5m)
30 - 45 mph (50 - 70 km/h)	75' (23m)	20' (6m)
Over 45 mph (70 km/h)	150' (46m)	30' (9m)

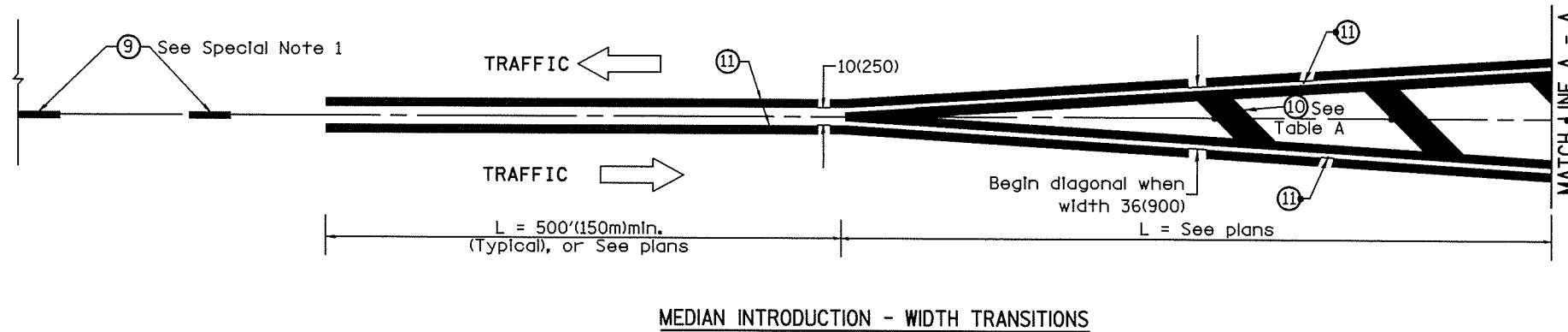

MEDIAN INTRODUCTION - WIDTH TRANSITIONS

All dimensions are in Inches (millimeters) unless otherwise noted.