

STATE OF ILLINOIS
DEPARTMENT OF TRANSPORTATION
DIVISION OF HIGHWAYS

**PROPOSED
HIGHWAY PLANS**

F.A.P. ROUTE 781 (IL. RTE. 33)
SECTION D7 HMA RESURF 2015-6

RESURFACING
LAWRENCE COUNTY

C-97-088-14

FOR INDEX OF SHEETS, SEE SHEET NO. 2

ADT = 900 (2011)

F.A.P. RTE.	SECTION	COUNTY	TOTAL SHEETS	SHEET NO.
781	D7 HMA RESURF 2015-6	LAWRENCE	7	1
		ILLINOIS	CONTRACT NO. 74682	

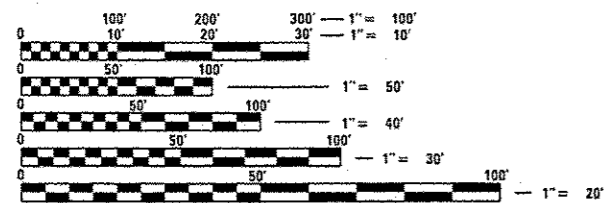
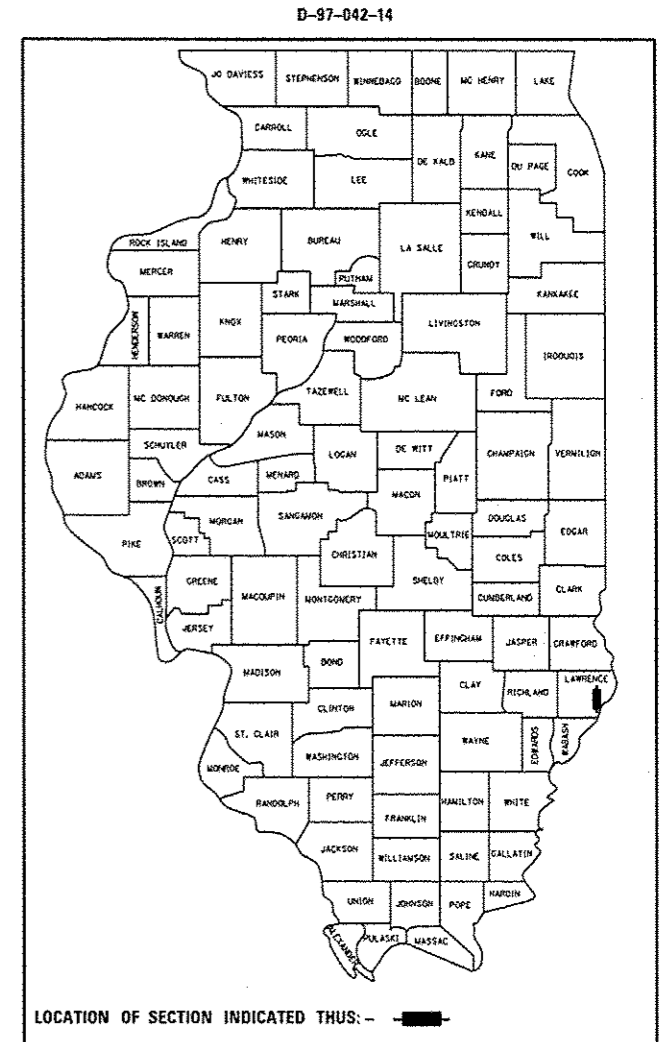

FULL SIZE PLANS HAVE BEEN PREPARED USING STANDARD ENGINEERING SCALES. REDUCED SIZED PLANS WILL NOT CONFORM TO STANDARD SCALES. IN MAKING MEASUREMENTS ON REDUCED PLANS, THE ABOVE SCALES MAY BE USED.

J.U.L.I.E.
JOINT UTILITY LOCATION INFORMATION FOR EXCAVATION
1-800-892-0123
OR 811

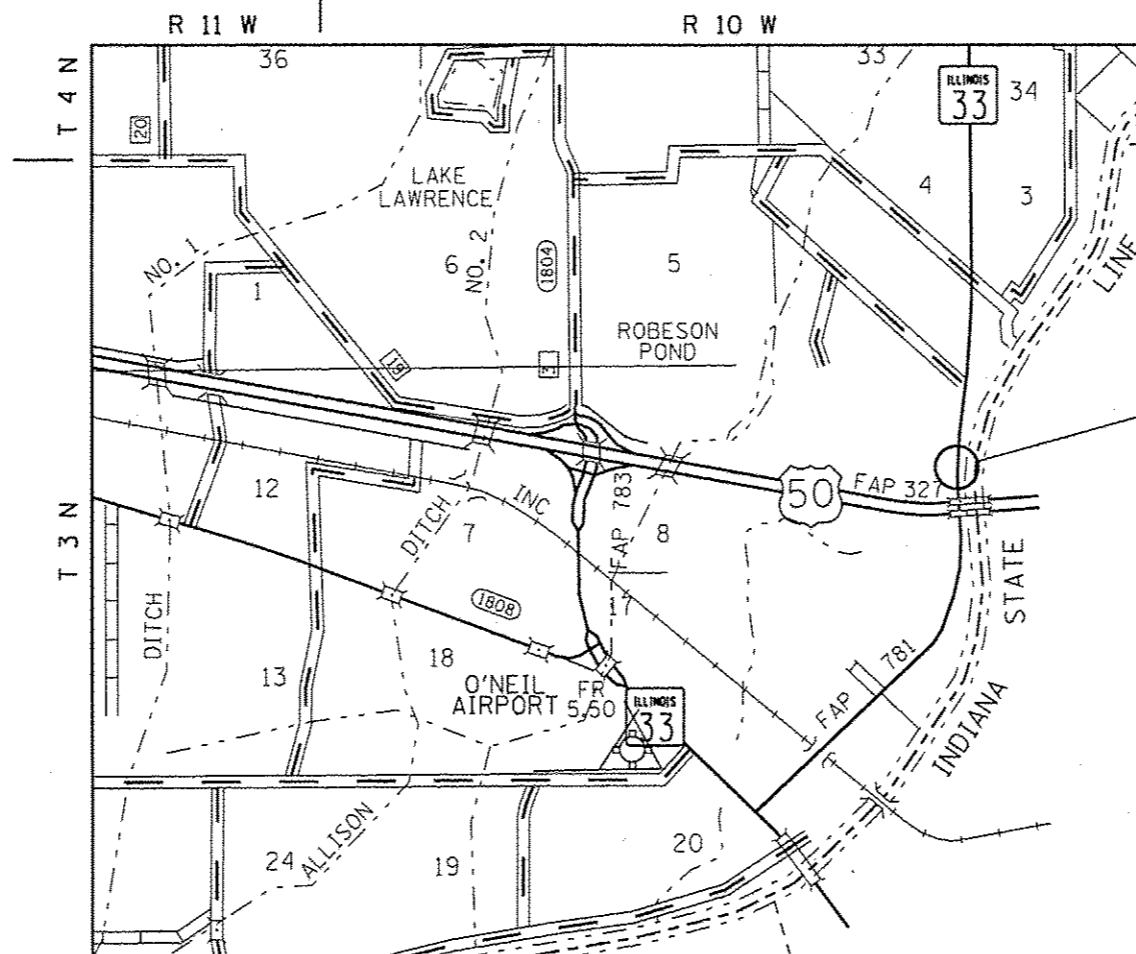

PROJECT LOCATION:
STA. 1175+00 TO STA. 1181+00

PROJECT ENGINEER: TOM RONAN
PROJECT MANAGER: TOM RONAN
PHONE: (217)-342-8320
CONTRACT NO. 74682

GROSS LENGTH = 600 FT. = 0.11 MILE
NET LENGTH = 600 FT. = 0.11 MILE

STATE OF ILLINOIS
DEPARTMENT OF TRANSPORTATION
DIVISION OF HIGHWAYS

SUBMITTED October 6 20 14
Ryan Z. Drabek
DEPUTY DIRECTOR OF HIGHWAYS, REGION ENGINEER

Jan 30 20 15
John D. Baranzelli, P.E.
ENGINEER OF DESIGN AND ENVIRONMENT

Jan 30 20 15
Omer Osman, P.E.
DIRECTOR OF HIGHWAYS, CHIEF ENGINEER

PRINTED BY THE AUTHORITY
OF THE STATE OF ILLINOIS

INDEX OF SHEETS

SHEET NO.	ITEM
1	COVER SHEET
2	INDEX OF SHEETS & GENERAL NOTES
3	SUMMARY OF QUANTITIES
4	TYPICAL SECTION
5	SCHEDULES OF QUANTITIES
6	PLAN SHEET
7	CONSTRUCTION DETAIL

THE FOLLOWING STANDARDS ARE A PART OF THESE PLANS AND ARE INCLUDED AFTER SHEET NO. 7:

STD. NO.	DESCRIPTION
000001-06	STANDARD SYMBOLS, ABBREVIATIONS AND PATTERNS
442201-03	CLASS C & D PATCHES
606101-04	TYPE A CUTTER - INLET, OUTLET, & ENTRANCE
701001-02	OFF-RD OPERATIONS, 2L, 2W, 15' MINIMUM FROM FROM PAVEMENT EDGE, 45 MPH +
701006-05	OFF-RD OPERATIONS, 2L, 2W, 15' TO 24" FROM PAVEMENT EDGE, 45 MPH +
701011-04	OFF-RD MOVING OPERATIONS, 2L, 2W, DAY ONLY, 45 MPH +
701201-04	LANE CLOSURE, 2L, 2W, DAY ONLY
701301-04	LANE CLOSURE, 2L, 2W, SHORT TIME OPERATIONS
701901-04	TRAFFIC CONTROL DEVICES
780001-05	TYPICAL PAVEMENT MARKINGS
781001-03	TYPICAL APPLICATION RAISED REFLECTIVE PAVEMENT MARKERS

GENERAL NOTES

THIS SECTION SHALL BE CONSTRUCTED IN ACCORDANCE WITH THE PLANS; THE "STANDARD SPECIFICATIONS FOR ROAD AND BRIDGE CONSTRUCTION", ADOPTED JANUARY 1, 2012; THE "SUPPLEMENTAL SPECIFICATIONS AND RECURRING SPECIAL PROVISIONS", ADOPTED JANUARY 1, 2014, AND THE SPECIAL PROVISIONS INCLUDED IN THE PROPOSAL.

THE WORK INCLUDED IN THIS SECTION IS LOCATED ON FAP ROUTE 781 (ILLINOIS ROUTE 33) IN LAWRENCE COUNTY BEGINNING 0.1 MILES NORTH OF US ROUTE 50 AND EXTENDING NORTH FOR 0.12 MILES. THE WORK INCLUDED IN THIS SECTION CONSISTS OF PAVEMENT PATCHING, HOT-MIX ASPHALT SURFACE REMOVAL, OVERLAYING WITH HOT-MIX ASPHALT SURFACE COURSE, AGGREGATE SHOULDER WEDGE, CONCRETE CUTTER REMOVAL AND REPLACEMENT, PAVEMENT MARKING, TRAFFIC CONTROL, AND ANY WORK NECESSARY TO COMPLETE THIS SECTION.

THE CONTRACTOR SHALL PROVIDE INTERNET ACCESSIBILITY TO THE HOT-MIX ASPHALT PLANT QUALITY CONTROL LAB SO THAT HOT-MIX ASPHALT PLANT REPORTS CAN BE E-MAILED TO THE DISTRICT HEADQUARTERS. THIS WORK SHALL BE INCLUDED IN THE COST OF ALL HOT-MIX ASPHALT ITEMS.

THE RESIDENT ENGINEER SHALL BE THE SOLE JUDGE CONCERNING THE CURING TIME FOR ALL HOT-MIX ASPHALT.

THE PAY ITEM TEMPORARY RAMP HAS BEEN INCLUDED FOR THE CONSTRUCTION OF TEMPORARY RAMPS IN ACCORDANCE WITH ARTICLE 406.08 OF THE STANDARD SPECIFICATIONS. THE CONTRACT UNIT PRICE PER SQUARE YARD FOR TEMPORARY RAMP SHALL INCLUDE BOTH THE INSTALLATION AND THE REMOVAL OF THE RAMPS.

ESTIMATED QUANTITIES OF CONCRETE CUTTER REMOVAL AND CONCRETE GUTTER, TYPE A HAVE BEEN INCLUDED TO REMOVE AND REPLACE DAMAGED OR SETTLED CONCRETE GUTTER. THE FINAL QUANTITIES AND LOCATIONS WILL BE DETERMINED BY THE RESIDENT ENGINEER. AN ESTIMATED QUANTITY OF SUB-BASE GRANULAR MATERIAL, TYPE B HAS BEEN INCLUDED TO BRING THE SUBGRADE, BENEATH SETTLED CUTTER THAT IS TO BE REMOVED, BACK UP TO GRADE.

GENERAL NOTES (Cont' d)

PAVEMENT MARKING SHALL BE APPLIED IN ACCORDANCE WITH SECTION 780 OF THE STANDARD SPECIFICATIONS. SHORT TERM PAVEMENT MARKING SHALL BE APPLIED TO THE MILLED SURFACE, AND HOT-MIX ASPHALT SURFACE COURSE AS SPECIFIED IN SECTION 703 OF THE STANDARD SPECIFICATIONS. TEMPORARY TAPE SHALL BE USED ON THE SURFACE COURSE AND PAINT SHALL BE USED ON MILLED SURFACES.

THE TOTAL QUANTITY OF PAINT PAVEMENT MARKING - LINE 4" CONSISTS OF 1,200 FEET OF WHITE AND 150 FEET OF YELLOW.

THE TOTAL QUANTITY OF RAISED REFLECTIVE PAVEMENT MARKERS CONSISTS OF 9 TWO-WAY AMBER MARKERS.

THE FOLLOWING MIXTURE REQUIREMENTS ARE APPLICABLE FOR THIS PROJECT:

SURFACE COURSE (1.5")

APPLICATION: HOT MIX ASPHALT SURFACE COURSE, MIX C, N70
 PG GRADE: PG 64-22
 DESIGN AIR VOIDS: 4.0% @ DESIGN = 70
 MIXTURE COMPOSITION: IL-9.5
 FRICTION AGGREGATE: MIXTURE C

BINDER COURSE (VAR. DEPTH)

APPLICATION: HOT MIX ASPHALT BINDER COURSE, IL-19, N70
 PG GRADE: PG 64-22
 DESIGN AIR VOIDS: 4.0% @ DESIGN = 70
 MIXTURE COMPOSITION: IL-19.0
 FRICTION AGGREGATE: N/A

PARTIAL DEPTH PAVEMENT PATCHING

APPLICATION: HOT MIX ASPHALT SURFACE COURSE, MIX C, N70
 PG GRADE: PG 64-22
 DESIGN AIR VOIDS: 4.0% @ DESIGN = 70
 MIXTURE COMPOSITION: IL-9.5
 FRICTION AGGREGATE: MIXTURE C

CLASS D PAVEMENT PATCHING

APPLICATION: HOT MIX ASPHALT BINDER COURSE, IL-19, N70
 PG GRADE: PG 64-22
 DESIGN AIR VOIDS: 4.0% @ DESIGN = 70
 MIXTURE COMPOSITION: IL-19.0
 FRICTION AGGREGATE: N/A

THE FOLLOWING RATES OF APPLICATION HAVE BEEN USED IN CALCULATING PLAN QUANTITIES:

HOT MIX ASPHALT	112 LBS/50 YD/IN
BITUMINOUS MATERIALS PRIME COAT	0.05 LBS/50 FT
GRANULAR MATERIAL	2.05 TONS/CU YD

FILE NAME	USER NAME	DESIGNED	REVISED	STATE OF ILLINOIS DEPARTMENT OF TRANSPORTATION		INDEX OF SHEETS AND GENERAL NOTES		F.A.P. RTE.	SECTION	COUNTY	TOTAL SHEETS	SHEET NO.
o:\pwork\p\dot\stefannk\09780310	stefannk	DRAWN	REVISED			SCALE: N/A SHEET 1 OF 1 SHEETS STA. TO STA.		781	07 HMA RESURF 2015-6	LAWRENCE	7	2
		CHECKED	REVISED					CONTRACT NO. 74682				
		DATE	REVISED					ILLINOIS FED. AID PROJECT				

41080

100% STATE

100% STATE

SUMMARY OF QUANTITIES			TOTAL QUANTITIES	CONSTRUCTION TYPE CODE		
CODE NO	ITEM	UNIT		0005		
31101000	SUBBASE GRANULAR MATERIAL, TYPE B	TON	7	7		
40600275	BITUMINOUS MATERIALS (PRIME COAT)	POUND	660	660		
40600990	TEMPORARY RAMP	SQ YD	24	24		
40603085	HOT-MIX ASPHALT BINDER COURSE, IL-19.0, N70	TON	80	80		
40603315	HOT-MIX ASPHALT SURFACE COURSE, MIX "C", N70	TON	123	123		
44000155	HOT-MIX ASPHALT SURFACE REMOVAL, 1 1/2"	SQ YD	1467	1467		
44000400	GUTTER REMOVAL	FOOT	360	360		
44201785	CLASS D PATCHES, TYPE I, 12 INCH	SQ YD	39	39		
44201789	CLASS D PATCHES, TYPE II, 12 INCH	SQ YD	20	20		
44201796	CLASS D PATCHES, TYPE IV, 12 INCH	SQ YD	53	53		
48102100	AGGREGATE WEDGE SHOULDER, TYPE B	TON	24	24		
60602500	CONCRETE GUTTER, TYPE A	FOOT	360	360		
67100100	MOBILIZATION	L SUM	1	1		

SUMMARY OF QUANTITIES			TOTAL QUANTITIES	CONSTRUCTION TYPE CODE		
CODE NO	ITEM	UNIT		0005		
70100450	TRAFFIC CONTROL AND PROTECTION, STANDARD 701201	L SUM	1	1		
70103815	TRAFFIC CONTROL SURVEILLANCE	CAL DA	5	5		
70300100	SHORT TERM PAVEMENT MARKING	FOOT	120	120		
70301000	WORK ZONE PAVEMENT MARKING REMOVAL	SQ FT	21	21		
* 78001110	PAINT PAVEMENT MARKING - LINE 4"	FOOT	1350	1350		
* 78100100	RAISED REFLECTIVE PAVEMENT MARKER	EACH	9	9		
X4406225	PARTIAL DEPTH REMOVAL, TYPE II, 2.5"	SQ YD	49	49		
X4421000	PARTIAL DEPTH PATCHING	TON	8	8		
X7015005	CHANGEABLE MESSAGE SIGN	CAL DA	28	28		

* SPECIALTY ITEM

FILE NAME =	USER NAME = steffanek	DESIGNED -	REVISED -
4:\p-work\p\dot\steffanek\02097033\074682-ant-aq.dgn		DRAWN -	REVISED -
		CHECKED -	REVISED -
		DATE -	REVISED -

**STATE OF ILLINOIS
DEPARTMENT OF TRANSPORTATION**

SUMMARY OF QUANTITIES	
SCALE: N/A	SHEET 1 OF 1 SHEETS STA. TO STA.

F.A.P. RATE	SECTION	COUNTY	TOTAL SHEETS	SHEET NO.
781	D7 HMA RESURF 2015-6	LAWRENCE	7	3
CONTRACT NO. 74682			ILLINOIS FED. AID PROJECT	

TYPICAL CROSS SECTION
STA 1175+00 TO STA 1181+00

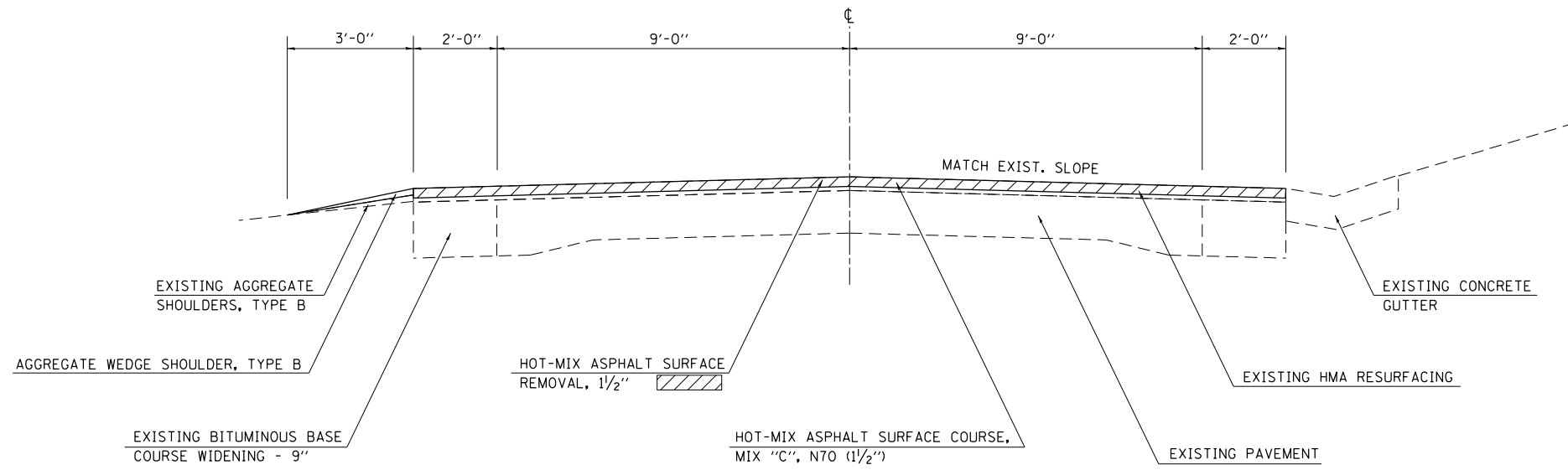

NOTE: NOT TO SCALE

FILE NAME =	USER NAME = steffenmk	DESIGNED -	REVISED -	STATE OF ILLINOIS DEPARTMENT OF TRANSPORTATION	TYPICAL CROSS SECTION			F.A.P. RTE.	SECTION	COUNTY	TOTAL SHEETS	SHEET NO.
ci:\pw\work\p\idot\steffenmk\d0397033\074682-sht-typicals.dgn	PLOT SCALE = 100.0000' / in.	DRAWN -	REVISED -		781	D7 HMA RESURF 2015-6	LAWRENCE	7	4			
Default	PLOT DATE = 10/27/2014	CHECKED -	REVISED -		SCALE: N/A SHEET 1 OF 1 SHEETS STA. TO STA.			CONTRACT NO. 74682				
		DATE -	REVISED -		ILLINOIS FED. AID PROJECT							

RESURFACING SCHEDULE

STATION TO STATION	WIDTH	LENGTH	HOT-MIX ASPHALT SURFACE REMOVAL, 1 1/2"	BITUMINOUS MATERIALS (PRIME COAT)	HOT-MIX ASPHALT SURFACE COURSE, MIX "C", N70	HOT-MIX ASPHALT BINDER COURSE, IL 19.0, N70	AGGREGATE WEDGE SHOULDER, TYPE B	TEMPORARY RAMP
	FOOT	FOOT	SQ YD	POUND	TON	TON	TON	SQ YD
1175+00.00 TO 1176+02.00	22	102	249	112	21		4	12
1176+02.00 TO 1178+62.00	22	260	636	286	53	80	10	
1178+62.00 TO 1181+00.00	22	238	582	262	49		9	12
TOTALS		600	1467	660	123	80	23	24

PAVEMENT MARKING SCHEDULE

STATION TO STATION	LENGTH	PAINT PAVEMENT MARKING - LINE 4"	SHORT-TERM PAVEMENT MARKING	WORK ZONE PAVEMENT MARKING REMOVAL	RAISED REFLECTIVE PAVEMENT MARKERS
	FOOT	FOOT	FOOT	SO FT	EACH
1175+00.00 TO 1177+00.00	200.0	450	40	7	3
1177+00.00 TO 1179+00.00	200.0	450	40	7	3
1179+00.00 TO 1181+00.00	200.0	450	40	7	3
TOTALS		1350	120	21	9



PROJECT BEGINS:
STATION 1175+00

1175



PROJECT ENDS:
STATION 1181+00

1180

PT Sta 1183+97.80
EQUATION:
Sta 1183+97.80 BK =
Sta 1183+94.80 AH

FILE NAME =	USER NAME = steffenmk	DESIGNED -	REVISED -
ci:\pw\work\p\idot\steffenmk\d0397033\074682-sht-plan.dgn		DRAWN -	REVISED -
Default	PLOT SCALE = 40.0000' / in.	CHECKED -	REVISED -
	PLOT DATE = 10/27/2014	DATE -	REVISED -

**STATE OF ILLINOIS
DEPARTMENT OF TRANSPORTATION**

PLAN

SCALE: 20 SHEET 1 OF 1 SHEETS STA. TO STA.

F.A.P. RTE.	SECTION	COUNTY	TOTAL SHEETS	SHEET NO.
781	D7 HMA RESURF 2015-6	LAWRENCE	7	6
CONTRACT NO. 74682			ILLINOIS FED. AID PROJECT	

EXISTING DIP IN PAVEMENT DETAIL

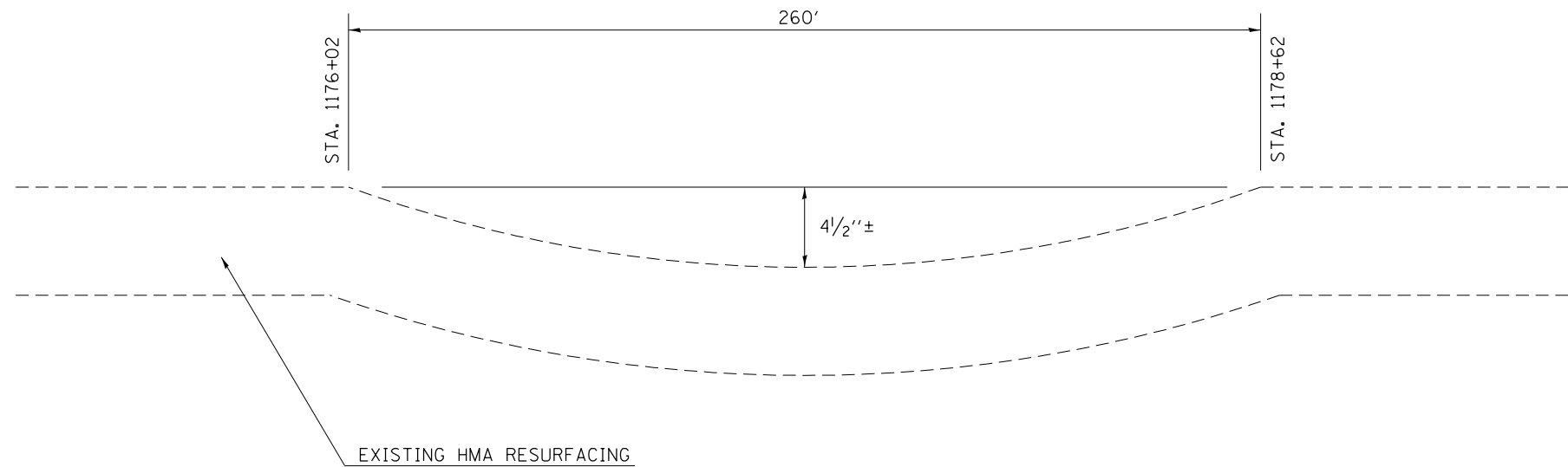

PROPOSED DIP IN PAVEMENT REPAIR DETAIL

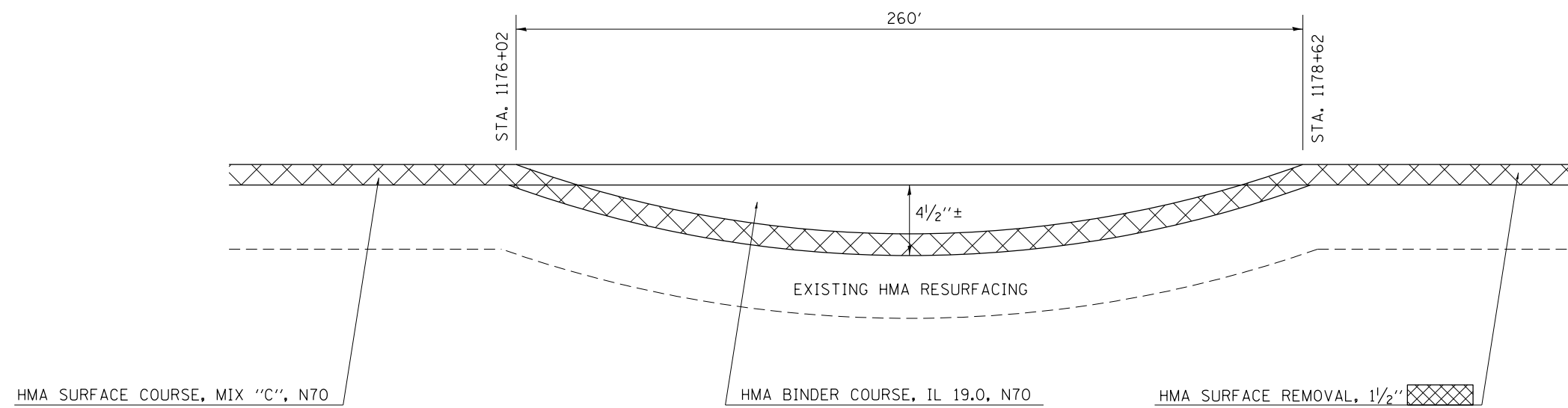

FILE NAME =	USER NAME = steffenmk	DESIGNED -	REVISED -	STATE OF ILLINOIS	DIP IN PAVEMENT DETAILS			F.A.P. RTE.	SECTION	COUNTY	TOTAL SHEETS	SHEET NO.
ci:\pw\work\p\idot\steffenmk\d0397033\0774682-sht-details.dgn		DRAWN -	REVISED -	DEPARTMENT OF TRANSPORTATION	SCALE: N/A	SHEET 1	OF 1	SHEETS	STA.	TO STA.	781	7
Default	PLOT SCALE = 100.0000' / in.	CHECKED -	REVISED -								D7 HMA RESURF 2015-6	7
	PLOT DATE = 10/27/2014	DATE -	REVISED -								LAWRENCE	7
											CONTRACT NO. 74682	
											ILLINOIS FED. AID PROJECT	