

STATE OF ILLINOIS  
DEPARTMENT OF TRANSPORTATION  
DIVISION OF HIGHWAYS

**PROPOSED  
HIGHWAY PLANS**

F.A.S ROUTE 1807 (U.S. BUS. 50)  
SECTION D7 HMA RESURF 2015-7

RESURFACING  
LAWRENCE COUNTY  
C-97-091-14

FOR INDEX OF SHEETS, SEE SHEET NO. 2

ADT = 4200 (2011)

| F.A.S. RTE. | SECTION | COUNTY   | TOTAL SHEETS       | SHEET NO. |
|-------------|---------|----------|--------------------|-----------|
| 1807        |         | LAWRENCE | 8                  | 1         |
|             |         | ILLINOIS | CONTRACT NO. 74685 |           |

\*D7 HMA RESURFACING 2015-7

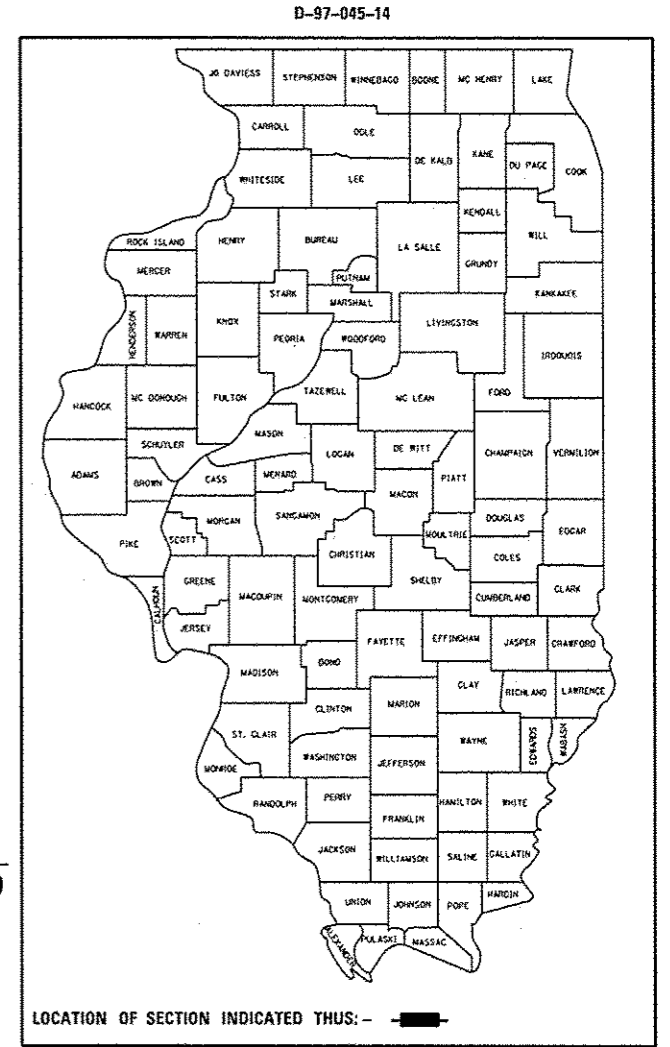

PROJECT LOCATION:  
STA. 68+00 TO STA. 86+50

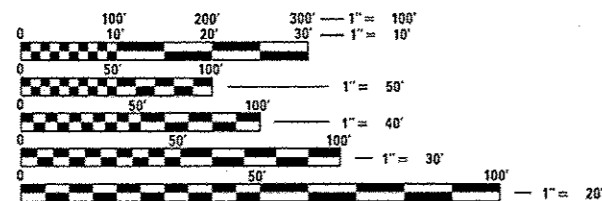
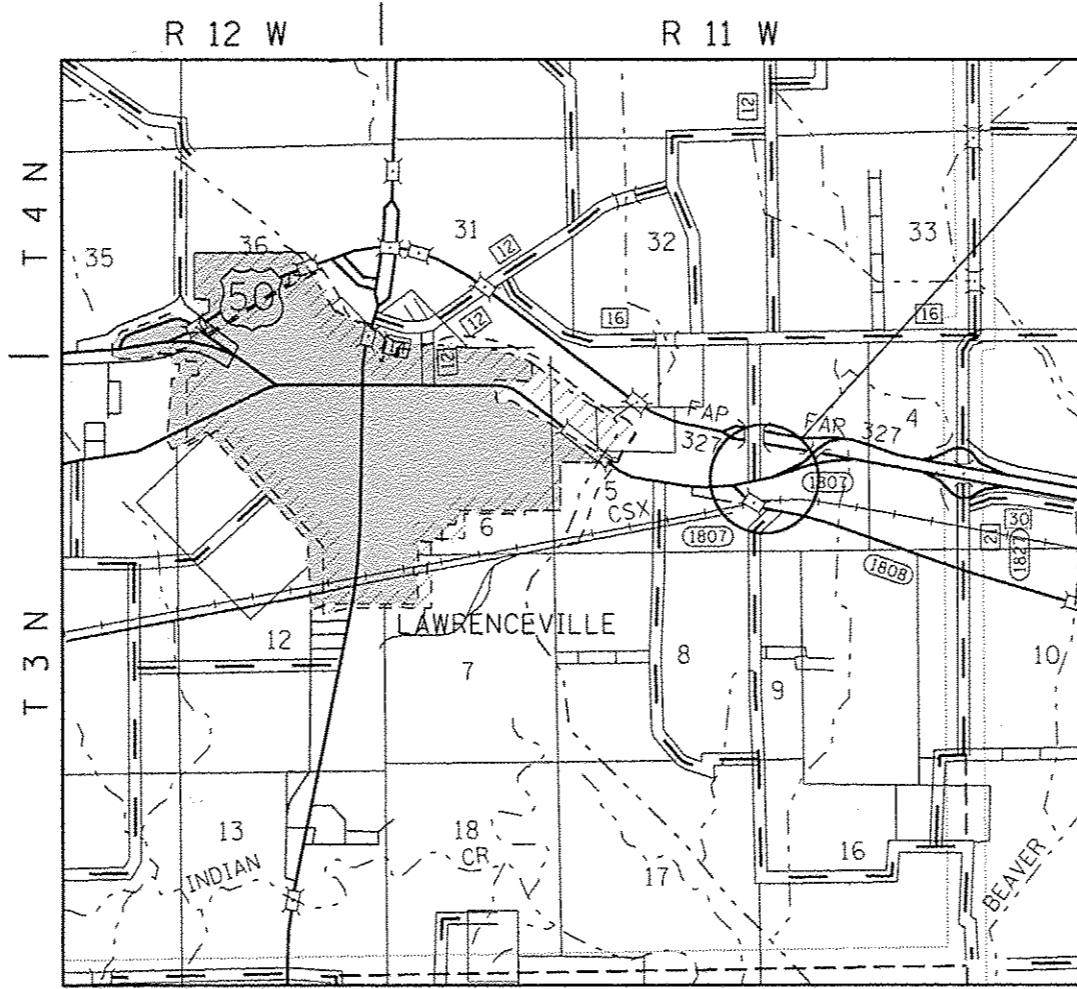

FULL SIZE PLANS HAVE BEEN PREPARED USING STANDARD ENGINEERING SCALES. REDUCED SIZED PLANS WILL NOT CONFORM TO STANDARD SCALES. IN MAKING MEASUREMENTS ON REDUCED PLANS, THE ABOVE SCALES MAY BE USED.

J.U.L.I.E.  
JOINT UTILITY LOCATION INFORMATION FOR EXCAVATION  
1-800-892-0123  
OR 811

PROJECT ENGINEER: TOM RONAN  
PROJECT MANAGER: TOM RONAN  
PHONE: (217)-342-8320  
CONTRACT NO. 74685

GROSS LENGTH = 1,850 FT. = 0.35 MILE  
NET LENGTH = 1,850 FT. = 0.35 MILE

STATE OF ILLINOIS  
DEPARTMENT OF TRANSPORTATION  
DIVISION OF HIGHWAYS

SUBMITTED October 10 20 14  
Roger L. Drushel  
DEPUTY DIRECTOR OF HIGHWAYS, REGION ENGINEER

Jan 30 20 15  
John D. Zanzarelli P.E.  
ENGINEER OF DESIGN AND ENVIRONMENT

Jan 30 20 15  
Omer Osman P.E.  
DIRECTOR OF HIGHWAYS, CHIEF ENGINEER

PRINTED BY THE AUTHORITY  
OF THE STATE OF ILLINOIS

INDEX OF SHEETS

| SHEET NO. | ITEM                            |
|-----------|---------------------------------|
| 1         | COVER SHEET                     |
| 2         | INDEX OF SHEETS & GENERAL NOTES |
| 3         | SUMMARY OF QUANTITIES           |
| 4         | TYPICAL SECTIONS                |
| 5         | SCHEDULES OF QUANTITIES         |
| 6         | LOCATION MAP                    |
| 7         | ENTRANCE SCHEDULE AND DETAILS   |
| 8         | CONSTRUCTION DETAILS            |

THE FOLLOWING STANDARDS ARE A PART OF THESE PLANS AND ARE INCLUDED AFTER SHEET NO. 8:

| STD. NO.  | DESCRIPTION   |
|-----------|---|
| 000001-06 | STANDARD SYMBOLS, ABBREVIATIONS AND PATTERNS                                |
| 406201-01 | MAILBOX TURNOUT   |
| 442201-03 | CLASS C & D PATCHES   |
| 701001-02 | OFF-RD OPERATIONS, 2L, 2W, 15' MINIMUM FROM PAVEMENT EDGE, 45 MPH +         |
| 701006-05 | OFF-RD OPERATIONS, 2L, 2W, 15' TO 24" FROM PAVEMENT EDGE, 45 MPH +          |
| 701011-04 | OFF-RD MOVING OPERATIONS, 2L, 2W, DAY ONLY, 45 MPH +                        |
| 701201-04 | LANE CLOSURE, 2L, 2W, DAY ONLY  |
| 701301-04 | LANE CLOSURE, 2L, 2W, SHORT TIME OPERATIONS                                 |
| 701306-03 | LANE CLOSURE, 2L, 2W, SLOW MOVING OPERATIONS DAY ONLY, FOR SPEEDS >= 45 MPH |
| 701311-03 | LANE CLOSURE 2L, 2W, MOVING OPERATIONS - DAY ONLY                           |
| 701901-04 | TRAFFIC CONTROL DEVICES   |
| 780001-05 | TYPICAL PAVEMENT MARKINGS   |
| 781001-03 | TYPICAL APPLICATION RAISED REFLECTIVE PAVEMENT MARKERS                      |

GENERAL NOTES

THIS SECTION SHALL BE CONSTRUCTED IN ACCORDANCE WITH THE PLANS; THE "STANDARD SPECIFICATIONS FOR ROAD AND BRIDGE CONSTRUCTION", ADOPTED JANUARY 1, 2012; THE "SUPPLEMENTAL SPECIFICATIONS AND RECURRING SPECIAL PROVISIONS", ADOPTED JANUARY 1, 2014, AND THE SPECIAL PROVISIONS INCLUDED IN THIS PROPOSAL.

THE WORK INCLUDED IN THIS SECTION IS LOCATED ON FAS ROUTE 1807 (BUS US ROUTE 50) IN LAWRENCE COUNTY BEGINNING 0.1 MILES WEST OF 990 N. AND EXTENDING EAST FOR 0.35 MILES TO THE US ROUTE 50 RAMP. THE WORK INCLUDED IN THIS SECTION CONSISTS OF PAVEMENT PATCHING, HOT-MIX ASPHALT SURFACE REMOVAL, OVERLAYING WITH HOT-MIX ASPHALT LEVELING BINDER AND SURFACE COURSE, AGGREGATE SHOULDER WEDGE, PAVEMENT MARKING, TRAFFIC CONTROL, AND ANY WORK NECESSARY TO COMPLETE THIS SECTION.

THE CONTRACTOR SHALL PROVIDE INTERNET ACCESSIBILITY TO THE HOT-MIX ASPHALT PLANT QUALITY CONTROL LAB SO THAT HOT-MIX ASPHALT PLANT REPORTS CAN BE E-MAILED TO THE DISTRICT HEADQUARTERS. THIS WORK SHALL BE INCLUDED IN THE COST OF ALL HOT-MIX ASPHALT ITEMS.

THE RESIDENT ENGINEER SHALL BE THE SOLE JUDGE CONCERNING THE CURING TIME FOR ALL HOT-MIX ASPHALT.

THE PAY ITEM TEMPORARY RAMP HAS BEEN INCLUDED FOR THE CONSTRUCTION OF TEMPORARY RAMPS IN ACCORDANCE WITH ARTICLE 406.08 OF THE STANDARD SPECIFICATIONS. THE CONTRACT UNIT PRICE PER SQUARE YARD FOR TEMPORARY RAMP SHALL INCLUDE BOTH THE INSTALLATION AND THE REMOVAL OF THE RAMPS.

THE MATERIAL USED FOR AGGREGATE WEDGE SHOULDER, TYPE B SHALL BE CRUSHED STONE, CRUSHED CONCRETE, OR RAP. THE MATERIAL USED FOR AGGREGATE SURFACE COURSE, TYPE B SHALL BE CRUSHED STONE OR CRUSHED CONCRETE.

PAVEMENT MARKING SHALL BE APPLIED IN ACCORDANCE WITH SECTION 780 OF THE STANDARD SPECIFICATIONS. SHORT TERM PAVEMENT MARKING SHALL BE APPLIED TO THE MILLED SURFACE, BITUMINOUS MATERIALS (PRIME COAT), HOT-MIX ASPHALT LEVEL BINDER, AND HOT-MIX ASPHALT SURFACE COURSE AS SPECIFIED IN SECTION 703 OF THE STANDARD SPECIFICATIONS. TEMPORARY TAPE SHALL BE USED ON THE SURFACE COURSE AND PAINT SHALL BE USED ON MILLED SURFACES.

THE TOTAL QUANTITY OF PAINT PAVEMENT MARKING - LINE 4" CONSISTS OF 3,558 FEET OF WHITE AND 1,045 FEET OF YELLOW.

THE FOLLOWING MIXTURE REQUIREMENTS ARE APPLICABLE FOR THIS PROJECT:

SURFACE COURSE (1.5")

APPLICATION: HOT MIX ASPHALT SURFACE COURSE, MIX C, NTO  
 PG GRADE: PG 64-22  
 DESIGN AIR VOIDS: 4.0%<sub>ND</sub>DESIGN = 70  
 MIXTURE COMPOSITION: IL-9.5  
 FRICTION AGGREGATE: MIXTURE C

INCIDENTAL HMA

APPLICATION: HOT MIX ASPHALT SURFACE COURSE, MIX C, NTO  
 PG GRADE: PG 64-22  
 DESIGN AIR VOIDS: 4.0%<sub>ND</sub>DESIGN = 70  
 MIXTURE COMPOSITION: IL-9.5  
 FRICTION AGGREGATE: MIXTURE C

CLASS D PAVEMENT PATCHING

APPLICATION: HOT MIX ASPHALT BINDER COURSE, IL-19, NTO  
 PG GRADE: PG 64-22  
 DESIGN AIR VOIDS: 4.0%<sub>ND</sub>DESIGN = 70  
 MIXTURE COMPOSITION: IL-19.0  
 FRICTION AGGREGATE: N/A

THE FOLLOWING RATES OF APPLICATION HAVE BEEN USED IN CALCULATING PLAN QUANTITIES:

|                                 |                  |
|---------------------------------|------------------|
| HOT MIX ASPHALT                 | 112 LBS/50 YD/IN |
| BITUMINOUS MATERIALS PRIME COAT | 0.05 LBS/50 FT   |
| GRANULAR MATERIAL               | 2.05 TONS/CU YD  |

|   |                              |             |            |   |  |         |      |                  |              |                    |                |             |
|---|------------------------------|-------------|------------|---|--|---------|------|------------------|--------------|--------------------|----------------|-------------|
| FILE NAME: c:\pwork\pavdoc\stefan\k10397102\074685-ent-ndex.dgn | USER NAME: esteffan          | DESIGNED: - | REVISED: - | <b>STATE OF ILLINOIS<br/>DEPARTMENT OF TRANSPORTATION</b> | <b>INDEX OF SHEETS AND<br/>GENERAL NOTES</b> |         |      | F.A.S. RTE. 1807 | SECTION *    | COUNTY LAWRENCE    | TOTAL SHEETS 8 | SHEET NO. 2 |
| Default   | PLOT SCALE = 100.0000' / in. | CHECKED: -  | REVISED: - |   | SCALE: N/A                                   | SHEET 1 | OF 1 | SHEETS           | STA. TO STA. | CONTRACT NO. 74685 |                |             |
|   | PLOT DATE = 10/27/2014       | DATE: -     | REVISED: - |   | *07 HMA RESURFACING 2015-7                   |         |      |                  |              |                    |                |             |
| ILLINOIS FED. AID PROJECT                                       |                              |             |            |   |  |         |      |                  |              |                    |                |             |

| SUMMARY OF QUANTITIES |  |       | TOTAL QUANTITIES | CONSTRUCTION TYPE CODE |  |  |
|-----------------------|--|-------|------------------|------------------------|--|--|
| CODE NO               | ITEM   | UNIT  |                  | 100% STATE<br>0005     |  |  |
| 40200800              | AGGREGATE SURFACE COURSE, TYPE B                   | TON   | 8                | 8                      |  |  |
| 40600275              | BITUMINOUS MATERIALS (PRIME COAT)                  | POUND | 2670             | 2670                   |  |  |
| 40600982              | HOT-MIX ASPHALT SURFACE REMOVAL - BUTT JOINT       | SO YD | 539              | 539                    |  |  |
| 40600990              | TEMPORARY RAMP                                     | SO YD | 199              | 199                    |  |  |
| 40603315              | HOT-MIX ASPHALT SURFACE COURSE, MIX "C", N70       | TON   | 498              | 498                    |  |  |
| 40800050              | INCIDENTAL HOT-MIX ASPHALT SURFACING               | TON   | 32               | 32                     |  |  |
| 44201789              | CLASS D PATCHES, TYPE II, 12 INCH                  | SO YD | 327              | 327                    |  |  |
| 48102100              | AGGREGATE WEDGE SHOULDER, TYPE B                   | TON   | 126              | 126                    |  |  |
| 67100100              | MOBILIZATION                                       | L SUM | 1                | 1                      |  |  |
| 70100450              | TRAFFIC CONTROL AND PROTECTION, STANDARD<br>701201 | L SUM | 1                | 1                      |  |  |
| 70300100              | SHORT TERM PAVEMENT MARKING                        | FOOT  | 376              | 376                    |  |  |
| 70301000              | WORK ZONE PAVEMENT MARKING REMOVAL                 | SO FT | 63               | 63                     |  |  |
| * 78001110            | PAINT PAVEMENT MARKING - LINE 4"                   | FOOT  | 4403             | 4403                   |  |  |

| SUMMARY OF QUANTITIES |  |        | TOTAL QUANTITIES | CONSTRUCTION TYPE CODE |  |  |
|-----------------------|--|--------|------------------|------------------------|--|--|
| CODE NO               | ITEM   | UNIT   |                  | 100% STATE<br>0005     |  |  |
| * 78100100            | RAISED REFLECTIVE PAVEMENT MARKER                  | EACH   | 23               | 23                     |  |  |
| X4401198              | HOT-MIX ASPHALT SURFACE REMOVAL, VARIABLE<br>DEPTH | SO YD  | 5722             | 5722                   |  |  |
| X7015005              | CHANGEABLE MESSAGE SIGN                            | CAL DA | 28               | 28                     |  |  |
| 3                     |  |        |                  |                        |  |  |

\* SPECIALTY ITEM

|   |                             |            |           |
|---|-----------------------------|------------|-----------|
| FILE NAME =   | USER NAME = steffanik       | DESIGNED - | REVISED - |
| c:\pwwork\psidat\steffanik\0397102\074685-ent\soq.dgn |                             | DRAWN -    | REVISED - |
| Default   | PLOT SCALE = 1/80.0000 "/in | CHECKED -  | REVISED - |
|   | PLOT DATE = 10/27/2014      | DATE -     | REVISED - |

STATE OF ILLINOIS  
DEPARTMENT OF TRANSPORTATION

SCHEDULE OF QUANTITIES

SCALE: N/A SHEET 1 OF 1 SHEETS STA. TO STA.

|                            |         |          |                    |
|----------------------------|---------|----------|--------------------|
| *DT HMA RESURFACING 2015-7 |         |          |                    |
| F.A.S. RATE                | SECTION | COUNTY   | TOTAL SHEETS       |
| 1807                       | *       | LAWRENCE | 8 3                |
|                            |         |          | CONTRACT NO. 74685 |
| ILLINOIS FED. AID PROJECT  |         |          |                    |

**TYPICAL CROSS SECTION**

**U.S. BUS. 50**

STATION 68+00 TO STATION 77+58

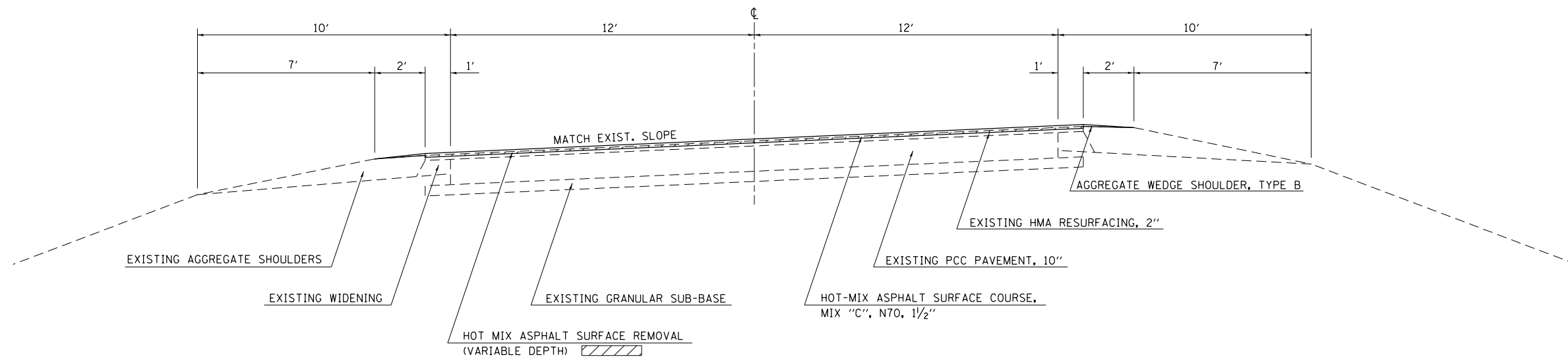

NOTE: NOT TO SCALE

**TYPICAL CROSS SECTION**

**U.S. BUS. 50**

STATION 77+58 TO STATION 86+50

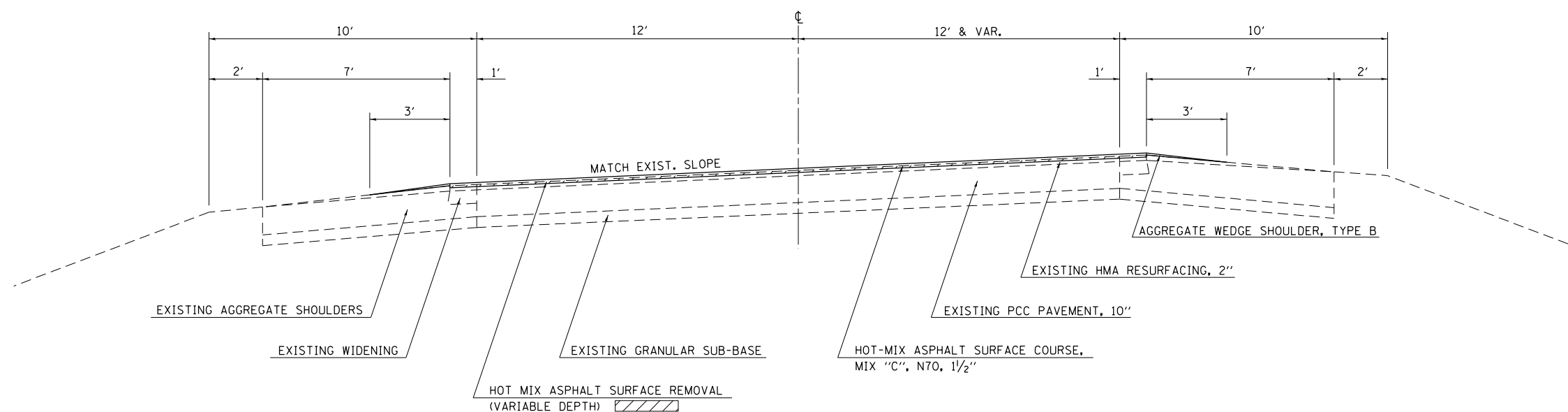

NOTE: NOT TO SCALE

|   |                               |            |           |
|---|-------------------------------|------------|-----------|
| FILE NAME =   | USER NAME = steffenmk         | DESIGNED - | REVISED - |
| c:\pwork\pwork\dot\steffenmk\d0397102\074685-sh1-typicals.dgn |                               | DRAWN -    | REVISED - |
|   | PLOT SCALE = 100.0000' / 1in. | CHECKED -  | REVISED - |
| Default   | PLOT DATE = 10/27/2014        | DATE -     | REVISED - |

**STATE OF ILLINOIS  
DEPARTMENT OF TRANSPORTATION**

**TYPICAL CROSS SECTIONS**

SCALE: N/A SHEET 1 OF 1 SHEETS STA. TO STA.

|                            |         |          |                    |           |
|----------------------------|---------|----------|--------------------|-----------|
| *D7 HMA RESURFACING 2015-7 |         |          |                    |           |
| F.A.S. RTE.                | SECTION | COUNTY   | TOTAL SHEETS       | SHEET NO. |
| 1807                       | *       | LAWRENCE | 8                  | 4         |
|                            |         |          | CONTRACT NO. 74685 |           |
| ILLINOIS FED. AID PROJECT  |         |          |                    |           |

RESURFACING SCHEDULE

| STATION TO STATION         | LENGTH | AVERAGE WIDTH | HOT-MIX ASPHALT SURFACE REMOVAL - BUTT JOINT | HOT-MIX ASPHALT SURFACE REMOVAL, VARIABLE DEPTH | BITUMINOUS MATERIALS (PRIME COAT) | HOT-MIX ASPHALT SURFACE COURSE, MIX "C", N70 | AGGREGATE WEDGE SHOULDER, TYPE B | TEMPORARY RAMP |
|----------------------------|--------|---------------|--|---|-----------------------------------|--|----------------------------------|----------------|
|                            | FOOT   | FOOT          | SQ YD  | SQ YD   | POUND                             | TON  | TON                              | SQ YD          |
| MAINLINE BUS US 50         |        |               |  |   |                                   |  |                                  |                |
| 68+00.00 TO 68+30.00       | 30.0   | 26.00         | 87   |   | 39                                | 7  | 2                                | 14.4           |
| 68+30.00 TO 77+58.00       | 928.0  | 26.00         |  | 2681  | 1206                              | 225  | 56                               |                |
| 77+58.00 TO 86+20.00       | 862.0  | 31.75         |  | 3041  | 1368                              | 255  | 65                               |                |
| 86+20.00 TO 86+50.00       | 30.0   | 37.50         | 125  |   | 56                                | 11   | 2                                | 20.8           |
| PUBLIC ROAD APPROACHES     |        |               |  |   |                                   |  |                                  |                |
| RT. STA. 71+20 (OLD US 50) | 10.0   | 189.50        | 211  |   |                                   |  |                                  | 105.3          |
| LT. STA. 76+05 (1400 E)    | 10.0   | 105.50        | 117  |   |                                   |  |                                  | 58.6           |
| TOTALS                     | 1850   |               | 539  | 5722  | 2670                              | 498  | 126                              | 199            |

PAVEMENT MARKING SCHEDULE

| STATION TO STATION   | LENGTH | PAINT PAVEMENT MARKING - LINE 4" | SHORT-TERM PAVEMENT MARKING | WORK ZONE PAVEMENT MARKING REMOVAL | RAISED REFLECTIVE PAVEMENT MARKERS |
|----------------------|--------|----------------------------------|-----------------------------|------------------------------------|------------------------------------|
|                      | FOOT   | FOOT                             | FOOT                        | SQ FT                              | EACH                               |
| 68+00.00 TO 81+44.00 | 1344   | 2682                             | 272                         | 45                                 | 17                                 |
| 81+44.00 TO 85+48.00 | 404    | 1313                             | 80                          | 13                                 | 5                                  |
| 85+48.00 TO 86+50.00 | 102    | 408                              | 24                          | 4                                  | 1                                  |
| TOTALS               | 1850   | 4403                             | 376                         | 63                                 | 23                                 |

•D7 HMA RESURFACING 2015-7

|  |                               |            |           |   |                               |  |  |                                  |         |          |                    |           |
|--|-------------------------------|------------|-----------|---|-------------------------------|--|--|----------------------------------|---------|----------|--------------------|-----------|
| FILE NAME =  | USER NAME = steffenmk         | DESIGNED - | REVISED - | <b>STATE OF ILLINOIS<br/>DEPARTMENT OF TRANSPORTATION</b> | <b>SCHEDULE OF QUANTITIES</b> |  |  | F.A.S. RTE.                      | SECTION | COUNTY   | TOTAL SHEETS       | SHEET NO. |
| ci:\pw\work\p\idot\steffenmk\d0397102\074685-shr-sch.dgn |                               | DRAWN -    | REVISED - |   |                               |  |  | 1807                             | •       | LAWRENCE | 8                  | 5         |
| Default  | PLOT SCALE = 100.0000' / 1in. | CHECKED -  | REVISED - |   | SCALE: N/A                    |  |  | SHEET 1 OF 1 SHEETS STA. TO STA. |         |          | CONTRACT NO. 74685 |           |
|  | PLOT DATE = 10/27/2014        | DATE -     | REVISED - |   | ILLINOIS FED. AID PROJECT     |  |  |                                  |         |          |                    |           |

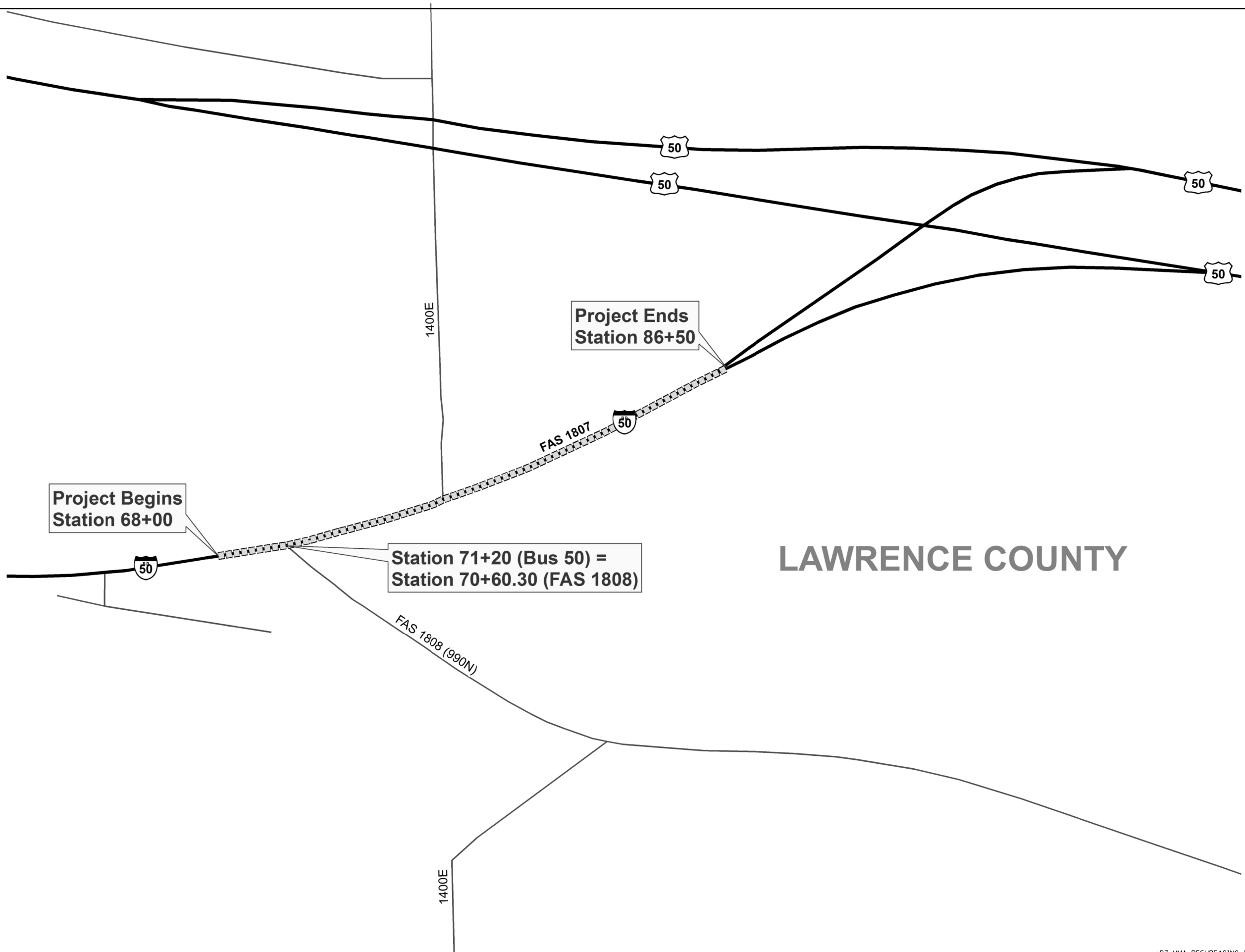

# LAWRENCE COUNTY

|   |                             |            |           |
|---|-----------------------------|------------|-----------|
| FILE NAME =   | USER NAME = steffenmk       | DESIGNED - | REVISED - |
| c:\pwork\pwork\dot\steffenmk\d0397102\074685-sh1-plan.dgn |                             | DRAWN -    | REVISED - |
| Default   | PLOT SCALE = 40.0000' / in. | CHECKED -  | REVISED - |
|   | PLOT DATE = 10/27/2014      | DATE -     | REVISED - |

**STATE OF ILLINOIS  
DEPARTMENT OF TRANSPORTATION**

|                     |         |             |              |
|---------------------|---------|-------------|--------------|
| <b>LOCATION MAP</b> |         |             |              |
| SCALE: 20           | SHEET 1 | OF 1 SHEETS | STA. TO STA. |

|                            |         |          |                           |           |
|----------------------------|---------|----------|---------------------------|-----------|
| *D7 HMA RESURFACING 2015-7 |         |          |                           |           |
| F.A.S. RTE.                | SECTION | COUNTY   | TOTAL SHEETS              | SHEET NO. |
| 1807                       | •       | LAWRENCE | 8                         | 6         |
| CONTRACT NO. 74685         |         |          | ILLINOIS FED. AID PROJECT |           |

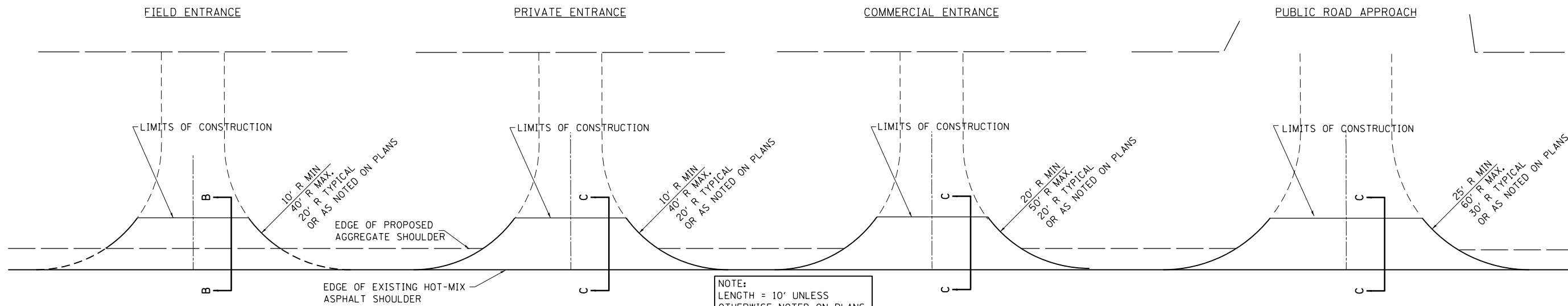

NOTE:  
LENGTH = 10' UNLESS  
OTHERWISE NOTED ON PLANS.

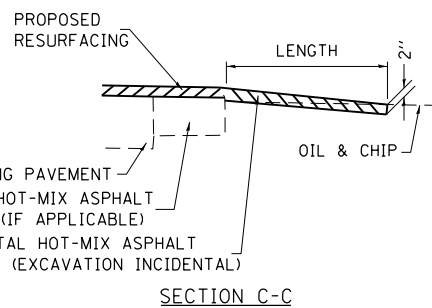
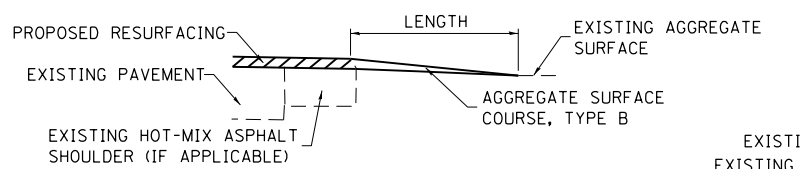
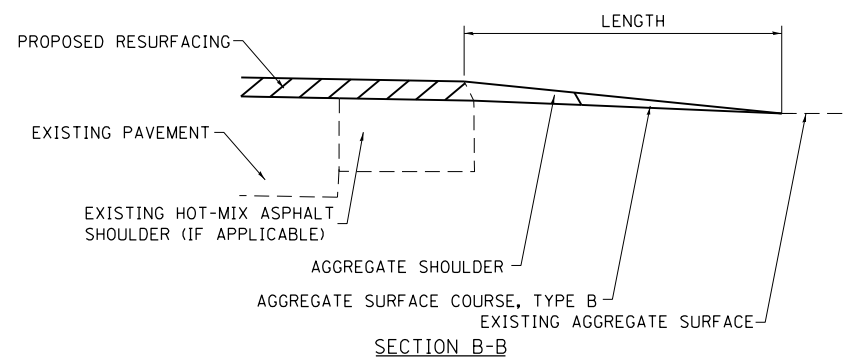

SECTION C-C

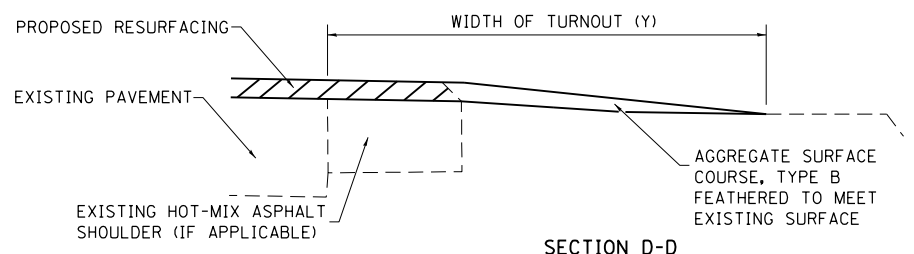
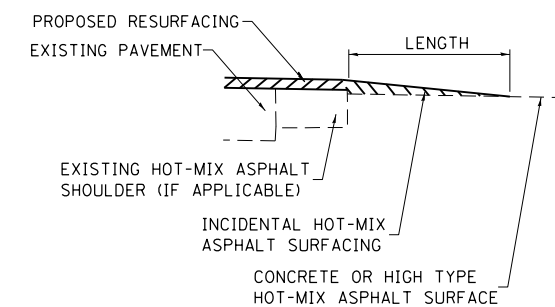

SECTION D-D

**TYPICAL SECTION AT MAILBOX TURNOUT**

NOTE: SEE STANDARD 406201 FOR MAILBOX TURNOUT DETAILS

**NOTES**

THE COST OF THE ASPHALT MATERIALS, AND AGGREGATE (PRIME COAT) FOR ENTRANCES AND PUBLIC ROADS AND APPROACHES SHALL BE INCLUDED IN THE PAY ITEM INCIDENTAL HOT-MIX ASPHALT SURFACING.

THE COST OF EXCAVATION IS INCLUDED IN THE PAY ITEM INCIDENTAL HOT-MIX ASPHALT SURFACING.

IF THERE IS NOT EXISTING HOT-MIX ASPHALT SHOULDER THEN THE ENTRANCE TAPER STARTS AT THE EDGE OF EXISTING PAVEMENT.

THE COST OF THE BITUMINOUS MATERIALS AND AGGREGATE (PRIME COAT) FOR ENTRANCES AND PUBLIC ROAD APPROACHES SHALL BE INCLUDED IN THE PAY ITEM INCIDENTAL HOT-MIX ASPHALT SURFACING.

| SIDE   | STATION | TYPE | INCIDENTAL HOT-MIX ASPHALT SURFACING |     |
|--------|---------|------|--------------------------------------|-----|
|        |         |      | TON                                  | TON |
| LT     | 68+63   | MBT2 |                                      | 4.7 |
| RT     | 71+20   | PRA  | 17.7                                 |     |
| RT     | 75+92   | PE   | 4                                    |     |
| RT     | 75+92   | PE   |                                      | 3.3 |
| LT     | 76+05   | PRA  | 9.8                                  |     |
| TOTALS |         |      | 32                                   | 8   |

FE=FIELD ENTRANCE PRA - PUBLIC ROAD APPROACH  
PE=PRIVATE ENTRANCE MBT - MAILBOX TURNOUT  
CE=COMMERCIAL ENTRANCE

\*D7 HMA RESURFACING 2015-7

|  |                             |                     |                    |
|--|-----------------------------|---------------------|--------------------|
| FILE NAME =  | USER NAME = steffemk        | DESIGNED - 08-03-99 | REVISED - 03-13-07 |
| c:\pwork\pwork\dot\stefemk\d0397102\074685-sht-sch.dgn |                             | DRAWN -             | REVISED -          |
|  | PLOT SCALE = 100.0000' / 1" | CHECKED -           | REVISED -          |
|  | PLOT DATE = 10/27/2014      | DATE -              | REVISED -          |

**STATE OF ILLINOIS  
DEPARTMENT OF TRANSPORTATION**

**RURAL ENTRANCE SCHEDULE AND MAILBOX TURNOUT DETAILS  
WITH SHOULDERS**

SCALE: N/A SHEET NO. 1 OF 1 SHEETS STA. TO STA.

|   |         |          |                    |           |
|---|---------|----------|--------------------|-----------|
| F.A.S. RTE.                                   | SECTION | COUNTY   | TOTAL SHEETS       | SHEET NO. |
| 1807  | *       | LAWRENCE | 8                  | 7         |
| FED. ROAD DIST. NO. ILLINOIS FED. AID PROJECT |         |          | CONTRACT NO. 74685 |           |

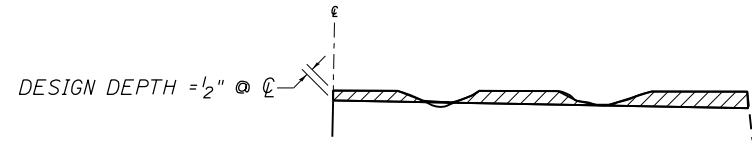

**NOTES:**

1. MILLING SHALL BE DONE TO ATTAIN A 3/16 "/FT. SLOPE IN CROWN SECTIONS
2. EXISTING S.E. AND S.E. TRANSITIONS SHALL BE MAINTAINED UNLESS OTHERWISE SHOWN ON THE PLANS.
3. MILLING TO THE BOTTOM OF WHEEL RUTS SHALL NOT BE NECESSARY UNLESS REQUIRED TO OBTAIN SLOPE OR THE DESIGN DEPTH AT CENTERLINE.
4. THE AVERAGE DEPTH OF MILLING IS ESTIMATED TO BE 1/2" BUT MAY VARY IN ISOLATED LOCATIONS.

HOT-MIX ASPHALT SURFACE REMOVAL (VARIABLE DEPTH) DETAIL

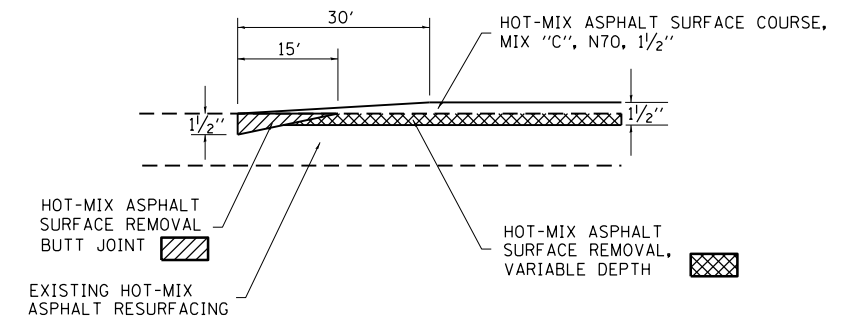

**BUTT JOINT DETAIL**

STA. 395+16 TO STA. 395+46

|   |                              |            |           |
|---|------------------------------|------------|-----------|
| FILE NAME =   | USER NAME = steffenmk        | DESIGNED - | REVISED - |
| ci:\pw\work\p\dot\steffenmk\d0397102\074685-sh1-details.dgn |                              | DRAWN -    | REVISED - |
| Default   | PLOT SCALE = 100.0000' / in. | CHECKED -  | REVISED - |
|   | PLOT DATE = 10/27/2014       | DATE -     | REVISED - |

**STATE OF ILLINOIS  
DEPARTMENT OF TRANSPORTATION**

**CONSTRUCTION DETAILS**

SCALE: N/A SHEET 1 OF 1 SHEETS STA. TO STA.

\*07 HMA RESURFACING 2015-7

| F.A.S. RTE.        | SECTION | COUNTY   | TOTAL SHEETS              | SHEET NO. |
|--------------------|---------|----------|---------------------------|-----------|
| 1807               | *       | LAWRENCE | 8                         | 8         |
| CONTRACT NO. 74685 |         |          | ILLINOIS FED. AID PROJECT |           |