

03-06-2015 LETTING ITEM 125

STATE OF ILLINOIS  
DEPARTMENT OF TRANSPORTATION  
DIVISION OF HIGHWAYS

**PROPOSED  
HIGHWAY PLANS**

FAP ROUTE 785/2 (IL 111/IL 140/IL 143)  
SECTION 132-4B-P, 406-B-1-P

BRIDGE PAINTING  
MADISON COUNTY

C-98-064-14

F.A.P. RTE.	SECTION	COUNTY	TOTAL SHEETS	SHEET NO.
785/2	132-4B-P, 406-B-1-P	MADISON	13	1
		ILLINOIS	CONTRACT NO. 76H37	

FOR INDEX OF SHEETS, SEE SHEET NO. 2

HIGHWAY CLASSIFICATION (SN 060-0187/SN 060-0190)

FAP 785 - IL 111/140  
Functional Class: Other Principal Arterial  
ADT: 17,800  
MU: 3.79% SU: 4.92%  
Design Speed: 55 mph  
Posted Speed: 55 mph

HIGHWAY CLASSIFICATION (SN 060-0200)

FAP 2 - IL 143  
Functional Class: Other Principal Arterial  
ADT: 13,100  
MU: 2.60% SU: 2.48%  
Design Speed: 55 mph  
Posted Speed: 55 mph

PROJECT LOCATION  
SN 060-0200  
LATITUDE: 38.862010  
LONGITUDE: -90.132013

PROJECT LOCATION  
SN 060-0187(EB) & 060-0190(WB)  
LATITUDE: 38.906844  
LONGITUDE: -90.084394

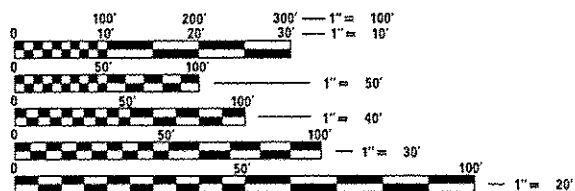

FULL SIZE PLANS HAVE BEEN PREPARED USING STANDARD ENGINEERING SCALES. REDUCED SIZED PLANS WILL NOT CONFORM TO STANDARD SCALES. IN MAKING MEASUREMENTS ON REDUCED PLANS, THE ABOVE SCALES MAY BE USED.

J.U.L.I.E.  
JOINT UTILITY LOCATION INFORMATION FOR EXCAVATION  
1-800-892-0123  
OR 811

PROJECT ENGINEER: MICHAEL PRITCHETT (618) 346-3180  
DESIGNER: OSCAR ZALDANA (618) 346-3206

CONTRACT NO. 76H37

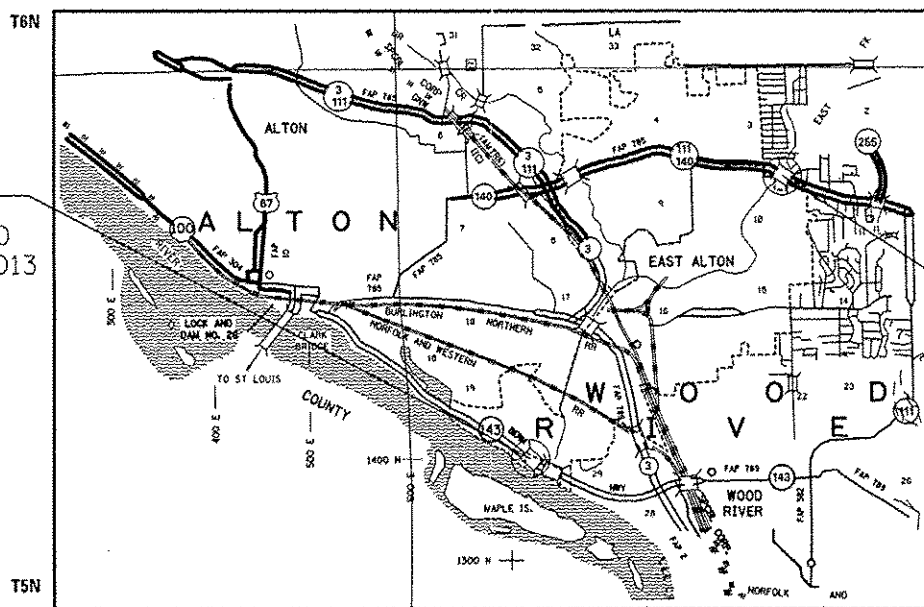

NOT TO SCALE  
LOCATION MAP  
WOOD RIVER TOWNSHIP

GROSS LENGTH = 555.00 FT. = 0.105 MILE  
NET LENGTH = 555.00 FT. = 0.105 MILE

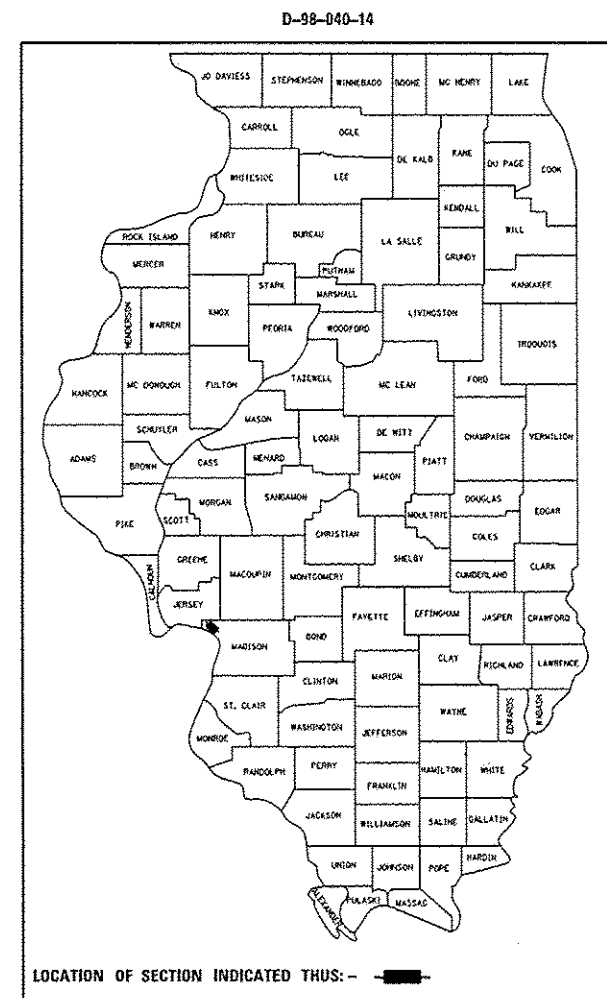

LOCATION OF SECTION INDICATED THUS: -

STATE OF ILLINOIS  
DEPARTMENT OF TRANSPORTATION  
DIVISION OF HIGHWAYS  
SUBMITTED Sept 3 20 14  
Jeffrey E. Ke...  
DEPUTY DIRECTOR OF HIGHWAYS, REGION 5 ENGINEER  
Jan 30 20 15  
John D. Baranzelli, PE  
ENGINEER OF DESIGN AND ENVIRONMENT  
Jan 30 20 15  
Omer Osman, PE  
DIRECTOR OF HIGHWAYS, CHIEF ENGINEER

PRINTED BY THE AUTHORITY  
OF THE STATE OF ILLINOIS

**INDEX OF SHEETS**

- 1 COVER SHEET
- 2 GENERAL NOTES, INDEX OF SHEETS & HIGHWAY STANDARDS STANDARDS
- 3 SUMMARY OF QUANTITIES
- 4-5 TYPICAL SECTION (SN 060-0187 & 060-0190)
- 6 PLAN & ELEVATION (SN 060-0187 & 060-0190)
- 7 PLAN SHEET (SN 060-0187 & 060-0190)
- 8 DETAIL SHEET (SN 060-0187 & 060-0190)
- 9 TYPICAL SECTION (SN 060-0200)
- 10 PLAN & ELEVATION (SN 060-0200)
- 11-12 PLAN SHEET (SN 060-0200)
- 13 DETAIL SHEET (SN 060-0200)

**GENERAL NOTES**

1. ILLINOIS STATE LAW REQUIRES A 48-HOUR NOTICE TO BE GIVEN TO UTILITIES BEFORE DIGGING. FIELD MARKING OF FACILITIES MAY BE OBTAINED BY CONTACTING J.U.L.I.E (1-800-892-0123 OR 811) OR FOR NON-MEMBERS, THE UTILITY COMPANY DIRECTLY.
2. A MINIMUM OF TWO AIR MONITORS WILL BE REQUIRED AT SN 060-0187 AND SN 060-0190. A MINIMUM OF ONE AIR MONITOR WILL BE REQUIRED AT SN 060-0200 TO MONITOR ABRASIVE BLASTING OPERATION, SEE SPECIAL PROVISIONS FOR "CONTAINMENT AND DISPOSAL OF LEAD PAINT CLEANING RESIDUES."
3. THE SSPC-OP1 AND SSPC-OP2 CERTIFICATIONS WILL BE REQUIRED FOR THE BRIDGES.
4. CLEANING AND PAINTING OF THE EXISTING STRUCTURAL STEEL SHALL BE AS SPECIFIED IN THE SPECIAL PROVISION FOR "CLEANING AND PAINTING EXISTING STEEL STRUCTURES". ALL BEAMS, BEARINGS AND OTHER STRUCTURAL STEEL WITHIN 5 FT (MEASURED ALONG THE BEAM) OF EITHER SIDE OF THE DECK JOINTS) SHALL BE CLEANED PER NEAR WHITE BLAST CLEANING--SSPC-SPI0. THE EXTERIOR SURFACES AND BOTTOM OF THE BOTTOM FLANGE OF THE FASCIA BEAMS SHOULD BE CLEANED PER COMMERCIAL GRADE POWER TOOL CLEANING--SSPC-SPI5. (SN 060-0200)
5. THE DESIGNATED AREAS CLEANED PER NEAR WHITE BLAST CLEANING AND PER COMMERCIAL GRADE POWER TOOL CLEANING SHALL BE PAINTED ACCORDING TO THE REQUIREMENTS OF PAINT SYSTEM 1-OZ/E/U. THE COLOR OF THE FINAL FINISH COAT FOR ALL STEEL SURFACES SHALL BE INTERSTATE GREEN, MUNSELL NO 7.5G 4/8. (SN 060-0200)
6. "CLEANING AND PAINTING OF THE EXISTING STRUCTURAL STEEL SHALL BE AS SPECIFIED IN THE SPECIAL PROVISION FOR "CLEANING AND PAINTING EXISTING STEEL STRUCTURES". ALL EXISTING STEEL SHALL BE CLEANED PER NEAR WHITE BLAST CLEANING--SSPC-SPI0. ALL EXISTING STEEL SHALL BE PAINTED ACCORDING TO THE REQUIREMENTS OF PAINT SYSTEM 1 - OZ/E/U. THE COLOR OF THE FINAL FINISH COAT FOR ALL STEEL SURFACES SHALL BE GRAY, MUNSELL NO 5B 7/L. (SN 060-0187 AND SN 060-0190)
7. ALL TURF AREA DISTURBED BY THE CONTRACTOR SHALL BE SEEDED WITH THE APPROPRIATE EROSION CONTROL AS DIRECTED BY THE RESIDENT ENGINEER/TECHNICIAN AT THE CONTRACTOR'S EXPENSE.
8. "ROAD CONSTRUCTION AHEAD" SIGNS SHALL BE PLACED AT EACH END OF THE PROJECT LOCATIONS AND ALL INTERSECTING SIDE ROADS AND WILL BE INCLUDED IN THE TRAFFIC CONTROL PAY ITEMS. ALL CONSTRUCTION SIGNS SHALL BE FLUORESCENT ORANGE, 48".
9. THE DEPARTMENT STRONGLY ENCOURAGES THE PRIME CONTRACTOR AND THEIR APPROVED SUB-CONTRACTORS TO HIRE MINORITY, WOMEN AND DISADVANTAGED INDIVIDUALS FROM ITS FEDERALLY FUNDED HIGHWAY CONSTRUCTION CAREERS TRAINING PROGRAM (HCCTP) TO HELP MEET WORKFORCE AND TRAINEE GOALS. THIS PROGRAM IS TRAINING MINORITIES, WOMEN AND DISADVANTAGED INDIVIDUALS IN HIGHWAY CONSTRUCTION-RELATED SKILLS, E.G., MATH FOR THE TRADES, JOB READINESS, TECHNICAL SKILLS COURSE WORK (CARPENTRY, CONCRETE FLATWORK, BLUEPRINT READING, SITE PLANS, SITE WORK, TOOLS USE, ETC.) AND OSHA 10 HOUR CERTIFICATION, TO PREPARE THEM FOR A CAREER IN THE HIGHWAY CONSTRUCTION TRADES. GRADUATES ARE WELL- TRAINED AND READY TO BECOME PRODUCTIVE ENTRY-LEVEL CONSTRUCTION WORKERS. CONTACT THE DISTRICT 8 EEO OFFICE AT 618-346-3360 AND/OR THE HCCTP COORDINATOR AT 618-874-6528 TO LEARN MORE ABOUT THE PROGRAM AND FOR ASSISTANCE IN MEETING WORKFORCE AND TRAINEE GOALS.
10. FLAGGERS SHALL BE PRESENT DURING ALL CLOSURE HOURS, INCLUDING LUNCH HOUR, AND NO ADDITIONAL COMPENSATION SHALL BE APPLIED.
11. PLAN DIMENSIONS AND DETAILS RELATIVE TO EXISTING PLANS ARE SUBJECT TO NOMINAL CONSTRUCTION VARIATIONS. THE CONTRACTOR SHALL FIELD VERIFY EXISTING DIMENTIONS AND DETAILS AFFECTING CONSTRUCTION AND MAKE NECESSARY APPROVED ADJUSTMENTS PRIOR TO CONSTRUCTION OR ORDERING MATERIALS. SUCH VARIATIONS SHALL NOT BE CAUSE FOR ADDITIONAL COMPESATION FOR A CHANGE IN SCOPE OF WORK, HOWEVER, THE CONTRACTOR WILL BE PAID FOR THE QUANTITY ACTUALLY FURNISHED AT THE UNIT PRICE BID FOR WORK.

**HIGHWAY STANDARDS**

- 000001-06 STANDARD SYMBOLS, ABBREVIATIONS AND PATTERNS
- 001006 DECIMAL OF AN INCH AND OF A FOOT
- 701101-04 OFF-ROAD OPERATION, MULTILANE, 15' (4.5 m) TO 24" (600 mm) FROM PAVEMENT EDGE
- 701106-02 OFF-ROAD OPERATIONS, MULTILANE, MORE THAN 15' (4.5 m) AWAY
- 701422-07 LANE CLOSURE, MULTILANE, FOR SPEEDS ≥ 45 MPH TO 55 MPH
- 701901-04 TRAFFIC CONTROL DEVICES

**COMMITMENTS**

NONE

FILE NAME *	USER NAME * lopezja	DESIGNED -	REVISED -	<b>STATE OF ILLINOIS DEPARTMENT OF TRANSPORTATION</b>	<b>GENERAL NOTES, INDEX OF SHEETS &amp; HIGHWAY STANDARDS</b>	F.A.P. RTE.	SECTION	COUNTY	TOTAL SHEETS	SHEET NO.
c:\pvc\work\pvidoc\llopezja\0600187\0270	37-shr-plan.dgn	DRAWN -	REVISED -			785/2	132-4B-P, 406-8-1-P	MADISON	13	2
PLOT SCALE * 100.0000 / 1/4"	CHECKED -	REVISED -	REVISED -			<b>CONTRACT NO. 76H37</b>				
PLOT DATE * 10/24/2014	DATE -	REVISED -	REVISED -			SCALE: 1/8" = 1'	SHEET NO. 1 OF 1 SHEETS	STA. _____ TO STA. _____	FED. ROAD DIST. NO. - [ILLINOIS] FED. AID PROJECT	

CODE NO.	ITEM	UNIT	TOTAL QUANTITY	CONSTRUCTION CODE		
				100% STATE		
				BRIDGE 0014 060-0200	BRIDGE 0014 060-0187	BRIDGE 0014 060-0190
				URBAN		
67100100	MOBILIZATION	L SUM	1	0.33	0.33	0.34
70100320	TRAFFIC CONTROL AND PROTECTION, STANDARD 701422	L SUM	1	0.33	0.33	0.34
Z0007101	CONTAINMENT AND DISPOSAL OF LEAD PAINT CLEANING RESIDUES NO. 1	L SUM	1	1		
Z0007102	CONTAINMENT AND DISPOSAL OF LEAD PAINT CLEANING RESIDUES NO. 2	L SUM	1		1	
Z0007103	CONTAINMENT AND DISPOSAL OF LEAD PAINT CLEANING RESIDUES NO. 3	L SUM	1			1
Z0010501	CLEANING AND PAINTING STEEL BRIDGE NO. 1	L SUM	1	1		
Z0010502	CLEANING AND PAINTING STEEL BRIDGE NO. 2	L SUM	1		1	
Z0010503	CLEANING AND PAINTING STEEL BRIDGE NO. 3	L SUM	1			1

BRIDGE NO. 1: SN 060-0200  
 BRIDGE NO. 2: SN 060-0187  
 BRIDGE NO. 3: SN 060-0190

SN 060-0187(EB) & 060-0190(WB)

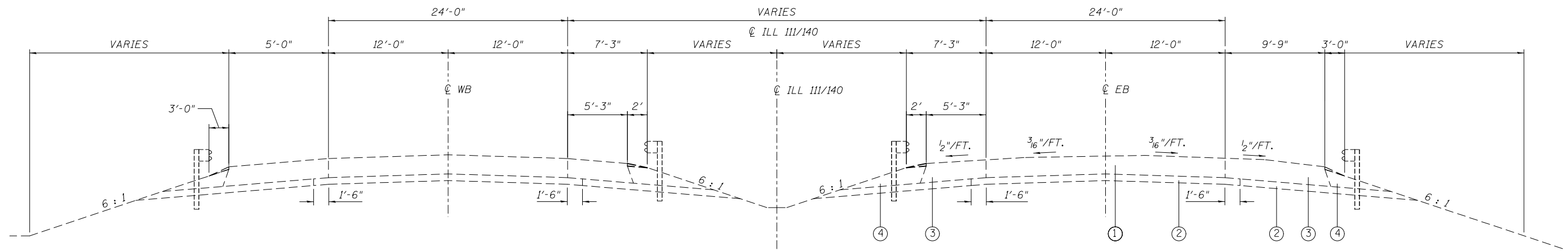

TYPICAL APPROACH SECTION (LOOKING EAST)

- ① EXISTING 8" CRC PAVEMENT
- ② EXISTING 4" STABILIZED SUBBASE
- ③ EXISTING HMA SHOULDER
- ④ EXISTING AGGREGATE SHOULDERS

FILE NAME =	USER NAME = zaldanaor	DESIGNED -	REVISED -
et:\pwork\pwork\zaldanaor\d0400185\d876h37-sh1-plan.dgn		DRAWN -	REVISED -
	PLOT SCALE = 100.0000' / in.	CHECKED -	REVISED -
	PLOT DATE = 9/3/2014	DATE -	REVISED -

STATE OF ILLINOIS  
DEPARTMENT OF TRANSPORTATION

TYPICAL SECTION	
SCALE: NTS	SHEET NO. 1 OF 1 SHEETS
STA.	TO STA.

F.A.P. RTE.	SECTION	COUNTY	TOTAL SHEETS	SHEET NO.
785/2	132-4B-P, 406-B-1-P	MADISON	13	4
FED. ROAD DIST. NO.			ILLINOIS FED. AID PROJECT	
CONTRACT NO. 76H37				



SN 060-0187(EB) & 060-0190(WB)

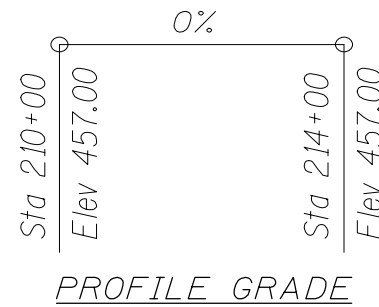
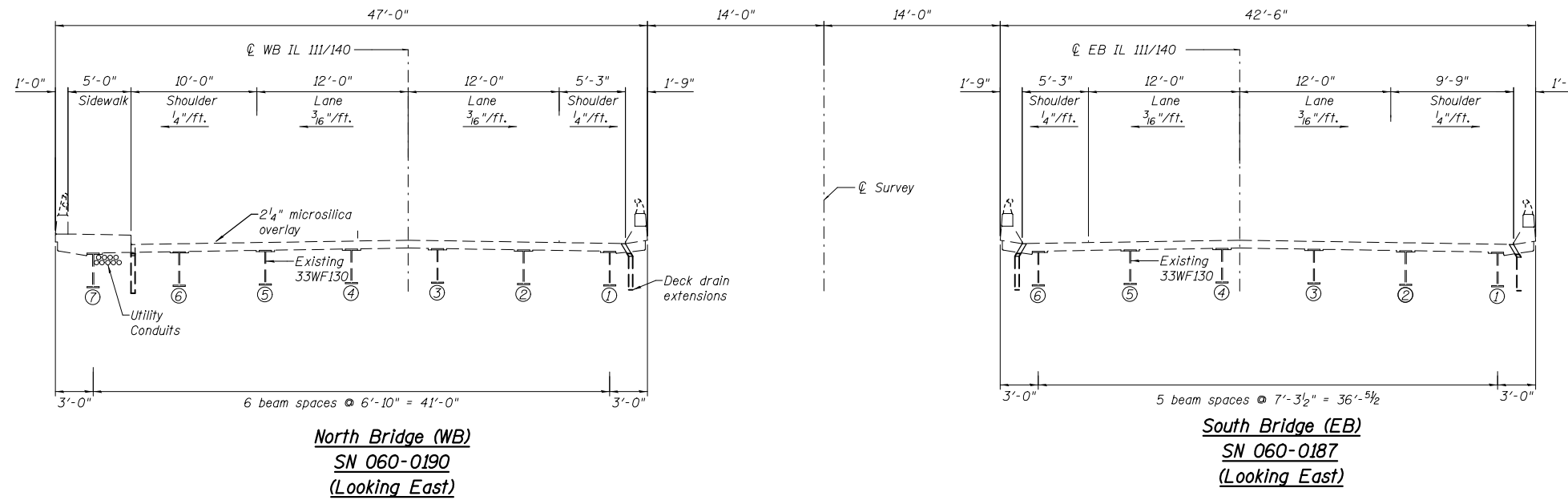

FILE NAME =	USER NAME = zaldanaor	DESIGNED -	REVISED -
et:\pw\work\p\dot\zaldanaor\d0400185\d876h37-sh-t-plan.dgn		DRAWN -	REVISED -
	PLOT SCALE = 100.0000' / in.	CHECKED -	REVISED -
	PLOT DATE = 9/3/2014	DATE -	REVISED -

STATE OF ILLINOIS  
 DEPARTMENT OF TRANSPORTATION

PLAN & ELEVATION

SCALE: NTS      SHEET NO. 1 OF 2 SHEETS      STA.      TO STA.

F.A.P. RTE.	SECTION	COUNTY	TOTAL SHEETS	SHEET NO.
785/2	132-4B-P, 406-B-1-P	MADISON	13	5
CONTRACT NO. 76H37				
FED. ROAD DIST. NO.      ILLINOIS FED. AID PROJECT				



SN 060-0187(EB) & 060-0190(WB)

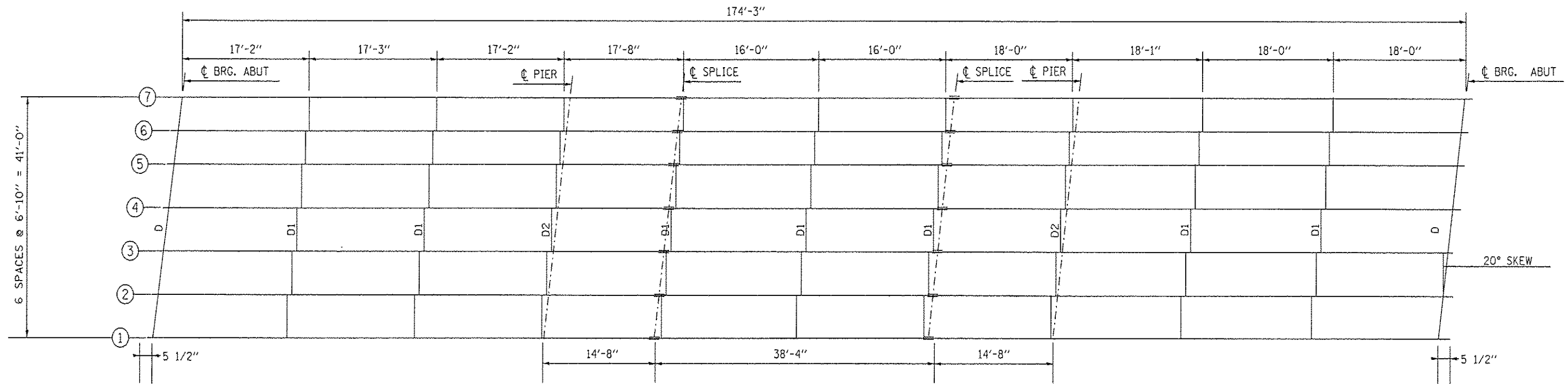

NORTH BRIDGE

ALL BEAMS 33WF130

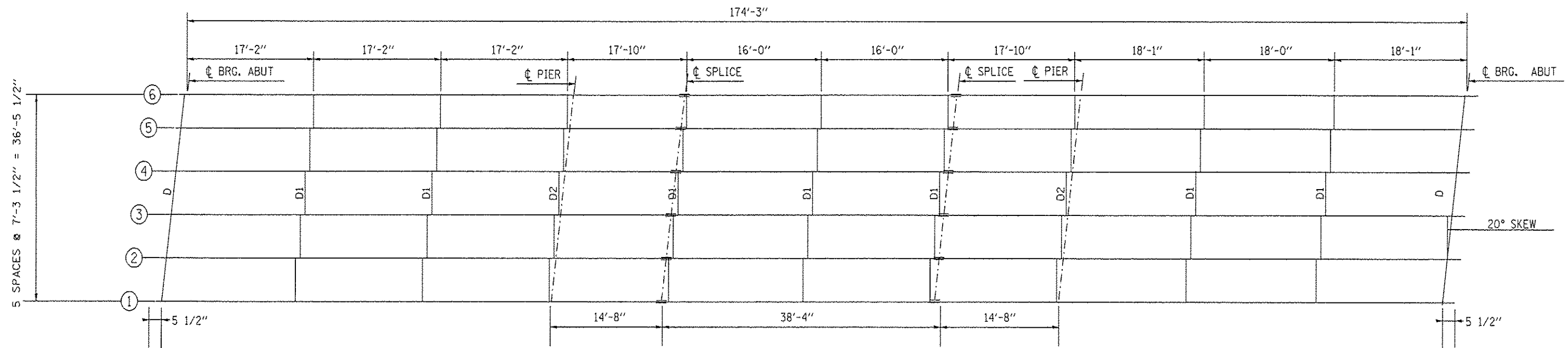

SOUTH BRIDGE

FILE NAME =	USER NAME = zaldonaor	DESIGNED -	REVISED -	<b>STATE OF ILLINOIS DEPARTMENT OF TRANSPORTATION</b>	<b>PLAN SHEET</b>		F.A.P. RTE. =	SECTION	COUNTY	TOTAL SHEETS	SHEET NO.
o:\p\work\p\widot\zaldonaor\d0488185\d076h37-ahb-plan.dgn	DRAWN -	REVISED -	REVISED -		765/2	132-4B-P, 406-B-1-P	MADISON	13	7		
PLOT SCALE = 100.0000' / in.	CHECKED -	REVISED -	REVISED -		CONTRACT NO. 76H37						
PLOT DATE = 9/3/2014	DATE -	REVISED -	REVISED -		SCALE: NTS	SHEET NO. 1 OF 1 SHEETS	STA. TO STA.	FED. ROAD DIST. NO.	ILLINOIS FED. AID PROJECT		

ELEVATION TOP OF WF  
For Fabrication only

NORTH BRIDGE

BEAMS	ELEVATION TOP OF WF						
	7	6	5	4	3	2	1
E. Brg.	455.87	456.01	456.15	456.26	456.29	456.19	456.06
E. & W. Abuts.	455.87	456.01	456.15	456.26	456.29	456.19	456.06
E. Piers 1 & 2	455.87	456.01	456.15	456.26	456.29	456.19	456.06
E. Splices 1 & 2	455.87	456.01	456.15	456.26	456.29	456.19	456.06

SOUTH BRIDGE

BEAMS	ELEVATION TOP OF WF						
	7	6	5	4	3	2	1
E. Brg.	456.06	456.19	456.31	456.24	456.12	455.96	
E. & W. Abuts.	456.06	456.19	456.31	456.24	456.12	455.96	
E. Piers 1 & 2	456.06	456.19	456.31	456.24	456.12	455.96	
E. Splices 1 & 2	456.06	456.19	456.31	456.24	456.12	455.96	

TABLE OF MOMENTS & REACTIONS - INTERIOR BEAMS

D.L.	Moments - Ft. Kips			Reaction - Kips	
	Piers 1 & 2	Abuts.	Piers 1 & 2	Abuts.	Piers 1 & 2
100.0	424.0	20.8	75.8		
350.0	325.0	37.2	45.0		
100.0	87.3	7.0	12.4		
Total	633.7	660.5	132.0		

TABLE OF "I" DIMENSIONS  
FOR ALL ABUTS & PIERS

	Beam 3	All other Beams
NORTH BRIDGE	3"	0"
SOUTH BRIDGE	0"	0"

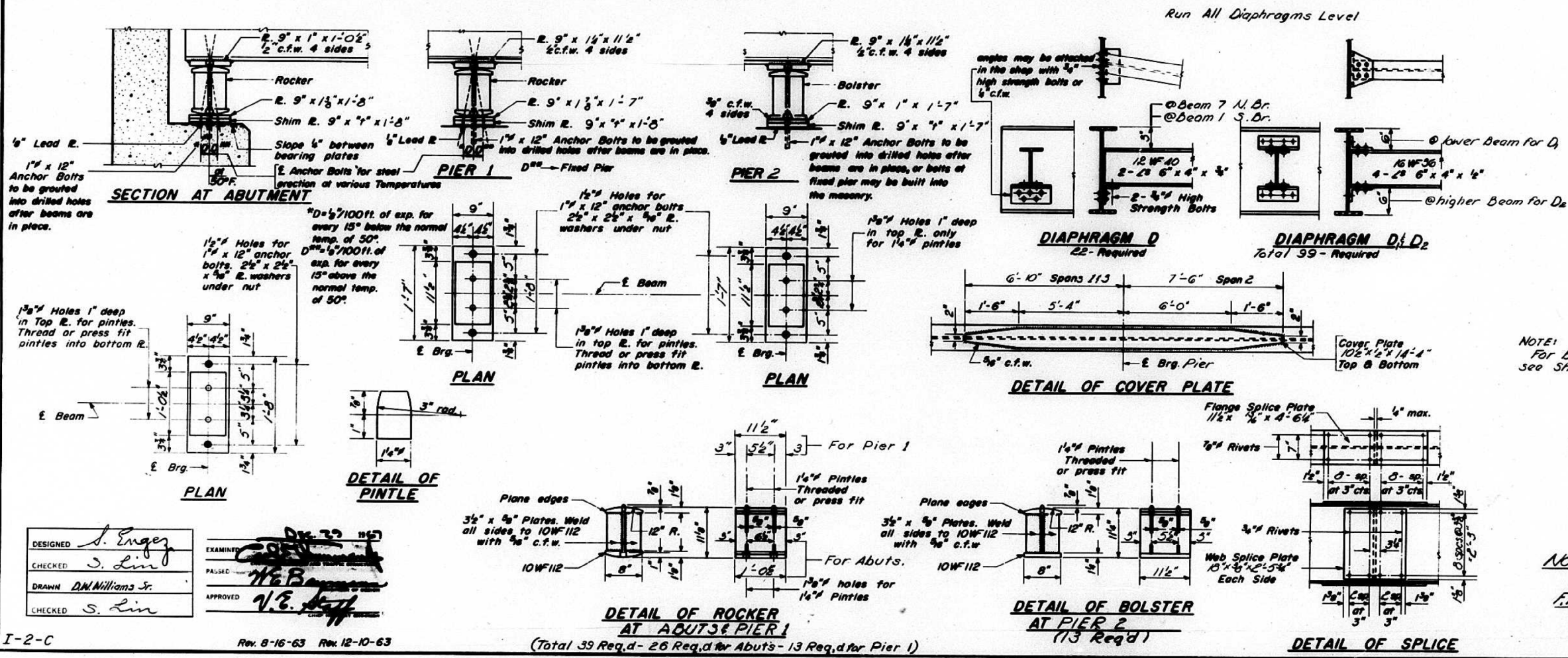

DESIGNED: S. Enger  
CHECKED: S. Lin  
DRAWN: D.M. Williams Jr.  
CHECKED: S. Lin

EXAMINED: [Signature]  
PASSED: [Signature]  
APPROVED: [Signature]

I-2-C Rev. 8-16-63 Rev. 12-10-63

NORTH & SOUTH BRIDGES  
STRUCTURAL STEEL  
F.A. RT. 67 SEC. 132-4B  
MADISON COUNTY  
STA. 212+85.00

SN 060-0200

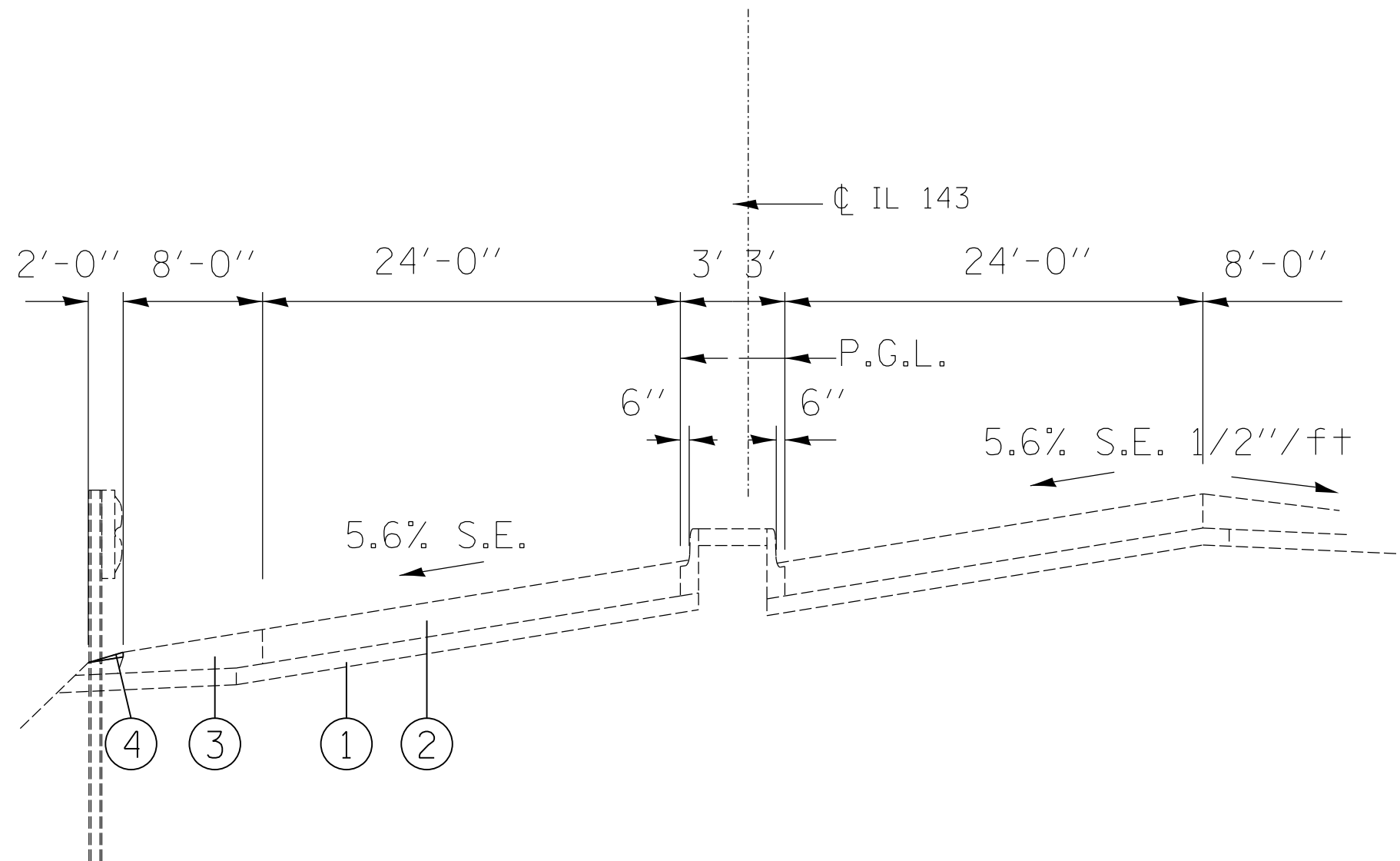

ROADWAY TYPICAL SECTION

- ① EXISTING SUBBASE - 4"
- ② EXISTING CRC PAVEMENT - 7"
- ③ EXISTING HOT-MIX ASPHALT SHOULDER
- ④ EXISTING AGGREGATE SHOULDERS, TYPE B

FILE NAME =	USER NAME = lopez.jc	DESIGNED -	REVISD -	<b>STATE OF ILLINOIS DEPARTMENT OF TRANSPORTATION</b>	<b>TYPICAL SECTIONS</b>		F.A.P. RTE.	SECTION	COUNTY	TOTAL SHEETS	SHEET NO.
c:\pwwork\pwwork\lopez.jc\d0400185\d876	37-sh-t-plen.dgn	DRAWN -	REVISD -				785/2	132-4B-P, 406-B-1-P	MADISON	13	9
PLOT SCALE = 100.0000' / 1"	CHECKED -	REVISD -	REVISD -		<b>CONTRACT NO. 76H37</b>						
PLOT DATE = 10/24/2014	DATE -	REVISD -	REVISD -		FED. ROAD DIST. NO. - ILLINOIS FED. AID PROJECT						

SN 060-0200

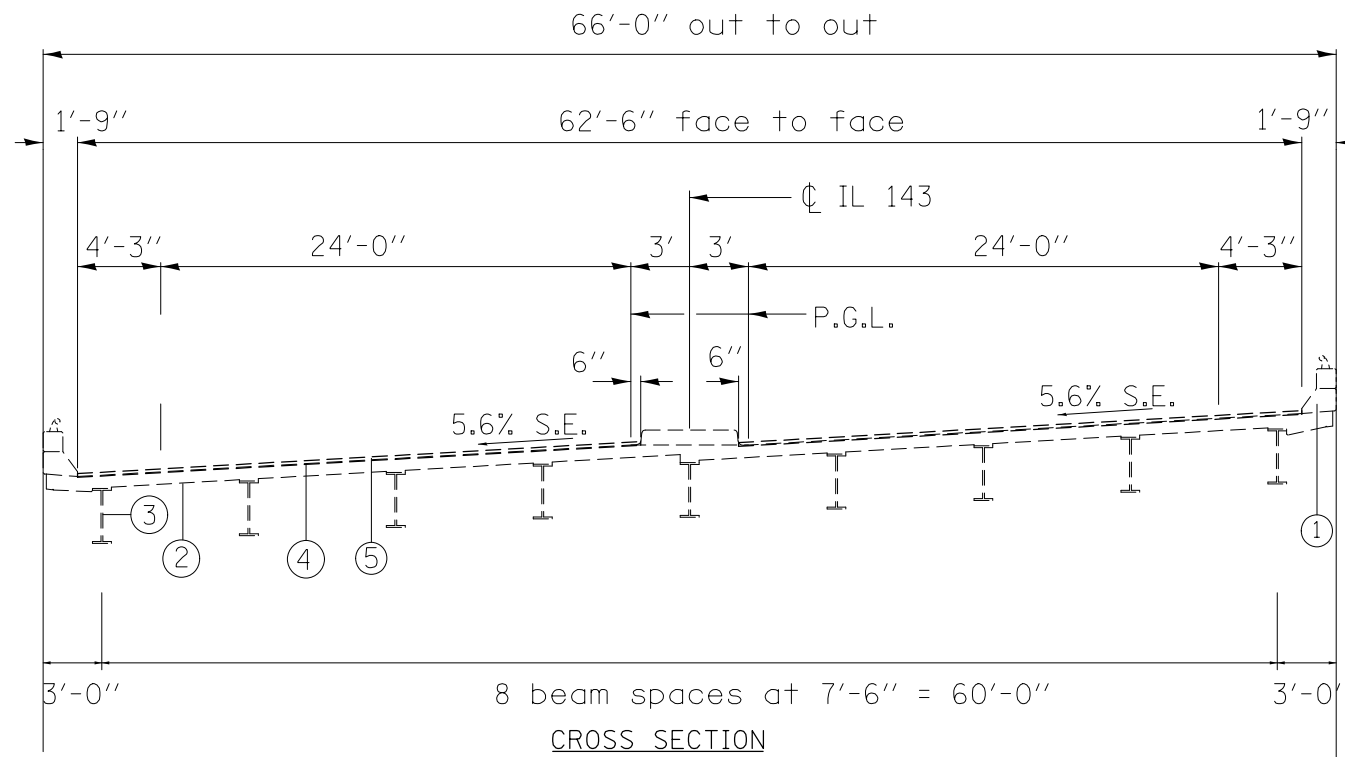
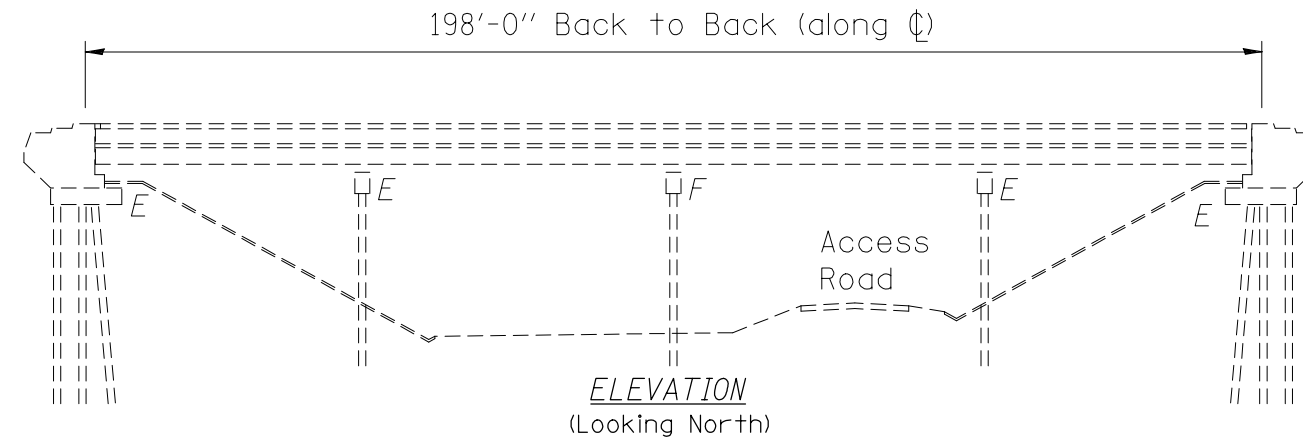

**CROSS SECTION**  
Looking East

- ① EXISTING CONCRETE PARAPET
- ② EXISTING 7 1/2" DECK
- ③ EXISTING W33x118
- ④ EXISTING BRIDGE DECK HYDRO-SCARIFICATION 1/2"
- ⑤ EXISTING BRIDGE DECK MICROSILICA CONCRETE OVERLAY 2 1/4"

FILE NAME =	USER NAME = zaldanaor	DESIGNED -	REVISED -
et:\pw\work\p\dot\zaldanaor\d0400185\d876h37-shr-plan.dgn		DRAWN -	REVISED -
	PLOT SCALE = 100.0000' / in.	CHECKED -	REVISED -
	PLOT DATE = 9/3/2014	DATE -	REVISED -

**STATE OF ILLINOIS**  
**DEPARTMENT OF TRANSPORTATION**

**PLAN & ELEVATION**

SCALE: NTS      SHEET NO. 1 OF 1 SHEETS      STA.      TO STA.

F.A.P. RTE.	SECTION	COUNTY	TOTAL SHEETS	SHEET NO.
785/2	132-4B-P, 406-B-1-P	MADISON	13	10
FED. ROAD DIST. NO. ILLINOIS FED. AID PROJECT			CONTRACT NO. 76H37	

SN 060-0200

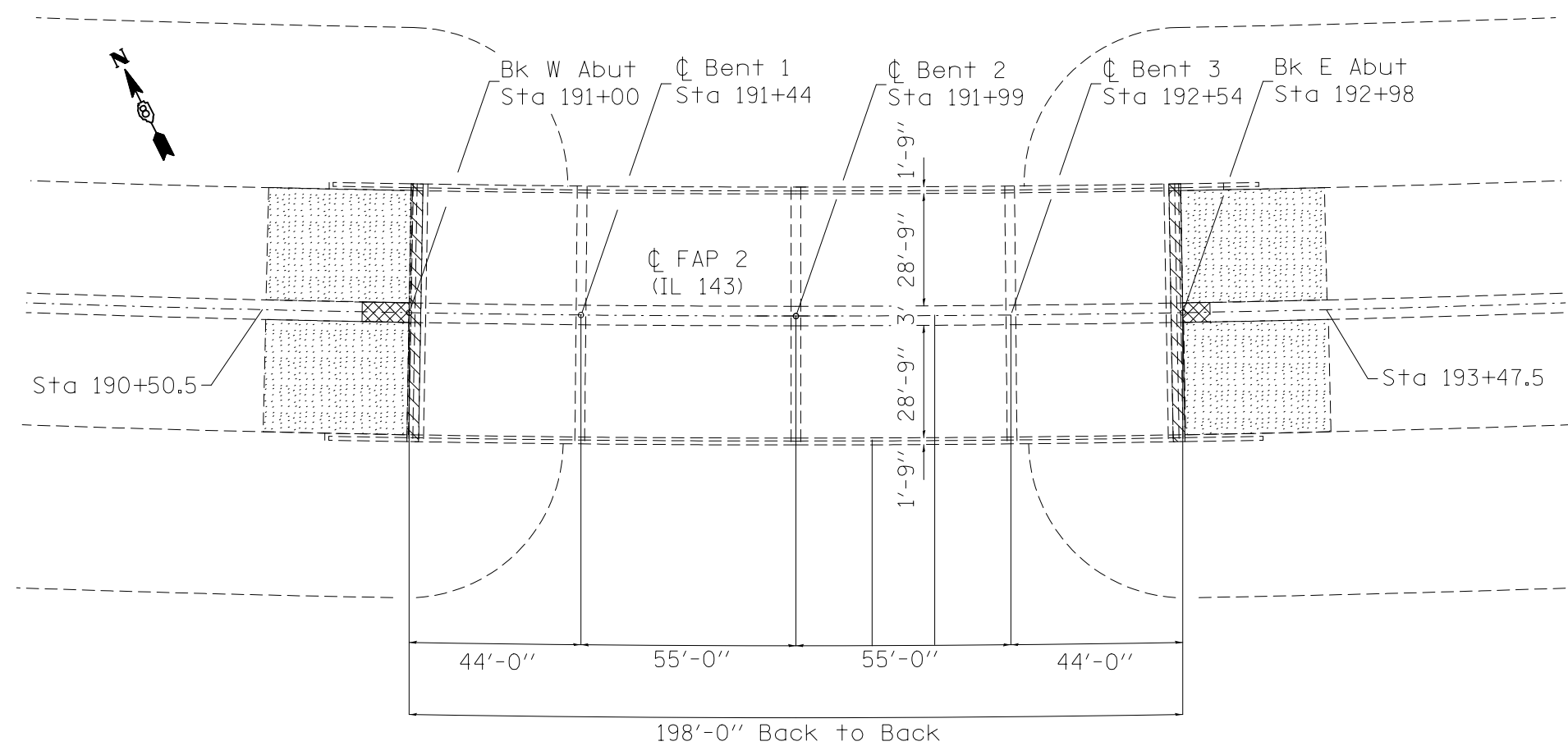

PLAN

FILE NAME =	USER NAME = zaldanaor	DESIGNED -	REVISED -	<b>STATE OF ILLINOIS DEPARTMENT OF TRANSPORTATION</b>	<b>PLAN SHEET</b>		F.A.P. RTE.	SECTION	COUNTY	TOTAL SHEETS	SHEET NO.	
et:\pw\work\p\dot\zaldanaor\d0400185\d876h37-shr-plan.dgn		DRAWN -	REVISED -		785/2	132-4B-P, 406-B-1-P	MADISON	13	11			
	PLOT SCALE = 100.0000' / in.	CHECKED -	REVISED -		SCALE: NTS		SHEET NO. 1 OF 2 SHEETS		STA.	TO STA.	CONTRACT NO. 76H37	
	PLOT DATE = 9/3/2014	DATE -	REVISED -		SCALE: NTS		SHEET NO. 1 OF 2 SHEETS		STA.	TO STA.	CONTRACT NO. 76H37	

SN 060-0200

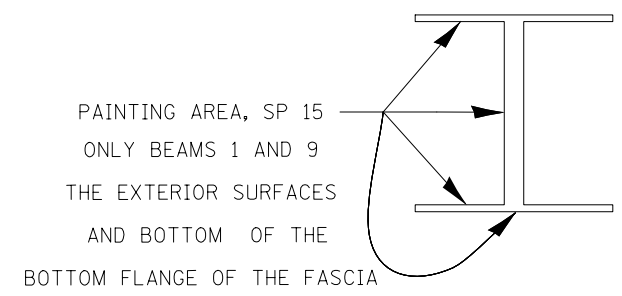
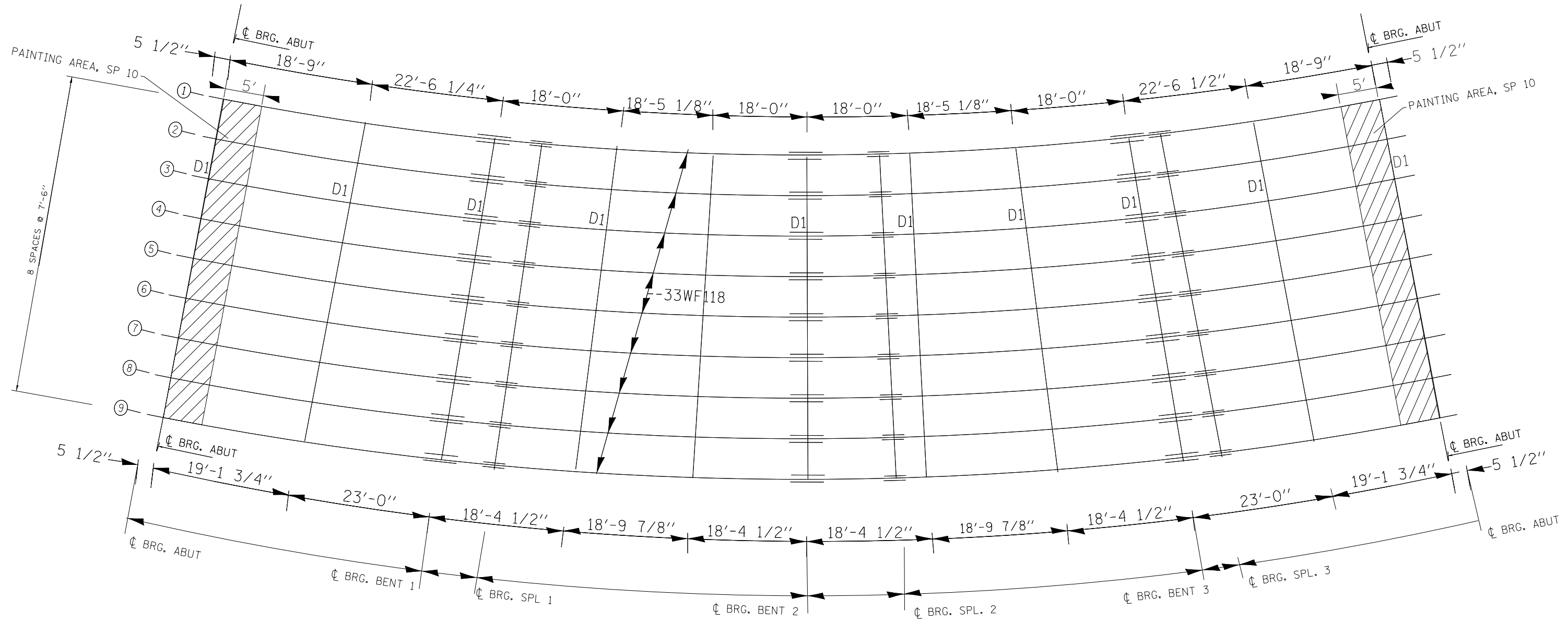

FILE NAME =	USER NAME = zaldanaor	DESIGNED -	REVISED -	<b>STATE OF ILLINOIS DEPARTMENT OF TRANSPORTATION</b>	<b>PLAN SHEET</b>		F.A.P. RTE.	SECTION	COUNTY	TOTAL SHEETS	SHEET NO.		
et:\pw\work\p\idot\zaldanaor\d0400185\d876h37-shr-plan.dgn		DRAWN -	REVISED -		SCALE: NTS	SHEET NO. 2 OF 2 SHEETS	STA.	TO STA.	785/2	132-4B-P, 406-B-1-P	MADISON	13	12
		CHECKED -	REVISED -						CONTRACT NO. 76H37				
		DATE -	REVISED -		FED. ROAD DIST. NO. ILLINOIS FED. AID PROJECT								



STATE OF ILLINOIS  
DEPARTMENT OF PUBLIC WORKS & BUILDINGS  
DIVISION OF HIGHWAYS

PROJECT NO.	SECTION	COUNTY	TOTAL SHEETS	SHEET NO.
155	406B-1	MADISON	18	10
SHEET NO. 7				

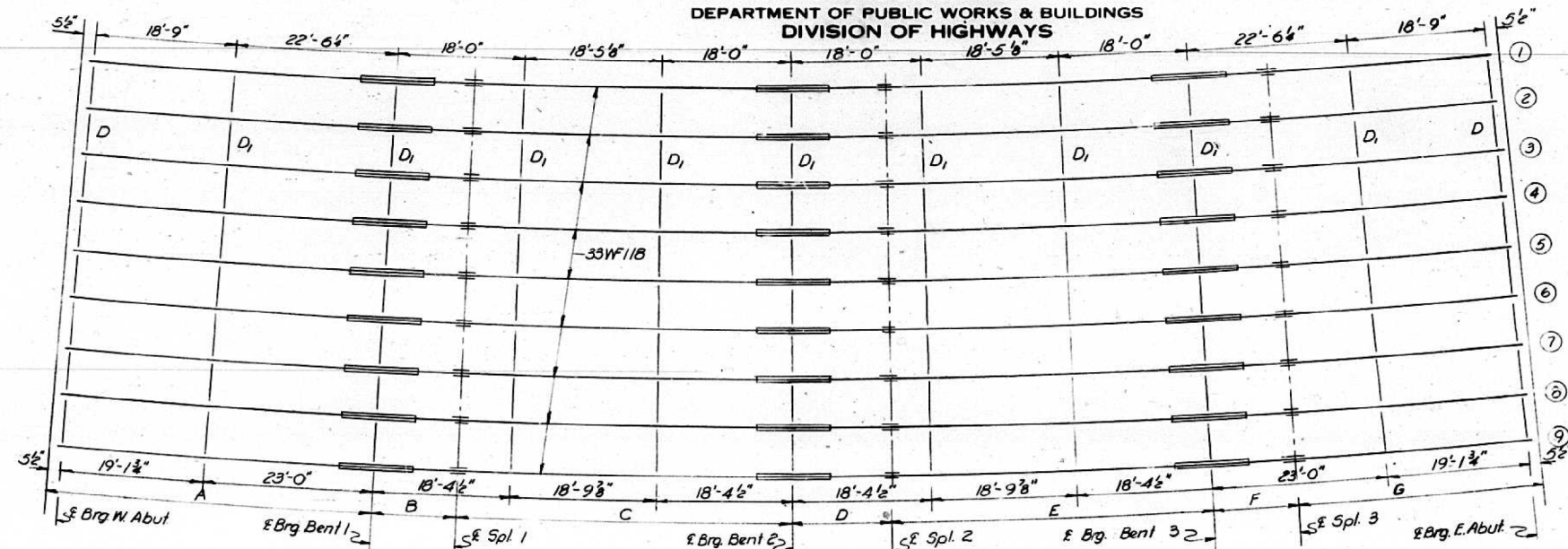

Note:  
Fabricate all beam according to its respective radius.  
All beam spaces 7'-6" radically.  
Place all diaphragms along radius lines.  
See sheet 3 for Moments & Reactions table.

TABLE OF BEAM LENGTHS

Beam	Radius	A	B	C	D
1	2834.79	41'-8 1/2"	10'-10 1/8"	43'-6 1/2"	12'-10 1/8"
2	2842.29	41'-10 1/8"	10'-11"	43'-7 1/8"	12'-10 1/8"
3	2849.79	41'-11 1/4"	10'-11 1/4"	43'-7 1/2"	12'-10 1/8"
4	2857.29	42'-0 1/8"	10'-11 1/2"	43'-7 3/8"	12'-10 1/8"
5	2864.79	42'-2"	11'-0"	44'-0"	13'-0"
6	2872.29	42'-3 1/4"	11'-0 1/4"	44'-1 1/4"	13'-0 1/4"
7	2879.79	42'-4 1/2"	11'-0 1/2"	44'-2 1/2"	13'-0 1/2"
8	2887.29	42'-5 1/2"	11'-1"	44'-4"	13'-1 1/2"
9	2894.79	42'-7 1/4"	11'-1 1/4"	44'-5 1/4"	13'-1 1/4"
E F G Total					
1	41'-6 1/2"	10'-10 1/8"	30'-10 1/8"	192'-3 1/2"	
2	41'-8 1/2"	10'-11"	30'-11"	192'-9 1/2"	
3	41'-9 1/2"	10'-11 1/4"	31'-0"	193'-3 1/2"	
4	41'-10 1/2"	10'-11 1/2"	31'-1"	193'-10"	
5	42'-0"	11'-0"	31'-2"	194'-4"	
6	42'-1 1/4"	11'-0 1/4"	31'-3"	194'-10 1/4"	
7	42'-2 1/2"	11'-0 1/2"	31'-4"	195'-4 1/2"	
8	42'-4"	11'-1"	31'-5 1/4"	195'-10 1/4"	
9	42'-5 1/4"	11'-1 1/4"	31'-6 1/4"	196'-4 1/4"	

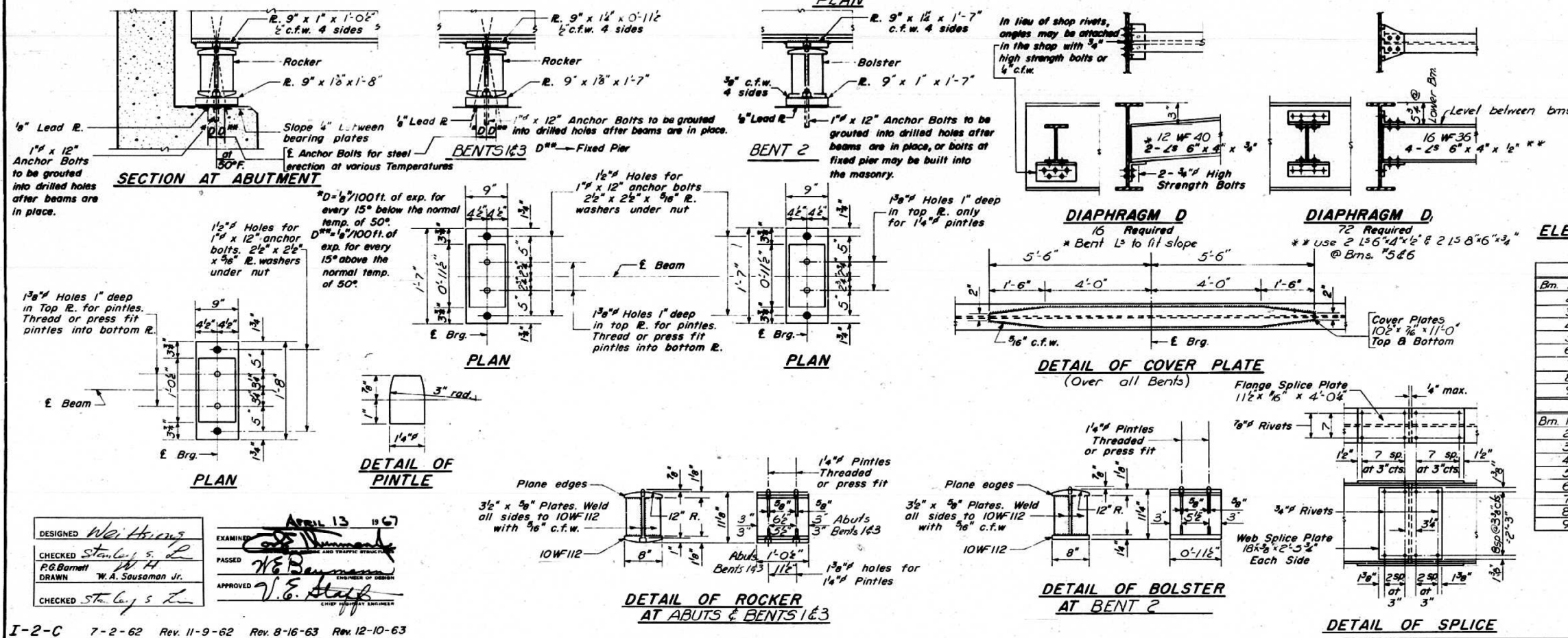

ELEVATION TOP OF W FOR FABRICATION ONLY

Beam	Abutment	Bent 1	Span 1	Bent 2
1	443.64	443.75	443.75	443.84
2	444.06	444.15	444.17	444.26
3	444.48	444.57	444.59	444.68
4	444.90	444.99	445.01	445.10
5	445.32	445.41	445.43	445.52
6	445.74	445.83	445.85	445.94
7	446.16	446.25	446.27	446.36
8	446.58	446.67	446.69	446.78
9	447.00	447.09	447.11	447.20
E Splice 2 E Bent 3 E Splice 3 E Bent E.A.				
1	443.87	443.95	443.97	444.03
2	444.29	444.37	444.39	444.45
3	444.71	444.79	444.81	444.87
4	445.13	445.21	445.23	445.29
5	445.55	445.63	445.65	445.71
6	445.97	446.05	446.07	446.13
7	446.39	446.47	446.49	446.55
8	446.81	446.89	446.91	446.97
9	447.23	447.31	447.33	447.39

STRUCTURAL STEEL  
F.A. RT. 155 SEC. 406B-1  
MADISON COUNTY  
STATION 191+99

DESIGNED: Wei Huang  
CHECKED: Stanley S. L.  
DRAWN: W.A. Sausaman Jr.  
APPROVED: V.E. Stahl  
DATE: APRIL 13 1967

I-2-C 7-2-62 Rev. 11-9-62 Rev. 8-16-63 Rev. 12-10-63