

066

03-06-2020 LETTING ITEM 066

STATE OF ILLINOIS
DEPARTMENT OF TRANSPORTATION

F A P SITE	SECTION	COUNTY	TOTAL SHEETS	SHEET NO
332	1471TS	VERMILION	17	1
		ILLINOIS	CONTRACT NO 70E07	

FOR INDEX OF SHEETS, SEE SHEET NO. 2

PROPOSED HIGHWAY PLANS

FAP ROUTE 332 (IL 1/US 150)
SECTION (47)TS
PROJECT NHPP-4IPS(181)
TRAFFIC SIGNAL MODERNIZATION
VERMILION COUNTY

C-95-052-19

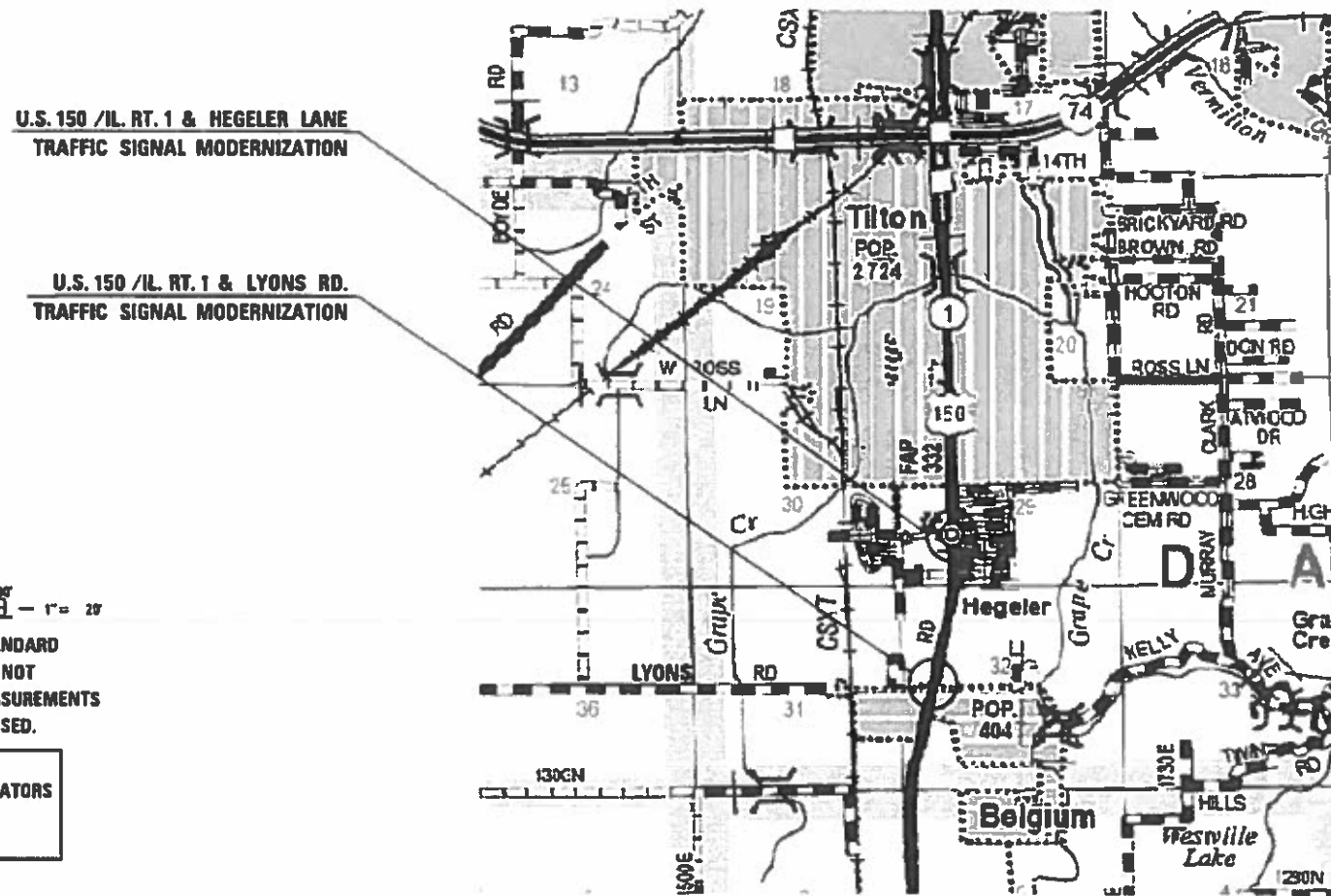

U.S. 150 /IL. RT. 1 & HEGELER LANE
TRAFFIC SIGNAL MODERNIZATION

U.S. 150 /IL. RT. 1 & LYONS RD.
TRAFFIC SIGNAL MODERNIZATION

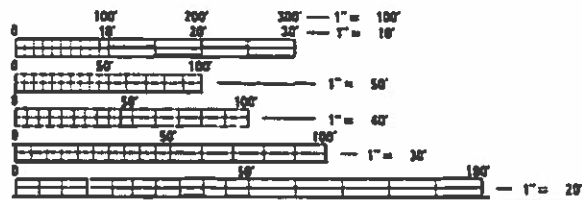

FULL SIZE PLANS HAVE BEEN PREPARED USING STANDARD ENGINEERING SCALES. REDUCED SIZED PLANS WILL NOT CONFORM TO STANDARD SCALES. IN MAKING MEASUREMENTS ON REDUCED PLANS, THE ABOVE SCALES MAY BE USED.

J.U.L.I.E.
JOINT UTILITY LOCATION INFORMATION FOR EXCAVATORS
1-800-892-0123
OR 811

PROJECT ENGINEER: JEFF ALLEN
PROJECT MANAGER: ROGER BIGGS

CONTRACT NO. 70E07

STATE OF ILLINOIS
DEPARTMENT OF TRANSPORTATION

SUBMITTED December 11 2019
[Signature]
REGIONAL ENGINEER

Jan 31 2020
[Signature]
ENGINEER OF DESIGN AND ENVIRONMENT

Jan 31 2020
[Signature]
DIRECTOR OF HIGHWAYS PROJECT IMPLEMENTATION

PRINTED BY THE AUTHORITY
OF THE STATE OF ILLINOIS

GENERAL NOTES

GN 105.07C
 EXISTING STATE-OWNED AND MAINTAINED UNDERGROUND UTILITY FACILITIES EXIST WITHIN THE ROW. THE DEPARTMENT IS NOT A MEMBER OF JULIE AND DOES NOT LOCATE IT'S OWN FACILITIES. THE CONTRACTOR SHALL BE RESPONSIBLE AT THEIR OWN EXPENSE FOR SECURING AN APPROVED LOCATING FIRM TO LOCATE ALL EXISTING IDOT UNDERGROUND FACILITIES PRIOR TO COMMENCING ANY EXCAVATION, PER THE REQUIREMENTS OF ARTICLE 803 OF THE STANDARD SPECIFICATIONS. UTILITY LOCATES MAY ALSO BE REQUIRED OUTSIDE THE PROJECT LIMITS, SUCH AS FOR TRAFFIC CONTROL SIGNING AND OTHER ITEMS. THE CONTRACTOR MAY OBTAIN, ON REQUEST, PLANS OF EXISTING ELECTRICAL FACILITIES FROM THE DEPARTMENT. FOR FURTHER INFORMATION, THE CONTRACTOR MAY CONTACT THE DISTRICT TRAFFIC OPERATIONS ENGINEER, GARY SIMS, AT 217-251-4859.

INDEX OF SHEETS

1	COVER SHEET
2	INDEX OF SHEETS, HIGHWAY STANDARDS, & GENERAL NOTES
3 - 7	SUMMARY OF QUANTITIES
8	LYONS RD TRAFFIC SIGNAL LAYOUT
9	LYONS RD CONDUIT LAYOUT
10	LYONS RD CABLE LAYOUT
11	LYONS RD DETAILS AND BILL OF MATERIALS
12	SCHEDULES
13	HEGELER LANE SIGNAL LAYOUT
14	HEGELER LANE CONDUIT LAYOUT
15	HEGELER LANE CABLE LAYOUT
16	HEGELER LAND DETAILS AND BILL OF MATERIALS
17	DETAILS

TRAFFIC SIGNAL GENERAL NOTES

- THE ACTUAL LOCATION OF ALL SIGNAL FOUNDATIONS, HANDHOLES, AND TRAFFIC CONTROLLER WILL BE DETERMINED IN THE FIELD BY THE ENGINEER.
- THE FINAL LOCATIONS OF ALL TRAFFIC CONTROL ITEMS SHALL BE VERIFIED BY THE ENGINEER IN THE FIELD.
- POST MOUNTED SIGNALS SHALL BE INSTALLED SO THAT NO PART OF THE SIGNAL HEAD IS WITHIN 2 FT. OF THE FACE OF CURB.
- ALL MAST ARM POLES SHALL BE A MINIMUM OF 6 FT. FROM THE CENTER OF THE POLE TO THE FACE OF CURB (ON THE MAST ARM SIDE) OR AS SHOWN ON THE PLANS.
- COMBINATION MAST ARM ASSEMBLIES SHALL BE FURNISHED WITH 15' LUMINAIRE TRUSS ARMS WITH A MOUNTED LUMINAIRE HEIGHT OF 40 FT.
- ALL TRAFFIC SIGNAL MAST ARMS MUST BE DESIGNED FOR THE LOADINGS SHOWN ON THE HIGHWAY STANDARDS OR THESE SIGNAL PLANS, WHICHEVER IS GREATER.
- SIGNAL FACES FOR THE NORTH APPROACH ARE NOTED AS "A","B" FOR THE SOUTH APPROACH,"C" FOR THE WEST APPROACH, AND "D" FOR THE EAST APPROACH.
- ALIGN ADJACENT RED INDICATIONS TO SAME HEIGHT ABOVE PAVEMENT.
- THE BASE FOR A TRAFFIC SIGNAL POST SHALL BE SITUATED SUCH THAT THE HANDHOLE IS LOCATED ON A SIDE AWAY FROM A TRAVELED LANE.
- PEDESTRIAN PUSHBUTTON SIGNAL SIGNS SHALL BE MOUNTED ABOVE THE APPROPRIATE PEDESTRIAN PUSHBUTTON.
- ITEMS REMOVED WILL BECOME THE PROPERTY OF THE CONTRACTOR UNLESS OTHERWISE NOTED ON THE PLANS.
- THE CONTRACTOR SHALL BE RESPONSIBLE FOR OBTAINING ELECTRICAL SERVICE FOR THE TRAFFIC SIGNALS. THE CONTRACTOR SHALL CONTACT THE UTILITY COMPANY PRIOR TO COMMENCEMENT OF WORK TO OBTAIN UTILITY COMPANY REQUIREMENTS FOR THE SERVICE INSTALLATION
- THE CONTRACTOR SHALL SUPPLY AND MOUNT SUPPLEMENTAL SIGNS BY THE MASTARM MOUNTED FYA SIGNAL HEADS STATING "LEFT TURN YIELD ON FLASHING YELLOW ARROW" (R10-1109 AS SHOWN IN THE ILLINOIS STANDARD HIGHWAY SIGNS BOOK - JULY 1, 2014)

STANDARDS TO BE INCLUDED IN THE PLANS

- | | |
|-----------|---|
| 000001-07 | STANDARD SYMBOLS, ABBREVIATIONS AND PATTERNS |
| 001001-02 | AREAS OF REINFORCEMENT BARS |
| 001006 | DECIMAL OF AN INCH AND OF A FOOT |
| 701101-05 | OFF-ROAD OPERATIONS, MULTILANE, MORE THAN 15' (4.5 m) TO 24" (600 MM) FROM PAVMENT EDGE |
| 701106-02 | OFF-ROAD OPERATIONS, MULTILANE, 15' (4.5 m) TO 24" (600 MM) FROM PAVEMENT EDGE |
| 701602-10 | URBAN LANE CLOSURE, MULTILANE, 2W WITH BIDIRECTIONAL LEFT TURN LANE |
| 701701-10 | URBAN LANE CLOSURE, MULTILANE INTERSECTION |
| 701801-06 | SIDEWALK CORNER OR CROSSWALK CLOSURE |
| 701901-08 | TRAFFIC CONTROL DEVICES |
| 720016-04 | MAST ARM MOUNTED STREET NAME SIGNS |
| 780001-05 | TYPICAL PAVEMENT MARKINGS |
| 805001-01 | ELECTRICAL SERVICE INSTALLATION DETAILS |
| 814001-03 | HANDHOLES |
| 814006-02 | DOUBLE HANDHOLES |
| 821101-02 | LUMINAIRE WIRING IN POLE |
| 857001-01 | STANDARD PHASE DESIGNATION DIAGRAMS AND PHASE SEQUENCES |
| 862001-01 | UNINTERRUPTABLE POWER SUPPLY |
| 873001-02 | TRAFFIC SIGNAL GROUNDING & BONDING |
| 876001-04 | PEDESTRIAN PUSH BUTTON POST |
| 877011-10 | STEEL COMB. MAST ARM ASSEMBLY AND POLE 16' THROUGH 55' |
| 878001-10 | CONCRETE FOUNDATION DETAILS |
| 880006-01 | TRAFFIC SIGNAL MOUNTING DETAILS |
| 886001-01 | DETECTOR LOOP INSTALLATIONS |
| 886006-01 | TYPICAL LAYOUTS FOR DETECTION LOOPS |

MODEL: S:\MODEL\NAMES
 FILE NAME: S:\Public\Information\IDOT\Office\District 5\Projects\0570E07\Cadd\Drawings\0570E07-shl-Cover-sheet-Index-500

USER NAME = biggsrd	DESIGNED -	REVISED -	STATE OF ILLINOIS DEPARTMENT OF TRANSPORTATION	GENERAL NOTES, INDEX OF SHEETS & STANDARDS TO BE INCLUDED IN PLANS	F.A.P. RTE.	SECTION	COUNTY	TOTAL SHEETS	SHEET NO.
DRAWN -	REVISID -	332			(47)TS	VERMILION	17	2	
PLOT SCALE = 40.0000 ' / in.	CHECKED -	REVISED -			CONTRACT NO. 70E07				
PLOT DATE = 12/11/2019	DATE -	REVISED -			SCALE: SHEET 1 OF 1 SHEETS STA. TO STA. ILLINOIS FED. AID PROJECT				

SUMMARY OF QUANTITIES

SHEET 1 OF 5

LOCATION OF WORK:	FAP 332	FAP 332
	U.S. 150/IL. 1	U.S. 150/IL. 1
	GEORGETOWN RD	GEORGETOWN RD
	&	&
	LYONS RD	HEGELER LANE
COUNTY:	VERMILION	VERMILION
FUNDING BREAKOUT:	80% FED	80% FED
	20% STATE	20% STATE
CONSTRUCTION TYPE CODE:	0021	0021

CODE NO.	ITEM	UNIT	TOTAL QUANTITY	QUANTITY	QUANTITY
* 66900200	NON-SPECIAL WASTE DISPOSAL	CU YD	30.0	13.5	16.5
* 66900530	SOIL DISPOSAL ANALYSIS	EACH	2.0	1.0	1.0
* 66901001	REGULATED SUBSTANCES PRE-CONSTRUCTION PLAN	LSUM	1.0	0.5	0.5
* 66901003	REGULATED SUBSTANCES FINAL CONSTRUCTION REPORT	LSUM	1.0	0.5	0.5
66901006	REGULATED SUBSTANCES MONITORING	CAL DA	7.0	3.0	4.0
67100100	MOBILIZATION	LSUM	1.0	0.5	0.5
70102632	TRAFFIC CONTROL AND PROTECTION, STANDARD 701602	LSUM	1.0	0.5	0.5
70102635	TRAFFIC CONTROL AND PROTECTION, STANDARD 701701	LSUM	1.0	0.5	0.5
70102640	TRAFFIC CONTROL AND PROTECTION, STANDARD 701801	LSUM	1.0	0.5	0.5
80500100	SERVICE INSTALLATION, TYPE A	EACH	2.0	1.0	1.0
81028320	UNDERGROUND CONDUIT, PVC, 1" DIA.	FOOT	315.0	186.0	129.0
81028340	UNDERGROUND CONDUIT, PVC, 1 1/2" DIA.	FOOT	1,221.0	489.0	732.0

* = SPECIALTY ITEM

MODEL: \\MODEL\MH\MS
FILE NAME: \\p01h01\com\m\dat\illinois.gov\PWIDOT\Documents\DOT_Offices\Director_5\Projects\0570E07_eht-Cover_sheet\Index-500

USER NAME = biggsrd	DESIGNED -	REVISED -	STATE OF ILLINOIS DEPARTMENT OF TRANSPORTATION	SUMMARY OF QUANTITIES SHEET 1 OF 5				F.A.P. RTE.	SECTION	COUNTY	TOTAL SHEETS	SHEET NO.	
PLOT SCALE = 40,0000 ' / in.	CHECKED -	REVISED -		SCALE:	SHEET 1	OF 5	SHEETS	STA.	TO STA.	332	(47)TS	VERMILION	17
PLOT DATE = 12/12/2019	DATE -	REVISED -					ILLINOIS FED. AID PROJECT CONTRACT NO. 70E07						

SUMMARY OF QUANTITIES

SHEET 2 OF 5

LOCATION OF WORK:	FAP 332	FAP 332
	U.S. 150/IL. 1	U.S. 150/IL. 1
	GEORGETOWN RD	GEORGETOWN RD
	&	&
	LYONS RD	HEGELER LANE
COUNTY:	VERMILION	VERMILION
FUNDING BREAKOUT:	80% FED	80% FED
	20% STATE	20% STATE
CONSTRUCTION TYPE CODE:	0021	0021

CODE NO.	ITEM	UNIT	TOTAL QUANTITY	QUANTITY	QUANTITY
81028350	UNDERGROUND CONDUIT, PVC, 2" DIA.	FOOT	683.0	482.0	201.0
81028360	UNDERGROUND CONDUIT, PVC, 2 1/2" DIA.	FOOT	202.0	125.0	77.0
81028370	UNDERGROUND CONDUIT, PVC, 3" DIA.	FOOT	534.0	199.0	335.0
81028390	UNDERGROUND CONDUIT, PVC, 4" DIA.	FOOT	159.0	155.0	4.0
81400100	HANDHOLE	EACH	20.0	12.0	8.0
81400300	DOUBLE HANDHOLE	EACH	2.0	1.0	1.0
81702110	ELECTRIC CABLE IN CONDUIT, 600V (XLP-TYPE USE) 1/C NO. 10	FOOT	2,440.0	1,339.0	1,101.0
82110008	LUMINAIRE, LED, ROADWAY, OUTPUT DESIGNATION H	EACH	8.0	4.0	4.0
85700200	FULL-ACTUATED CONTROLLER AND TYPE IV CABINET	EACH	2.0	1.0	1.0
86200200	UNINTERRUPTABLE POWER SUPPLY, STANDARD	EACH	2.0	1.0	1.0
87300901	ELECTRIC CABLE IN CONDUIT, TRACER, NO. 12 1C	FOOT	2,836.0	1,383.0	1,453.0
87301215	ELECTRIC CABLE IN CONDUIT, SIGNAL NO. 14 2C	FOOT	858.0	416.0	442.0

MODEL: \\MODEL\MAT\...
 FILE: \\MODEL\MAT\...

SUMMARY OF QUANTITIES

SHEET 3 OF 5

LOCATION OF WORK:	FAP 332 U.S. 150/IL. 1 GEORGETOWN RD & LYONS RD	FAP 332 U.S. 150/IL. 1 GEORGETOWN RD & HEGELER LANE
COUNTY:	VERMILION	VERMILION
FUNDING BREAKOUT:	80% FED 20% STATE	80% FED 20% STATE
CONSTRUCTION TYPE CODE:	0021	0021

CODE NO.	ITEM	UNIT	TOTAL QUANTITY	QUANTITY	QUANTITY
87301225	ELECTRIC CABLE IN CONDUIT, SIGNAL NO. 14 3C	FOOT	697.0	486.0	211.0
87301245	ELECTRIC CABLE IN CONDUIT, SIGNAL NO. 14 5C	FOOT	4,194.0	2,243.0	1,951.0
87301255	ELECTRIC CABLE IN CONDUIT, SIGNAL NO. 14 7C	FOOT	2,600.0	1,550.0	1,050.0
87301515	ELECTRIC CABLE IN CONDUIT, LEAD-IN, NO. 18 3 PAIR	FOOT	5,000.0	2,879.0	2,121.0
87301805	ELECTRIC CABLE IN CONDUIT, SERVICE, NO. 6 2 C	FOOT	195.0	36.0	159.0
87301900	ELECTRIC CABLE IN CONDUIT, EQUIPMENT GROUNDING CONDUCTOR, NO. 6 1C	FOOT	1,466.0	884.0	582.0
87502640	TRAFFIC SIGNAL POST, ALUMINUM 10 FT.	EACH	3.0	3.0	
87502660	TRAFFIC SIGNAL POST, ALUMINUM 12 FT.	EACH	2.0	1.0	1.0
87502680	TRAFFIC SIGNAL POST, ALUMINUM 14 FT.	EACH	3.0	3.0	
87502700	TRAFFIC SIGNAL POST, ALUMINUM 16 FT.	EACH	2.0		2.0
87601200	PEDESTRIAN PUSH-BUTTON POST, GALVANIZED STEEL, TYPE II	EACH	4.0	2.0	2.0
87702840	STEEL COMBINATION MAST ARM ASSEMBLY AND POLE 22 FT.	EACH	2.0	2.0	

MODEL: \\MODEL\MHMS
 FILE: \\MAILS_PUB\pubmail\comad\at\links\gov\PI\DOT\Documents\DOT_Offices\Dir\trct_5\Projects\0570E07\CADD\Drawings\0570E07.dwg-Cover_sheet-Index-500

USER NAME = biggsrd	DESIGNED -	REVISED -
	DRAWN -	REVISED -
PLOT SCALE = 40.0000 ' / in.	CHECKED -	REVISED -
PLOT DATE = 12/11/2019	DATE -	REVISED -

**STATE OF ILLINOIS
DEPARTMENT OF TRANSPORTATION**

**SUMMARY OF QUANTITIES
SHEET 3 OF 5**

SCALE: SHEET 3 OF 5 SHEETS STA. TO STA.

F.A.P. RTE.	SECTION	COUNTY	TOTAL SHEETS	SHEET NO.
332	(47)TS	VERMILION	17	5
CONTRACT NO. 70E07				
ILLINOIS FED. AID PROJECT				

SUMMARY OF QUANTITIES

SHEET 4 OF 5

LOCATION OF WORK:	FAP 332 U.S. 150/IL. 1 GEORGETOWN RD	FAP 332 U.S. 150/IL. 1 GEORGETOWN RD & HEGELER LANE
COUNTY:	LYONS RD VERMILION	VERMILION
FUNDING BREAKOUT:	80% FED 20% STATE	80% FED 20% STATE
CONSTRUCTION TYPE CODE:	0021	0021

CODE NO.	ITEM	UNIT	TOTAL QUANTITY	QUANTITY	QUANTITY
87702880	STEEL COMBINATION MAST ARM ASSEMBLY AND POLE 30 FT.	EACH	1.0		1.0
87702940	STEEL COMBINATION MAST ARM ASSEMBLY AND POLE 42 FT.	EACH	1.0	1.0	
87702960	STEEL COMBINATION MAST ARM ASSEMBLY AND POLE 46 FT.	EACH	1.0	1.0	
87702980	STEEL COMBINATION MAST ARM ASSEMBLY AND POLE 50 FT.	EACH	1.0		1.0
87702985	STEEL COMBINATION MAST ARM ASSEMBLY AND POLE 52 FT.	EACH	1.0		1.0
87702990	STEEL COMBINATION MAST ARM ASSEMBLY AND POLE 54 FT.	EACH	1.0		1.0
87800100	CONCRETE FOUNDATION, TYPE A	FOOT	31.0	21.7	9.3
87800150	CONCRETE FOUNDATION, TYPE C	FOOT	7.0	3.5	3.5
87800400	CONCRETE FOUNDATION, TYPE E 30-INCH DIAMETER	FOOT	30.0	20.0	10.0
87800415	CONCRETE FOUNDATION, TYPE E 36-INCH DIAMETER	FOOT	71.0	26.0	45.0
88040070	SIGNAL HEAD, POLYCARBONATE, LED, 1-FACE, 3-SECTION, BRACKET MOUNTED	EACH	5.0	2.0	3.0
88040090	SIGNAL HEAD, POLYCARBONATE, LED, 1-FACE, 3-SECTION, MAST ARM MOUNTED	EACH	16.0	8.0	8.0

MODEL: \\MODEL\MHMS
FILE: \\MAILS_PUB\pubmail\com\ma\data\illinois.gov\PI\DOT\Documents\DOT_Offices\Illin\dot 5\Projects\0570E07\shl-Cover_sheets\Index-S00

USER NAME = biggsrd	DESIGNED -	REVISED -
	DRAWN -	REVISED -
PLOT SCALE = 40.0000 ' / in.	CHECKED -	REVISED -
PLOT DATE = 12/11/2019	DATE -	REVISED -

**STATE OF ILLINOIS
DEPARTMENT OF TRANSPORTATION**

**SUMMARY OF QUANTITIES
SHEET 4 OF 5**

SCALE: SHEET 4 OF 5 SHEETS STA. TO STA.

F.A.P. RTE.	SECTION	COUNTY	TOTAL SHEETS	SHEET NO.
332	(47)TS	VERMILION	17	6
CONTRACT NO. 70E07				
ILLINOIS FED. AID PROJECT				

SUMMARY OF QUANTITIES

SHEET 5 OF 5

LOCATION OF WORK:	FAP 332 U.S. 150/IL. 1 GEORGETOWN RD & LYONS RD VERMILION 80% FED 20% STATE	FAP 332 U.S. 150/IL. 1 GEORGETOWN RD & HEGELER LANE VERMILION 80% FED 20% STATE
COUNTY:	LYONS RD	HEGELER LANE
FUNDING BREAKOUT:	VERMILION 80% FED 20% STATE	VERMILION 80% FED 20% STATE
CONSTRUCTION TYPE CODE:	0021	0021

CODE NO.	ITEM	UNIT	QUANTITY	QUANTITY	QUANTITY
88040120	SIGNAL HEAD, POLYCARBONATE, LED, 1-FACE, 4-SECTION, MAST ARM MOUNTED	EACH	4.0	2.0	2.0
88040250	SIGNAL HEAD, POLYCARBONATE, LED, 2-FACE, 1-3 SECTION, 1-4 SECTION, BRACKET MOUNTED	EACH	4.0	2.0	2.0
88102825	PEDESTRIAN SIGNAL HEAD, POLYCARBONATE, LED, 1-FACE, BRACKET MOUNTED WITH COUNT DOWN TIMER	EACH	14.0	8.0	6.0
88200510	TRAFFIC SIGNAL BACKPLATE, RETROREFLECTIVE	EACH	32.0	16.0	16.0
88500100	INDUCTIVE LOOP DETECTOR	EACH	19.0	10.0	9.0
88600100	DETECTOR LOOP, TYPE I	FOOT	2,142.0	1,224.0	918.0
88800100	PEDESTRIAN PUSH-BUTTON	EACH	14.0	8.0	6.0
89502375	REMOVE EXISTING TRAFFIC SIGNAL EQUIPMENT	EACH	2.0	1.0	1.0
89502380	REMOVE EXISTING HANDHOLE	EACH	15.0	11.0	4.0
89502385	REMOVE EXISTING CONCRETE FOUNDATION	EACH	22.0	13.0	9.0
X0326266	ETHERNET SWITCH	EACH	2.0	1.0	1.0
X1400351	WOOD POLE, 35 FT, CLASS 4	EACH	2.0	1.0	1.0

MODEL: s:\MODEL\MHFS
 FILE: MHFS: s:\pub\mcom\mdata\illinois\gov\PIWDOT\Documents\DOT_Offices\Illinet\ s:\projects\0570E07\CADDData\Design\0570E07.sht-Cover_sheet-Index-500

USER NAME = biggsrd	DESIGNED -	REVISED -
	DRAWN -	REVISED -
PLOT SCALE = 40,0000 ' / in.	CHECKED -	REVISED -
PLOT DATE = 12/11/2019	DATE -	REVISED -

**STATE OF ILLINOIS
DEPARTMENT OF TRANSPORTATION**

**SUMMARY OF QUANTITIES
SHEET 5 OF 5**

SCALE: SHEET 5 OF 5 SHEETS STA. TO STA.

F.A.P. RTE.	SECTION	COUNTY	TOTAL SHEETS	SHEET NO.
332	(47)TS	VERMILION	17	7
CONTRACT NO. 70E07				
ILLINOIS FED. AID PROJECT				

TRAFFIC SIGNAL INSTALLATION

F.A.P. 332 (U.S. 150/IL. Rte. 1/Georgetown Rd.)

&
Lyons (Catlin Rd.) / Smith Rd.

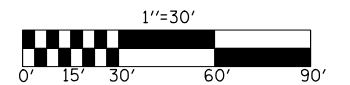

SIGNAL LAYOUT

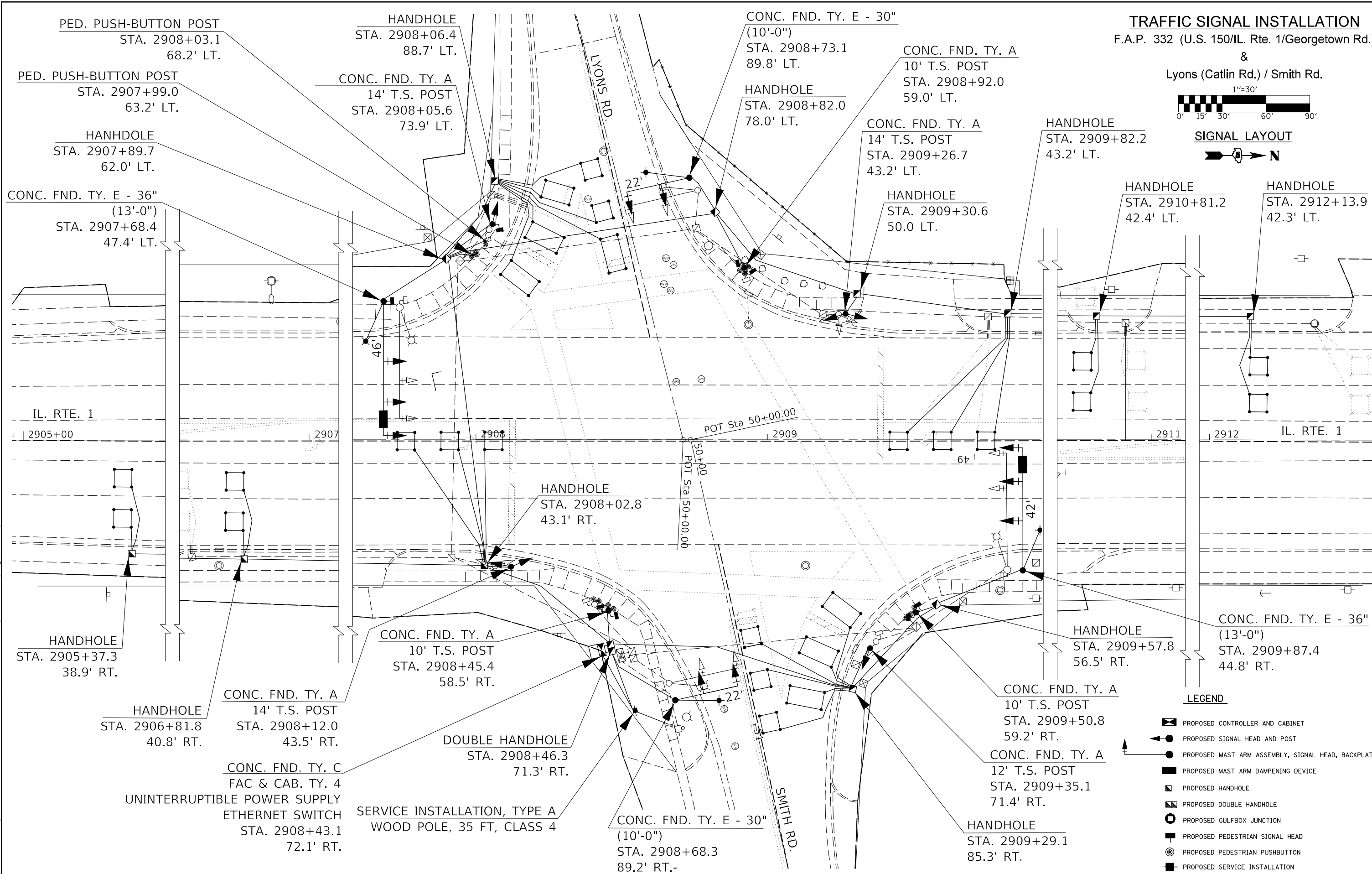

LEGEND

- PROPOSED CONTROLLER AND CABINET
- PROPOSED SIGNAL HEAD AND POST
- PROPOSED MAST ARM ASSEMBLY, SIGNAL HEAD, BACKPLATE
- PROPOSED MAST ARM DAMPENING DEVICE
- PROPOSED HANDHOLE
- PROPOSED DOUBLE HANDHOLE
- PROPOSED GULFBBOX JUNCTION
- PROPOSED PEDESTRIAN SIGNAL HEAD
- PROPOSED PEDESTRIAN PUSHBUTTON
- PROPOSED SERVICE INSTALLATION

USER NAME = biggsrd	DESIGNED -	REVISED -
	DRAWN -	REVISED -
PLOT SCALE = 30.0000' / in.	CHECKED -	REVISED -
PLOT DATE = 12/12/2019	DATE -	REVISED -

**STATE OF ILLINOIS
DEPARTMENT OF TRANSPORTATION**

**U.S. 150 & Lyons Rd.
Traffic Signal Layout**

SCALE: 1" = 30' SHEET 1 OF 1 SHEETS STA. 2905+00 TO STA. 2912+55

F.A.P. RTE.	SECTION	COUNTY	TOTAL SHEETS	SHEET NO.
332	(47)TS	VERMILION	17	8
CONTRACT NO. 70E07				
ILLINOIS FED. AID PROJECT				

MODEL: s:\MODEL\MARTE
 FILE: MARTE_Plan\Submittal\DOT\Documents\DOT_Office\Drawings\Projects\0570E07-sh-5\Signal_Lyons_Road.dgn

TRAFFIC SIGNAL INSTALLATION

F.A.P. 332 (U.S. 150/IL. Rte. 1/Georgetown Rd.)

&
Lyons (Catlin Rd.) / Smith Rd.

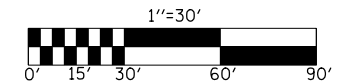

CONDUIT LAYOUT

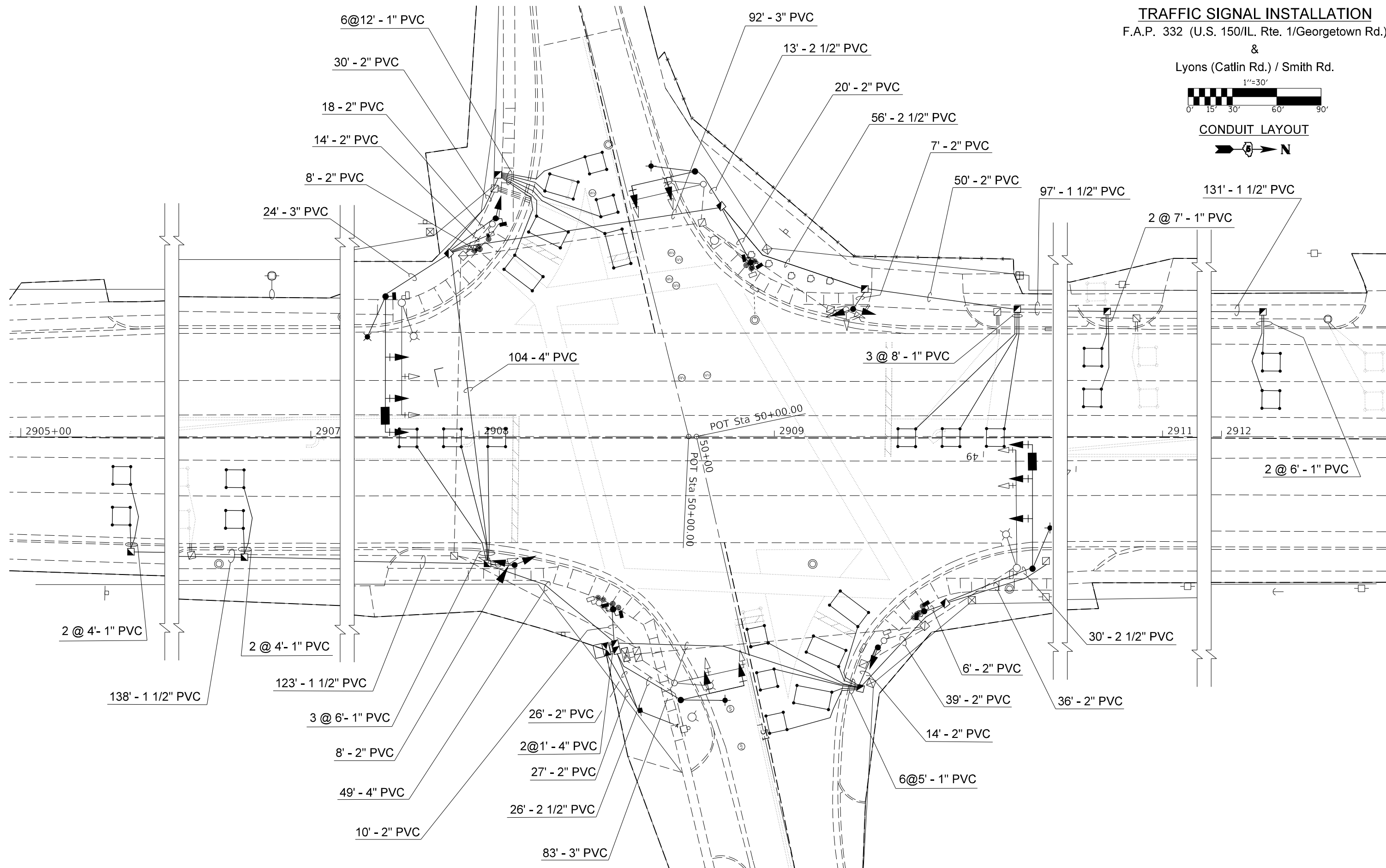
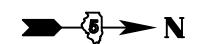

MODEL: s:\MODEL\MAR18
 FILE: MAR18: s:\pub\mcom\mdata\illinois\pwr\DOT\Documents\DOT - Offices\Dir\trct_5\Projects\0570E07\CADD\data\Design\0570E07-sh-TrafficSignal_Lyons_Road.dgn

USER NAME = biggsrd	DESIGNED -	REVISED -
	DRAWN -	REVISED -
PLOT SCALE = 30.0000 ' / in.	CHECKED -	REVISED -
PLOT DATE = 12/11/2019	DATE -	REVISED -

STATE OF ILLINOIS
DEPARTMENT OF TRANSPORTATION

U.S. 150 & Lyons Rd.
Traffic Signal Conduit Layout

SCALE: 1" = 30' SHEET 1 OF 1 SHEETS STA. 2905+00 TO STA. 2912+55

F.A.P. RTE.	SECTION	COUNTY	TOTAL SHEETS	SHEET NO.
332	(47)TS	VERMILION	17	9
CONTRACT NO. 70E07				
ILLINOIS FED. AID PROJECT				

TRAFFIC SIGNAL INSTALLATION

F.A.P. 332 (U.S. 150/IL. Rte. 1/Georgetown Rd.)

&
Lyons (Catlin Rd.) / Smith Rd.

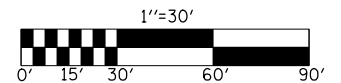

CABLE LAYOUT

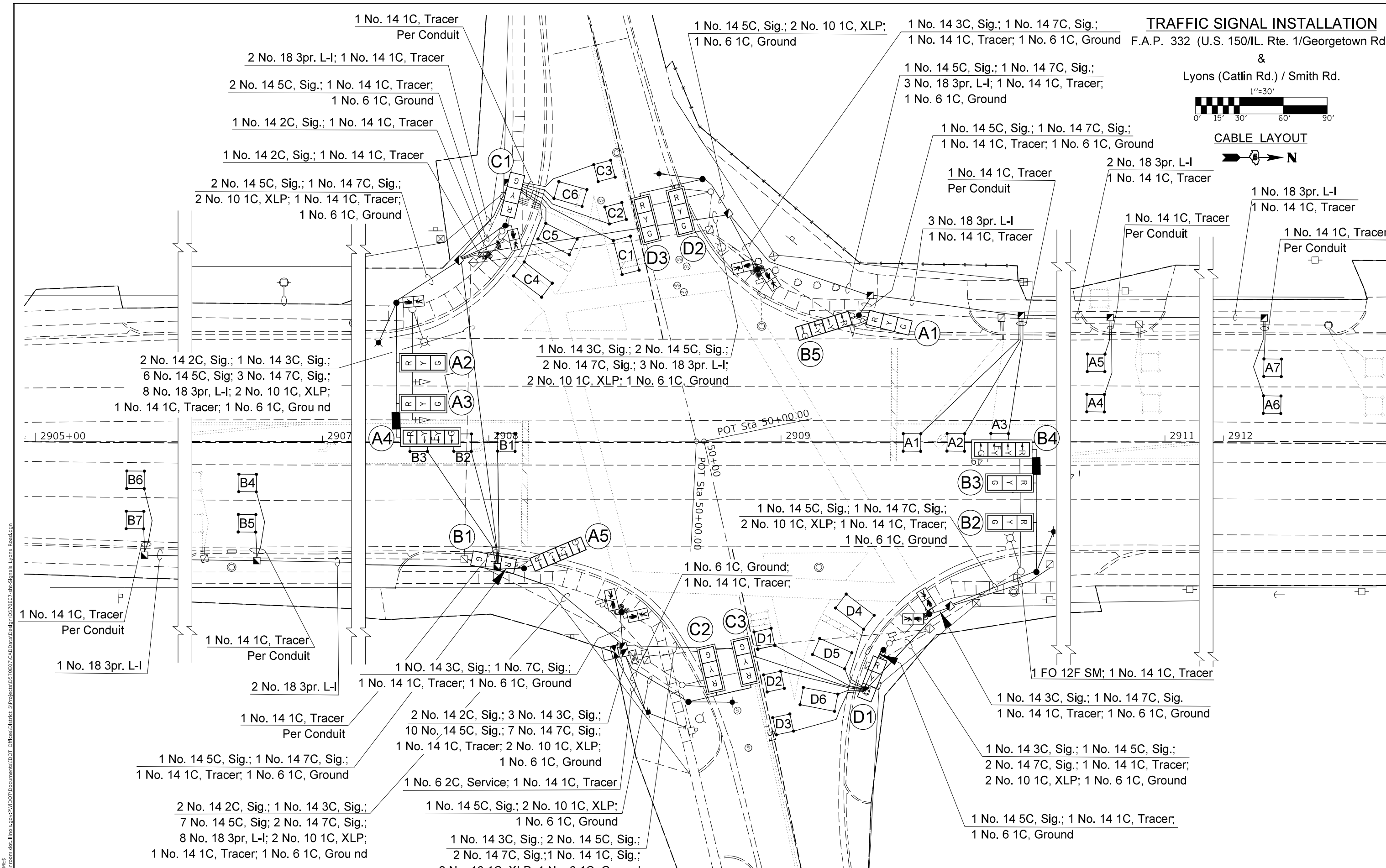

1 No. 14 1C, Tracer
Per Conduit

2 No. 18 3pr. L-I; 1 No. 14 1C, Tracer

2 No. 14 5C, Sig.; 1 No. 14 1C, Tracer;
1 No. 6 1C, Ground

1 No. 14 2C, Sig.; 1 No. 14 1C, Tracer

1 No. 14 2C, Sig.; 1 No. 14 1C, Tracer

2 No. 14 5C, Sig.; 1 No. 14 7C, Sig.;
2 No. 10 1C, XLP; 1 No. 14 1C, Tracer;
1 No. 6 1C, Ground

2 No. 14 2C, Sig.; 1 No. 14 3C, Sig.;
6 No. 14 5C, Sig.; 3 No. 14 7C, Sig.;
8 No. 18 3pr. L-I; 2 No. 10 1C, XLP;
1 No. 14 1C, Tracer; 1 No. 6 1C, Ground

1 No. 14 3C, Sig.; 2 No. 14 5C, Sig.;
2 No. 14 7C, Sig.; 3 No. 18 3pr. L-I;
2 No. 10 1C, XLP; 1 No. 6 1C, Ground

1 No. 14 5C, Sig.; 1 No. 14 7C, Sig.;
2 No. 10 1C, XLP; 1 No. 14 1C, Tracer;
1 No. 6 1C, Ground

1 No. 6 1C, Ground;
1 No. 14 1C, Tracer;

1 No. 14 3C, Sig.; 1 No. 7C, Sig.;
1 No. 14 1C, Tracer; 1 No. 6 1C, Ground

2 No. 14 2C, Sig.; 3 No. 14 3C, Sig.;
10 No. 14 5C, Sig.; 7 No. 14 7C, Sig.;
1 No. 14 1C, Tracer; 2 No. 10 1C, XLP;
1 No. 6 1C, Ground

1 No. 6 2C, Service; 1 No. 14 1C, Tracer

1 No. 14 5C, Sig.; 2 No. 10 1C, XLP;
1 No. 6 1C, Ground

1 No. 14 3C, Sig.; 2 No. 14 5C, Sig.;
2 No. 14 7C, Sig.; 1 No. 14 1C, Sig.;
2 No. 10 1C, XLP; 1 No. 6 1C, Ground

1 No. 14 3C, Sig.; 1 No. 14 7C, Sig.;
1 No. 14 1C, Tracer; 1 No. 6 1C, Ground

1 No. 14 5C, Sig.; 1 No. 14 7C, Sig.;
3 No. 18 3pr. L-I; 1 No. 14 1C, Tracer;
1 No. 6 1C, Ground

1 No. 14 5C, Sig.; 1 No. 14 7C, Sig.;
1 No. 14 1C, Tracer; 1 No. 6 1C, Ground

1 No. 14 1C, Tracer
Per Conduit

3 No. 18 3pr. L-I
1 No. 14 1C, Tracer

2 No. 18 3pr. L-I
1 No. 14 1C, Tracer

1 No. 14 1C, Tracer
Per Conduit

1 No. 18 3pr. L-I
1 No. 14 1C, Tracer

1 No. 14 1C, Tracer
Per Conduit

1 FO 12F SM; 1 No. 14 1C, Tracer

1 No. 14 3C, Sig.; 1 No. 14 7C, Sig.
1 No. 14 1C, Tracer; 1 No. 6 1C, Ground

1 No. 14 3C, Sig.; 1 No. 14 5C, Sig.;
2 No. 14 7C, Sig.; 1 No. 14 1C, Tracer;
2 No. 10 1C, XLP; 1 No. 6 1C, Ground

1 No. 14 5C, Sig.; 1 No. 14 1C, Tracer;
1 No. 6 1C, Ground

USER NAME = biggsrd	DESIGNED -	REVISD -
	DRAWN -	REVISD -
PLOT SCALE = 30.0000' / in.	CHECKED -	REVISD -
PLOT DATE = 12/11/2019	DATE -	REVISD -

**STATE OF ILLINOIS
DEPARTMENT OF TRANSPORTATION**

**U.S. 150 & Lyons Rd.
Traffic Signal Cable Layout**

SCALE: 1" = 30' SHEET 1 OF 1 SHEETS STA. 2905+00 TO STA. 2912+55

F.A.P. RTE. 332	SECTION (47)TS	COUNTY VERMILION	TOTAL SHEETS 17	SHEET NO. 10
CONTRACT NO. 70E07				
ILLINOIS FED. AID PROJECT				

MODEL: s:\MODEL\MARF...
 FILE: MARF...
 PROJECT: s:\PROJECTS\0570E07\CADD\DATA\DESIGN\0570E07-24T-SIGNALS-LYONS-ROAD.dwg
 PLOT DATE: 12/11/2019

DETECTOR LOOP DATA				
IL. 1 & Lyons Rd				
Loop	Length	Width	Number of Turns	Delay (sec.)
A1-3	6	6	5	
A4-5	6	6	6	
A6-7	6	6	6	
B1-3	6	6	3	
B4-5	6	6	4	
B6-7	6	6	4	
C1	12	6	3	
C2-3	6	6	4	
C4-5	6	12	3	8
C6	6	10	3	8
D1-3	6	6	3	
D4-6	6	12	3	8

THE FOLLOWING LOOPS SHALL BE WIRED TO COMMON AMPLIFIERS: (A1, A2, A3), (A4, A5), (A6, A7), (B1, B2, B3), (B4, B5), (B6, B7), (C1, C2, C3), (C4, C5, C6), (D1, D2, D3), (D4, D5, D6)

10 AMPLIFIERS REQUIRED

PHASE DESIGNATION DIAGRAM

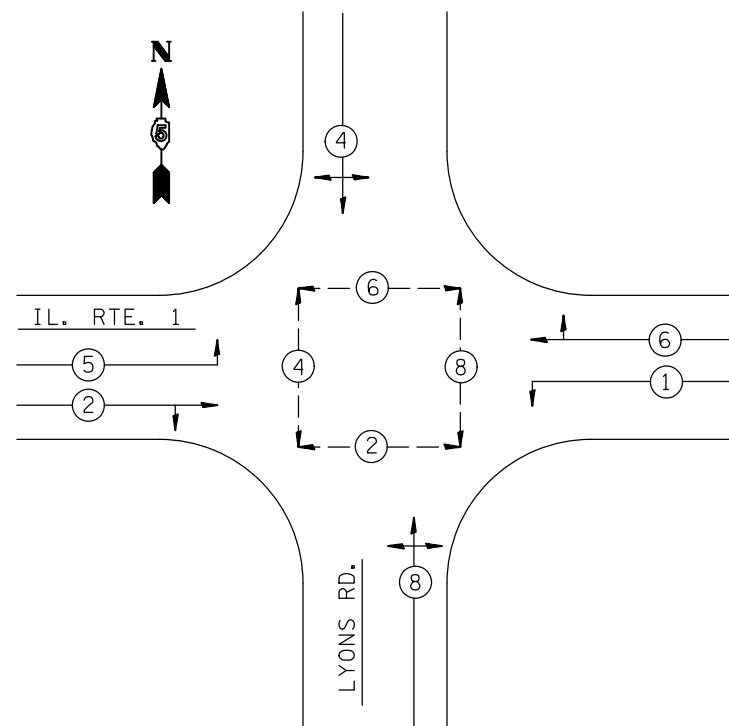

BILL OF MATERIALS

IL. Rte. 1 & Lyons Rd.

ITEM	UNIT	QUANTITY
SERVICE INSTALLATION, TYPE A	EACH	1
UNDERGROUND CONDUIT, PVC, 1" DIA.	FOOT	186
UNDERGROUND CONDUIT, PVC, 1 1/2" DIA.	FOOT	489
UNDERGROUND CONDUIT, PVC, 2" DIA.	FOOT	482
UNDERGROUND CONDUIT, PVC, 2 1/2" DIA.	FOOT	125
UNDERGROUND CONDUIT, PVC, 3" DIA.	FOOT	199
UNDERGROUND CONDUIT, PVC, 4" DIA.	FOOT	155
HANDHOLE	EACH	12
DOUBLE HANDHOLE	EACH	1
ELECTRIC CABLE IN CONDUIT, 600V (XLP-TYPE USE) 1/C NO. 10	FOOT	1339
LUMINAIRE, LED, ROADWAY, OUTPUT DESIGNATION H	EACH	4
FULL-ACTUATED CONTROLLER AND TYPE IV CABINET	EACH	1
UNINTERRUPTABLE POWER SUPPLY, STANDARD	EACH	1
ELECTRIC CABLE IN CONDUIT, TRACER, NO. 12 1C	FOOT	1383
ELECTRIC CABLE IN CONDUIT, SIGNAL NO. 14 2C	FOOT	416
ELECTRIC CABLE IN CONDUIT, SIGNAL NO. 14 3C	FOOT	486
ELECTRIC CABLE IN CONDUIT, SIGNAL NO. 14 5C	FOOT	2243
ELECTRIC CABLE IN CONDUIT, SIGNAL NO. 14 7C	FOOT	1550
ELECTRIC CABLE IN CONDUIT, LEAD-IN, NO. 18 3 PAIR	FOOT	2879
ELECTRIC CABLE IN CONDUIT, SERVICE, NO. 6 2 C	FOOT	36
ELECTRIC CABLE IN CONDUIT, EQUIPMENT GROUNDING CONDUCTOR, NO. 6 1C	FOOT	884
TRAFFIC SIGNAL POST, ALUMINUM 10 FT.	EACH	3
TRAFFIC SIGNAL POST, ALUMINUM 12 FT.	EACH	1
TRAFFIC SIGNAL POST, ALUMINUM 14 FT.	EACH	3
PEDESTRIAN PUSH-BUTTON POST, GALVANIZED STEEL, TYPE II	EACH	2
STEEL COMBINATION MAST ARM ASSEMBLY AND POLE 22 FT.	EACH	2
STEEL COMBINATION MAST ARM ASSEMBLY AND POLE 42 FT.	EACH	1
STEEL COMBINATION MAST ARM ASSEMBLY AND POLE 46 FT.	EACH	1
CONCRETE FOUNDATION, TYPE A	FOOT	21.7
CONCRETE FOUNDATION, TYPE C	FOOT	3.5
CONCRETE FOUNDATION, TYPE E 30-INCH DIAMETER	FOOT	20
CONCRETE FOUNDATION, TYPE E 36-INCH DIAMETER	FOOT	26
SIGNAL HEAD, POLYCARBONATE, LED, 1-FACE, 3-SECTION, BRACKET MOUNTED	EACH	2
SIGNAL HEAD, POLYCARBONATE, LED, 1-FACE, 3-SECTION, MAST ARM MOUNTED	EACH	8
SIGNAL HEAD, POLYCARBONATE, LED, 1-FACE, 4-SECTION, MAST ARM MOUNTED	EACH	2
SIGNAL HEAD, POLYCARBONATE, LED, 2-FACE, 1-3 SECTION, 1-4 SECTION, BRACKET MOUNTED	EACH	2
PEDESTRIAN SIGNAL HEAD, POLYCARBONATE, LED, 1-FACE, BRACKET MOUNTED WITH COUNT DOWN TIMER	EACH	8
TRAFFIC SIGNAL BACKPLATE, RETROREFLECTIVE	EACH	10
INDUCTIVE LOOP DETECTOR	EACH	10
DETECTOR LOOP, TYPE I	FOOT	1224
PEDESTRIAN PUSH-BUTTON	EACH	8
REMOVE EXISTING TRAFFIC SIGNAL EQUIPMENT	EACH	1
REMOVE EXISTING HANDHOLE	EACH	11
REMOVE EXISTING CONCRETE FOUNDATION	EACH	13
ETHERNET SWITCH	EACH	1
WOOD POLE, 35 FT, CLASS 4	EACH	1

MODEL: s:\MODEL\MHFS
FILE: mhfs: p:\pub\mcom\maha\at\links\pwr\WIDOT\Documents\DOT_Offices\Drawings\Projects\0570E07\0570E07-sh-5\Signal_Lyons_Road.dgn

USER NAME = biggsrd	DESIGNED -	REVISED -
	DRAWN -	REVISED -
PLOT SCALE = 30.0000 ' / in.	CHECKED -	REVISED -
PLOT DATE = 12/11/2019	DATE -	REVISED -

STATE OF ILLINOIS
DEPARTMENT OF TRANSPORTATION

U.S. 150 & Lyons Rd.
Detector Loop Data - Phase Designation Diagram - Bill of Materials

SCALE: NA SHEET 1 OF 1 SHEETS STA. TO STA.

F.A.P. RTE.	SECTION	COUNTY	TOTAL SHEETS	SHEET NO.
332	(47)TS	VERMILION	17	11
			CONTRACT NO. 70E07	
		ILLINOIS	FED. AID PROJECT	

81400100 HANDHOLE
 STA. 2905+37.3; 38.9' RT. 1 EACH
 STA. 2906+81.8; 40.8' RT. 1 EACH
 STA. 2907+89.7; 62.0' LT. 1 EACH
 STA. 2908+02.8; 43.1' RT. 1 EACH
 STA. 2908+06.4; 88.7' LT. 1 EACH
 STA. 2908+82.0; 78.0' LT. 1 EACH
 STA. 2909+29.1; 85.3' RT. 1 EACH
 STA. 2909+30.6; 50.0' LT. 1 EACH
 STA. 2909+57.8; 56.5' RT. 1 EACH
 STA. 2909+82.2; 43.2' LT. 1 EACH
 STA. 2910+81.2; 42.4' LT. 1 EACH
 STA. 2912+13.9; 42.3' LT. 1 EACH

TOTAL = 12 EACH

87502640 TRAFFIC SIGNAL POST GS 10 FT

Sta. 2908+45.4; 58.5' RT. 1 EACH
 Sta. 2908+92.0; 59.0' RT. 1 EACH
 Sta. 2909+50.8; 59.2' LT. 1 EACH

TOTAL = 3 EACH

87502660 TRAFFIC SIGNAL POST GS 12 FT

Sta. 2909+35.1; 71.4' RT. 1 EACH

87502680 TRAFFIC SIGNAL POST GS 14 FT

Sta. 2908+12.0; 43.5' RT. 1 EACH
 Sta. 2908+05.6; 73.9' LT. 1 EACH
 Sta. 2909+26.7; 43.2' LT. 1 EACH

TOTAL = 3 EACH

87800100 CONCRETE FOUNDATION, TYPE A

Sta. 2908+05.6; 73.9' LT. 3.1 FEET
 Sta. 2908+12.0; 43.5' RT. 3.1 FEET
 Sta. 2908+45.4; 58.5' RT. 3.1 FEET
 Sta. 2908+92.0; 59.0' LT. 3.1 FEET
 Sta. 2909+26.7; 43.2' LT. 3.1 FEET
 Sta. 2909+35.1; 71.4' RT. 3.1 FEET
 Sta. 2909+50.8; 59.2' RT. 3.1 FEET

TOTAL = 21.7 FEET

SCHEDULES

LYONS RD.

87800400 CONCRETE FDN TY E 30 IN

Sta. 2908+68.3; 89.2' RT. 10 FEET
 Sta. 2908+73.1; 89.8' LT. 10 FEET

TOTAL = 20 FEET

87800415 CONCRETE FDN TY E 36 IN

Sta. 2907+68.4; 47.4' LT. 13 FEET
 Sta. 2909+87.4; 44.8' RT. 13 FEET

TOTAL = 26 FEET

89502385 REMOVE EXIST CONCRETE FDN

Sta. 2907+73.9; 45.3' Lt. 1 EACH
 Sta. 2907+98.6; 64.2' Lt. 1 EACH
 Sta. 2908+04.5; 71.9' Lt. 1 EACH
 Sta. 2908+06.5; 43.2' Rt. 1 EACH
 Sta. 2908+40.6; 56.4' Rt. 1 EACH
 Sta. 2908+49.7; 73.9' Rt. 1 EACH
 Sta. 2908+66.1; 83.5' Rt. 1 EACH
 Sta. 2909+37.1; 69.1' Rt. 1 EACH
 Sta. 2909+48.5; 61.4' Rt. 1 EACH
 Sta. 2909+82.1; 44.6' Rt. 1 EACH
 Sta. 2908+76.0; 85.5' Lt. 1 EACH
 Sta. 2908+93.8; 57.6' Lt. 1 EACH
 Sta. 2909+24.3; 42.9' Lt. 1 EACH

TOTAL = 13 EACH

87601200 PED P-B POST, GS, T2

Sta. 2907+99.0; 63.2' Lt. 1 EACH
 Sta. 2908+03.1; 68.2' Lt. 1 EACH

TOTAL = 2 EACH

89502380 REMOVE EXISTING HANDHOLE

Sta. 2906+59.6; 40.0' Rt. 1 EACH
 Sta. 2907+91.6; 40.3; Rt. 1 EACH
 Sta. 2908+53.7; 73.8' Rt. 1 EACH
 Sta. 2907+94.6; 61.3' Lt. 1 EACH
 Sta. 2908+05.3; 84.0' Lt. 1 EACH
 Sta. 2909+30.1; 77.0' Rt. 1 EACH
 Sta. 2909+51.0; 64.1' Rt. 1 EACH
 Sta. 2908+75.5; 72.5' Lt. 1 EACH
 Sta. 2909+19.0; 43.1' Lt. 1 EACH
 Sta. 2909+75.5; 42.2' Lt. 1 EACH
 Sta. 2910+91.2; 40.1' Lt. 1 EACH

TOTAL = 11 EACH

81400100 HANDHOLE

1 EACH
 Sta. 2943+11.7; 41.1' RT. 1 EACH
 Sta. 2945+37.2; 39.5' RT. 1 EACH
 Sta. 2947+04.3; 38.2' RT. 1 EACH
 Sta. 2947+57.5; 72.0' LT. 1 EACH
 Sta. 2947+95.6; 53.8' RT. 1 EACH
 Sta. 2948+80.8; 45.2' LT. 1 EACH
 Sta. 2950+37.6; 41.1' LT. 1 EACH
 Sta. 2952+19.5; 41.3' LT. 1 EACH

TOTAL = 8 EACH

87502660 TRAFFIC SIGNAL POST A 12 FT

Sta. 2947+91.9; 58.1' Rt. 1 EACH

87502700 TRAFFIC SIGNAL POST A 16 FT

Sta. 2947+22.9; 48.8' Rt. 1 EACH
 Sta. 2948+58.7; 52.0' Lt. 1 EACH

TOTAL = 2 EACH

87800100 CONCRETE FOUNDATION, TYPE A

Sta. 2947+91.9; 58.1' Rt. 3.1 FEET
 Sta. 2947+22.9; 48.8' Rt. 3.1 FEET
 Sta. 2948+58.7; 52.0' Lt. 3.1 FEET

TOTAL = 9.3 FEET

HEGELER LANE

87800400 CONCRETE FDN TY E 30 IN

Sta. 2947+57.2; 78.4' Lt. 10 FEET

87800415 CONCRETE FDN TY E 36 IN

Sta. 2947+05.5; 43.6' Rt. 15 FEET
 Sta. 2948+05.3; 53.1 Rt. 15 FEET
 Sta. 2947+16.1; 54.5' Lt. 15 FEET

TOTAL = 45 FEET

89502385 REMOVE EXIST CONCRETE FDN

Sta. 2947+06.6; 41.2' Rt. 1 EACH
 Sta. 2947+14.1; 47.1' Rt. 1 EACH
 Sta. 2947+27.3; 49.6' Rt. 1 EACH
 Sta. 2947+20.8; 54.1' Lt. 1 EACH
 Sta. 2947+41.9; 60.8' Lt. 1 EACH
 Sta. 2947+51.1; 72.5' Lt. 1 EACH
 Sta. 2948+00.2; 52.6' Rt. 1 EACH
 Sta. 2948+69.3; 57.4' Lt. 1 EACH
 Sta. 2948+76.5; 45.3' Lt. 1 EACH

TOTAL = 9 EACH

87601200 PED P-B POST, GS, T2

Sta. 2947+22.5; 52.5' Lt. 1 EACH
 Sta. 2947+97.9; 52.5' Rt. 1 EACH

TOTAL = 2 EACH

89502380 REMOVE EXISTING HANDHOLE

Sta. 2947+13.0; 42.3' Rt. 1 EACH
 Sta. 2947+45.4; 66.9' Lt. 1 EACH
 Sta. 2947+95.6; 57.5' Rt. 1 EACH
 Sta. 2948+69.2; 53.6' Lt. 1 EACH

TOTAL = 4 EACH

MODEL: I:\MODEL\MHFE
 FILE: Mhfe.dwg
 PLOT DATE: 12/12/2019
 PROJECT: I:\Projects\0570E07\CADDData\Design\0570E07.dwg
 USER: biggsrd
 DATE: 12/12/2019

USER NAME = biggsrd	DESIGNED -	REVISED -
DRAWN -	DRAWN -	REVISED -
PLOT SCALE = 30.0000 ' / in.	CHECKED -	REVISED -
PLOT DATE = 12/12/2019	DATE -	REVISED -

STATE OF ILLINOIS
 DEPARTMENT OF TRANSPORTATION

SCALE: NA SHEET 1 OF 1 SHEETS STA. TO STA.

SCHEDULES

F.A.P. RTE.	SECTION	COUNTY	TOTAL SHEETS	SHEET NO.
332	(47)TS	VERMILION	17	12
CONTRACT NO. 70E07				
ILLINOIS FED. AID PROJECT				

TRAFFIC SIGNAL INSTALLATION
 F.A.P. 332 (U.S. 150/IL. Rte. 1/Georgetown Rd.)

&
 Hegeler Lane / Spelter Avenue

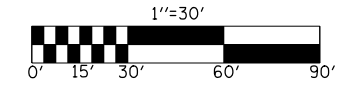

SIGNAL LAYOUT

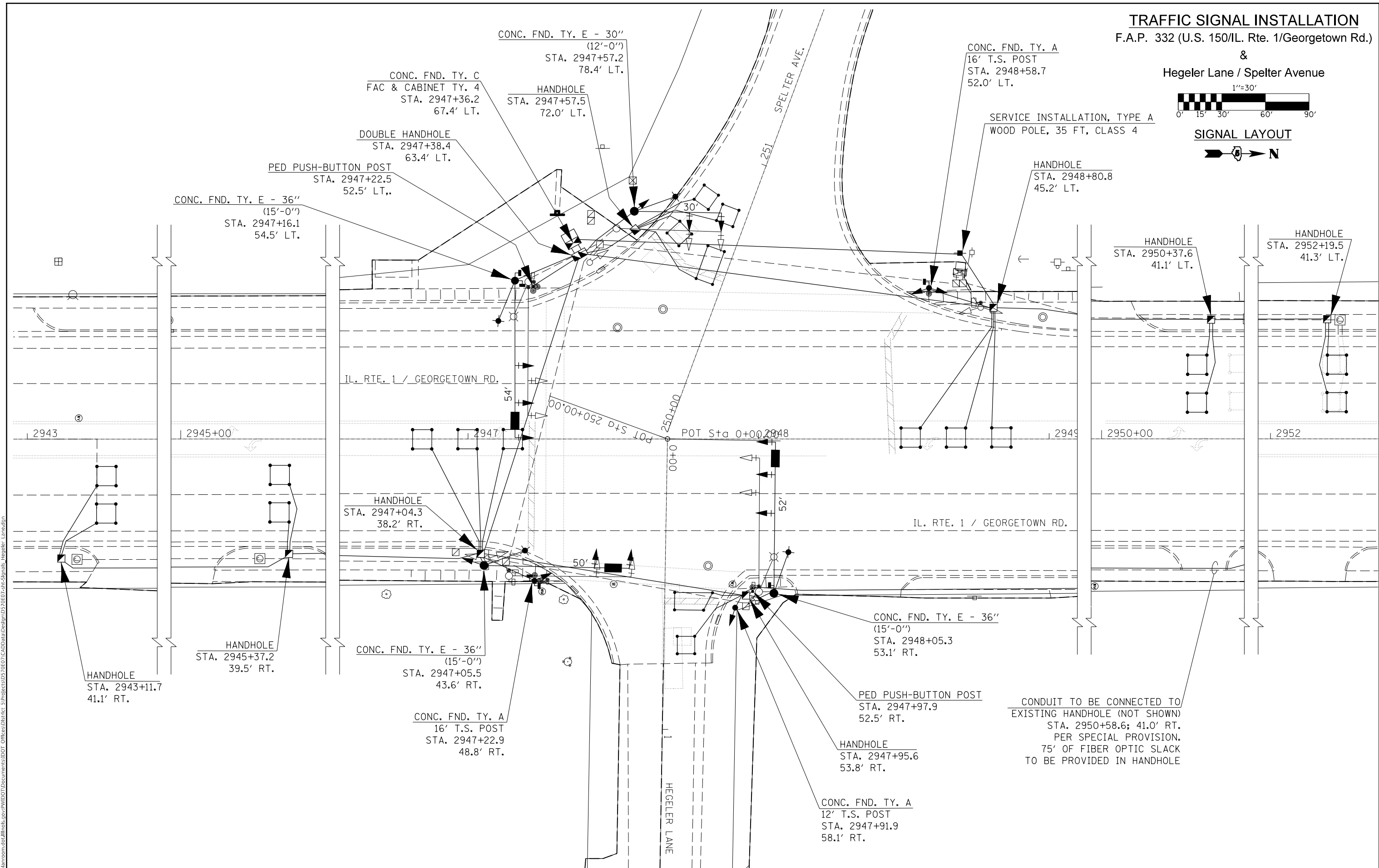

MODEL: \\MODEL\NAME
 FILE: \\NAME: \\path\to\file.dwg
 PROJECT: \\PROJECT\NAME
 OFFICE: \\OFFICE\NAME
 DATE: 12/11/2019

USER NAME = biggsrd	DESIGNED - _____	REVISED - _____
DRAWN - _____	REVISIONS - _____	REVISIONS - _____
PLOT SCALE = 30.0000' / in.	CHECKED - _____	REVISIONS - _____
PLOT DATE = 12/11/2019	DATE - _____	REVISIONS - _____

STATE OF ILLINOIS
DEPARTMENT OF TRANSPORTATION

U.S. 150 & Hegeler Lane
Traffic Signal Layout

SCALE: 1" = 30' SHEET 1 OF 1 SHEETS STA. 2943+00 TO STA. 2952+37

F.A.P. RTE. 332	SECTION (47)TS	COUNTY VERMILION	TOTAL SHEETS 17	SHEET NO. 13
CONTRACT NO. 70E07				
ILLINOIS FED. AID PROJECT				

TRAFFIC SIGNAL INSTALLATION
 F.A.P. 332 (U.S. 150/IL. Rte. 1/Georgetown Rd.)
 &
 Hegeler Lane / Spelter Avenue

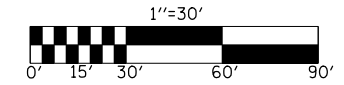

CONDUIT LAYOUT

- 1@17' - 1" PVC
- 1@14' - 1" PVC
- 1@12' - 1" PVC
- 1@6' - 1" PVC

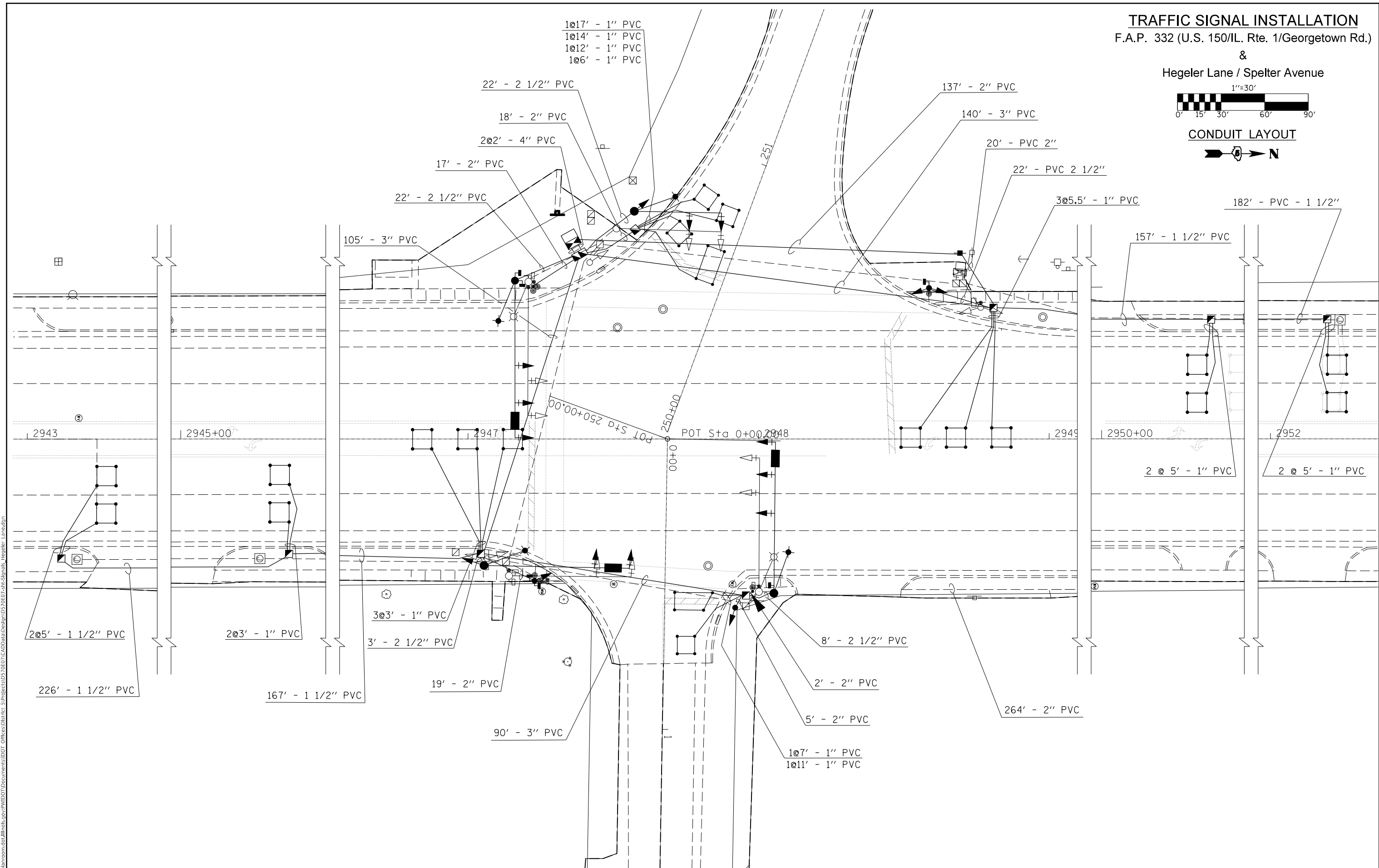

MODEL: \\MODEL\NAME
 FILE: \\NAME: \\pub\hmm\com\ma\data\illinois.gov\RWIDOT\Documents\DOT_Offices\Director_S\Projects\0570E07\CADD\Drawings\0570E07-sh-Traffic_Signals_Hegeler_Lane.dgn

USER NAME = biggsrd	DESIGNED - _____	REVISED - _____
DRAWN - _____	REVISED - _____	
PLOT SCALE = 30.0000 ' / in.	CHECKED - _____	REVISED - _____
PLOT DATE = 12/12/2019	DATE - _____	REVISED - _____

STATE OF ILLINOIS
DEPARTMENT OF TRANSPORTATION

U.S. 150 & Hegeler Lane
Traffic Signal Conduit Layout

SCALE: 1" = 30' SHEET 1 OF 1 SHEETS STA. _____ TO STA. _____

F.A.P. RTE.	SECTION	COUNTY	TOTAL SHEETS	SHEET NO.
332	(47)TS	VERMILION	17	14
CONTRACT NO. 70E07				
ILLINOIS FED. AID PROJECT				

MODEL: \\MODEL\MHFE
 FILE: \\MAILS: public\mcom\mdata\illinois\gov\PI\DOT\Documents\IBDOT_Offices\Ibldtct_5\Projects\0570E07\CaddData\Design\0570E07-sh-Signals_Hegeler_Lane.dgn

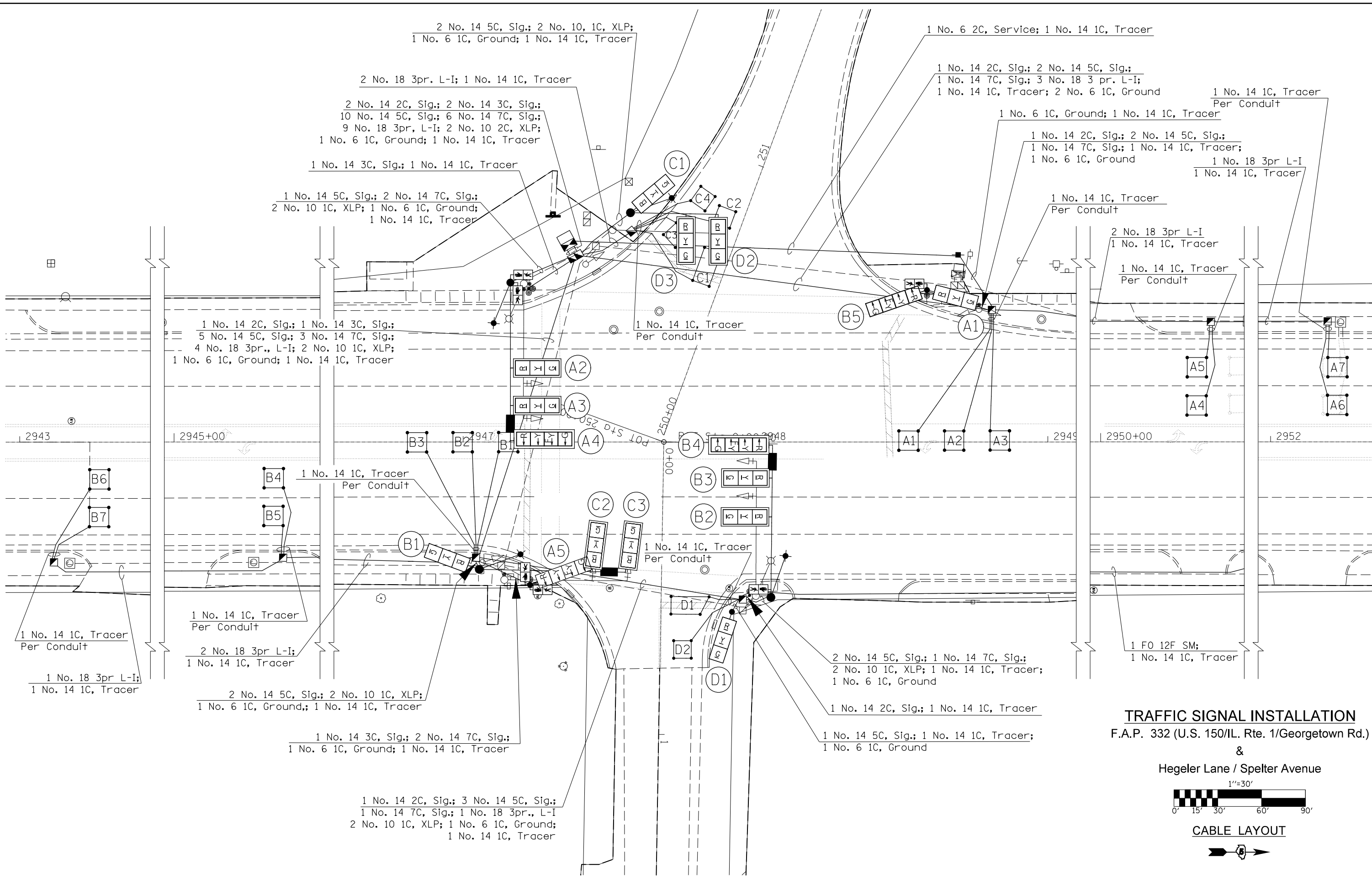

TRAFFIC SIGNAL INSTALLATION
 F.A.P. 332 (U.S. 150/IL. Rte. 1/Georgetown Rd.)
 &
 Hegeler Lane / Spelter Avenue

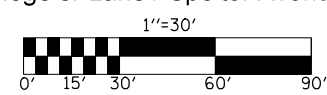

CABLE LAYOUT



USER NAME = biggsrd	DESIGNED - _____	REVISED - _____
	DRAWN - _____	REVISED - _____
PLOT SCALE = 30.0000' / in.	CHECKED - _____	REVISED - _____
PLOT DATE = 12/11/2019	DATE - _____	REVISED - _____

STATE OF ILLINOIS
DEPARTMENT OF TRANSPORTATION

U.S. 150 & Hegeler Lane
Traffic Signal Cable Layout

SCALE: 1" = 30' SHEET 1 OF 1 SHEETS STA. 2943+00 TO STA. 2952+37

F.A.P. RTE. 332	SECTION (47)TS	COUNTY VERMILION	TOTAL SHEETS 17	SHEET NO. 15
ILLINOIS FED. AID PROJECT			CONTRACT NO. 70E07	

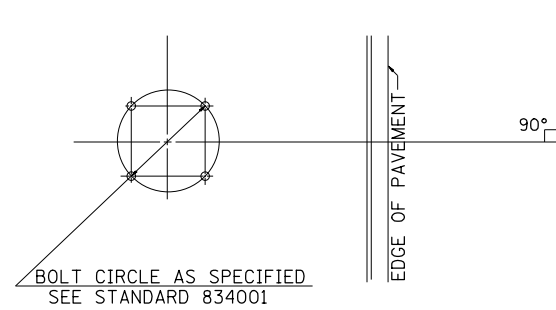

BOLT CIRCLE AS SPECIFIED
SEE STANDARD 834001

DETAIL OF MAST ARM FOUNDATION

BOLT PATTERN

PEDESTRIAN PUSH-BUTTON SIGNS

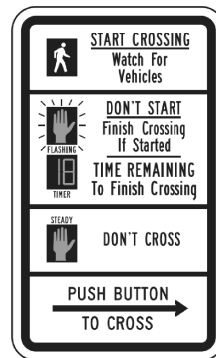

R10-3e

PEDESTRIAN PUSH-BUTTON SIGNS SHALL BE MOUNTED ABOVE THE PEDESTRIAN PUSH BUTTONS. THE SIGNS SHALL BE BOLTED TO THE POSTS.

TRAFFIC SIGNAL GENERAL NOTES

- 1 THE ACTUAL LOCATION OF ALL SIGNAL FOUNDATIONS, HANDHOLES, AND TRAFFIC CONTROLLER WILL BE DETERMINED IN THE FIELD BY THE ENGINEER.
- 2 THE FINAL LOCATIONS OF ALL TRAFFIC CONTROL ITEMS SHALL BE VERIFIED BY THE ENGINEER IN THE FIELD.
- 3 POST MOUNTED SIGNALS SHALL BE INSTALLED SO THAT NO PART OF THE SIGNAL HEAD IS WITHIN 2 FT. OF THE FACE OF CURB.
- 4 ALL MAST ARM POLES SHALL BE A MINIMUM OF 6 FT. FROM THE CENTER OF THE POLE TO THE FACE OF CURB (ON THE MAST ARM SIDE) OR AS SHOWN ON THE PLANS.
- 5 COMBINATION MAST ARM ASSEMBLIES SHALL BE FURNISHED WITH 15' LUMINAIRE TRUSS ARMS WITH A MOUNTED LUMINAIRE HEIGHT OF 40 FT.
- 6 ALL TRAFFIC SIGNAL MAST ARMS MUST BE DESIGNED FOR THE LOADINGS SHOWN ON THE HIGHWAY STANDARDS OR THESE SIGNAL PLANS, WHICHEVER IS GREATER.
- 7 SIGNAL FACES FOR THE NORTH APPROACH ARE NOTED AS "A","B" FOR THE SOUTH APPROACH,"C" FOR THE WEST APPROACH, AND "D" FOR THE EAST APPROACH.
- 8 ALIGN ADJACENT RED INDICATIONS TO SAME HEIGHT ABOVE PAVEMENT.
- 9 THE BASE FOR A TRAFFIC SIGNAL POST SHALL BE SITUATED SUCH THAT THE HANDHOLE IS LOCATED ON A SIDE AWAY FROM A TRAVELED LANE.
- 10 PEDESTRIAN PUSHBUTTON SIGNAL SIGNS SHALL BE MOUNTED ABOVE THE APPROPRIATE PEDESTRIAN PUSHBUTTON.
- 11 ITEMS REMOVED WILL BECOME THE PROPERTY OF THE CONTRACTOR UNLESS OTHERWISE NOTED IN THE CONTRACT.
- 12 THE CONTRACTOR SHALL BE RESPONSIBLE FOR OBTAINING ELECTRICAL SERVICE FOR THE TRAFFIC SIGNALS. THE CONTRACTOR SHALL CONTACT THE UTILITY COMPANY PRIOR TO COMMENCEMENT OF WORK TO OBTAIN UTILITY COMPANY REQUIREMENTS FOR THE SERVICE INSTALLATIONS.
- 13 THE ANTI-BACKUP FEATURE SHALL BE HARDWIRED ON THE BACKPANEL OF THE CONTROLLER CABINET.
- 14 TIMINGS SHOWN ARE FOR INITIAL OPERATION AND MAY BE ADJUSTED TO REFLECT SITE CONDITIONS PER APPROVAL OF THE TRAFFIC OPERATIONS ENGINEER.
- 15 THE CONTRACTOR SHALL SUPPLY AND MOUNT SIGNS BY THE MASTARM MOUNTED FYA SIGNAL HEADS STATING "LEFT TURN YIELD ON FLASHING YELLOW ARROW" (R10-1109 AS SHOWN IN THE ILLINOIS STANDARD HIGHWAY SIGNS BOOK - JULY 1, 2014)

MAST ARM DAMPENING DEVICE MOUNTING DETAIL

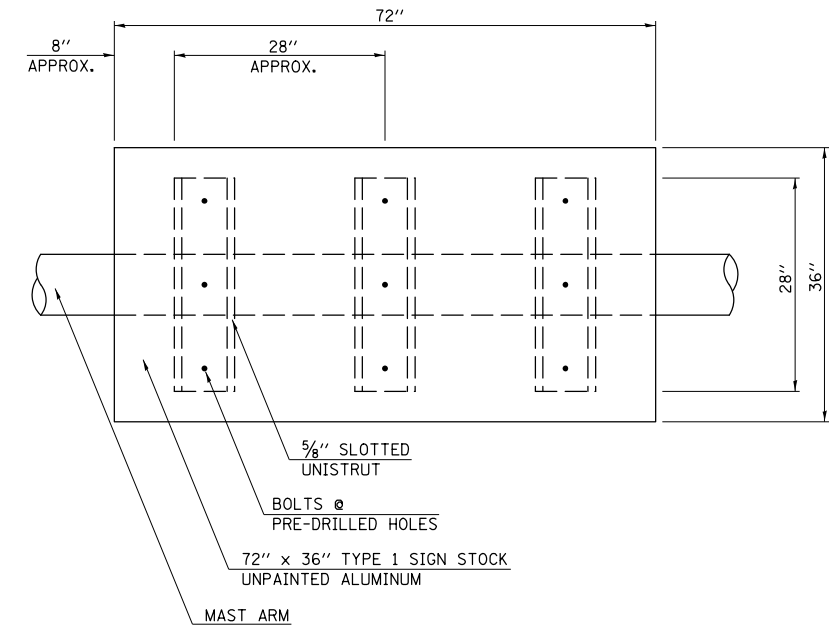

PLAN VIEW

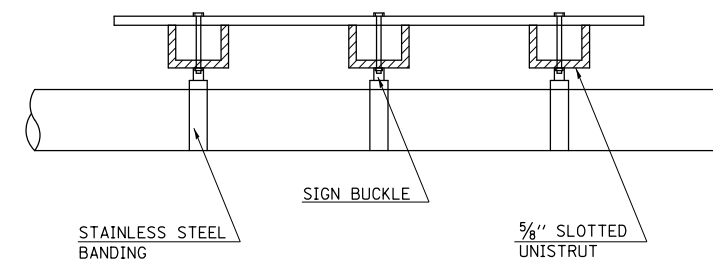

ELEVATION

NOTE: PAINT ENDS OF UNISTRUT WITH SPRAY ON GALVANIZED PAINT

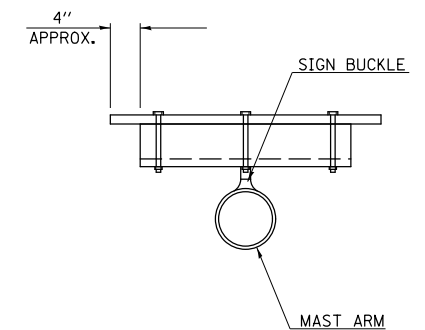

CROSS SECTION

MODEL: I:\MODEL\NAMES FILE NAME: P:\pub\hmm\goma\data\illinois\pwr\DOT\Documents\DOT_Offices\Illinois\DOT\Projects\0570E07\CADD\data\Design\0570E07-sh-5\Signals_Layouts.dgn

USER NAME = biggsrd	DESIGNED - _____	REVISED - _____
DRAWN - _____	REVISIONS - _____	REVISIONS - _____
PLOT SCALE = 30.0000 ' / in.	CHECKED - _____	REVISIONS - _____
PLOT DATE = 12/11/2019	DATE - _____	REVISIONS - _____

**STATE OF ILLINOIS
DEPARTMENT OF TRANSPORTATION**

**DETAILS -
TRAFFIC SIGNAL GENERAL NOTES**

SCALE: NA SHEET 1 OF 1 SHEETS STA. _____ TO STA. _____

F.A.P. RTE.	SECTION	COUNTY	TOTAL SHEETS	SHEET NO.
332	(47)TS	VERMILION	17	17
CONTRACT NO. 70E07				
ILLINOIS FED. AID PROJECT				