

UNIT DUCT 3-1/2" No. 2, 1-1/2" No. 4 GROUND
600V (EPR-TYPE RHW), 1/2" DIA.
SCHEDULE 40 POLYETHENE (TYPICAL).

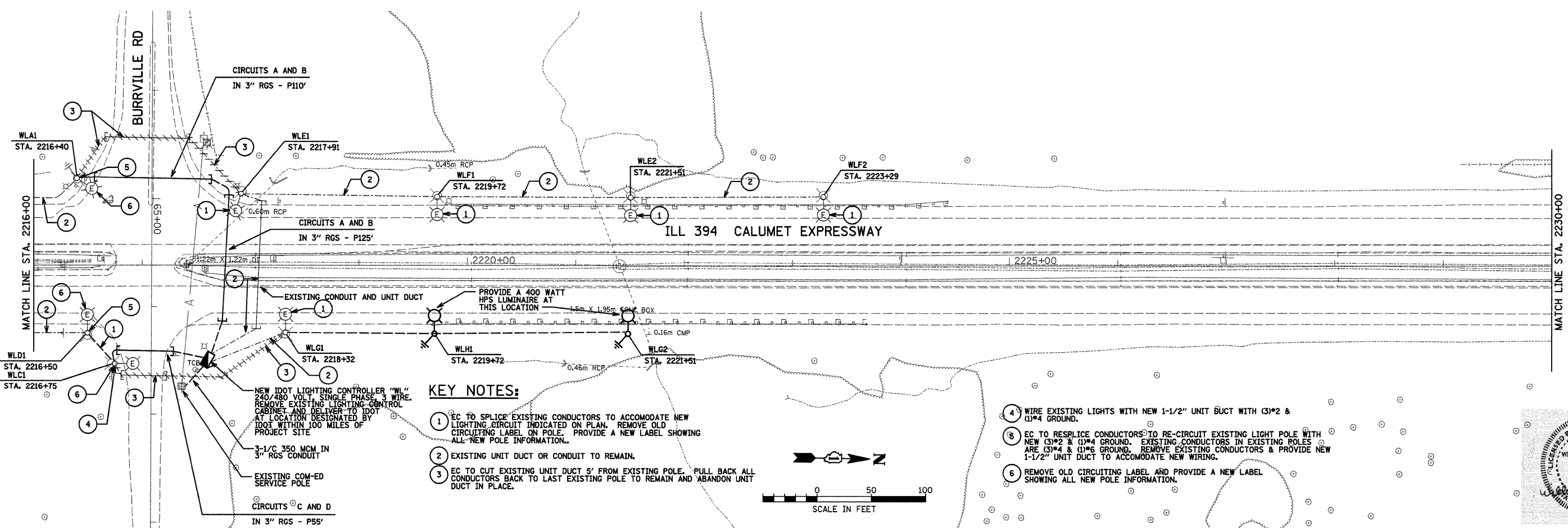

- KEY NOTES:**
- EC TO SPLICE EXISTING CONDUCTORS TO ACCOMMODATE NEW LIGHTING CIRCUIT INDICATED ON PLAN. REMOVE OLD CIRCUITING LABEL ON POLE. PROVIDE A NEW LABEL SHOWING ALL NEW POLE INFORMATION.
 - EXISTING UNIT DUCT OR CONDUIT TO REMAIN.
 - EC TO CUT EXISTING UNIT DUCT 5' FROM EXISTING POLE. PULL BACK ALL CONDUCTORS BACK TO LAST EXISTING POLE TO REMAIN AND ABANDON UNIT DUCT IN PLACE.
 - WIRE EXISTING LIGHTS WITH NEW 1-1/2" UNIT DUCT WITH (3)*2 & (1)*4 GROUND.
 - EC TO RESPLICE CONDUCTORS TO RE-CIRCUIT EXISTING LIGHT POLE WITH NEW (3)*2 & (1)*4 GROUND. EXISTING CONDUCTORS IN EXISTING POLES ARE (3)*4 & (1)*6 GROUND. REMOVE EXISTING CONDUCTORS & PROVIDE NEW 1-1/2" UNIT DUCT TO ACCOMMODATE NEW WIRING.
 - REMOVE OLD CIRCUITING LABEL AND PROVIDE A NEW LABEL SHOWING ALL NEW POLE INFORMATION.

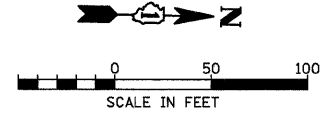
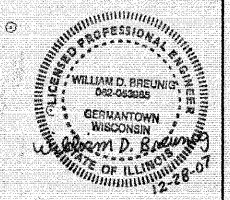
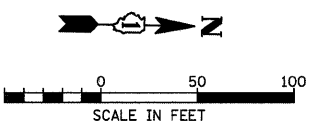

L:\Jobs\2006\20063028-39\CAD\Electrical\dgn\00\E19.dwg
12/28/2007 10:45:38 AM



USER NAME = #USER#	DESIGNED - BDB/CMP	REVISED -
PLOT SCALE = #SCALE#	DRAWN - JCC	REVISED -
PLOT DATE = 12/28/2007	CHECKED - BDB	REVISED -
	DATE - 12-31-07	REVISED -

**STATE OF ILLINOIS
DEPARTMENT OF TRANSPORTATION**

**ILL 394 SAFETY IMPROVEMENTS - GOODNOW ROAD TO BURRVILLE ROAD
LIGHTING PLAN**

SCALE: 1" = 50' SHEET NO. 10 OF 22 SHEETS STA. 2202+00 TO STA. 2230+00

F.A.P. RTE. 332	SECTION 2007-044 I	COUNTY WILL & COOK	TOTAL SHEETS 53	SHEET NO. 40	E10
FED. ROAD DIST. NO. ILLINOIS FED. AID PROJECT		CONTRACT NO. 60D34			