

F.A.P. RTE. 305	SECTION 2007-047 I	COUNTY MCHENRY	TOTAL SHEETS 20	SHEET NO. 1
FED. ROAD DIST. NO. 1		ILLINOIS	CONTRACT NO. 60D37	

STATE OF ILLINOIS  
DEPARTMENT OF TRANSPORTATION  
DIVISION OF HIGHWAYS

# PROPOSED HIGHWAY PLANS

F.A.P. ROUTE 305: US 14  
IL 23 TO WEST OF IL 120  
SECTION: 2007-047 I

SHOULDER WIDENING AND RUMBLE STRIP INSTALLATION

PROJECT: *ACHSIP-0305(040)*

MCHENRY COUNTY

C-91-009-08

FOR INDEX OF SHEETS, SEE SHEET NO. 2

PROJECT LOCATED IN UNINCORPORATED,  
MCHENRY COUNTY.

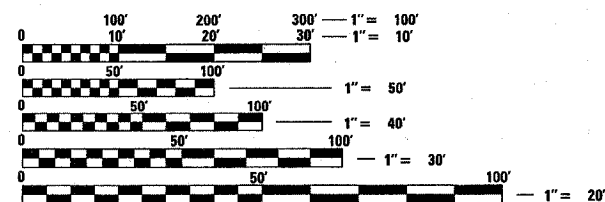
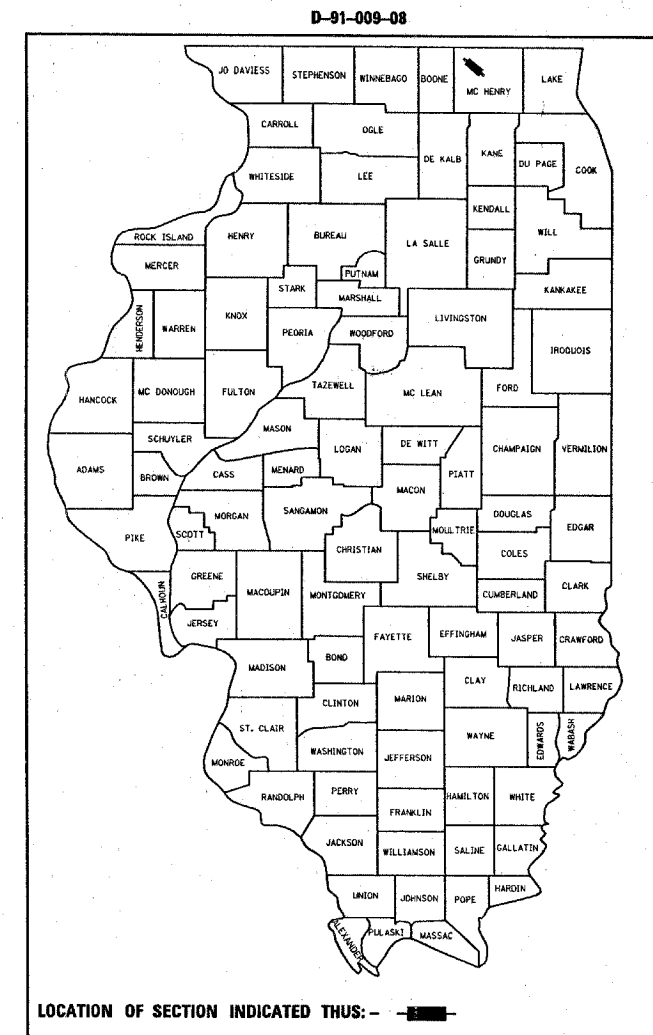

FULL SIZE PLANS HAVE BEEN PREPARED USING STANDARD ENGINEERING SCALES. REDUCED SIZED PLANS WILL NOT CONFORM TO STANDARD SCALES. IN MAKING MEASUREMENTS ON REDUCED PLANS, THE ABOVE SCALES MAY BE USED.

J.U.L.I.E.  
JOINT UTILITY LOCATION INFORMATION FOR EXCAVATION  
1-800-892-0123  
OR 811

PROJECT ENGINEER: J. CHANG (847) 705-4432  
PROJECT MANAGER: KEN ENG

CONTRACT NO. 60D37

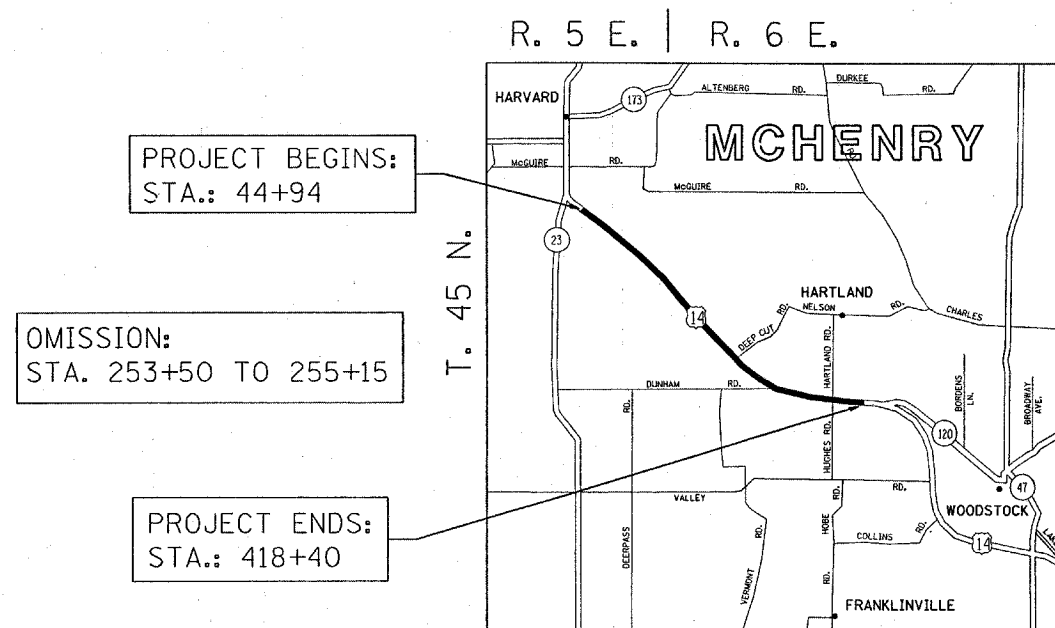

PROJECT BEGINS:  
STA.: 44+94

OMISSION:  
STA. 253+50 TO 255+15

PROJECT ENDS:  
STA.: 418+40

DUNHAM AND HARTLAND TOWNSHIP

GROSS LENGTH OF PROJECT = 37,346 FEET (7.07 MILES)  
NET LENGTH OF PROJECT = 37,181 FEET (7.04 MILES)

TRAFFIC DATA:

SPEED LIMIT = 55 MPH

2005 ADT = 9,300

STATE OF ILLINOIS  
DEPARTMENT OF TRANSPORTATION  
DIVISION OF HIGHWAYS

SUBMITTED *Dec. 20* 20 *07*

*Diane O'Keefe*  
DEPUTY DIRECTOR OF HIGHWAYS, REGION ENGINEER

*February 1, 20 08*  
*Eric F. Hara*  
INTERIM ENGINEER OF DESIGN AND ENVIRONMENT

*February 1, 20 08*  
*Christina M. Reed*  
DIRECTOR OF HIGHWAYS, CHIEF ENGINEER

PRINTED BY THE AUTHORITY  
OF THE STATE OF ILLINOIS

INDEX OF SHEETS

<u>SHEET NO.</u>	<u>DESCRIPTION</u>
1	TITLE SHEET
2	INDEX OF SHEETS, STATE STANDARDS & GENERAL NOTES.
3	SUMMARY OF QUANTITIES
4	EXISTING AND PROPOSED TYPICAL SECTIONS
5-17	ROADWAY AND PAVEMENT MARKING PLAN
18	TRAFFIC CONTROL AND PROTECTION FOR SIDE ROADS, INTERSECTIONS AND DRIVEWAYS
19	RAISED REFLECTIVE PAVEMENT MARKERS (SNOW PLOW RESISTANT)
20	ARTERIAL ROAD INFORMATION SIGN

GENERAL NOTES

BEFORE STARTING ANY EXCAVATION, THE CONTRACTOR SHALL CALL "JULIE" AT (800) 892-0123 OR 811 FOR FIELD LOCATIONS OF BURIED ELECTRIC, TELEPHONE, AND GAS FACILITIES. (48 HOUR NOTIFICATION REQUIRED).

THE CONTRACTOR SHALL COORDINATE CONSTRUCTION ACTIVITIES WITH UTILITY COMPANIES AND MCHENRY COUNTY.

THE CONTRACTOR WILL NOT BE ABLE TO SET UP A YARD OR FIELD OFFICE ON STATE PROPERTY WITHOUT THE WRITTEN PERMISSION OF THE DEPARTMENT.

THE RESIDENT ENGINEER SHALL CONTACT THE TRAFFIC CONTROL SUPERVISOR AT (847) 705-4470 A MINIMUM OF 72 HOURS PRIOR TO THE INSTALLATION OF ANY TEMPORARY TRAFFIC CONTROL DEVICES.

STATE STANDARDS

<u>STANDARD NO.</u>	<u>DESCRIPTION</u>
000001-05	TYPICAL SYMBOLS, ABBREVIATIONS AND PATTERNS
482001-02	HMA SHOULDER ADJACENT TO FLEXIBLE PAVEMENT
630001-07	STEEL PLATE BEAM GUARDRAIL
630301-04	SHOULDER WIDENING FOR TYPE 1 (SPECIAL) GUARDRAIL TERMINALS
635006-02	REFLECTOR AND TERMINAL MARKER PLACEMENT
642001	SHOULDER RUMBLE STRIPS
701006-02	OFF-RD. OPERATIONS, 2L, 2W, 15' TO PAVEMENT EDGE
701201-02	LANE CLOSURE, 2L, 2W, DAY ONLY
701306-01	LANE CLOSURE, 2L, 2W, SLOW MOVING OPERATIONS, DAY ONLY
701311-02	LANE CLOSURE, 2L, 2W, MOVING OPERATIONS, DAY ONLY
701901	TRAFFIC CONTROL DEVICES

**STATE OF ILLINOIS  
DEPARTMENT OF TRANSPORTATION**

**INDEX OF SHEETS, STATE STANDARDS AND GENERAL NOTES**

F.A.P. RTE.	SECTION	COUNTY	TOTAL SHEETS	SHEET NO.
305	2007-047 I	MCHENRY	20	2
CONTRACT NO.				

FILE NAME =	USER NAME = wjgreendp	DESIGNED -	REVISED -
cr\projects\100908\design_ee.dgn		DRAWN -	REVISED -
	PLOT SCALE = 50.0000 ' / IN.	CHECKED -	REVISED -
	PLOT DATE = 12/21/2007	DATE -	REVISED -

SCALE: SHEET NO. 2 OF 20 SHEETS STA. TO STA.

FED. ROAD DIST. NO. 1 ILLINOIS FED. AID PROJECT

F.A.P. RTE.	SECTION	COUNTY	TOTAL SHEETS	SHEET NO.
305	2007-047 I	MCHENRY	20	3
FED. ROAD DIST. NO. 1		ILLINOIS	HIGHWAY PROJECT	

CONTRACT NO. 60D37

SUMMARY OF QUANTITIES			TOTAL QUANTITIES	CONSTRUCTION TYPE CODE				
CODE NO	ITEM	UNIT		URBAN 90% FED. 10% STATE SFTY-2A				
20200100	EARTH EXCAVATION	CU YD	8500	8500				
31102100	SUB-BASE GRANULAR MATERIAL, TYPE C 4"	SQ YD	25500	25500				
48102100	AGGREGATE WEDGE SHOULDER, TYPE B	TON	955	955				
48203029	HOT-MIX ASPHALT SHOULDERS, 8"	SQ YD	25500	25500				
* 63000000	STEEL PLATE BEAM GUARD RAIL, TYPE A	FOOT	300	300				
* 63100167	TRAFFIC BARRIER TERMINAL TYPE 1, (SPECIAL) TANGENT	EACH	10	10				
63200310	GUARDRAIL REMOVAL	FOOT	800	800				
64200105	SHOULDER RUMBLE STRIP	FOOT	70500	70500				
67000400	ENGINEER'S FIELD OFFICE, TYPE A	CAL MO	3	3				
67100100	MOBILIZATION	L SUM	1	1				
70100450	TRAFFIC CONTROL AND PROTECTION, STANDARD 701201	L SUM	1	1				
70100460	TRAFFIC CONTROL AND PROTECTION, STANDARD 701306	L SUM	1	1				
* 78100100	RAISED REFLECTIVE PAVEMENT MARKER	EACH	910	910				
* 78200420	GUARDRAIL MARKERS, TYPE B	EACH	20	20				
* 78201000	TERMINAL MARKER - DIRECT APPLIED	EACH	10	10				
78300200	RAISED REFLECTIVE PAVEMENT MARKER REMOVAL	EACH	910	910				
X0322256	TEMPORARY INFORMATION SIGNING	SQ FT	52	52				

SUMMARY OF QUANTITIES			TOTAL QUANTITIES	CONSTRUCTION TYPE CODE				
CODE NO	ITEM	UNIT						

\* SPECIALTY ITEMS

REVISIONS	
NAME	DATE

ILLINOIS DEPARTMENT OF TRANSPORTATION  
SUMMARY OF QUANTITIES

PLOT DATE: 12/26/2007

12/26/2007 10:00:00 AM



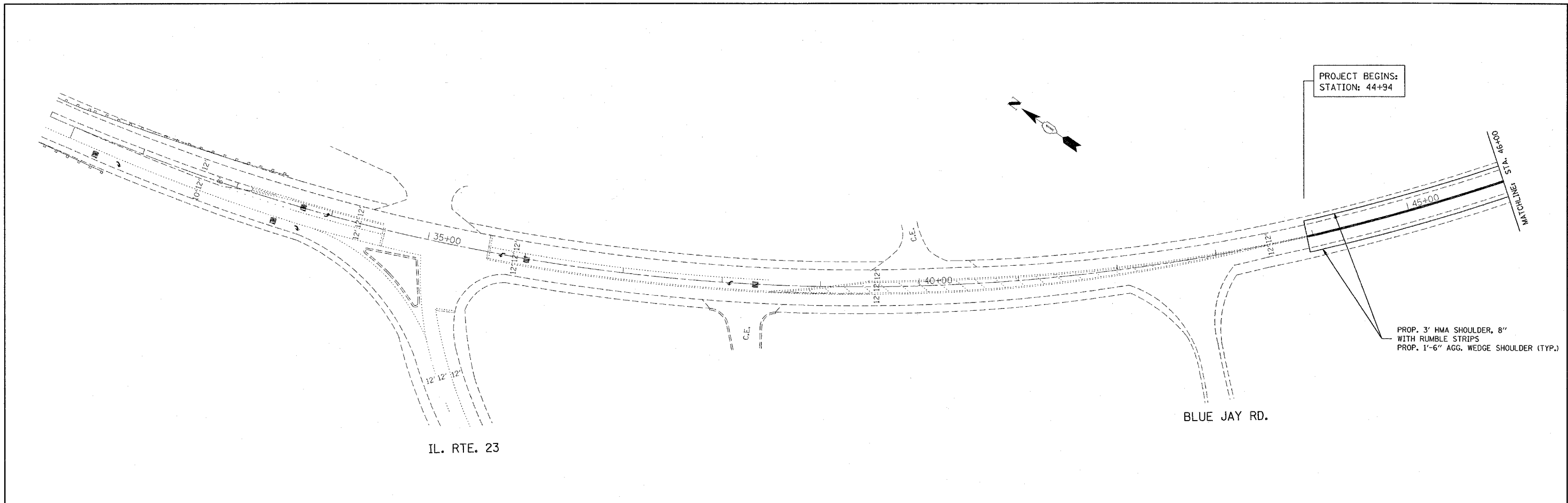

NOTE:  
 ALL EXISTING RAISED REFLECTIVE MARKERS TO BE REMOVED AND REPLACED WITHIN THE PROJECT LIMITS IN ACCORDANCE TO THE DISTRICT DETAIL: TYPICAL APPLICATIONS RAISED REFLECTIVE PAVEMENT MARKERS (SNOW-PLOW RESISTANT)

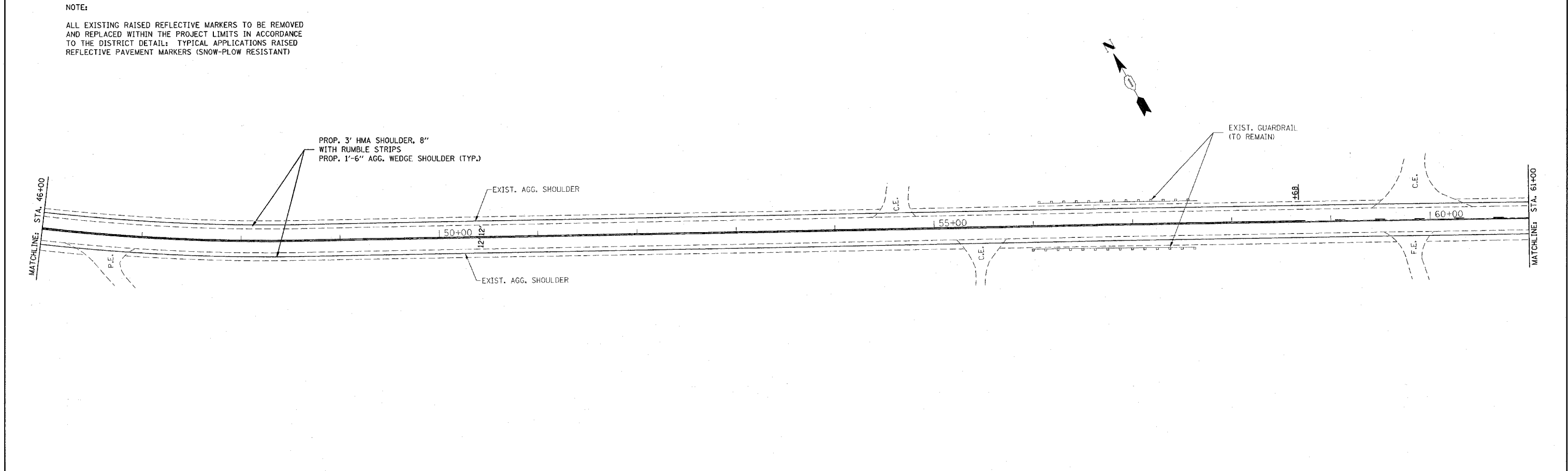

FILE NAME = c:\projects\120908\design.as.dgn	USER NAME = wjgreendp	DESIGNED -	REVISED -	<b>STATE OF ILLINOIS DEPARTMENT OF TRANSPORTATION</b>	<b>ROADWAY AND PAVEMENT MARKING PLAN US 14 (IL 23 TO WEST OF IL 120)</b>			F.A.P. RTE. 305	SECTION 2007-047 I	COUNTY MCHENRY	TOTAL SHEETS 20	SHEET NO. 5
	PLOT SCALE = 50.0000' / IN.	CHECKED -	REVISED -					SCALE: 1"=50'    SHEET NO. 5 OF 20 SHEETS    STA.    TO STA.			CONTRACT NO. 60D37	
PLOT DATE = 12/21/2007	DATE -	REVISED -	REVISED -	FED. ROAD DIST. NO. 1   ILLINOIS FED. AID PROJECT								

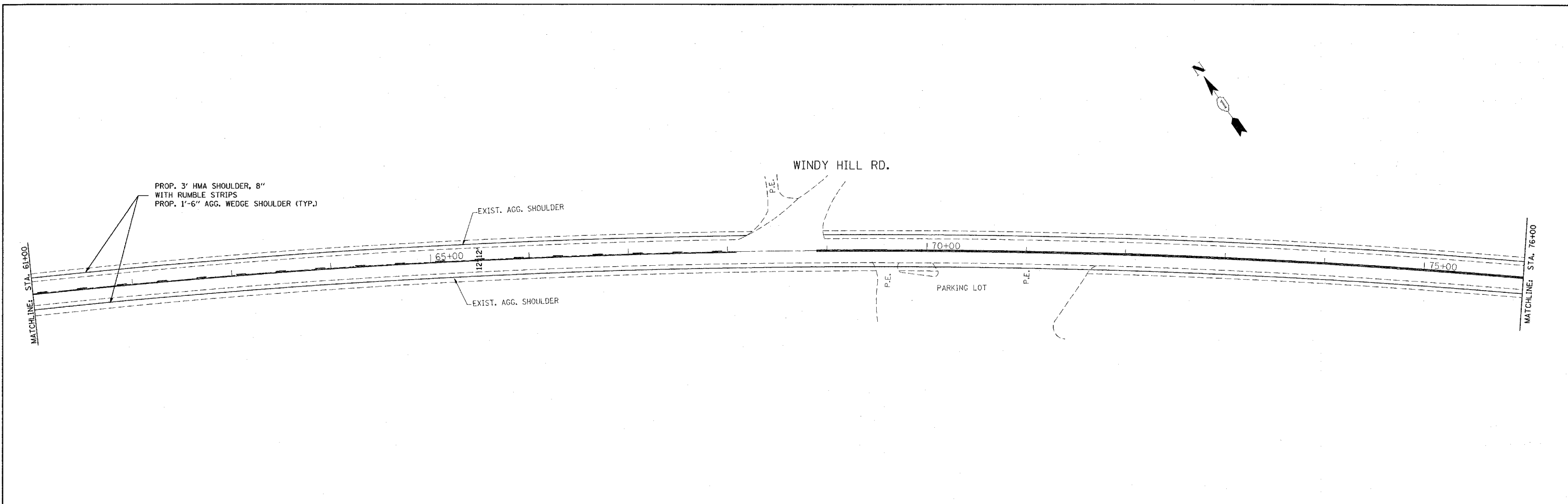

NOTE:  
 ALL EXISTING RAISED REFLECTIVE MARKERS TO BE REMOVED AND REPLACED WITHIN THE PROJECT LIMITS IN ACCORDANCE TO THE DISTRICT DETAIL: TYPICAL APPLICATIONS RAISED REFLECTIVE PAVEMENT MARKERS (SNOW-PLOW RESISTANT)

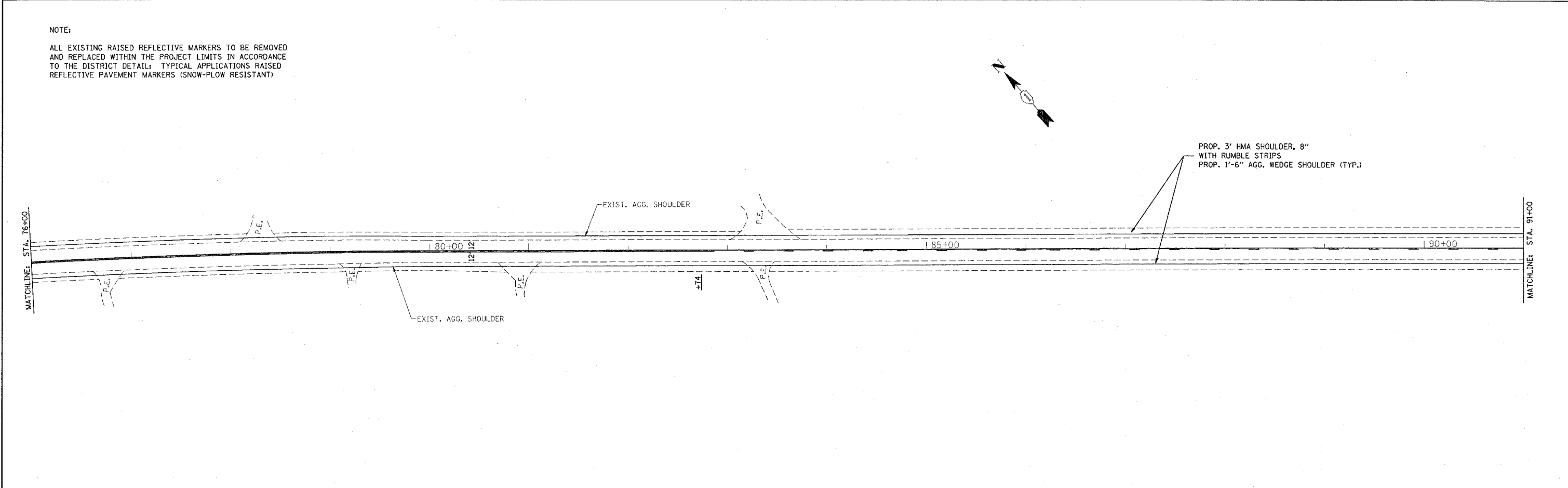

FILE NAME = c:\projects\dl00906\design\_00.dgn

USER NAME = wjgreendp  
 PLOT SCALE = 50.0000' / IN.  
 PLOT DATE = 12/21/2007

DESIGNED -  
 DRAWN -  
 CHECKED -  
 DATE -

REVISED -  
 REVISED -  
 REVISED -  
 REVISED -

**STATE OF ILLINOIS  
 DEPARTMENT OF TRANSPORTATION**

**ROADWAY AND PAVEMENT MARKING PLAN  
 US 14 (IL 23 TO WEST OF IL 120)**

SCALE: 1"=50' SHEET NO. 6 OF 20 SHEETS STA. TO STA.

F.A.P. RTE.	SECTION	COUNTY	TOTAL SHEETS	SHEET NO.
305	2007-047 I	MCHENRY	20	6
CONTRACT NO. 60D37				
FED. ROAD DIST. NO. 1 ILLINOIS FED. AID PROJECT				

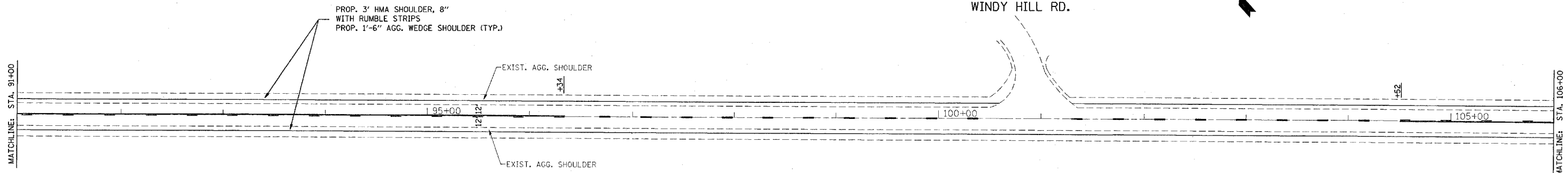

NOTE:  
 ALL EXISTING RAISED REFLECTIVE MARKERS TO BE REMOVED AND REPLACED WITHIN THE PROJECT LIMITS IN ACCORDANCE TO THE DISTRICT DETAIL: TYPICAL APPLICATIONS RAISED REFLECTIVE PAVEMENT MARKERS (SNOW-PLOW RESISTANT)

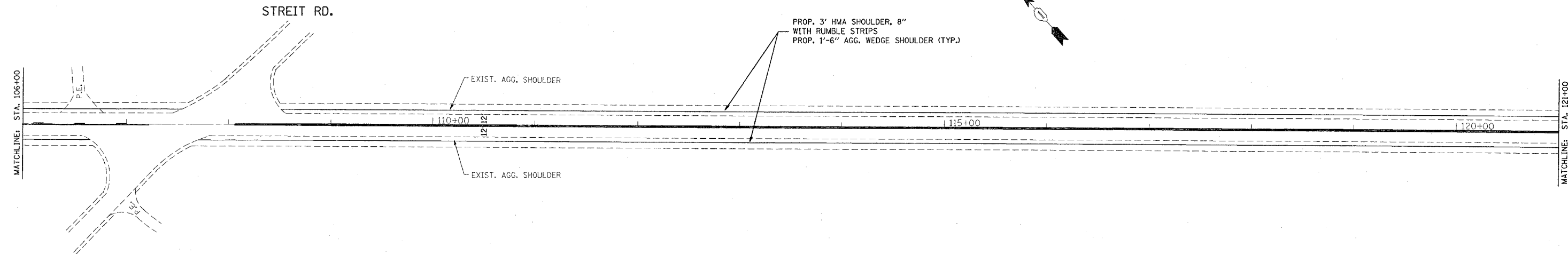

FILE NAME = c:\projects\d102908\design.aa.dgn	USER NAME = wlgreendp	DESIGNED -	REVISED -
		DRAWN -	REVISED -
	PLOT SCALE = 50.0000' / IN.	CHECKED -	REVISED -
	PLOT DATE = 12/21/2007	DATE -	REVISED -

**STATE OF ILLINOIS  
 DEPARTMENT OF TRANSPORTATION**

**ROADWAY AND PAVEMENT MARKING PLAN  
 US 14 (IL 23 TO WEST OF IL 120)**

F.A.P. RTE. 305	SECTION 2007-047 I	COUNTY MCHENRY	TOTAL SHEETS 20	SHEET NO. 7
CONTRACT NO. 60D37				
FED. ROAD DIST. NO. 1   ILLINOIS   FED. AID PROJECT				

SCALE: 1"=50'      SHEET NO. 7 OF 20 SHEETS      STA.      TO STA.

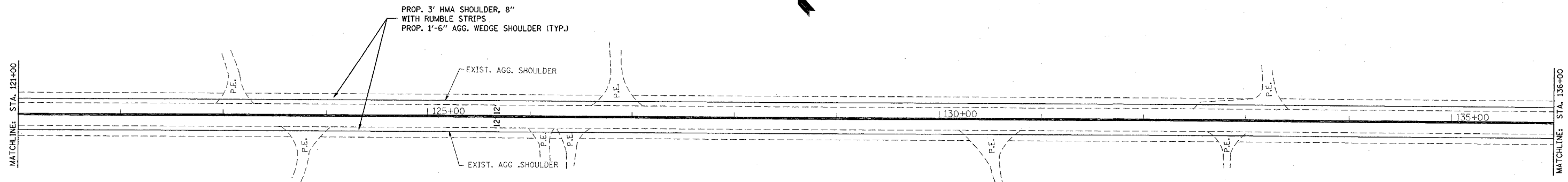

NOTE:  
 ALL EXISTING RAISED REFLECTIVE MARKERS TO BE REMOVED AND REPLACED WITHIN THE PROJECT LIMITS IN ACCORDANCE TO THE DISTRICT DETAIL: TYPICAL APPLICATIONS RAISED REFLECTIVE PAVEMENT MARKERS (SNOW-PLOW RESISTANT)

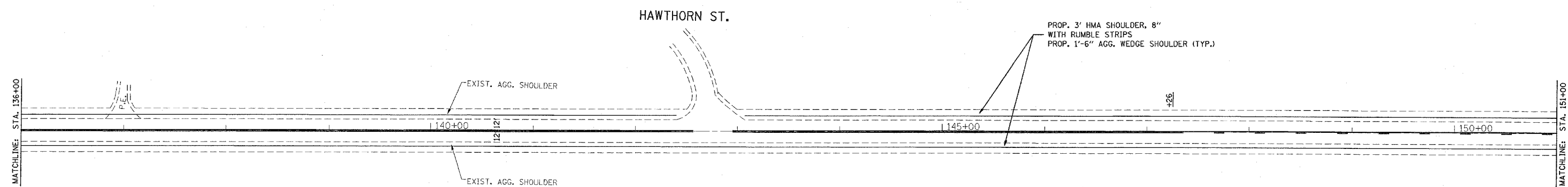

FILE NAME = c:\projects\dl00908\design\_00.dgn

USER NAME = wjgreendp

DESIGNED -

DRAWN -

PLOT SCALE = 50,0000 1 / IN.

PLOT DATE = 12/21/2007

CHECKED -

DATE -

REVISED -

REVISED -

REVISED -

REVISED -

**STATE OF ILLINOIS  
 DEPARTMENT OF TRANSPORTATION**

**ROADWAY AND PAVEMENT MARKING PLAN  
 US 14 (IL 23 TO WEST OF IL 120)**

SCALE: 1"=50'

SHEET NO. 8 OF 20 SHEETS

STA.

TO STA.

F.A.P. RTE. 305

SECTION 2007-047 I

COUNTY MCHENRY

TOTAL SHEETS 20

SHEET NO. 8

CONTRACT NO. 60D37

FED. ROAD DIST. NO. 1 ILLINOIS FED. AID PROJECT



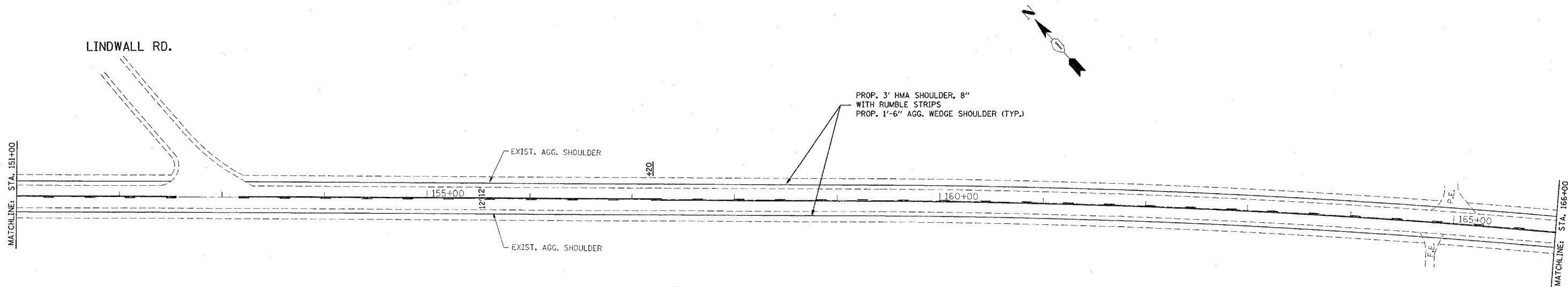

NOTE:  
 ALL EXISTING RAISED REFLECTIVE MARKERS TO BE REMOVED  
 AND REPLACED WITHIN THE PROJECT LIMITS IN ACCORDANCE  
 TO THE DISTRICT DETAIL: TYPICAL APPLICATIONS RAISED  
 REFLECTIVE PAVEMENT MARKERS (SNOW-PLOW RESISTANT)

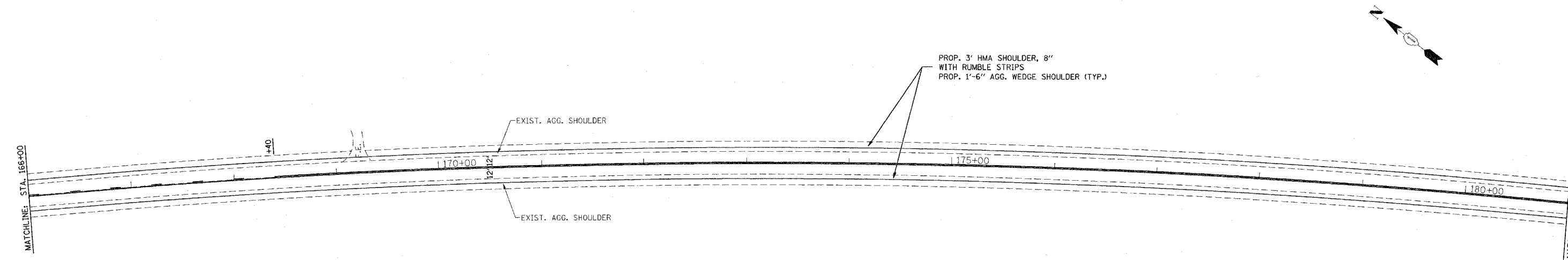

FILE NAME =  
 a:\projects\102908\design\_00.dgn

USER NAME = wlgreendp  
 PLOT SCALE = 50.0000' / IN.  
 PLOT DATE = 12/21/2007

DESIGNED -  
 DRAWN -  
 CHECKED -  
 DATE -

REVISED -  
 REVISED -  
 REVISED -  
 REVISED -

**STATE OF ILLINOIS  
 DEPARTMENT OF TRANSPORTATION**

**ROADWAY AND PAVEMENT MARKING PLAN  
 US 14 (IL 23 TO WEST OF IL 120)**

SCALE: 1"=50' SHEET NO. 9 OF 20 SHEETS STA. TO STA.

F.A.P. RTE. 305	SECTION 2007-047 I	COUNTY MCHENRY	TOTAL SHEETS 20	SHEET NO. 9
CONTRACT NO. 60D37				
FED. ROAD DIST. NO. 1 [ILLINOIS] FED. AID PROJECT				

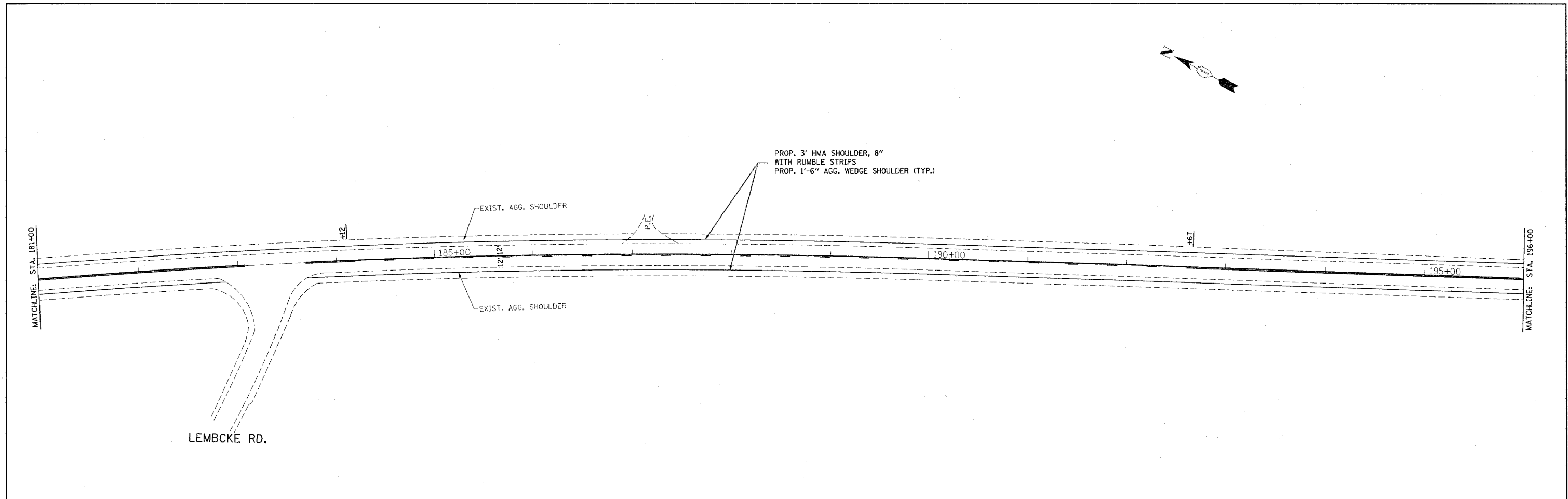

**NOTE:**

ALL EXISTING RAISED REFLECTIVE MARKERS TO BE REMOVED AND REPLACED WITHIN THE PROJECT LIMITS IN ACCORDANCE TO THE DISTRICT DETAIL: TYPICAL APPLICATIONS RAISED REFLECTIVE PAVEMENT MARKERS (SNOW-PLOW RESISTANT)

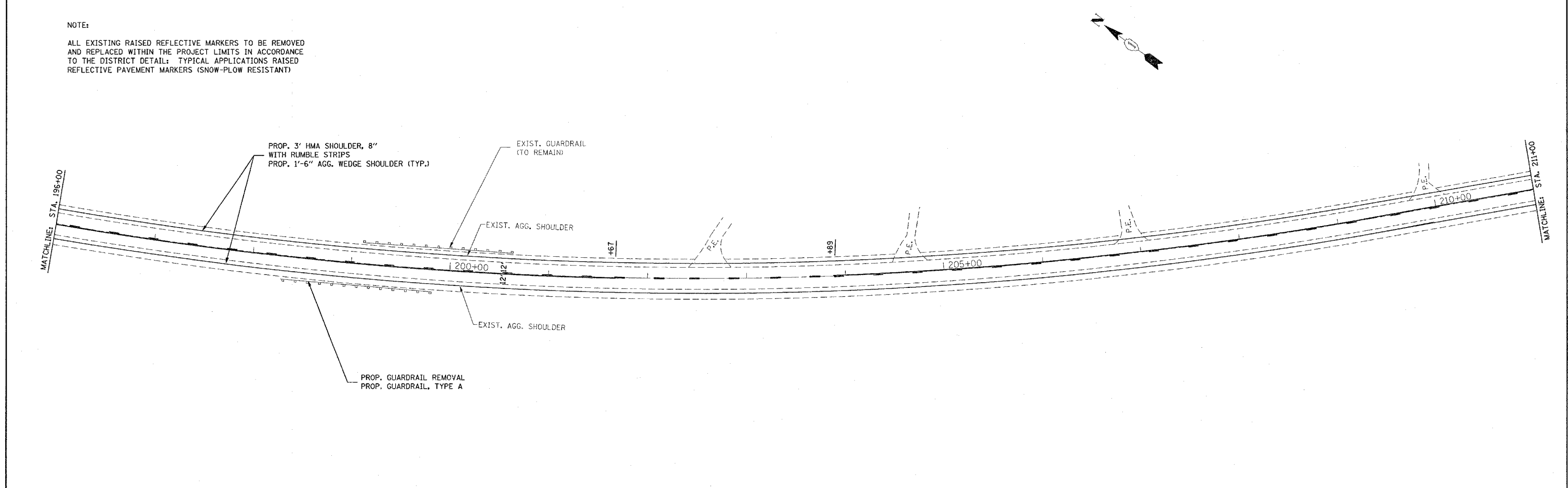

FILE NAME = o:\projects\1100986\design_aa.dgn	USER NAME = w1greendp	DESIGNED -	REVISED -	<b>STATE OF ILLINOIS DEPARTMENT OF TRANSPORTATION</b>	<b>ROADWAY AND PAVEMENT MARKING PLAN US 14 (IL 23 TO WEST OF IL 120)</b>			F.A.P. RTE. 305	SECTION 2007-047 I	COUNTY MCHENRY	TOTAL SHEETS 20	SHEET NO. 10
	PLOT SCALE = 50.0000' / IN.	CHECKED -	REVISED -		SCALE: 1"=50'	SHEET NO. 10 OF 20 SHEETS	STA. TO STA.	FED. ROAD DIST. NO. 1 (ILLINOIS) FED. AID PROJECT CONTRACT NO. 60D37				
PLOT DATE = 12/21/2007	DATE -	REVISED -	REVISED -									

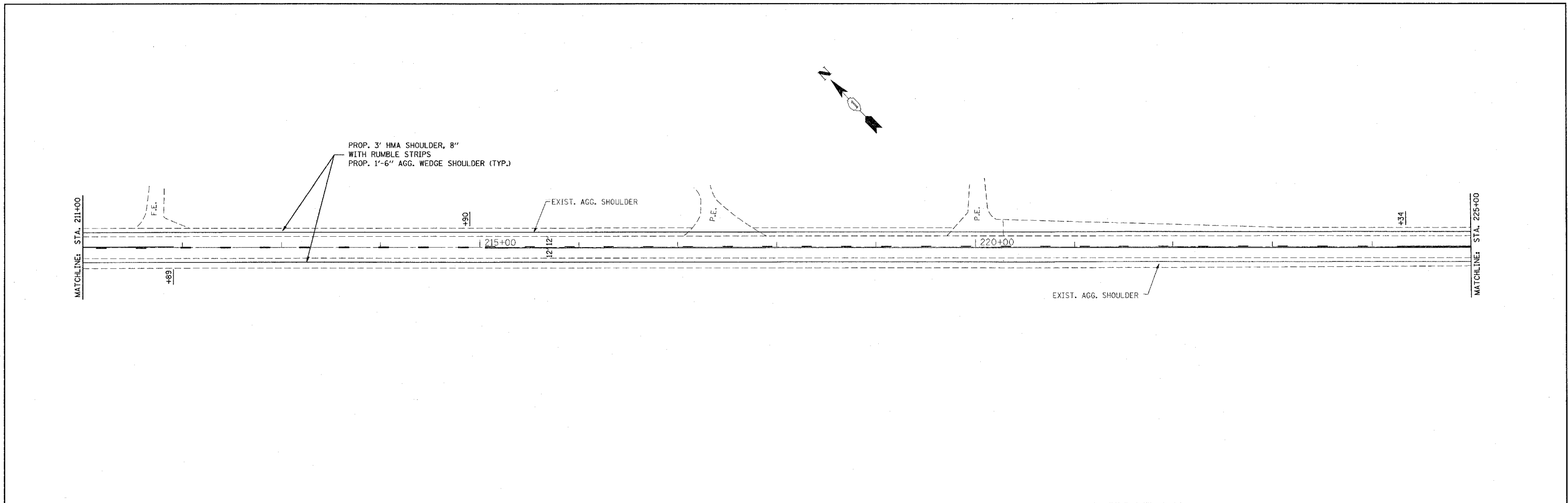

**NOTE:**

ALL EXISTING RAISED REFLECTIVE MARKERS TO BE REMOVED AND REPLACED WITHIN THE PROJECT LIMITS IN ACCORDANCE TO THE DISTRICT DETAIL: TYPICAL APPLICATIONS RAISED REFLECTIVE PAVEMENT MARKERS (SNOW-PLOW RESISTANT)

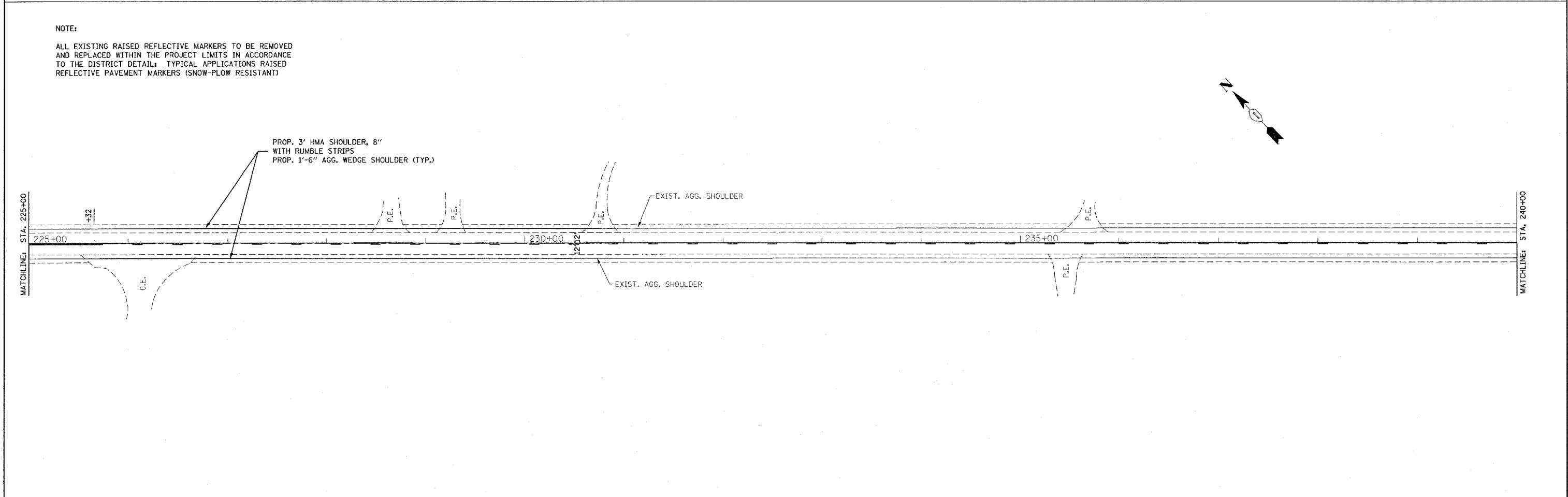

FILE NAME = c:\projects\d100908\design_ee.dgn	USER NAME = wlgreendp	DESIGNED -	REVISED -	<b>STATE OF ILLINOIS DEPARTMENT OF TRANSPORTATION</b>	<b>ROADWAY AND PAVEMENT MARKING PLAN US 14 (IL 23 TO WEST OF IL 120)</b>			F.A.P. RTE. 305	SECTION 2007-047 I	COUNTY MCHENRY	TOTAL SHEETS 20	SHEET NO. 11
	PLOT SCALE = 50.0000' / IN.	CHECKED -	REVISED -					CONTRACT NO. 60D37				
	PLOT DATE = 12/21/2007	DATE -	REVISED -		SCALE: 1"=50'	SHEET NO. 11 OF 20 SHEETS	STA. TO STA.	FED. ROAD DIST. NO. 1 ILLINOIS FED. AID PROJECT				

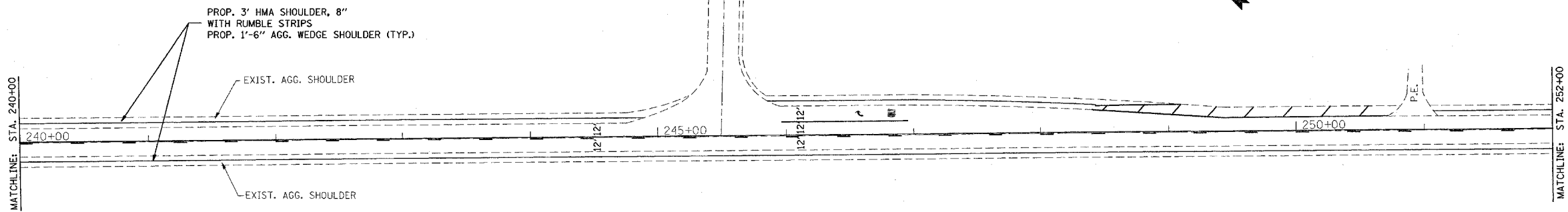

NOTE:  
 ALL EXISTING RAISED REFLECTIVE MARKERS TO BE REMOVED AND REPLACED WITHIN THE PROJECT LIMITS IN ACCORDANCE TO THE DISTRICT DETAIL. TYPICAL APPLICATIONS RAISED REFLECTIVE PAVEMENT MARKERS (SNOW-PLOW RESISTANT)

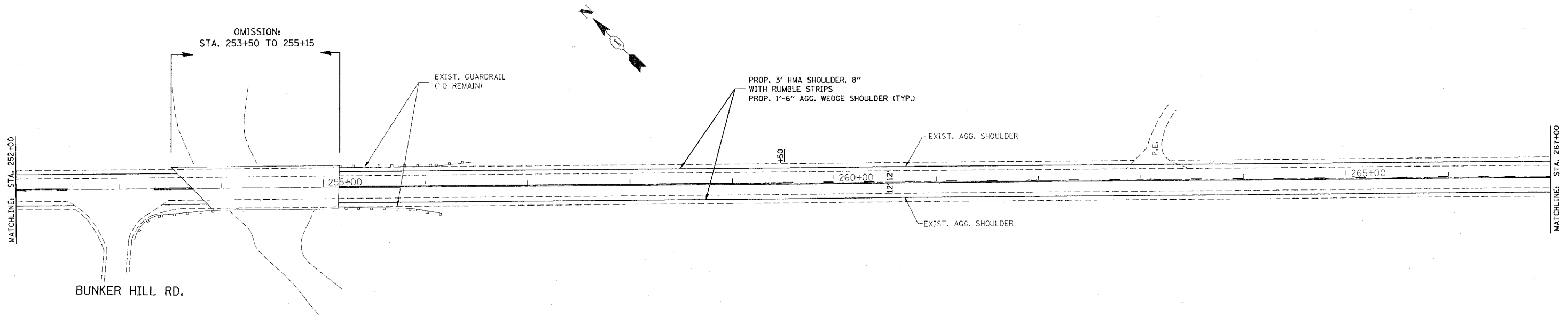

FILE NAME = c:\projects\1107908\design_00.dgn	USER NAME = wjgreendp	DESIGNED -	REVISED -
		DRAWN -	REVISED -
	PLOT SCALE = 50.0000' / IN.	CHECKED -	REVISED -
	PLOT DATE = 12/21/2007	DATE -	REVISED -

**STATE OF ILLINOIS  
 DEPARTMENT OF TRANSPORTATION**

**ROADWAY AND PAVEMENT MARKING PLAN  
 US 14 (IL 23 TO WEST OF IL 120)**

SCALE: 1"=50'      SHEET NO. 12 OF 20 SHEETS      STA.      TO STA.

F.A.P. RTE. 305	SECTION 2007-047 I	COUNTY MCHENRY	TOTAL SHEETS 20	SHEET NO. 12
CONTRACT NO. 60D37				
FED. ROAD DIST. NO. 1 ILLINOIS FED. AID PROJECT				

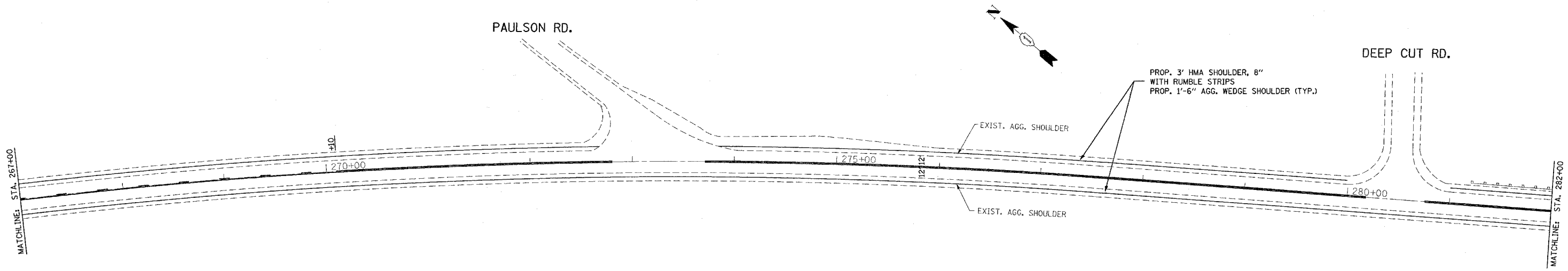

NOTE:  
 ALL EXISTING RAISED REFLECTIVE MARKERS TO BE REMOVED AND REPLACED WITHIN THE PROJECT LIMITS IN ACCORDANCE TO THE DISTRICT DETAIL. TYPICAL APPLICATIONS RAISED REFLECTIVE PAVEMENT MARKERS (SNOW-PLOW RESISTANT)

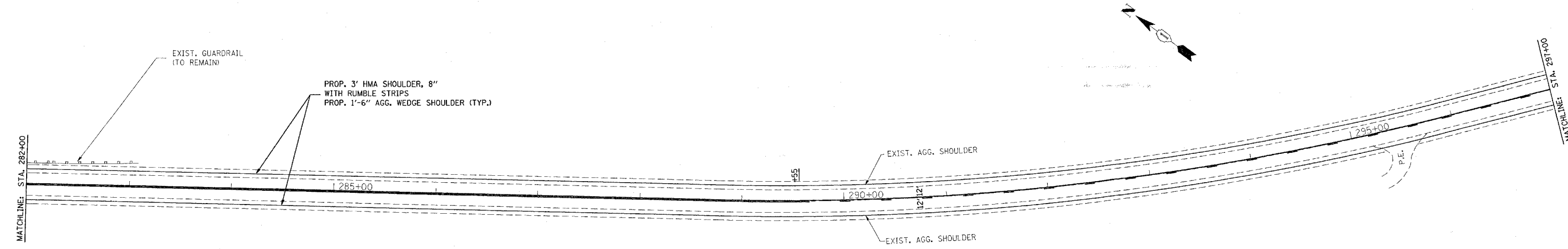

FILE NAME = c:\projects\1100900\design_00.dgn	USER NAME = wlgreendp	DESIGNED -	REVISED -
		DRAWN -	REVISED -
		CHECKED -	REVISED -
		DATE -	REVISED -

**STATE OF ILLINOIS  
 DEPARTMENT OF TRANSPORTATION**

**ROADWAY AND PAVEMENT MARKING PLAN  
 US 14 (IL 23 TO WEST OF IL 120)**

SCALE: 1"=50'    SHEET NO. 13 OF 20 SHEETS    STA.    TO STA.

F.A.P. RTE. 305	SECTION 2007-047 I	COUNTY MCHENRY	TOTAL SHEETS 20	SHEET NO. 13
CONTRACT NO. 60D37				
FED. ROAD DIST. NO. 1 ILLINOIS FED. AID PROJECT				

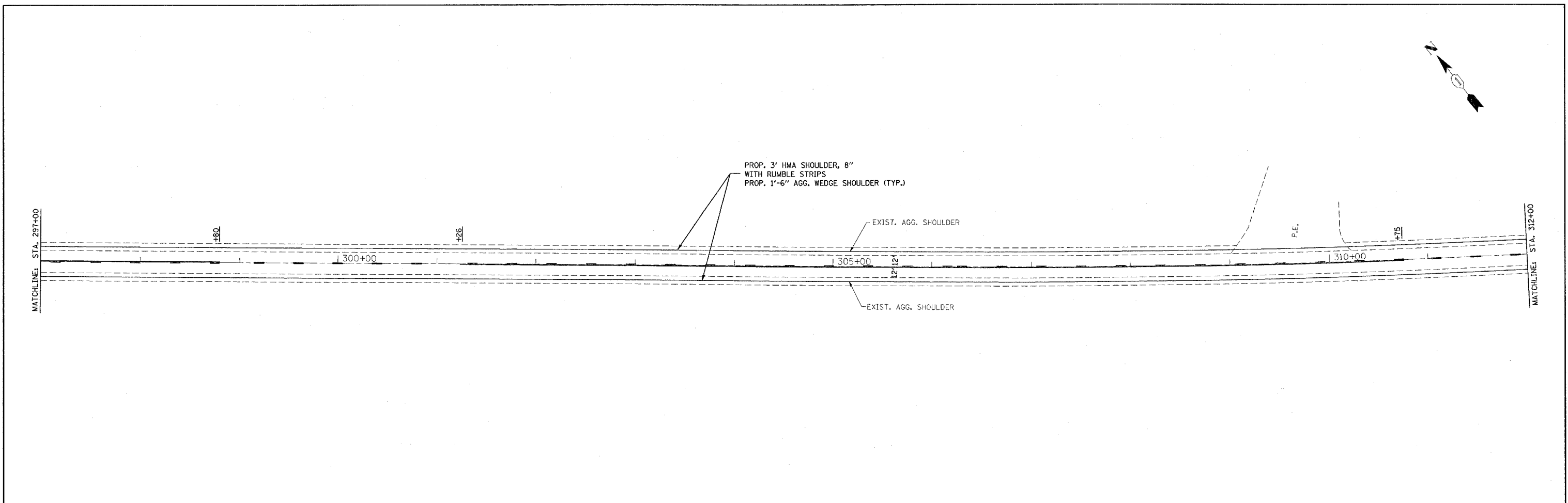

NOTE:  
 ALL EXISTING RAISED REFLECTIVE MARKERS TO BE REMOVED  
 AND REPLACED WITHIN THE PROJECT LIMITS IN ACCORDANCE  
 TO THE DISTRICT DETAIL: TYPICAL APPLICATIONS RAISED  
 REFLECTIVE PAVEMENT MARKERS (SNOW-PLOW RESISTANT)

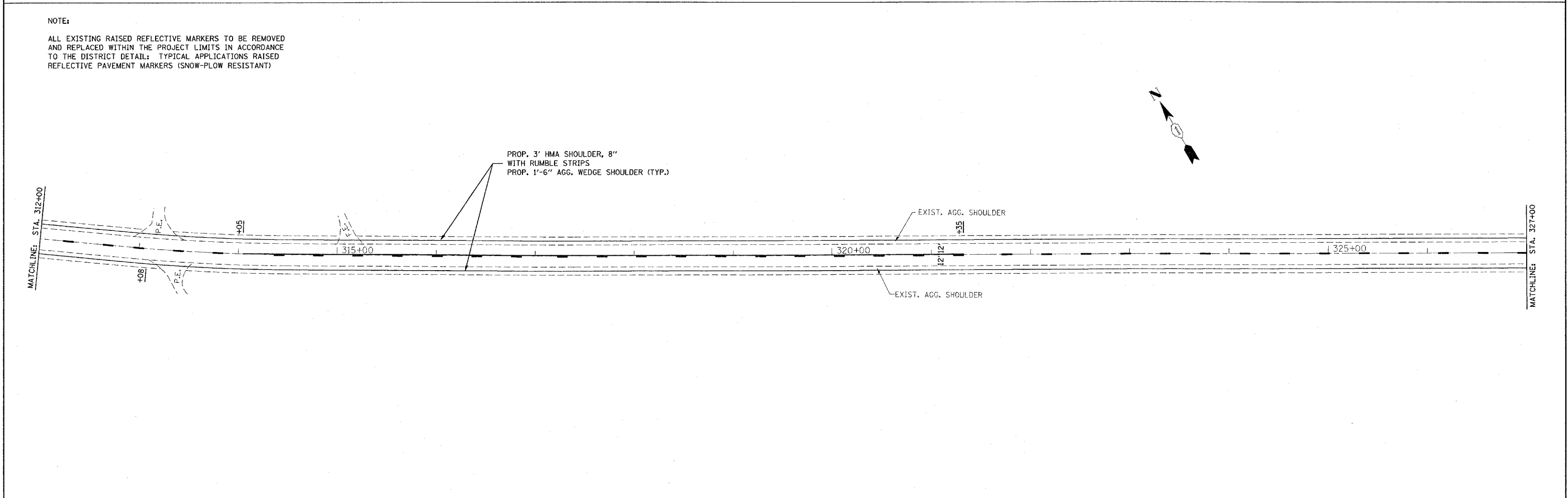

FILE NAME = c:\projects\100926\design_ee.dgn	USER NAME = wilgreendp	DESIGNED -	REVISED -	<b>STATE OF ILLINOIS DEPARTMENT OF TRANSPORTATION</b>	<b>ROADWAY AND PAVEMENT MARKING PLAN US 14 (IL 23 TO WEST OF IL 120)</b>			F.A.P. RTE. 305	SECTION 2007-047 I	COUNTY MCHENRY	TOTAL SHEETS 20	SHEET NO. 14
	PLOT SCALE = 50,000.00' / IN.	CHECKED -	REVISED -		SCALE: 1"=50'	SHEET NO. 14 OF 20 SHEETS	STA.	TO STA.	FED. ROAD DIST. NO. 1   ILLINOIS   FED. AID PROJECT			
PLOT DATE = 12/21/2007	DATE -	REVISED -	REVISED -		CONTRACT NO. 60D37							



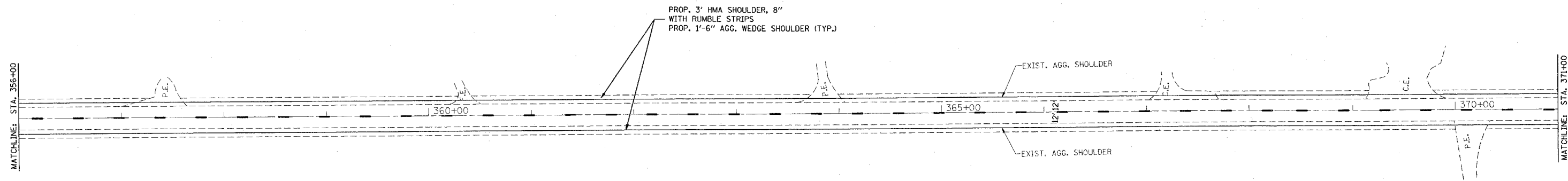
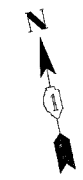

NOTE:  
 ALL EXISTING RAISED REFLECTIVE MARKERS TO BE REMOVED  
 AND REPLACED WITHIN THE PROJECT LIMITS IN ACCORDANCE  
 TO THE DISTRICT DETAIL: TYPICAL APPLICATIONS RAISED  
 REFLECTIVE PAVEMENT MARKERS (SNOW-PLOW RESISTANT)

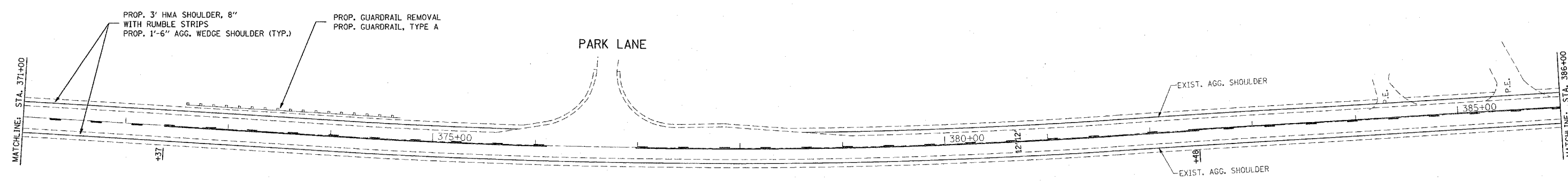

FILE NAME = c:\projects\1002908\design.asdgn	USER NAME = wilgreendp	DESIGNED -	REVISED -
PLOT SCALE = 50.0000' / IN.	DATE = 12/21/2007	DRAWN -	REVISED -
		CHECKED -	REVISED -
		DATE -	REVISED -

**STATE OF ILLINOIS  
 DEPARTMENT OF TRANSPORTATION**

<b>ROADWAY AND PAVEMENT MARKING PLAN</b>			
<b>US 14 (IL 23 TO WEST OF IL 120)</b>			
SCALE: 1"=50'	SHEET NO. 16 OF 20 SHEETS	STA.	TO STA.

F.A.P. RTE. 305	SECTION 2007-047 I	COUNTY MCHENRY	TOTAL SHEETS 20	SHEET NO. 16
FED. ROAD DIST. NO. 1 ILLINOIS FED. AID PROJECT				
CONTRACT NO. 60D37				



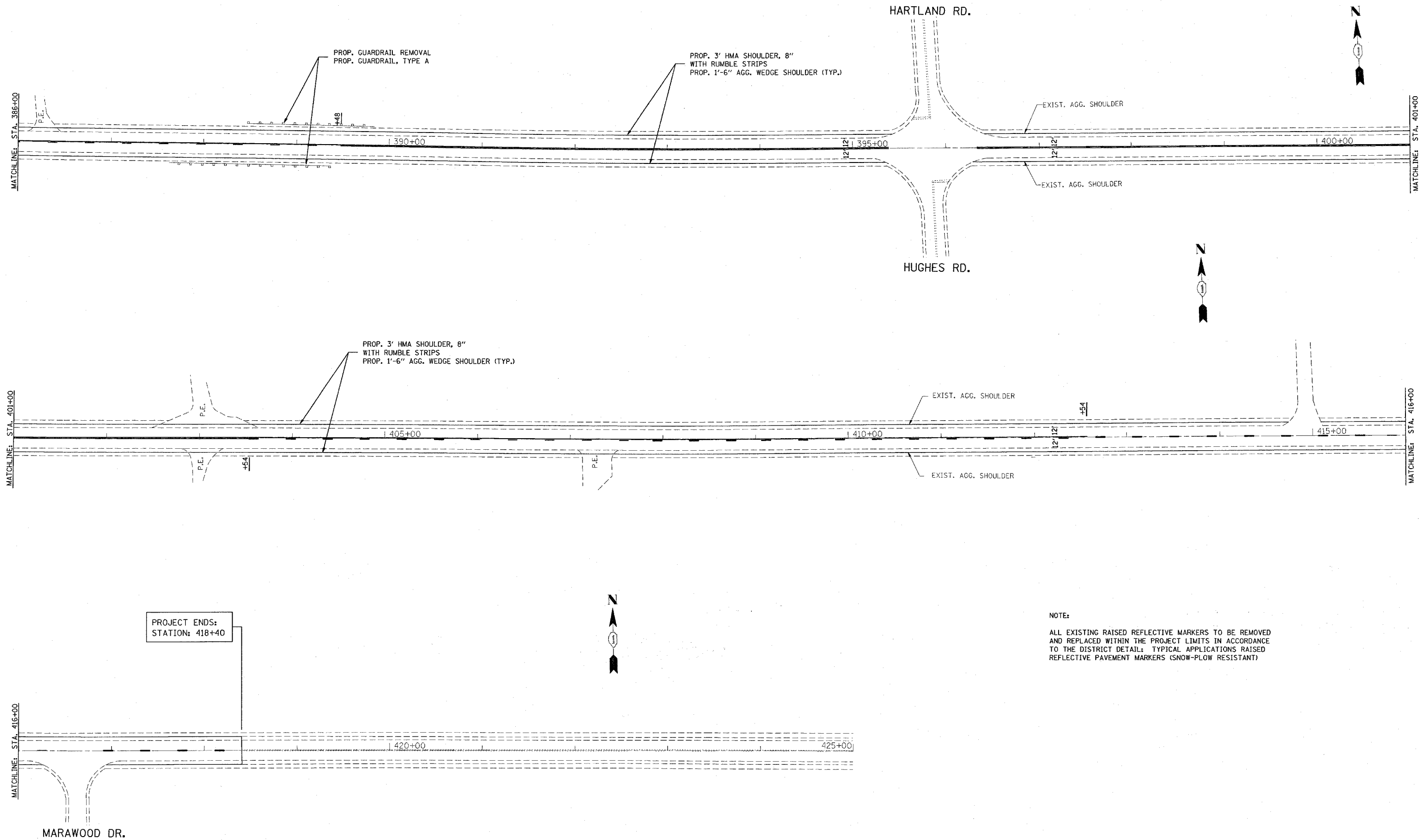

FILE NAME =  
c:\projects\dl00988\design.asdgn

USER NAME = wilgreenp  
PLOT SCALE = 50.0000' / IN.  
PLOT DATE = 12/21/2007

DESIGNED -  
DRAWN -  
CHECKED -  
DATE -

REVISED -  
REVISED -  
REVISED -  
REVISED -

**STATE OF ILLINOIS  
DEPARTMENT OF TRANSPORTATION**

**ROADWAY AND PAVEMENT MARKING PLAN  
US 14 (IL 23 TO WEST OF IL 120)**

SCALE: 1"=50' SHEET NO. 17 OF 20 SHEETS STA. TO STA.

F.A.P. RTE.	SECTION	COUNTY	TOTAL SHEETS	SHEET NO.
305	2007-047 I	MCHENRY	20	17
CONTRACT NO. 60D37				

FED. ROAD DIST. NO. 1 ILLINOIS FED. AID PROJECT

F.A.P. RTE.	SECTION	COUNTY	TOTAL SHEETS	SHEET NO.
305	2007-047 I	MCHENRY	20	18
STA.		TO STA.		
FED. ROAD DIST. NO. 1		ILLINOIS FED. AID PROJECT		

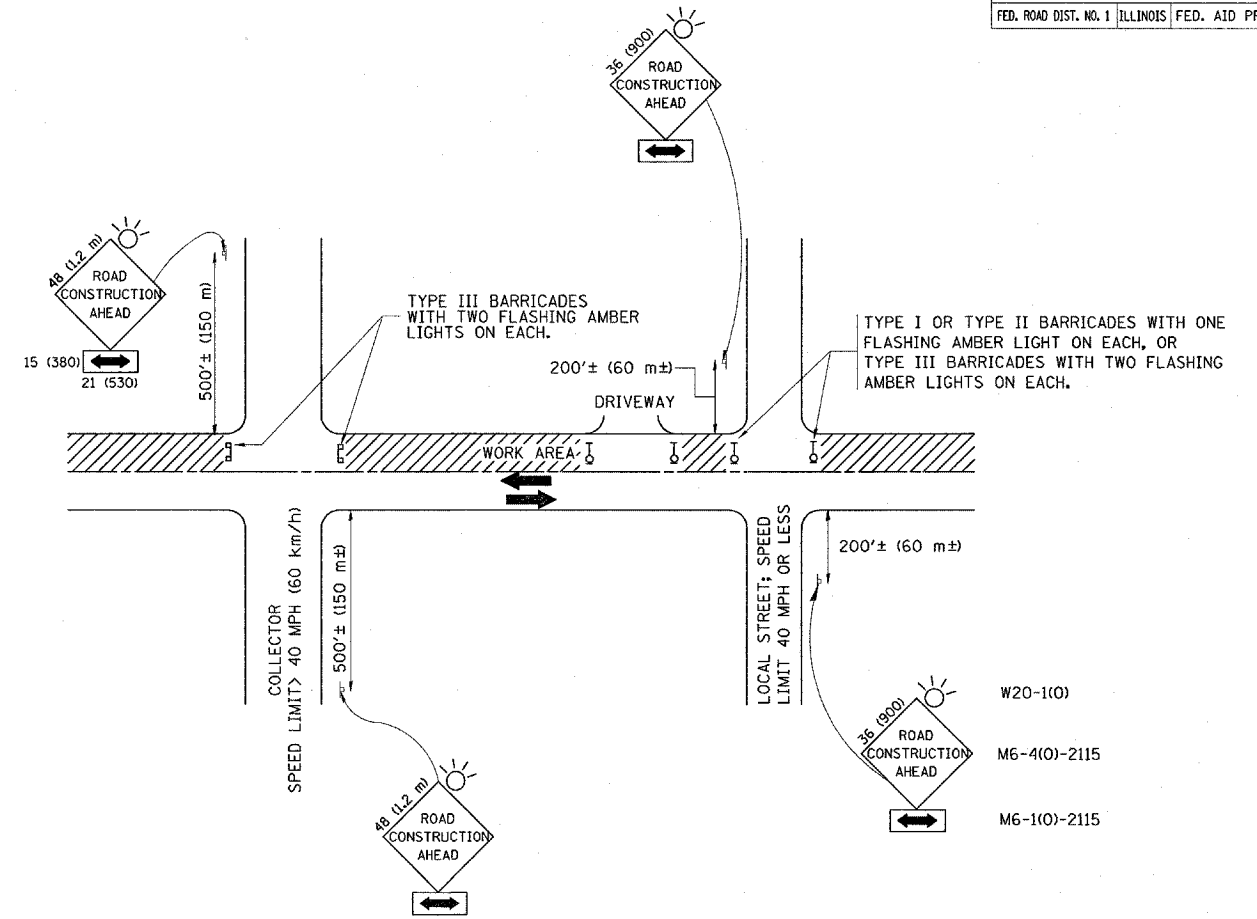

TRAFFIC CONTROL AND PROTECTION FOR SIDE ROADS, INTERSECTIONS, AND DRIVEWAYS

NOTES:

- A. FOR NO LANE RESTRICTION ON THE SIDE ROAD OR DRIVEWAYS
  - 1. SIDE ROAD WITH A SPEED LIMIT OF 40 MPH (60 km/h) OR LESS AS SHOWN ON THE DRAWING AND AS DIRECTED BY THE ENGINEER:
    - a) ONE ROAD CONSTRUCTION AHEAD SIGN 36 x 36 (900x900) WITH A FLASHER AND FLAG MOUNTED ON IT APPROXIMATELY 200' (60 m) IN ADVANCE OF THE MAIN ROUTE.
    - b) THE CLOSED PORTION OF THE MAIN ROUTE SHALL BE PROTECTED BY BLOCKING WITH TYPE I, TYPE II OR TYPE III BARRICADES, 1/3 OF THE CROSS SECTION OF THE CLOSED PORTION.
  - 2. SIDE ROAD WITH A SPEED LIMIT GREATER THAN 40 MPH (60 km/h) AS SHOWN ON THE DRAWING AND AS DIRECTED BY THE ENGINEER:
    - a) ONE ROAD CONSTRUCTION AHEAD SIGN 48 x 48 (1.2 m x 1.2 m) WITH A FLASHER MOUNTED ON IT APPROXIMATELY 500' (150 m) IN ADVANCE OF THE MAIN ROUTE.
    - b) THE CLOSED PORTION OF THE MAIN ROUTE SHALL BE PROTECTED BY BLOCKING WITH TYPE III BARRICADES, 1/2 OF THE CROSS SECTION OF THE CLOSED PORTION.
- 3. WHEN THE SIDE ROAD LIES BETWEEN THE BEGINNING OF THE MAINLINE SIGNING AND THE WORK ZONE, A SINGLE HEADED ARROW (M6-1) SHALL BE USED IN LIEU OF THE DOUBLE HEADED ARROW (M6-4).

- B. FOR A LANE CLOSURE ON A SIDE ROAD OR DRIVEWAY:
  - USE APPLICABLE PORTIONS OF THE TYPICAL APPLICATION OF TRAFFIC CONTROL DEVICES (STD. 701501, STD. 701606 OR THE APPROPRIATE STANDARD). THE SPACING OF SIGNS AND BARRICADES SHALL BE ADJUSTED FOR FIELD CONDITIONS AS DIRECTED BY THE ENGINEER. THE DIRECTIONAL ARROW SHALL BE COVERED OR REMOVED WHEN NO LONGER CONSISTENT WITH THE SIDE ROAD LANE CLOSURE.
- C. ADVANCE WARNING SIGNS ARE TO BE OMITTED ON DRIVEWAY UNLESS OTHERWISE NOTED.
- D. THE TRAFFIC CONTROL AND PROTECTION FOR SIDE ROADS, INTERSECTIONS, AND DRIVEWAYS SHALL BE INCIDENTAL TO THE COST OF SPECIFIED TRAFFIC CONTROL STANDARDS OR ITEMS.

All dimensions are in millimeters (inches) unless otherwise shown.

REVISIONS	
NAME	DATE
LHA	6/89
T. RAMMACHER	09/08/94
J. OBERLE	10/18/95
A. HOUSEH	03/06/96
A. HOUSEH	10/15/96
T. RAMMACHER	01/06/00

ILLINOIS DEPARTMENT OF TRANSPORTATION  
**TRAFFIC CONTROL AND PROTECTION FOR SIDE ROADS, INTERSECTIONS, AND DRIVEWAYS**

SCALE: NONE  
 DRAWN BY  
 CHECKED BY  
 TC-10

PLOT DATE = 12/26/2007  
 FILE NAME = \\distinstf2\users\wlgreenup\Desktop\US 14 Distract Details\coll.dgn  
 PLOT SCALE = 50:1  
 USER NAME = wlgreenup

F.A.P. RTE.	SECTION	COUNTY	TOTAL SHEETS	SHEET NO.
305	2007-047 I	MCHENRY	20	19
STA.		TO STA.		
FED. ROAD DIST. NO. 1		ILLINOIS FED. AID PROJECT		

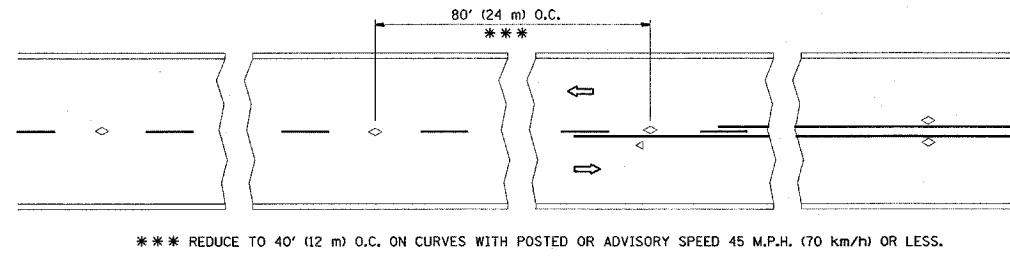

TWO-LANE/TWO-WAY

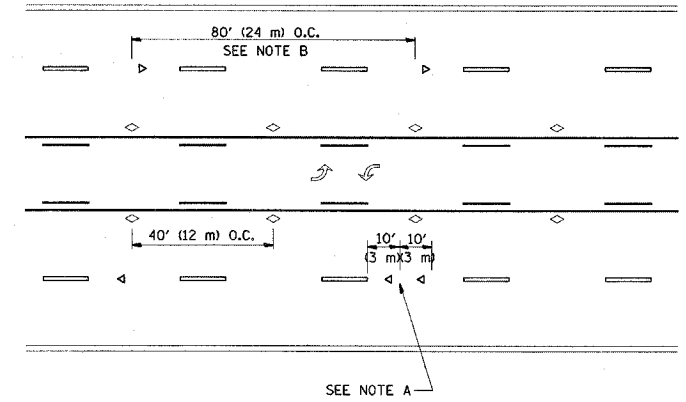
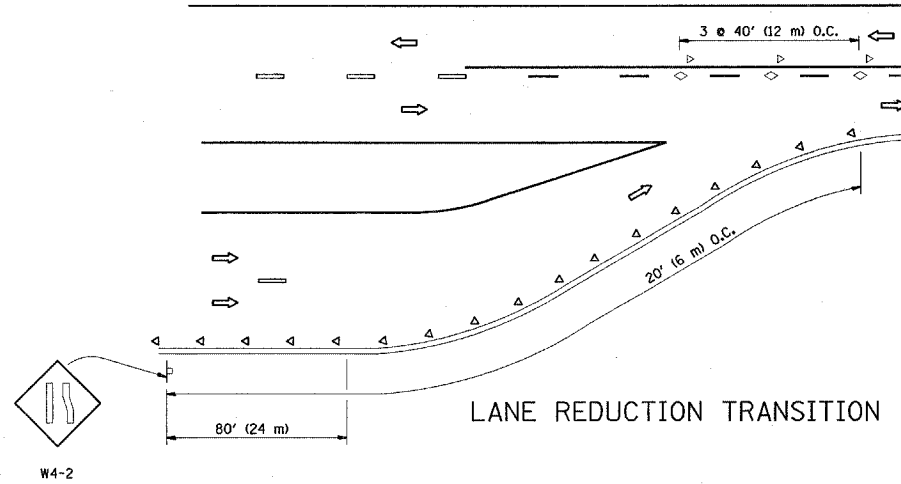

TWO-WAY LEFT TURN

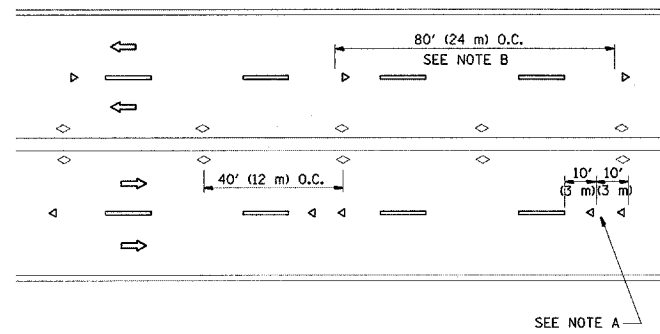

MULTI-LANE/UNDIVIDED

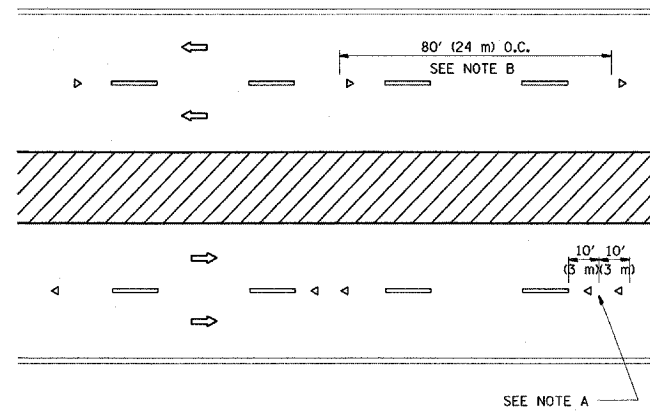

MULTI-LANE/DIVIDED

GENERAL NOTES

1. MARKERS USED WITH DASHED LINES SHALL BE CENTERED IN THE GAP BETWEEN SEGMENTS.
2. MARKERS USED ADJACENT TO SOLID LINES SHALL BE OFFSET 2 TO 3 (50 TO 75) TOWARD TRAFFIC AS SHOWN.
3. MARKERS THROUGH TANGENTS LESS THAN 500' (150 m) IN LENGTH BETWEEN CURVES SHALL BE INSTALLED AT THE LESSER OF THE TWO CURVE SPACINGS.

SYMBOLS

- YELLOW STRIPE
- WHITE STRIPE
- ◁ ONE-WAY AMBER MARKER
- ◁ ONE-WAY CRYSTAL MARKER (W/O)
- ◊ TWO-WAY AMBER MARKER

LANE MARKER NOTES

- B. REDUCE TO 40' (12 m) O.C. ON CURVES WHERE ADVISORY SPEEDS ARE 10 M.P.H. (20 km/h) LOWER THAN POSTED SPEEDS.
- A. USE DOUBLE LANE LINE MARKERS SPACED AS SHOWN.

DESIGN NOTES

1. DOUBLE LANE LINE MARKERS SHALL BE USED UNLESS SPECIFIED OTHERWISE.
2. EXCEPT AS SHOWN ON THE LANE REDUCTION TRANSITION AND FREEWAY EXIT RAMP DETAIL, MARKERS ARE NOT TO BE SPECIFIED ON RIGHT EDGE LINES.
3. THE EXACT MARKER LIMITS, SPACING, AND COLOR SHOULD BE INCLUDED IN THE PLANS.
4. MARKERS SHOULD NOT BE USED ALONGSIDE CURBS EXCEPT FOR EXTREMELY SHORT SECTIONS OF CURBS WHERE NOT MORE THAN TWO MARKERS WOULD BE INVOLVED.

All dimensions are in inches (millimeters) unless otherwise shown.

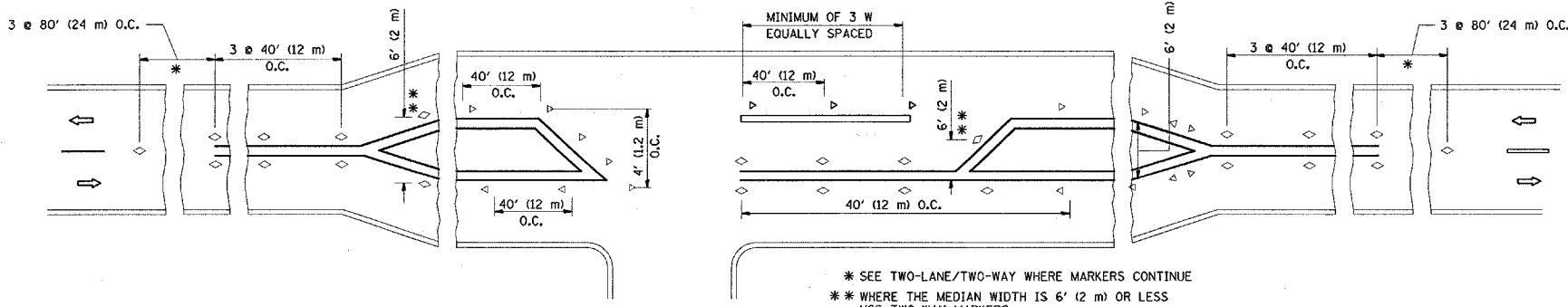

- \* SEE TWO-LANE/TWO-WAY WHERE MARKERS CONTINUE
- \*\* WHERE THE MEDIAN WIDTH IS 6' (2 m) OR LESS USE TWO-WAY MARKERS.

LEFT TURN

REVISIONS	
NAME	DATE
T. RAMMACHER	09-19-94
T. RAMMACHER	03-12-99
T. RAMMACHER	01-06-00

ILLINOIS DEPARTMENT OF TRANSPORTATION  
TYPICAL APPLICATIONS  
RAISED REFLECTIVE PAVEMENT  
MARKERS (SNOW-PLOW RESISTANT)

SCALE: NONE

DRAWN BY CADD  
CHECKED BY  
TC-11

F.A.P. RTE.	SECTION	COUNTY	TOTAL SHEETS	SHEET NO.
305	2007-047 I	MCHENRY	20	20
STA.		TO STA.		
FED. ROAD DIST. NO. 1		ILLINOIS FED. AID PROJECT		

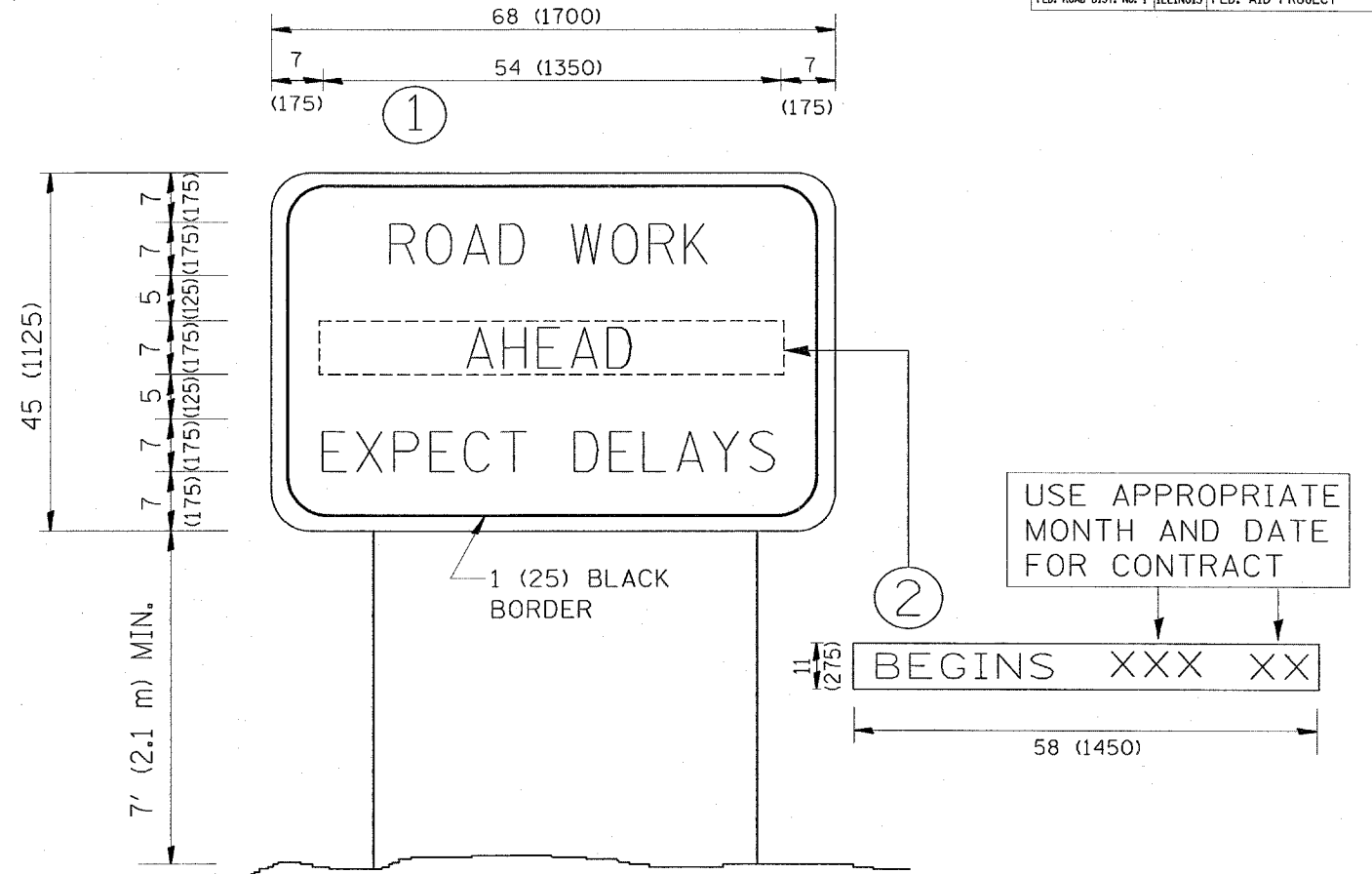

NOTES:

1. USE BLACK LETTERING ON ORANGE BACKGROUND.
2. ERECT SIGNS IN ADVANCE OF THE LOCATION FOR THE "ROAD CONSTRUCTION AHEAD" SIGN AT LOCATIONS AS DIRECTED BY THE ENGINEER.
3. ERECT SIGN ① WITH INSTALLED PANEL ② ONE WEEK PRIOR TO THE START OF CONSTRUCTION.
4. REMOVE PANEL ② SOON AFTER THE START OF CONSTRUCTION.
5. SEE SPECIAL PROVISION FOR "TEMPORARY INFORMATION SIGNING" FOR ADDITIONAL INFORMATION.
6. ONE SIGN ASSEMBLY EQUALS 25.70 SQ. FT. (2.3 SQ. M.)
7. SHALL BE PAID FOR AS TEMPORARY INFORMATION SIGNING.

ALL DIMENSIONS ARE IN INCHES (MILLIMETERS) UNLESS OTHERWISE SHOWN.

REVISIONS	
NAME	DATE
R. MIRS	9-15-97
R. MIRS	12-11-97
T. RAMMACHER	2-2-99
C. JUCCIUS	1-31-07

ILLINOIS DEPARTMENT OF TRANSPORTATION

ARTERIAL ROAD INFORMATION SIGN

SCALE: NONE

DRAWN BY DESIGN

CHECKED BY

TC22