

STATE OF ILLINOIS
 DEPARTMENT OF TRANSPORTATION
 DIVISION OF HIGHWAYS

**PROPOSED
 HIGHWAY PLANS**

FAP ROUTE 330: US 12/20/45 SB RAMP TO
 EB IL 171 (79 TH ST & ARCHER AVE.)
 SECTION BR-H6-I-2
 STEEL BEAM REPLACEMENT
 COOK COUNTY
 C-91-037-08

F.A.P. RTE.	SECTION	COUNTY	TOTAL SHEETS	SHEET NO.
330	BR-H6-I-2	COOK	14	1
FED. ROAD DIST. NO. 1	ILLINOIS	CONTRACT NO. 60D53		

D-91-037-08

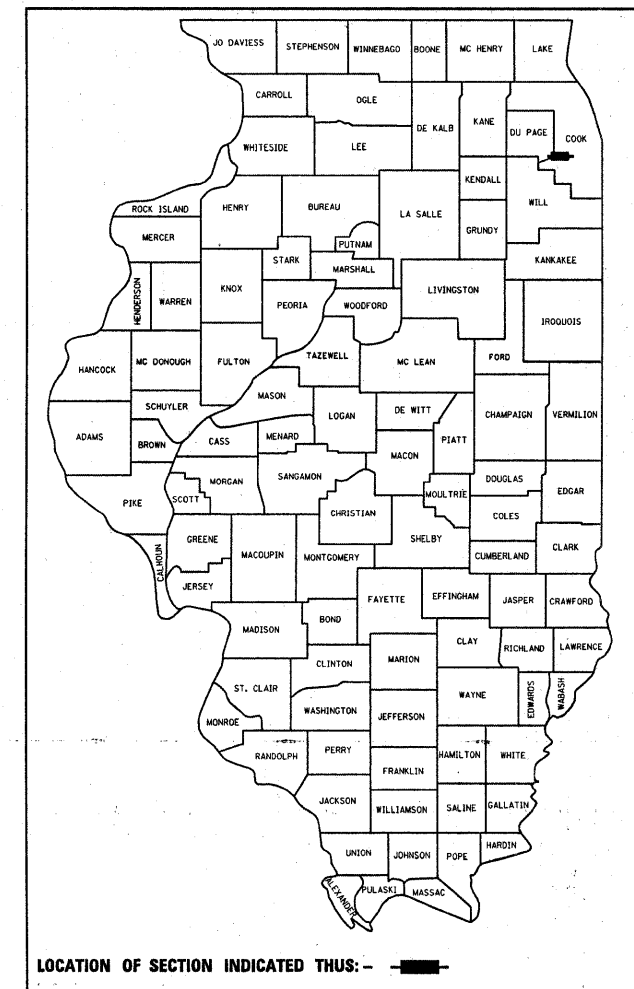

FOR INDEX OF SHEETS, SEE SHEET NO. 2

IMPROVEMENT LOCATED IN THE
 VILLAGE OF WILLOW SPRINGS

TRAFFIC DATA:

2006 ADT = 18500
 SPEED LIMIT = 40 MPH

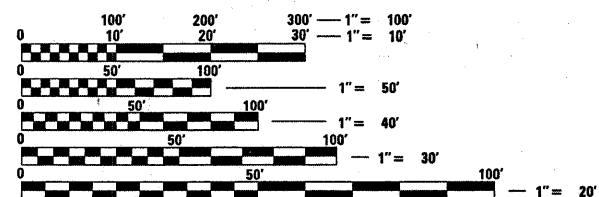

FULL SIZE PLANS HAVE BEEN PREPARED USING STANDARD ENGINEERING SCALES. REDUCED SIZED PLANS WILL NOT CONFORM TO STANDARD SCALES. IN MAKING MEASUREMENTS ON REDUCED PLANS, THE ABOVE SCALES MAY BE USED.

J.U.L.I.E.
 JOINT UTILITY LOCATION INFORMATION FOR EXCAVATION
 1-800-892-0123
 OR 811

PROJECT ENGINEER KEN ENG
 PROJECT MANAGER BOB BORO

CONTRACT NO. 60D53

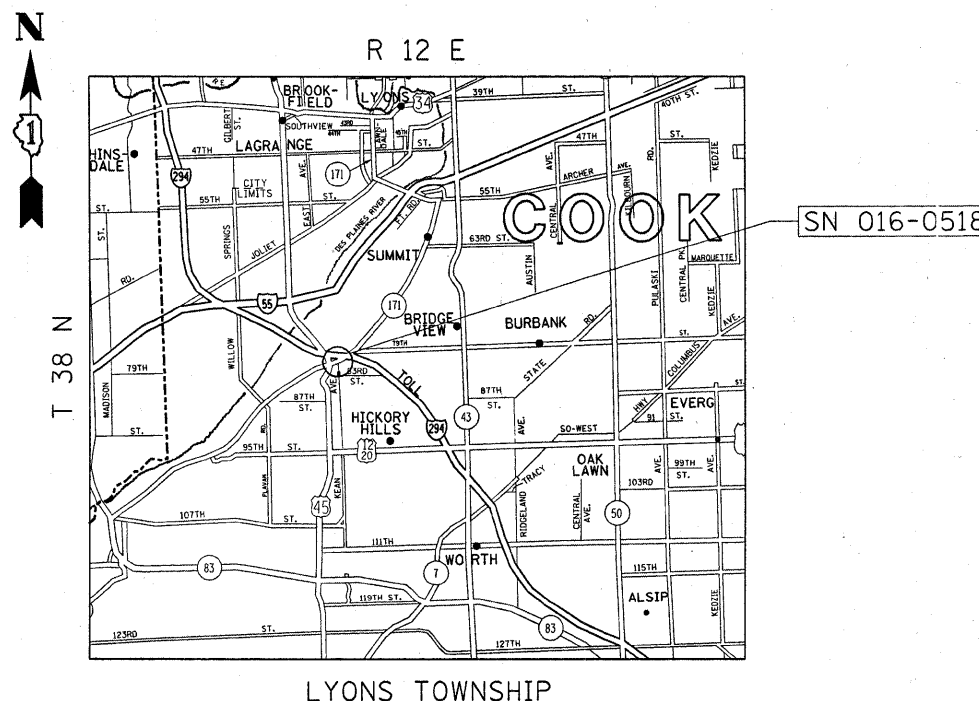

STATE OF ILLINOIS
 DEPARTMENT OF TRANSPORTATION
 DIVISION OF HIGHWAYS

SUBMITTED Dec. 28 2007

Diane O'Keefe
 DEPUTY DIRECTOR OF HIGHWAYS, REGION ENGINEER

February 1, 2008
Eric F. Horn
 ENGINEER OF DESIGN AND ENVIRONMENT

February 1, 2008
Christine M. Reed
 DIRECTOR OF HIGHWAYS, CHIEF ENGINEER

PRINTED BY THE AUTHORITY
 OF THE STATE OF ILLINOIS