

CONTRACT NO. 60254				
F.A. RTE.	SECTION	COUNTY	TOTAL SHEETS	SHEET NO.
392	D-RD-5	LAKE	30	27
STA.	TO STA.			
FED. ROAD DIST. NO.	ILLINOIS	FED. AID PROJECT		

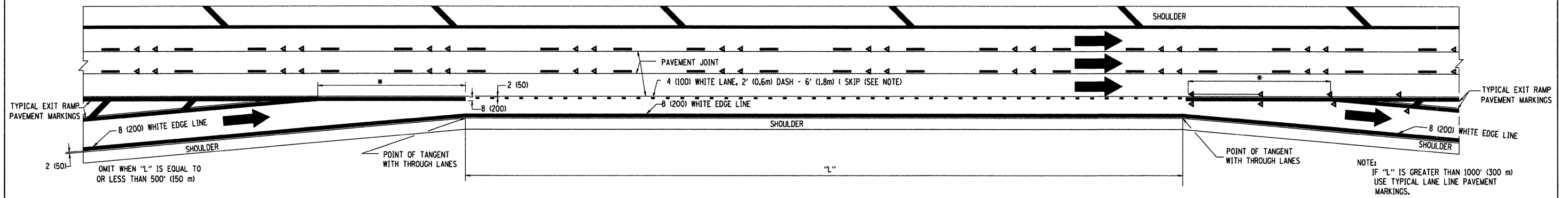

**TYPICAL ENTRANCE/EXIT RAMP COMBINATION PAVEMENT MARKINGS**

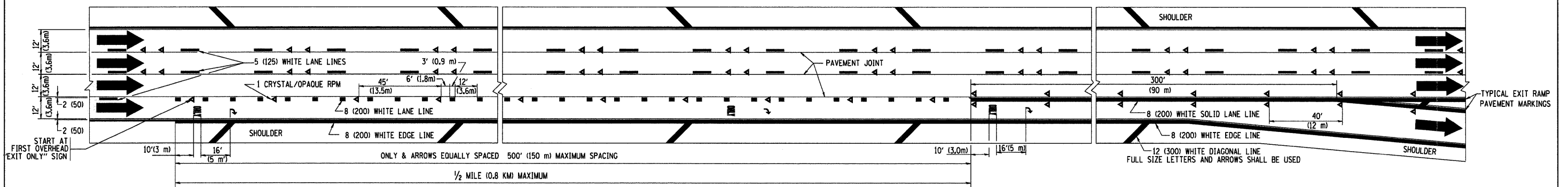

**TYPICAL EXIT ONLY LANE PAVEMENT MARKINGS**

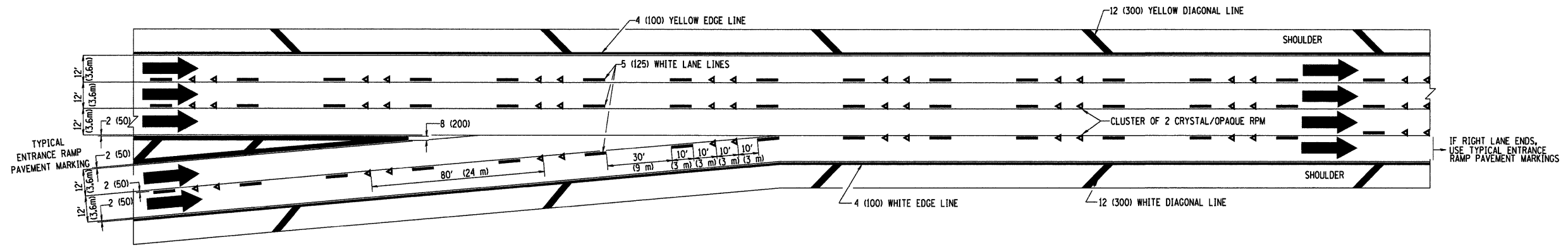

**TYPICAL TWO LANE ENTRANCE RAMP PAVEMENT MARKINGS**

REVISIONS	
NAME	DATE
DWS	1/90
DWS	5/91
SPB	1/07

ILLINOIS DEPARTMENT OF TRANSPORTATION

**MULTI-LANE FREEWAY PAVEMENT MARKING DETAILS**

SCALE: NONE

DRAWN BY C.A.D.D.  
CHECKED BY

PLOT DATE = 3/6/2007  
PLOT SCALE = 1/8" = 1'-0"  
USER NAME = bauer-dl