

F.A.P. RTE.	SECTION	COUNTY	TOTAL SHEETS	SHEET NO.
308	10B, HB-1, VB, HB-2/R	ROCK ISLAND	210	49
STA. 1455+00.00 TO STA. 1485+00.00				
FED. ROAD DIST. NO. 2 ILLINOIS FED. AID PROJECT				

STAGE 1

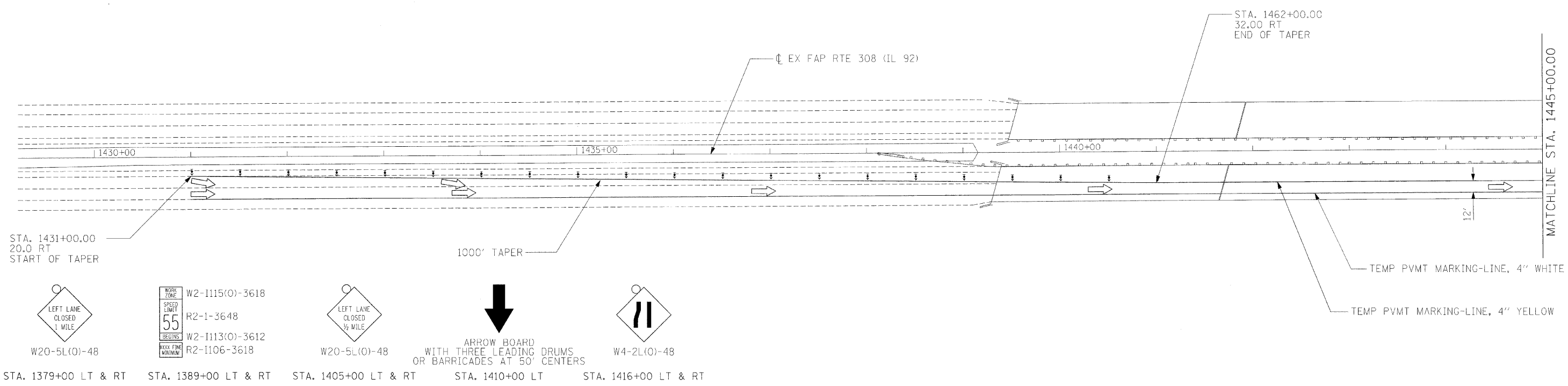

STAGE 1

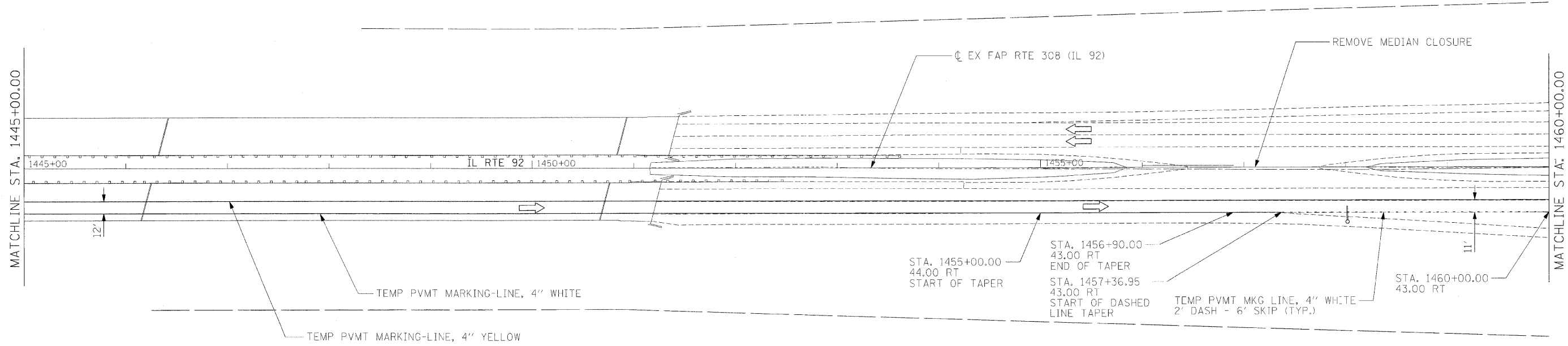

LEGEND

- ➔ DIRECTION OF TRAFFIC
- DRUM WITH STEADY BURN MONODIRECTIONAL LIGHT
- ⚡ DIRECTION INDICATOR BARRICADE WITH STEADY BURN MONODIRECTIONAL LIGHT
- ⚡ TYPE III BARRICADE WITH FLASHING MONODIRECTIONAL LIGHTS
- ▬ TEMPORARY CONCRETE BARRIER

PLOT DATE = 04/25/08
 PLOT TIME = 10:58:00
 PLOT SCALE = AS SHOWN
 USER NAME = RUSSEK