

F.A.P. RTE.	SECTION	COUNTY	TOTAL SHEETS	SHEET NO.
308	10B,1B-1,VB,1B-2R	ROCK ISLAND	210	50
STA. 1455+00.00 TO STA. 1485+00.00				
FED. ROAD DIST. NO. 2		ILLINOIS	FED. AID PROJECT	

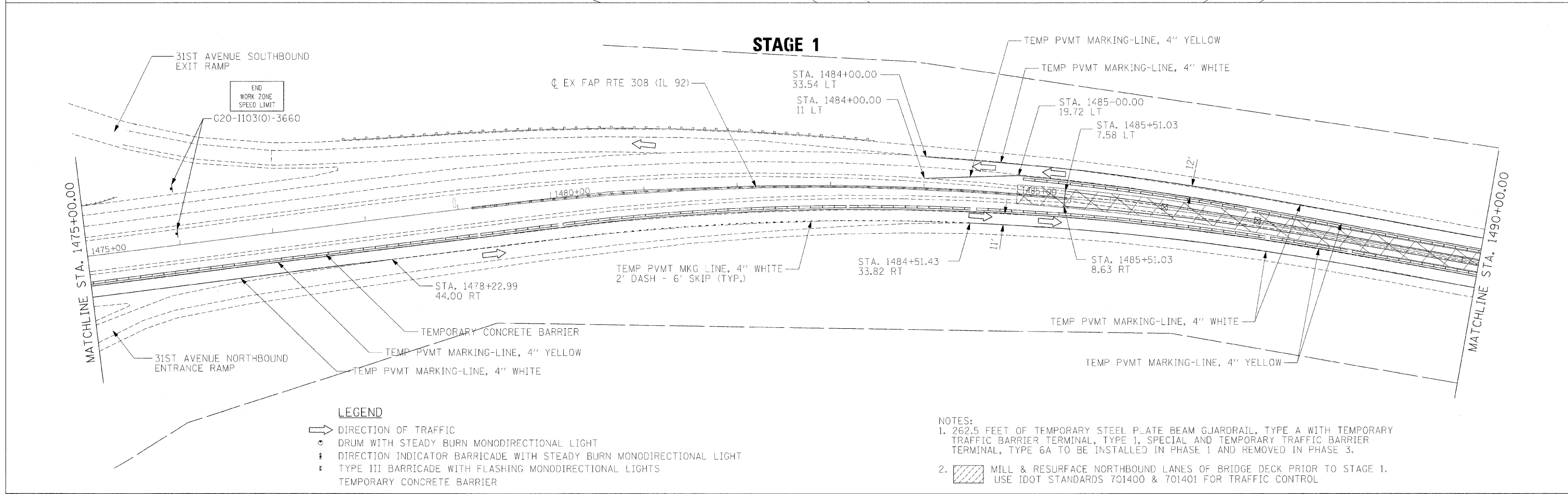
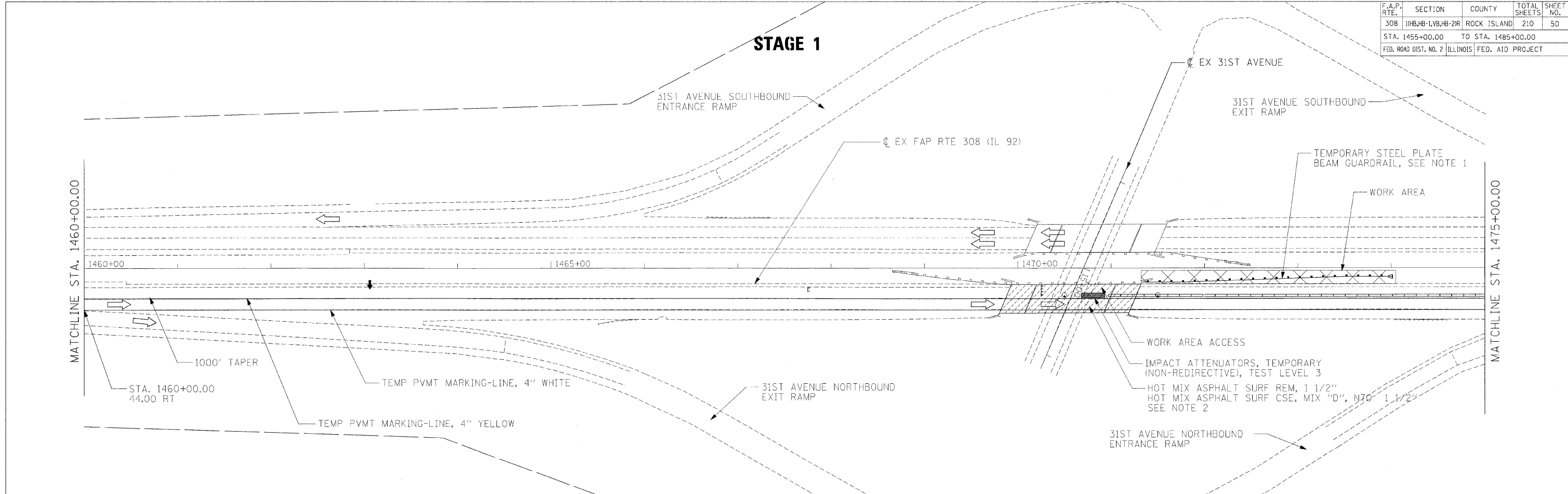

- LEGEND**
- ➔ DIRECTION OF TRAFFIC
  - DRUM WITH STEADY BURN MONODIRECTIONAL LIGHT
  - ⚡ DIRECTION INDICATOR BARRICADE WITH STEADY BURN MONODIRECTIONAL LIGHT
  - ⚡ TYPE III BARRICADE WITH FLASHING MONODIRECTIONAL LIGHTS
  - ▭ TEMPORARY CONCRETE BARRIER

- NOTES:**
1. 262.5 FEET OF TEMPORARY STEEL PLATE BEAM GUARDRAIL, TYPE A WITH TEMPORARY TRAFFIC BARRIER TERMINAL, TYPE 1, SPECIAL AND TEMPORARY TRAFFIC BARRIER TERMINAL, TYPE 6A TO BE INSTALLED IN PHASE 1 AND REMOVED IN PHASE 3.
  2. MILL & RESURFACE NORTHBOUND LANES OF BRIDGE DECK PRIOR TO STAGE 1. USE IDOT STANDARDS 701400 & 701401 FOR TRAFFIC CONTROL

PLOT DATE = #DATE#  
 PLOT FILE = #FILE#  
 PLOT SCALE = #SCALE#  
 PLOT USER = #USER#