

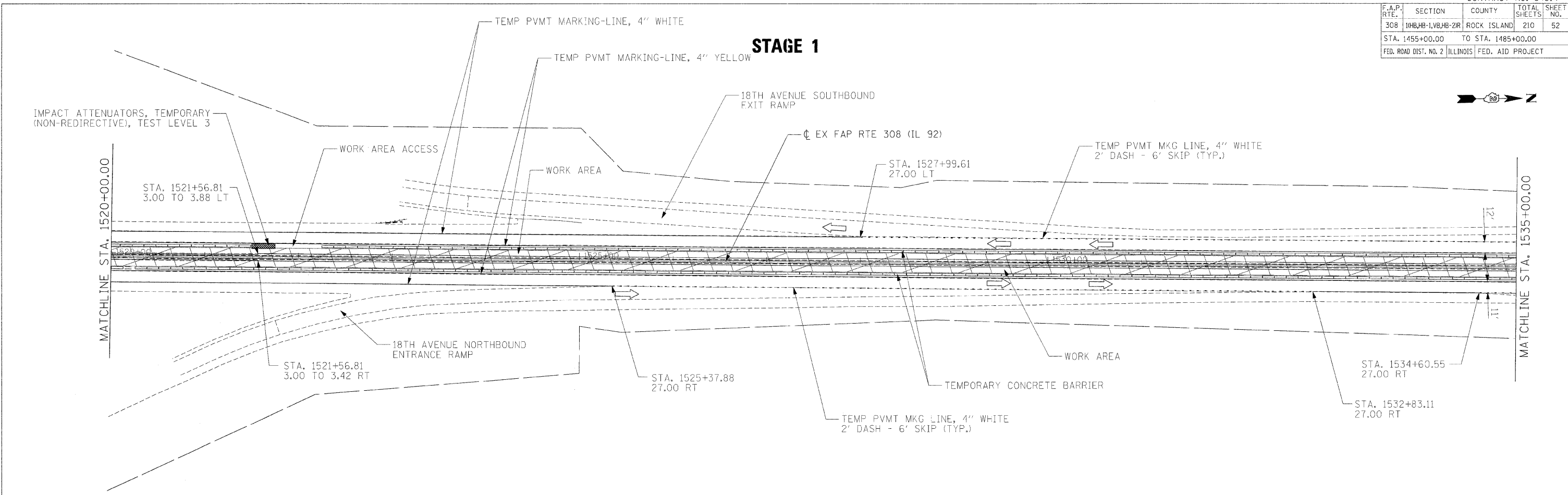

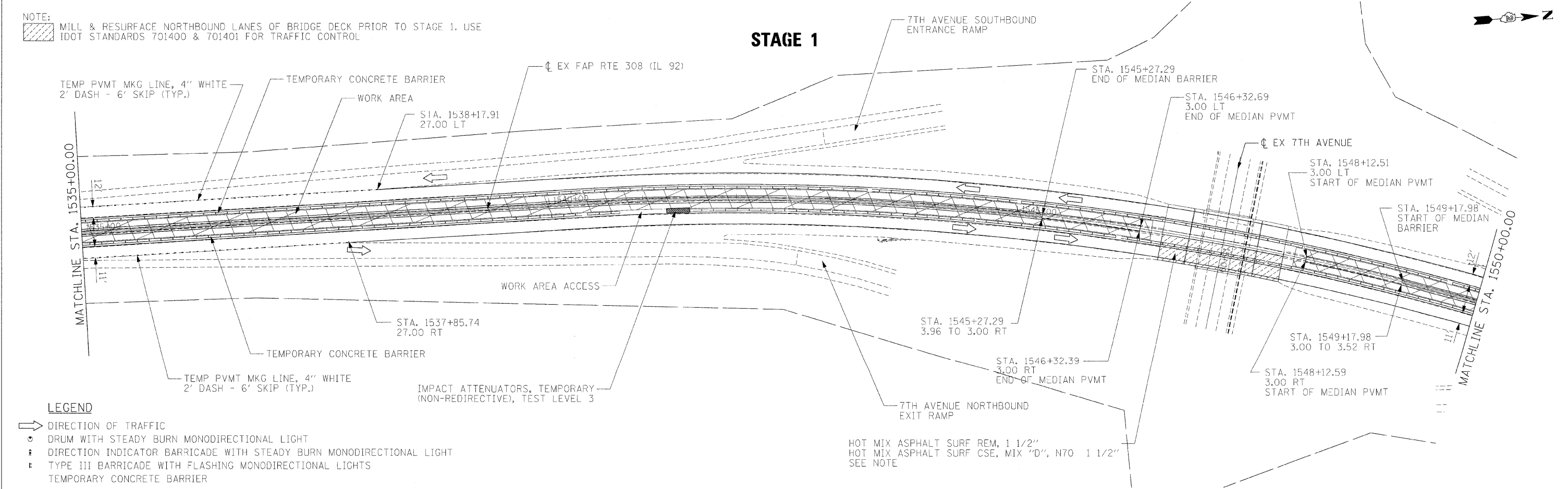

F.A.P. RTE.	SECTION	COUNTY	TOTAL SHEETS	SHEET NO.
308	10HB,10WB,20R	ROCK ISLAND	210	52
STA. 1455+00.00 TO STA. 1485+00.00				
FED. ROAD DIST. NO. 2 ILLINOIS			FED. AID PROJECT	

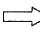

NOTE:
 MILL & RESURFACE NORTHBOUND LANES OF BRIDGE DECK PRIOR TO STAGE 1. USE IDOT STANDARDS 701400 & 701401 FOR TRAFFIC CONTROL

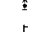

- LEGEND**
-  DIRECTION OF TRAFFIC
 -  DRUM WITH STEADY BURN MONODIRECTIONAL LIGHT
 -  DIRECTION INDICATOR BARRICADE WITH STEADY BURN MONODIRECTIONAL LIGHT
 -  TYPE III BARRICADE WITH FLASHING MONODIRECTIONAL LIGHTS
 -  TEMPORARY CONCRETE BARRIER

HOT MIX ASPHALT SURF REM. 1 1/2"
 HOT MIX ASPHALT SURF CSE, MIX "D", N70 1 1/2"
 SEE NOTE

PLOT DATE = 8/24/15
 FILE NAME = 011115
 USER NAME = AUBURN