

F.A.P. RTE.	SECTION	COUNTY	TOTAL SHEETS	SHEET NO.
308	118LJHB-1,VB,HB-2IR	ROCK ISLAND	210	55
STA. 1460+00 TO STA. 1490+00				
FED. ROAD DIST. NO. 2 ILLINOIS			FED. AID PROJECT	

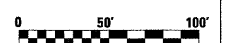
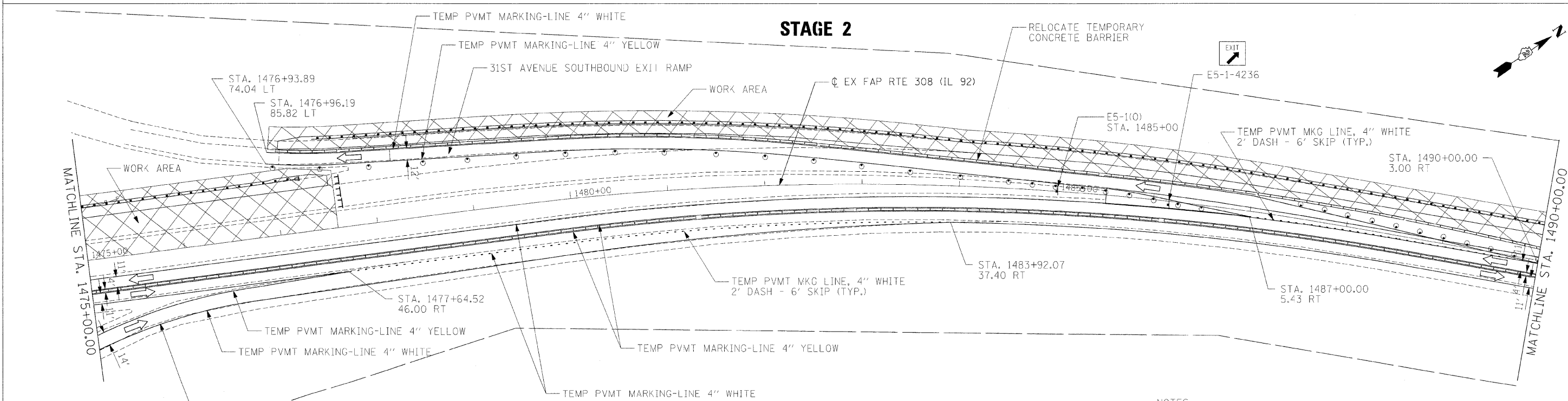
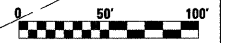
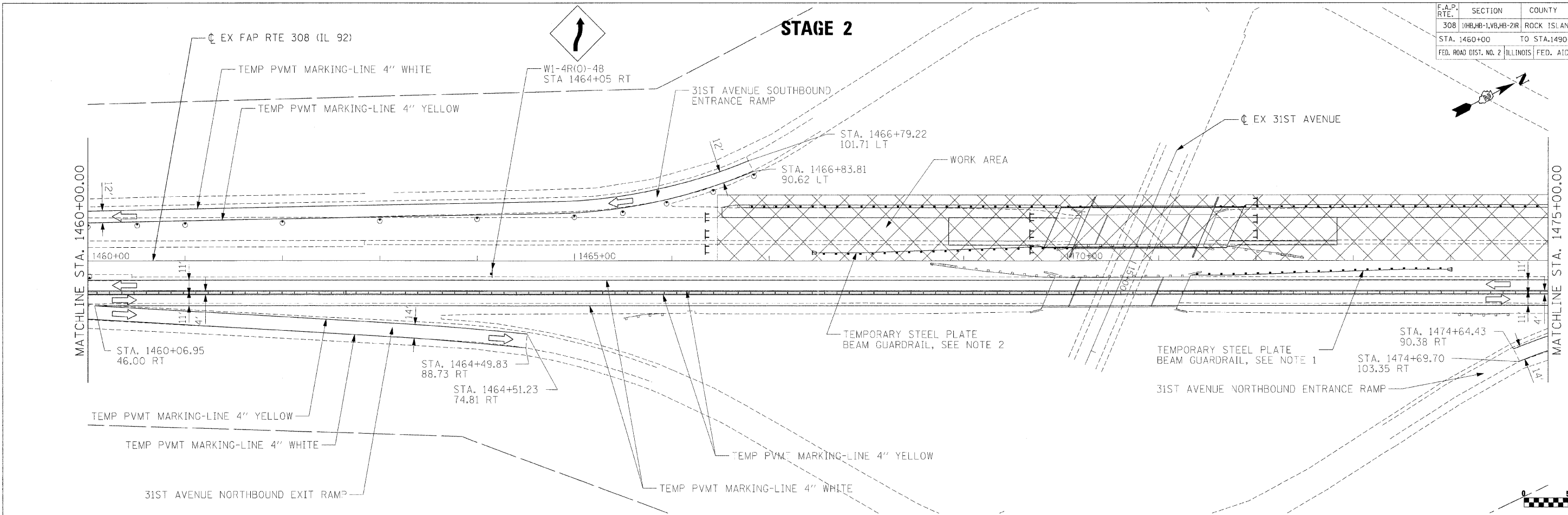

LEGEND

- DIRECTION OF TRAFFIC
- DRUM WITH STEADY BURN MONODIRECTIONAL LIGHT
- DIRECTION INDICATOR BARRICADE WITH STEADY BURN MONODIRECTIONAL LIGHT
- TYPE III BARRICADE WITH FLASHING MONODIRECTIONAL LIGHTS
- TEMPORARY CONCRETE BARRIER

- NOTES:**
- 262.5 FEET OF TEMPORARY STEEL PLATE BEAM GUARDRAIL, TYPE A WITH TEMPORARY TRAFFIC BARRIER TERMINAL, TYPE 1, SPECIAL AND TEMPORARY TRAFFIC BARRIER TERMINAL, TYPE 6A TO BE INSTALLED IN PHASE 1 AND REMOVED IN PHASE 3.
 - 262.5 FEET OF TEMPORARY STEEL PLATE BEAM GUARDRAIL, TYPE A WITH TEMPORARY TRAFFIC BARRIER TERMINAL, TYPE 1, SPECIAL AND TEMPORARY TRAFFIC BARRIER TERMINAL, TYPE 6 TO BE INSTALLED IN PHASE 2 AND REMOVED IN PHASE 4.

PLOT DATE = 8/24/15
 FILE NAME = 8/15/15
 PLOT SCALE = 1/8"=1'-0"
 USER NAME = RUSSELL