

F.A. RTE.	SECTION	COUNTY	TOTAL SHEETS	SHEET NO.
308	10B,11B-1,12B,13B-2,14B	ROCK ISLAND	210	58
STA. 1550+00		TO STA. 1580+00		
FED. ROAD DIST. NO. 2		ILLINOIS	FED. AID PROJECT	

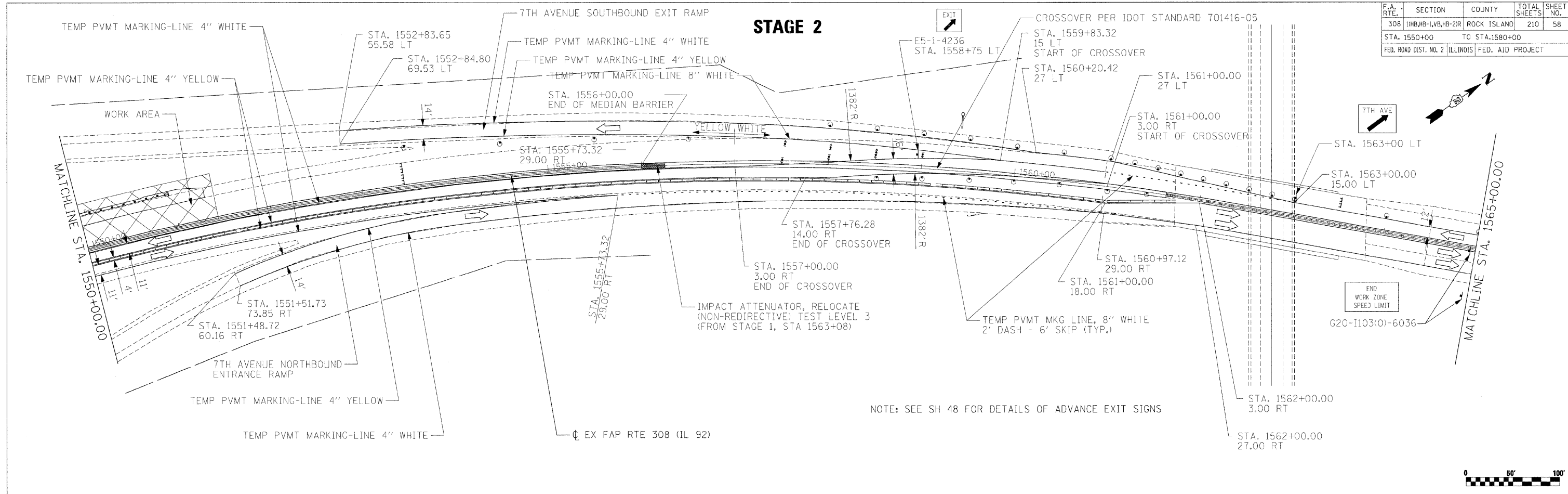

NOTE: SEE SH 48 FOR DETAILS OF ADVANCE EXIT SIGNS

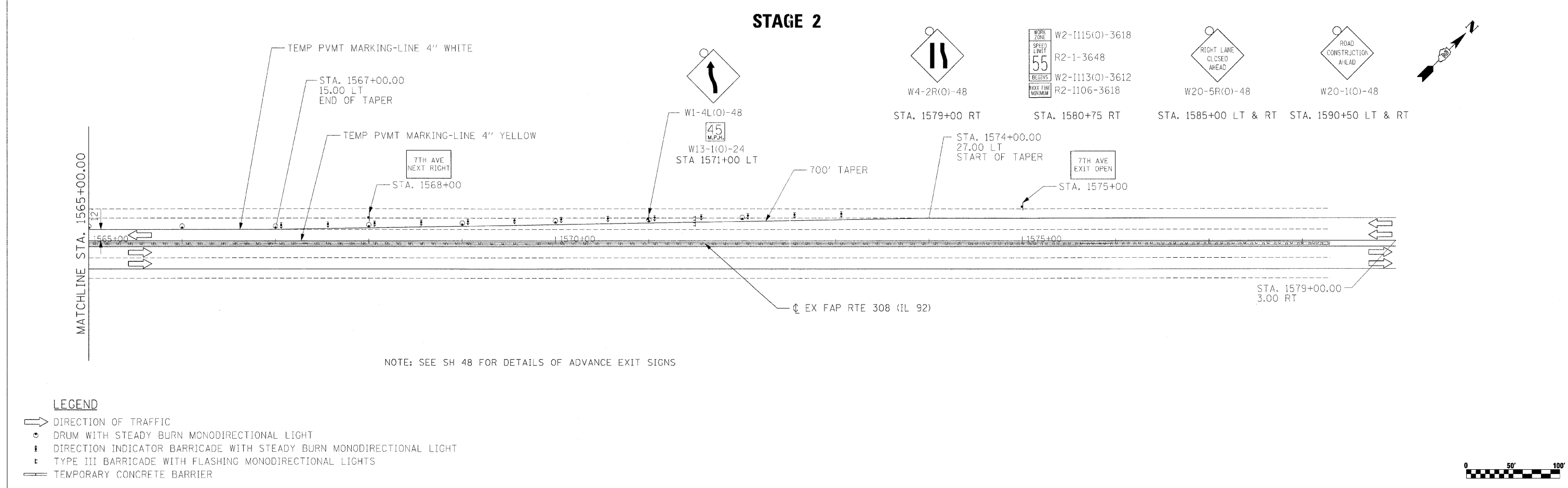
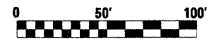

NOTE: SEE SH 48 FOR DETAILS OF ADVANCE EXIT SIGNS

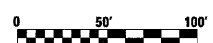

LEGEND

- DIRECTION OF TRAFFIC
- DRUM WITH STEADY BURN MONODIRECTIONAL LIGHT
- DIRECTION INDICATOR BARRICADE WITH STEADY BURN MONODIRECTIONAL LIGHT
- TYPE III BARRICADE WITH FLASHING MONODIRECTIONAL LIGHTS
- TEMPORARY CONCRETE BARRIER

PLOT DATE = 08/15/15
 FILE NAME = ST1550-1580-00
 PLOT SCALE = 1/8\"/>