

F.A. RTE.	SECTION	COUNTY	TOTAL SHEETS	SHEET NO.
308		ROCK ISLAND	210	208
STA.		TO STA.		
FED. ROAD DIST. NO.		ILLINOIS FED. AID PROJECT		

**NOTES:**

1. DISCONNECT AND ABANDON EXISTING CIRCUITRY TO UNDERPASS JUNCTION BOX.
2. TEMPORARY WOOD POLES AND AERIAL CABLE SHALL BE REMOVED AFTER PROPOSED CIRCUIT IS OPERATIONAL. REMOVAL OF WOOD POLES AND AERIAL CABLE SHALL BE PAID FOR UNDER "REMOVAL OF TEMPORARY LIGHTING UNITS."

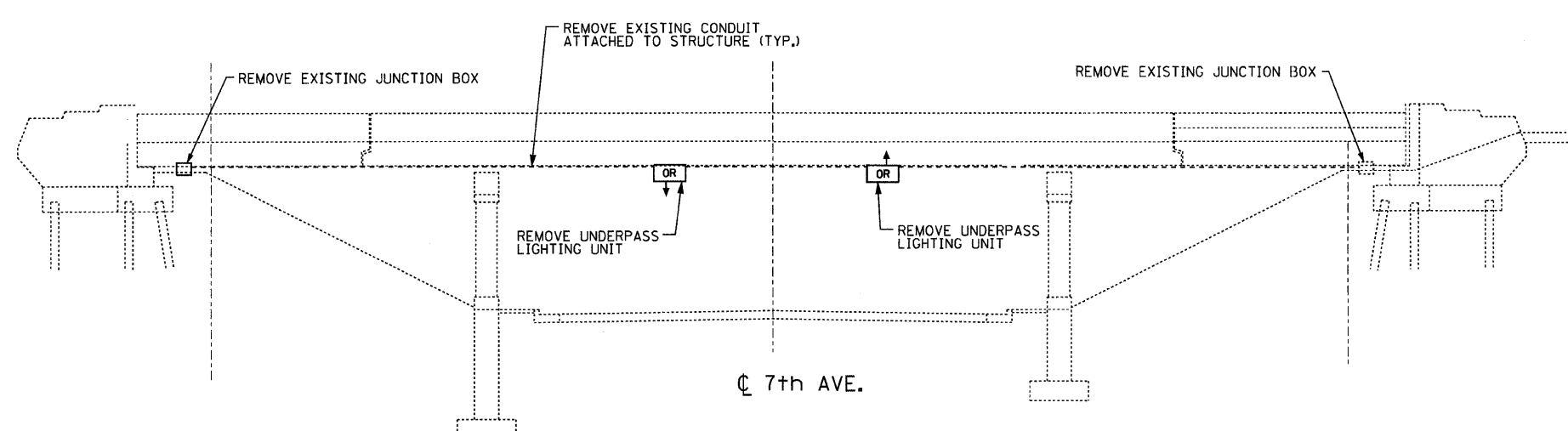
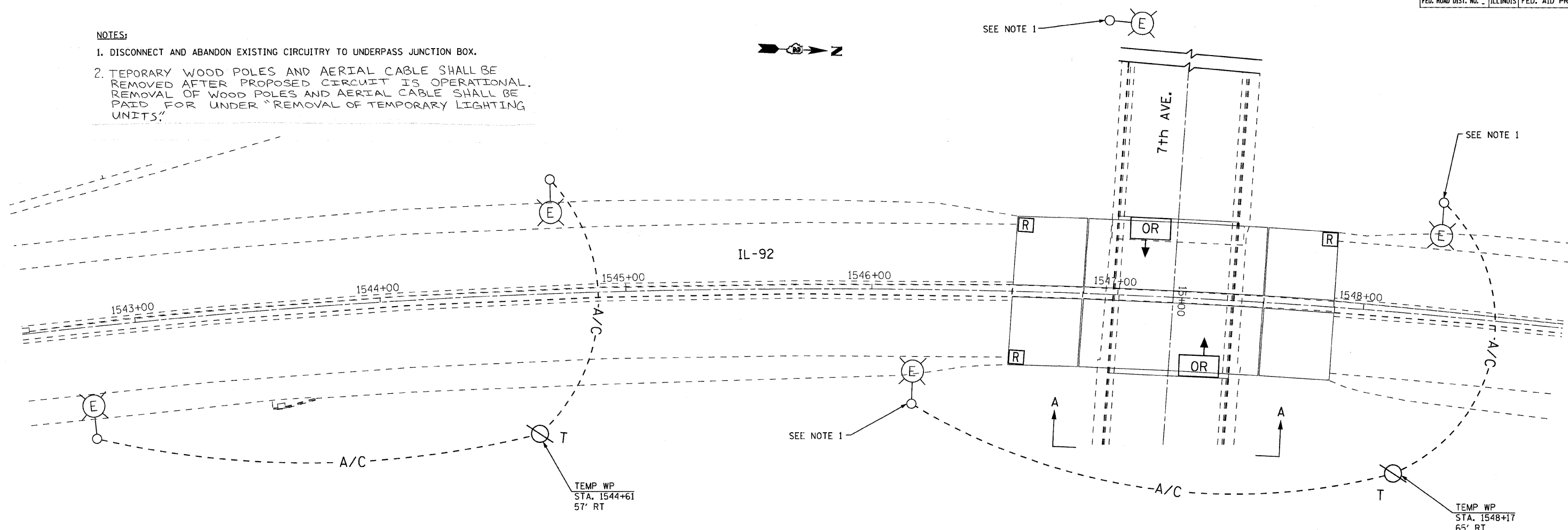

**SECTION A-A**  
LOOKING WEST  
NOT TO SCALE

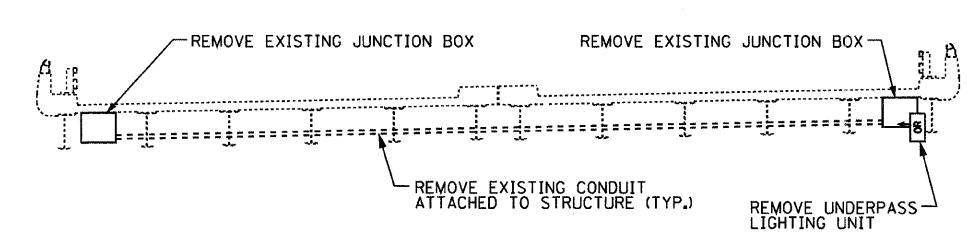

**SECTION THROUGH BRIDGE**  
LOOKING SOUTH  
NOT TO SCALE



REVISIONS	
NAME	DATE

ILLINOIS DEPARTMENT OF TRANSPORTATION  
ILLINOIS ROUTE 92  
TEMPORARY AND REMOVAL PLAN  
7TH AVE.  
SCALE: 1"=20'  
DATE: 11/26/07  
DRAWN BY: JDM  
CHECKED BY: JH

PLOT DATE: \* \* \* \* \*  
FILE NAME: \* \* \* \* \*  
USER NAME: \* \* \* \* \*