

STATE OF ILLINOIS  
DEPARTMENT OF TRANSPORTATION

SHEET #4 OF  
11 SHEETS

ROUTE NO.	SECTION	COUNTY	JOB NO.	SHEET
FAS 203	11BR-1	WHITESIDE & ROCK ISLAND	15	43
FED. ROAD DIST. NO. 3	ILLINOIS	FED. AID PROJECT-		

CONTRACT #64939

\* Order a(E) bars full length  
Cut to fit skew and use  
remainder in opposite end  
(See Bar Cutting Diagram)

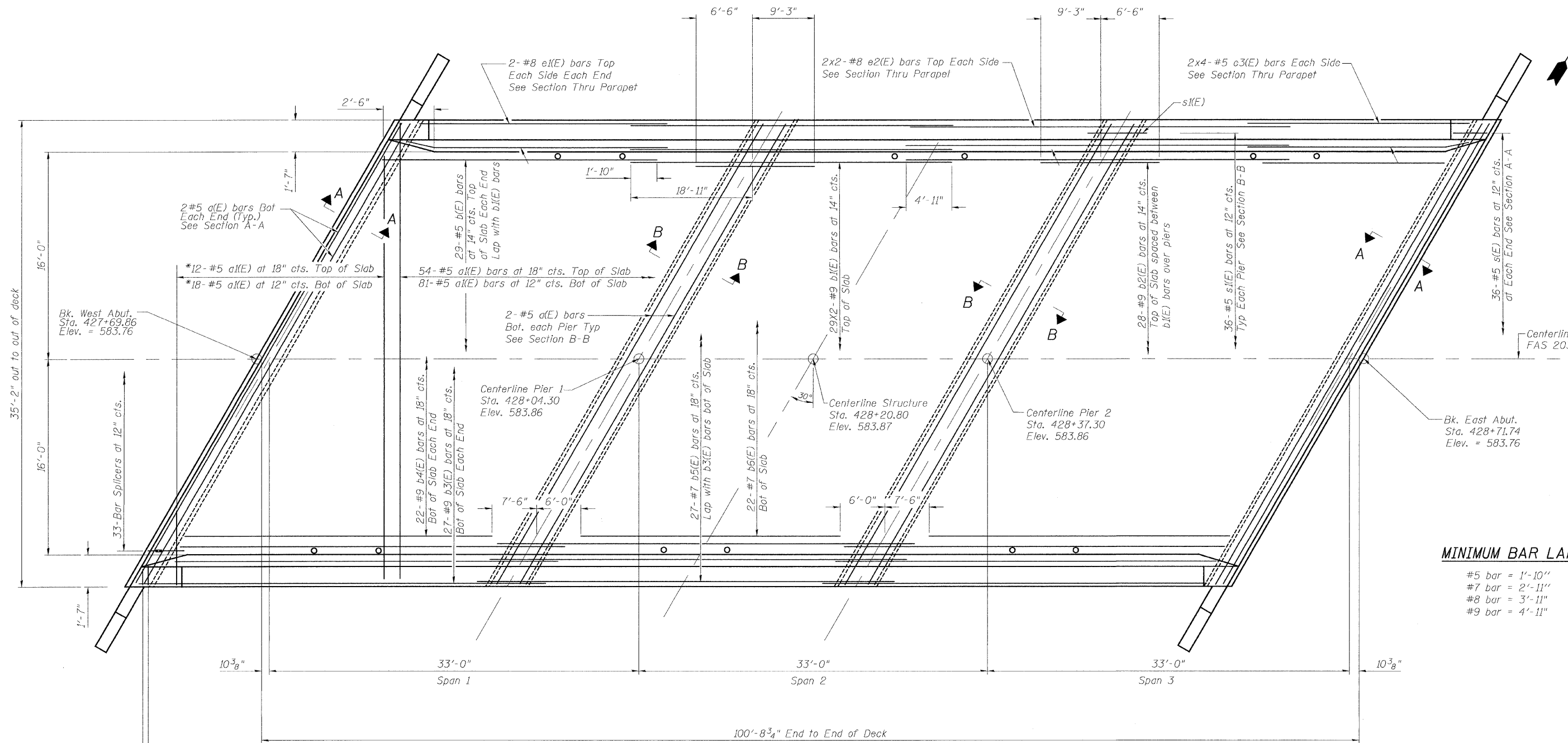

**MINIMUM BAR LAP**

#5 bar	= 1'-10"
#7 bar	= 2'-11"
#8 bar	= 3'-11"
#9 bar	= 4'-11"

**PLAN**

**NOTES**

1. See sheets No. 5 and 6 of 11 for Superstructure Details, parapet reinforcing, and Bill of Materials.
2. Reinforcing bars designated (E) shall be epoxy coated.
3. Bars indicated thus 6x3-#5 etc. indicates 6 lines of bars with 3 lengths per line.
4. See sheet No.1 of 11 for floor drain spacing.
5. Space reinforcement bars to clear floor drain.

**SUPERSTRUCTURE PLAN**  
FAS ROUTE 203 (MOLINE ROAD)  
OVER MEREDOSIA DITCH  
SECTION 11BR-1  
STA. 428+20.80  
WHITESIDE & ROCK ISLAND COUNTIES  
SN 098-0111

DESIGNED	KCM
CHECKED	TMM
DRAWN	JLM
CHECKED	TMM