

| ROUTE NO.             | SEC.     | COUNTY  | TOTAL SHEETS | SHEET NO. |
|-----------------------|----------|---------|--------------|-----------|
| FAS 1247              | *        | HENRY   | 80           | 45        |
| FED. ROAD DIST. NO. 7 | ILLINOIS | PROJECT |              |           |
| * (6BR)D              |          |         |              |           |

SHEET NO. 15  
of 16 SHEETS

CONTRACT NO. 64D10

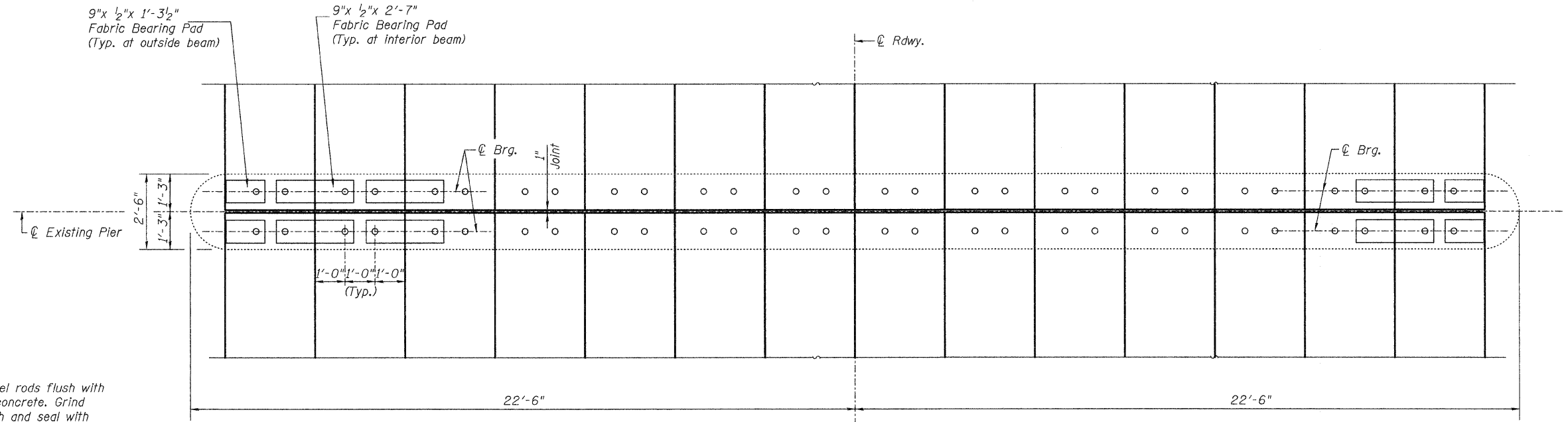

PLAN - PIER 2

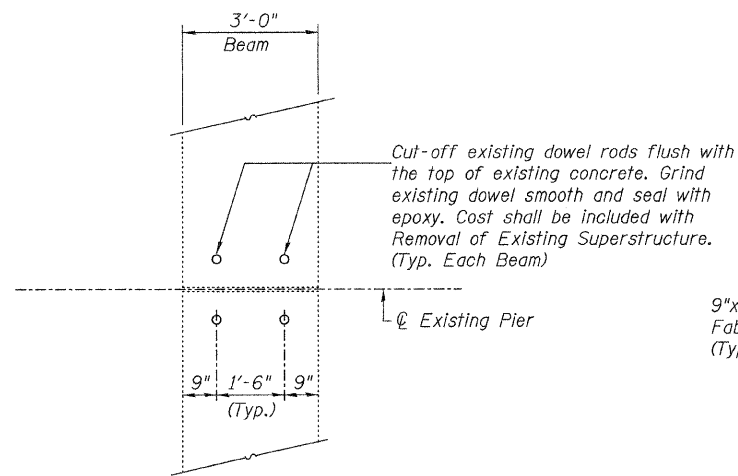

PLAN - EXISTING BEAMS  
AT PIERS

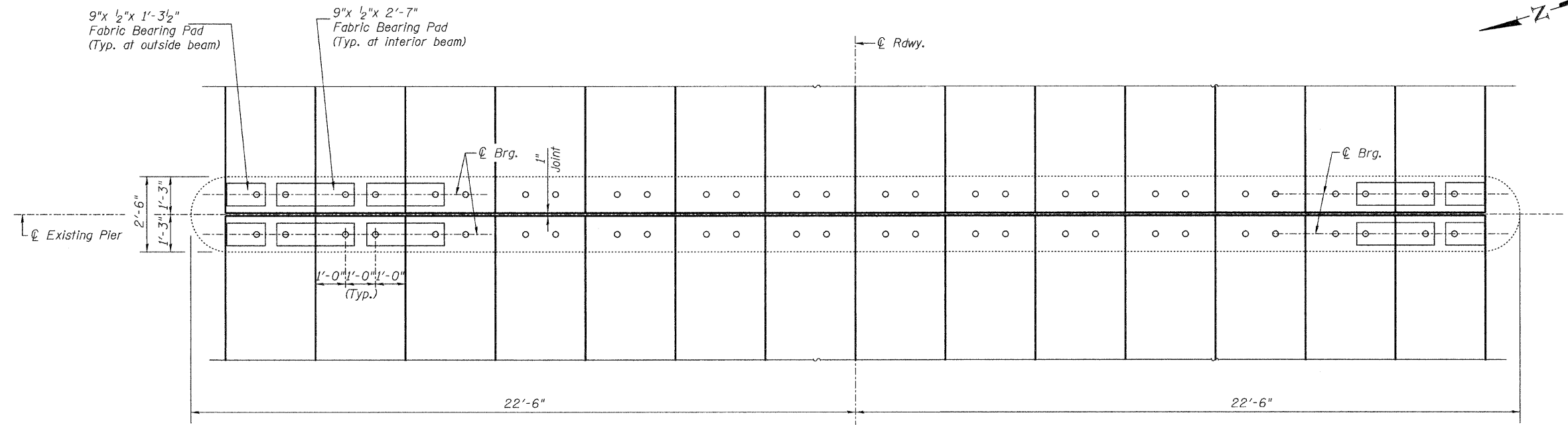

PLAN - PIER 1

|          |       |
|----------|-------|
| DESIGNED | BAN   |
| CHECKED  | JEH   |
| DRAWN    | TC/TD |
| CHECKED  | BAN   |

PIER DETAILS  
F.A.S. 1247 (U.S. ROUTE 6)  
OVER MUD CREEK  
SECTION (6BR)D  
HENRY COUNTY  
STATION 666+69.05  
STR. NO. 037-0131

HUTCHISON ENGINEERING, INC.  
JACKSONVILLE, ILLINOIS  
Rev: \_\_\_\_\_ Date: \_\_\_\_\_