

| F.A.P. RTE. | SECTION | COUNTY    | TOTAL SHEETS | SHEET NO. |
|-------------|---------|-----------|--------------|-----------|
| *303        | 129M&TS | WINNEBAGO | 110          | 39        |

|                     |                           |
|---------------------|---------------------------|
| STA.                | TO STA.                   |
| FED. ROAD DIST. NO. | ILLINOIS FED. AID PROJECT |

\*(IL 173)

# DETAIL A

| LETTERS | STATION   | OFFSET LT | ELEVATIONS |
|---------|-----------|-----------|------------|
| A       | 248+04.46 | 87.27'    | 905.79     |
| B       | 248+05.59 | 77.35'    | 905.72     |
| C       | 248+04.73 | 67.40'    | 905.66     |
| D       | 248+01.91 | 57.83'    | 905.59     |
| E       | 247+97.25 | 49.00'    | 905.52     |
| F       | 247+90.92 | 41.28'    | 905.45     |
| G       | 247+83.19 | 34.96'    | 905.39     |
| H       | 247+74.36 | 30.31'    | 905.32     |
| I       | 247+70.97 | 29.08'    | 905.29     |
| J       | 247+64.86 | 27.18'    | 905.25     |
| K       | 247+55.24 | 24.47'    | 905.18     |
| L       | 247+45.53 | 22.08'    | 905.12     |
| M       | 247+35.74 | 20.02'    | 905.05     |
| N       | 247+25.89 | 18.29'    | 904.98     |
| O       | 247+15.99 | 16.88'    | 904.91     |
| P       | 247+06.05 | 15.80'    | 904.84     |
| Q       | 246+98.08 | 15.06'    | 904.78     |
| R       | 246+86.09 | 14.65'    | 904.71     |
| S       | 246+79.16 | 14.56'    | 904.66     |

| LETTERS | STATION   | OFFSET LT | ELEVATIONS |
|---------|-----------|-----------|------------|
| T       | 248+18.02 | 149.00'   | 905.58     |
| U       | 248+21.39 | 139.59'   | 905.60     |
| V       | 248+24.77 | 130.17'   | 905.61     |
| W       | 248+28.14 | 120.76'   | 905.60     |
| X       | 248+31.52 | 111.35'   | 905.59     |
| Y       | 248+34.89 | 101.93'   | 905.57     |
| Z       | 248+38.26 | 92.52'    | 905.56     |
| AA      | 248+41.64 | 83.11'    | 905.55     |
| BB      | 248+45.01 | 73.69'    | 905.56     |
| CC      | 248+47.85 | 65.77'    | 905.59     |
| DD      | 248+48.40 | 64.29'    | 905.60     |
| EE      | 248+52.92 | 54.75'    | 905.66     |
| FF      | 248+58.47 | 46.44'    | 905.75     |
| GG      | 248+65.96 | 38.24'    | 905.86     |
| HH      | 248+73.73 | 31.96'    | 905.99     |
| II      | 248+82.32 | 26.84'    | 906.12     |
| JJ      | 248+91.54 | 23.00'    | 906.25     |
| KK      | 249+01.22 | 20.52'    | 906.38     |
| LL      | 249+11.15 | 19.44'    | 906.49     |
| MM      | 249+13.74 | 19.39'    | 906.52     |
| NN      | 249+23.74 | 19.39'    | 906.62     |
| OO      | 249+33.74 | 19.39'    | 906.72     |

| LETTERS | STATION   | OFFSET LT | ELEVATIONS |
|---------|-----------|-----------|------------|
| PP      | 249+43.87 | 19.39'    | 906.82     |
| QQ      | 249+53.87 | 19.39'    | 906.92     |
| RR      | 249+63.87 | 19.39'    | 907.02     |
| SS      | 249+66.18 | 19.39'    | 907.04     |
| TT      | 249+76.18 | 19.10'    | 907.14     |
| UU      | 249+85.16 | 18.85'    | 907.24     |
| VV      | 249+95.15 | 18.56'    | 907.34     |
| WW      | 250+05.15 | 18.27'    | 907.45     |
| XX      | 250+15.29 | 17.98'    | 907.55     |
| YY      | 250+24.50 | 17.72'    | 907.65     |
| ZZ      | 250+34.50 | 17.43'    | 907.76     |
| AB      | 250+44.50 | 17.15'    | 907.86     |
| CD      | 250+54.49 | 16.86'    | 907.97     |
| EF      | 250+64.49 | 16.58'    | 908.07     |
| GH      | 250+73.56 | 16.32'    | 908.18     |
| IJ      | 250+83.05 | 16.05'    | 908.28     |
| KL      | 250+93.04 | 15.76'    | 908.39     |
| MN      | 251+03.04 | 15.47'    | 908.49     |
| OP      | 251+13.03 | 15.19'    | 908.60     |
| OR      | 251+23.03 | 14.90'    | 908.70     |
| ST      | 251+33.03 | 14.62'    | 908.80     |
| UV      | 251+39.56 | 14.43'    | 908.87     |

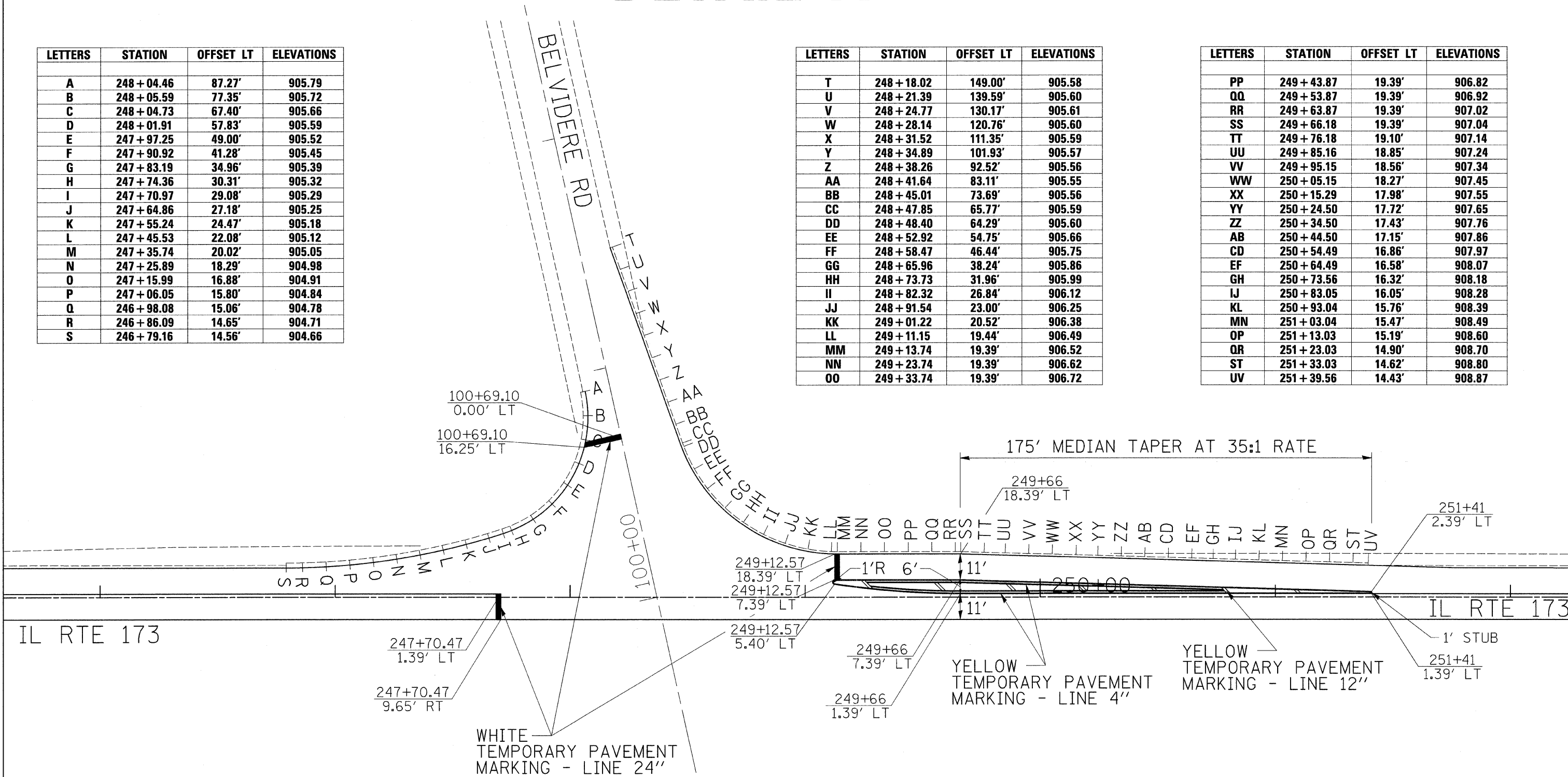

PLOT DATE = Mon, Dec 03 13:24:43 2007  
 FILE NAME = c:\p\projects\p207107\c087107.spl.dgn  
 PLOT SCALE = 20.000 / IN.  
 USER NAME = polzrnej

| REVISIONS |      | ILLINOIS DEPARTMENT OF TRANSPORTATION                         |
|-----------|------|---------------------------------------------------------------|
| NAME      | DATE |                                                               |
|           |      | FAP ROUTE 303 (IL 173)<br>SECTION 129M&TS<br>WINNEBAGO COUNTY |
|           |      |                                                               |
|           |      |                                                               |
|           |      |                                                               |
|           |      |                                                               |
|           |      |                                                               |

SCALE: VERT. \_\_\_\_\_  
 HORIZ. \_\_\_\_\_  
 DATE \_\_\_\_\_ DRAWN BY \_\_\_\_\_  
 CHECKED BY \_\_\_\_\_

## STAGING DETAIL A