

# PAVEMENT MARKINGS

CONTRACT NO. 64051	
F.A.P. RTE.	SECTION
•303	129M&TS
COUNTY	TOTAL SHEETS
WINNEBAGO	110
NO.	48
STA. 235+00 TO STA.261+00	
FED. ROAD DIST. NO. ILLINOIS FED. AID PROJECT	
*(IL 173)	

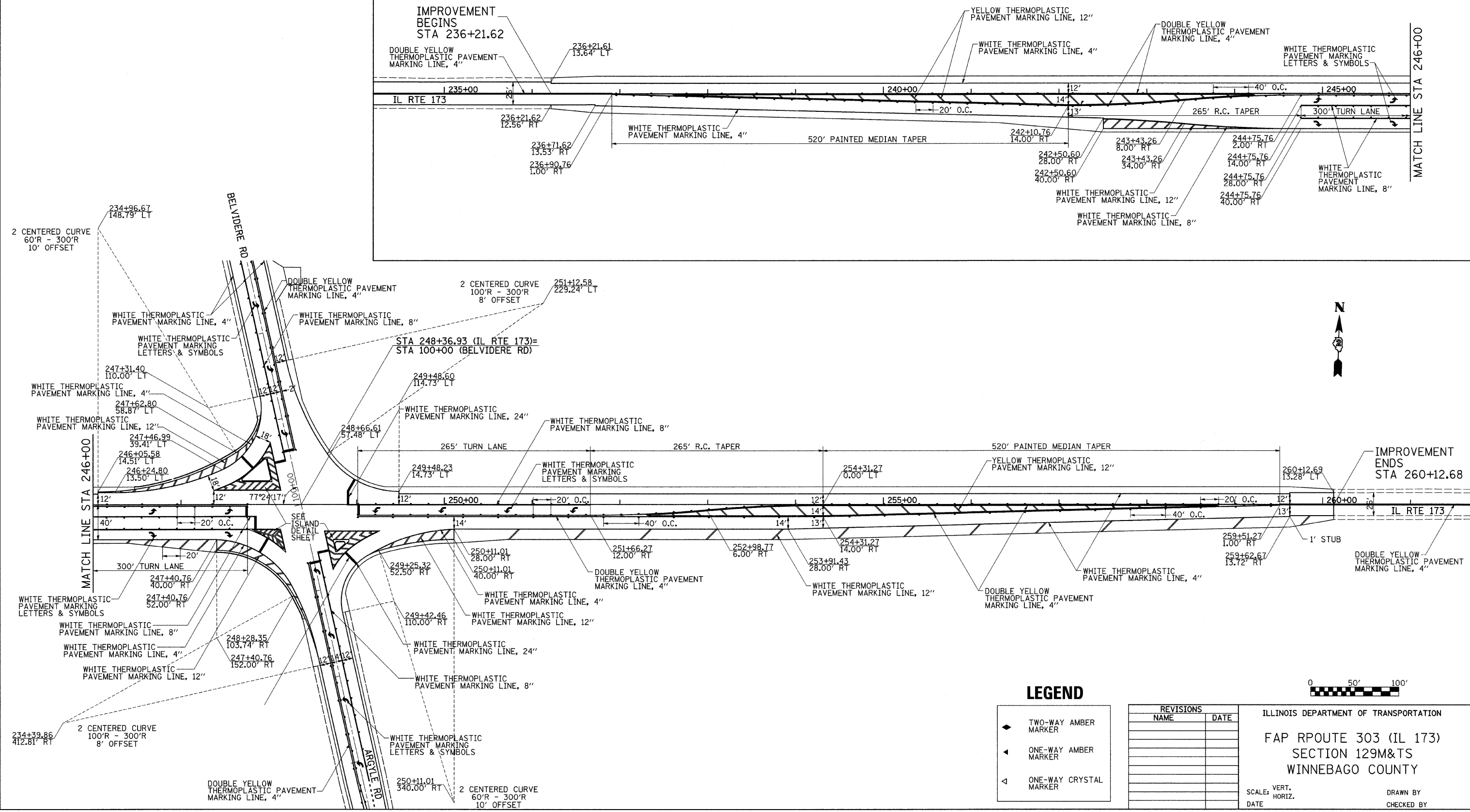

### LEGEND

- ◀ TWO-WAY AMBER MARKER
- ◄ ONE-WAY AMBER MARKER
- ◁ ONE-WAY CRYSTAL MARKER

REVISIONS	
NAME	DATE

ILLINOIS DEPARTMENT OF TRANSPORTATION  
 FAP RROUTE 303 (IL 173)  
 SECTION 129M&TS  
 WINNEBAGO COUNTY

SCALE: VERT. \_\_\_\_\_  
 HORIZ. \_\_\_\_\_

DRAWN BY \_\_\_\_\_  
 CHECKED BY \_\_\_\_\_

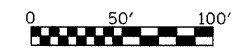

PLOT DATE = Mon Dec 03 13:33:12 2007  
 FILE NAME = c:\projects\p261787\4871787.dwg  
 PLOT SCALE = 1/8" = 1'-0"  
 USER NAME = polzmaej