

F.A.P. RTE.	SECTION	COUNTY	TOTAL SHEETS	SHEET NO.
326		LIVINGSTON	354	71
STA.		TO STA.		
FED. ROAD DIST. NO.		ILLINOIS FED. AID PROJECT		
1023.123XORS-3.024RS-5.1231BR-3				

FINAL SURVEY	BY	DATE
DESIGNED		
PLOTTED		
NOTE BOOK		
AREAS CHECKED		
NO.		

ORIGINAL SURVEY	BY	DATE
DESIGNED		
PLOTTED		
NOTE BOOK		
AREAS CHECKED		
NO.		

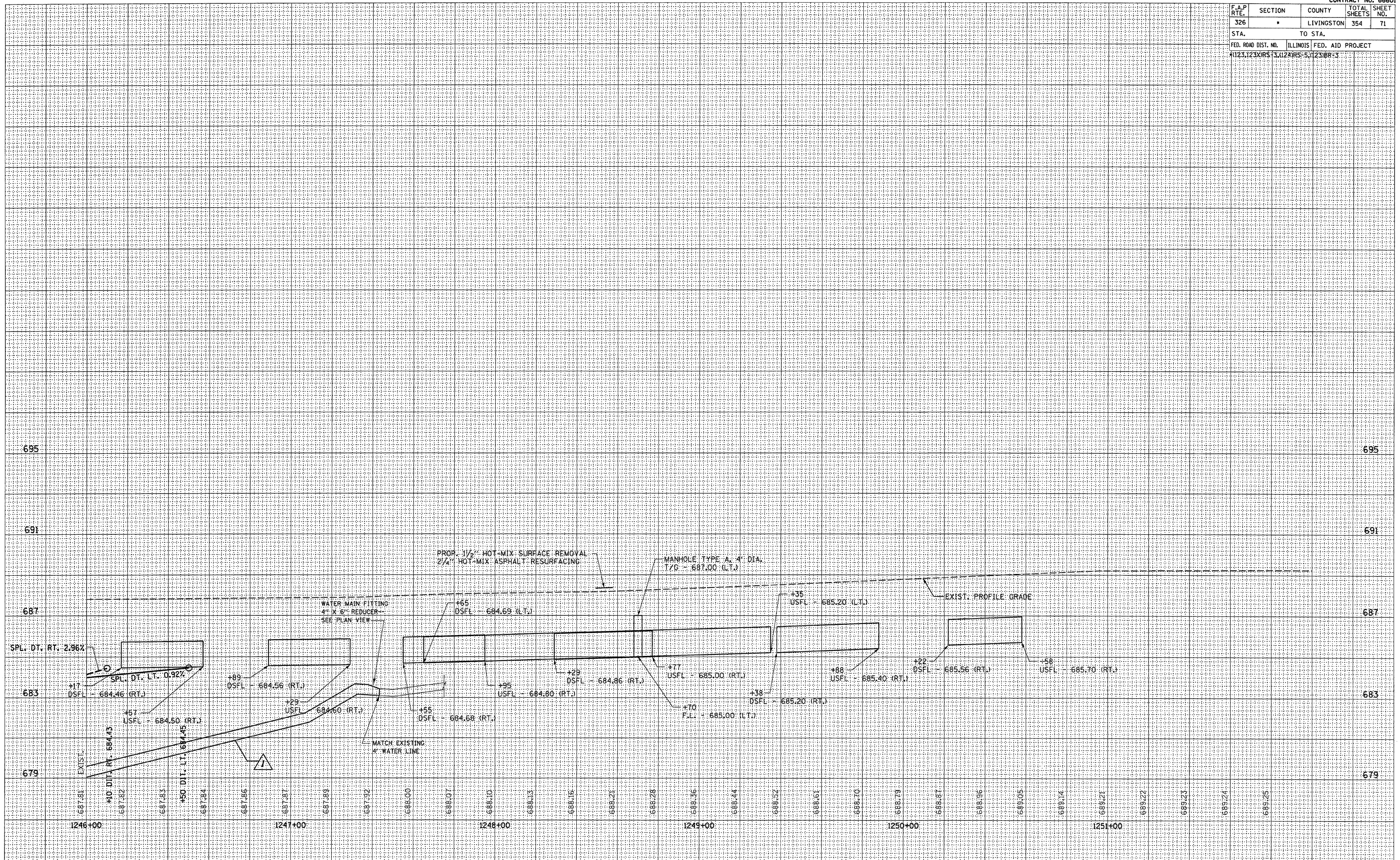

**△ REVISED TO INCLUDE PROPOSED WATER MAIN 2-14-08 MJ** IL 47 STA. 1246+00 TO STA. 1252+00