

F.A.P. RTE.	SECTION	COUNTY	TOTAL SHEETS	SHEET NO.
326		LIVINGSTON	354	44
STA. 905+00		TO STA. 920+00		
FED. ROAD DIST. NO.		ILLINOIS	FED. AID PROJECT	
*(123,123)RS-3,(124)RS-5,(123)BR-3				

LEGEND

- X - TREE REMOVAL
- ▨ - PAVEMENT REMOVAL & CLASS D PATCH
- - - - SPECIAL DITCH
- - - - STANDARD DITCH
- ▩ - RIPRAP
- ◇ - TEMP. DITCH CHECK

SEE FAP 326 (IL RTE. 47) & 1500 N & 1400 N INTERSECTION DETAIL SHEET AND SIDEROAD DETAIL SHEET FOR ADDITIONAL INFORMATION

EVELYN FOX SHAUFLER

BLUESTEM NATIONAL BANK, TRUSTEE, ET AL

SEC. 34, T28N, R7E, 3RD P.M.

SEC. 3, T27N, R7E, 3RD P.M.

SEC. 33, T28N, R7E, 3RD P.M.

MARY A. HALEY, TRUSTEE

SEC. 4, T27N, R7E, 3RD P.M.

BM#64 NAIL IN POWER POLE
40.1' LT. STA. 909+27.5 ELEV. 676.92

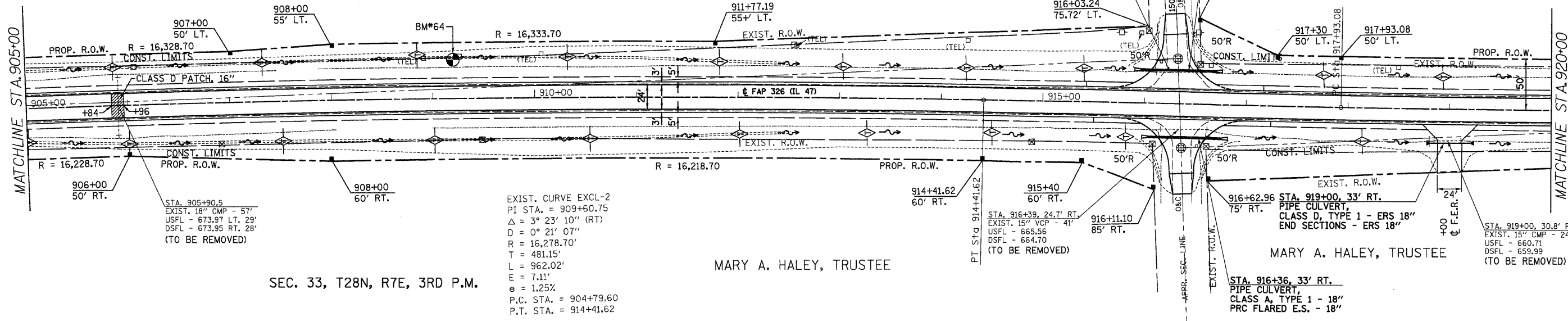
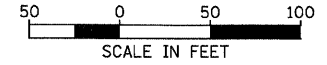

PLAN

DATE	
BY	
REVIEWED	
PLOTTED	
NOTED	
NO. CHECKED	
CADD FILE NAME	

PROFILE

DATE	
BY	
REVIEWED	
PLOTTED	
NOTED	
NO. CHECKED	
STRUCTURE NOTATIONS CRKO	

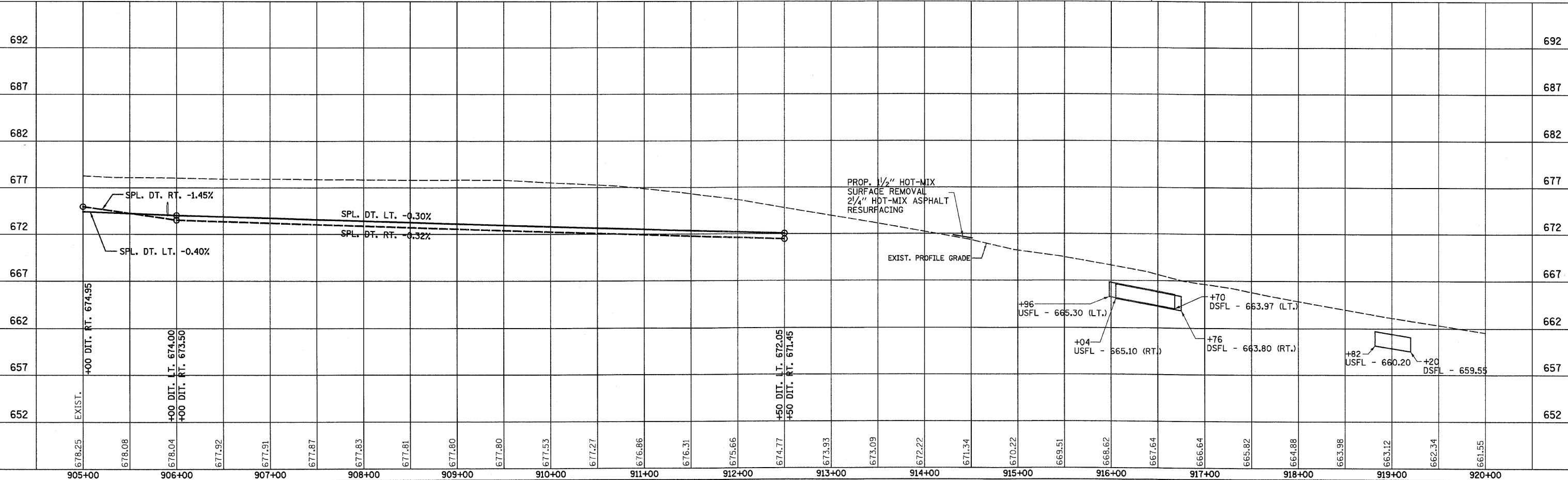

IL 47 STA. 905+00 TO STA. 920+00