

F.A.P. RTE.	SECTION	COUNTY	TOTAL SHEETS	SHEET NO.
326	.	LIVINGSTON	354	45
STA. 920+00		TO STA. 935+00		
FED. ROAD DIST. NO.		ILLINOIS FED. AID PROJECT		
*(123,123)RS-3,(124)RS-5,(123)BR-3				

**LEGEND**

- X - TREE REMOVAL
- ▨ - PAVEMENT REMOVAL & CLASS D PATCH
- - - - SPECIAL DITCH
- - - - STANDARD DITCH
- ▨ - RIPRAP
- ◇ - TEMP. DITCH CHECK

EXIST. CURVE EXCL-3  
 PI STA. = 922+60.91  
 $\Delta = 3^\circ 27' 46''$  (LT)  
 $D = 0^\circ 22' 13''$   
 $R = 15,477.36'$   
 $T = 467.83'$   
 $L = 935.37'$   
 $E = 7.07'$   
 $e = N.C.$   
 P.C. STA. = 917+93.08  
 P.T. STA. = 927+28.45

SEC. 3, T27N, R7E, 3RD P.M.  
 BLUESTEM NATIONAL BANK, TRUSTEE, ET AL



PLAN

REVIEWED	DATE
PLOTTED	
NOTED	
NO. _____	

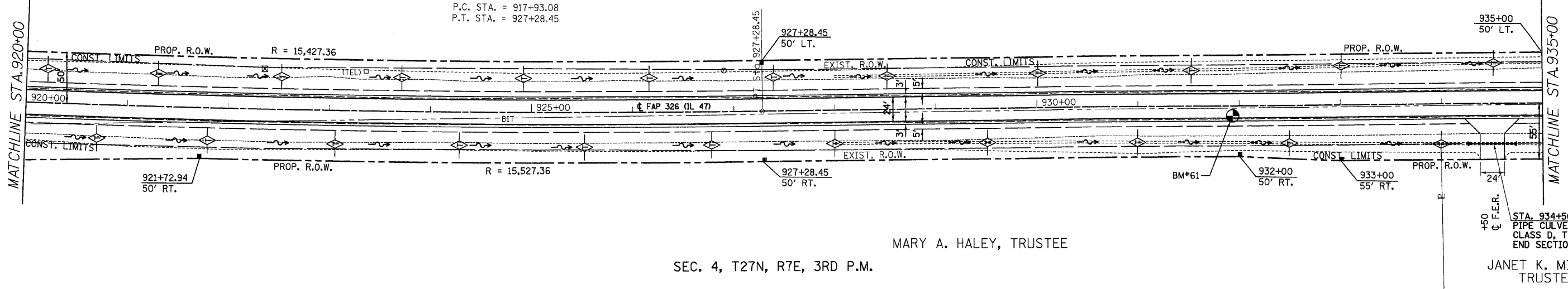

MARY A. HALEY, TRUSTEE  
 SEC. 4, T27N, R7E, 3RD P.M.

JANET K. MILLER, TRUSTEE

BM#61 CHISLED SQUARE IN PAVEMENT  
 NEAR PAVEMENT STAMP 932  
 12' RT. STA. 931+83.6 ELEV. 655.75

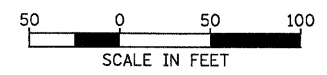

PROFILE

REVIEWED	DATE
PLOTTED	
NOTED	
NO. _____	

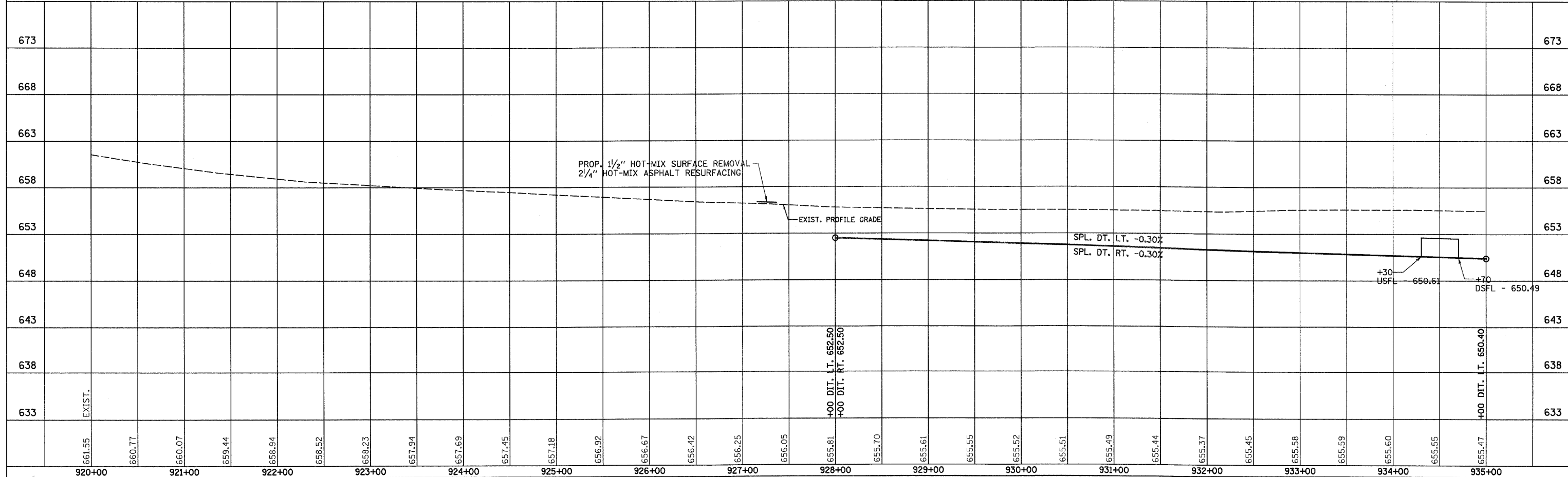

IL 47 STA. 920+00 TO STA. 935+00