

F.A.P. RTE.	SECTION	COUNTY	TOTAL SHEETS	SHEET NO.
326		LIVINGSTON	354	51
STA. 1010+00 TO STA. 1025+00				
FED. ROAD DIST. NO. ILLINOIS FED. AID PROJECT				
#(123,123)RS-3,(124)RS-5,(123)BR-3				

FIRST STATE BANK OF FORREST, TRUSTEE
 SEC. 15
 T27N, R7E, 3RD P.M.

MARY V. HANLEY, ET AL., TRUSTEES
 SEC. 16
 T27N, R7E, 3RD P.M.

STA. 1023+57, 33' RT.
 PIPE CULVERT,
 CLASS A, TYPE 1 - 18"
 PRC FLARED E.S. - 18"

LEGEND

- X - TREE REMOVAL
- ▨ - PAVEMENT REMOVAL & CLASS D PATCH
- - - SPECIAL DITCH
- ~ ~ ~ STANDARD DITCH
- ▧ - RIPRAP
- ◇ - TEMP. DITCH CHECK

SEE FAP 326 (IL RTE. 47) & 1300 N INTERSECTION DETAIL SHEET AND SIDEROAD DETAIL SHEET FOR ADDITIONAL INFORMATION

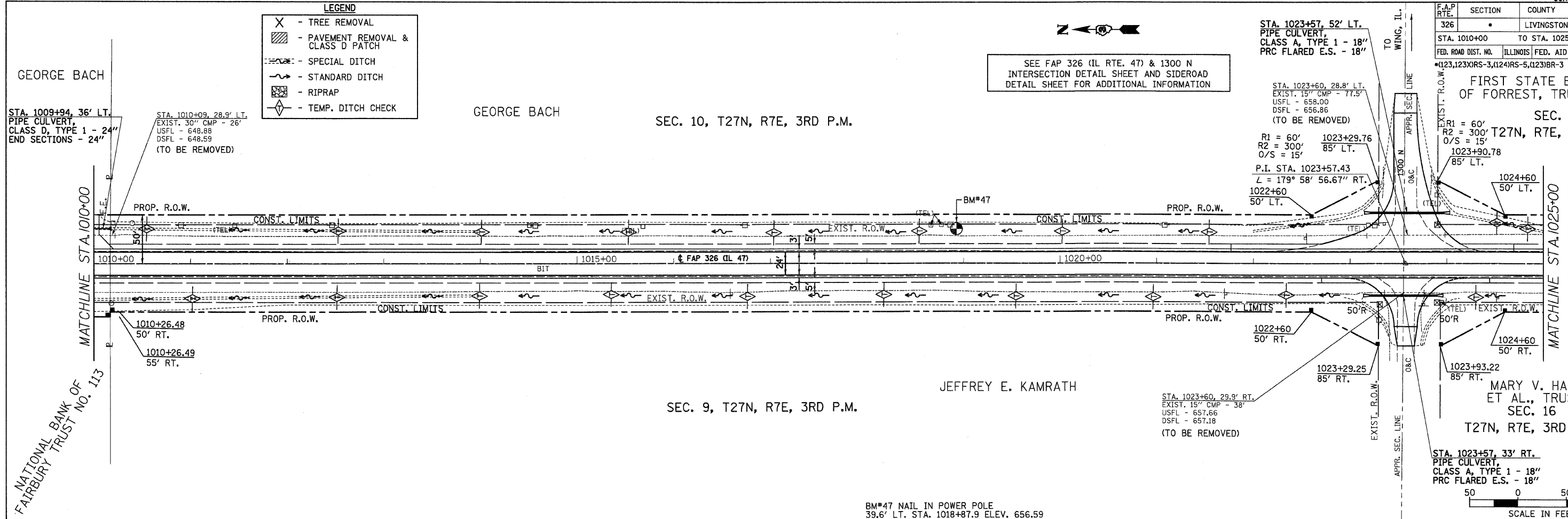

PLAN

DATE	
BY	
REVISION	
NO. _____	
DATE _____	

DATE _____

BY _____

REVISION _____

NO. _____

DATE _____

PROFILE

DATE	
BY	
REVISION	
NO. _____	
DATE _____	

DATE _____

BY _____

REVISION _____

NO. _____

DATE _____

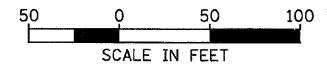
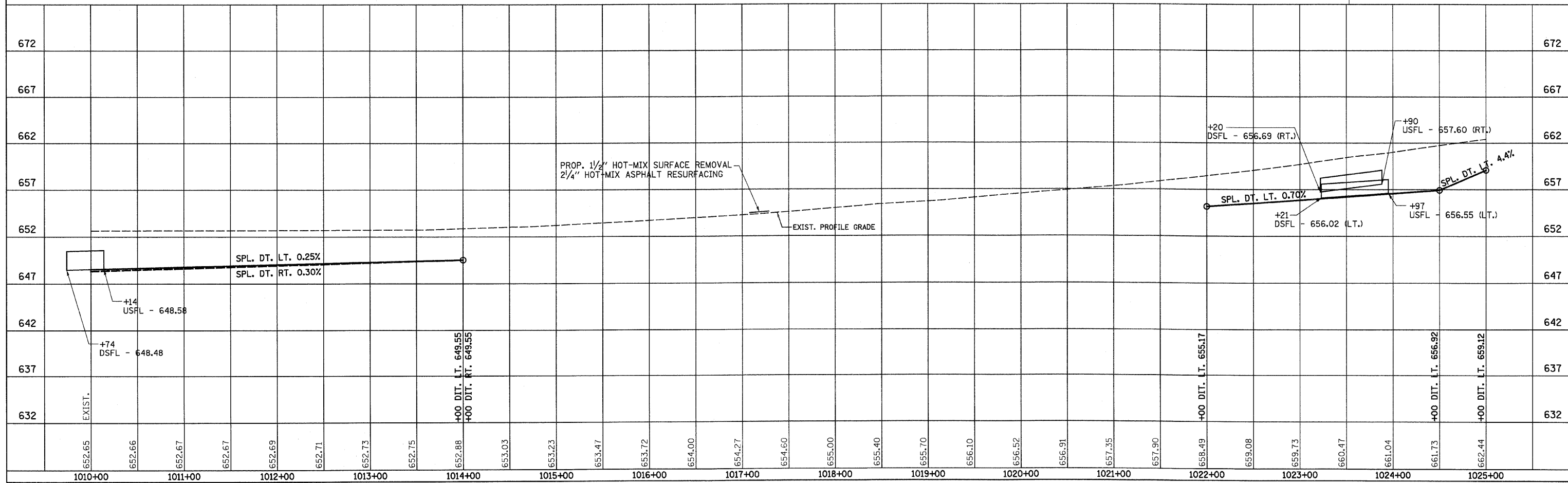

BM#47 NAIL IN POWER POLE
 39.6' LT. STA. 1018+87.9 ELEV. 656.59