

F.A.P. RTE.	SECTION	COUNTY	TOTAL SHEETS	SHEET NO.
326	•	LIVINGSTON	354	52
STA. 1025+00		TO STA. 1040+00		
FED. ROAD DIST. NO.		ILLINOIS	FED. AID PROJECT	
•(123,123)RS-3,(124)RS-5,(123)BR-3				

**LEGEND**

- X - TREE REMOVAL
- [Hatched Box] - PAVEMENT REMOVAL & CLASS D PATCH
- [Dashed Line] - SPECIAL DITCH
- [Wavy Line] - STANDARD DITCH
- [Cross-hatched Box] - RIPRAP
- [Diamond] - TEMP. DITCH CHECK

PLAN

DATE: \_\_\_\_\_ BY: \_\_\_\_\_

REVISIONS:

NO.	DATE	DESCRIPTION

PROFILE

DATE: \_\_\_\_\_ BY: \_\_\_\_\_

REVISIONS:

NO.	DATE	DESCRIPTION

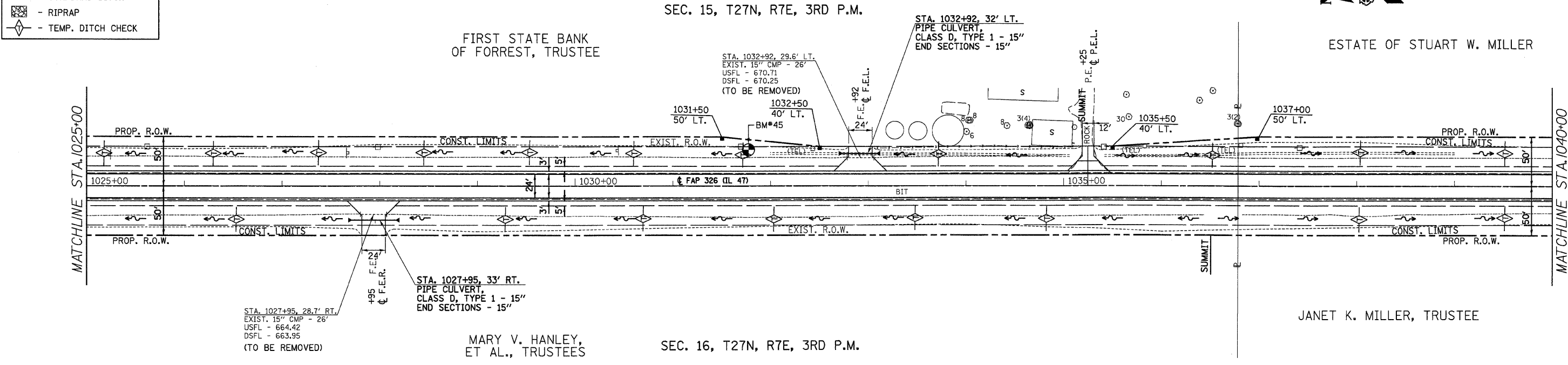

BM#45 NAIL IN POWER POLE  
39.3' LT. STA. 1031+71 ELEV. 671.74

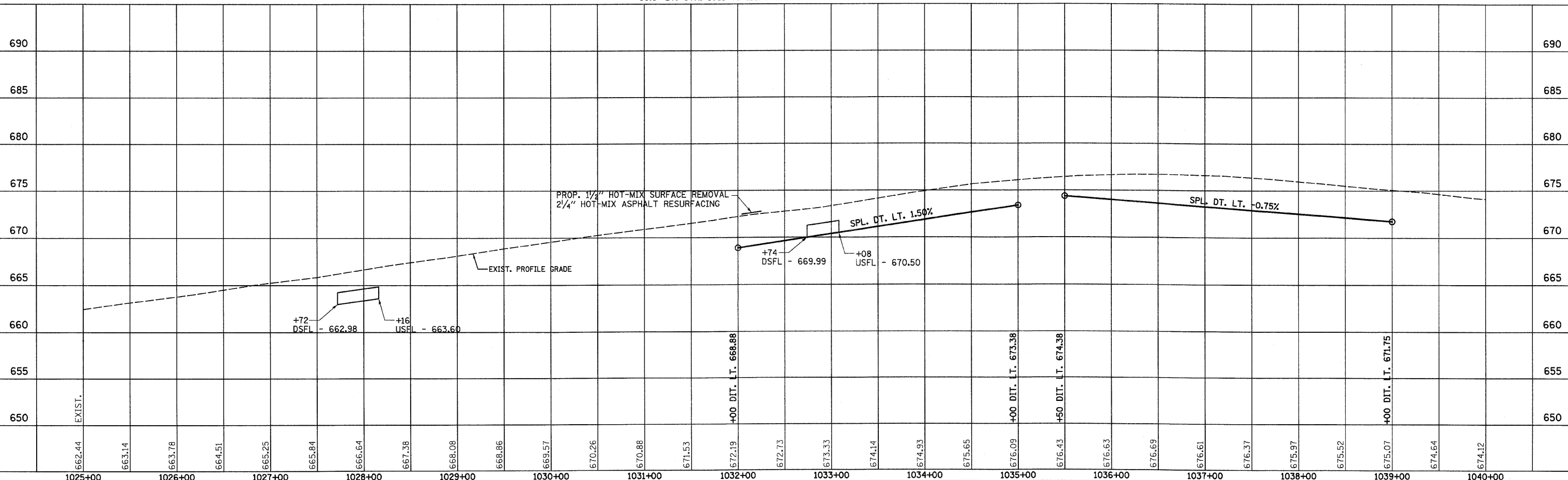
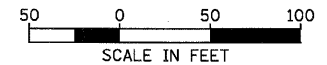

IL 47 STA. 1025+00 TO STA. 1040+00