

F.A.P. RTE.	SECTION	COUNTY	TOTAL SHEETS	SHEET NO.
326		LIVINGSTON	354	56
STA. 1085+00		TO STA. 1100+00		
FED. ROAD DIST. NO.		ILLINOIS FED. AID PROJECT		
•(123,123XRS-3,(124)RS-5,(123)BR-3				

LEGEND

- X - TREE REMOVAL
- ▨ - PAVEMENT REMOVAL & CLASS D PATCH
- - SPECIAL DITCH
- ~ - STANDARD DITCH
- ▨ - RIPRAP
- ◇ - TEMP. DITCH CHECK

JANET K. MILLER, TRUSTEE

SEC. 21, T27N, R7E, 3RD P.M.

JANET K. MILLER

JANET K. MILLER, TRUSTEE

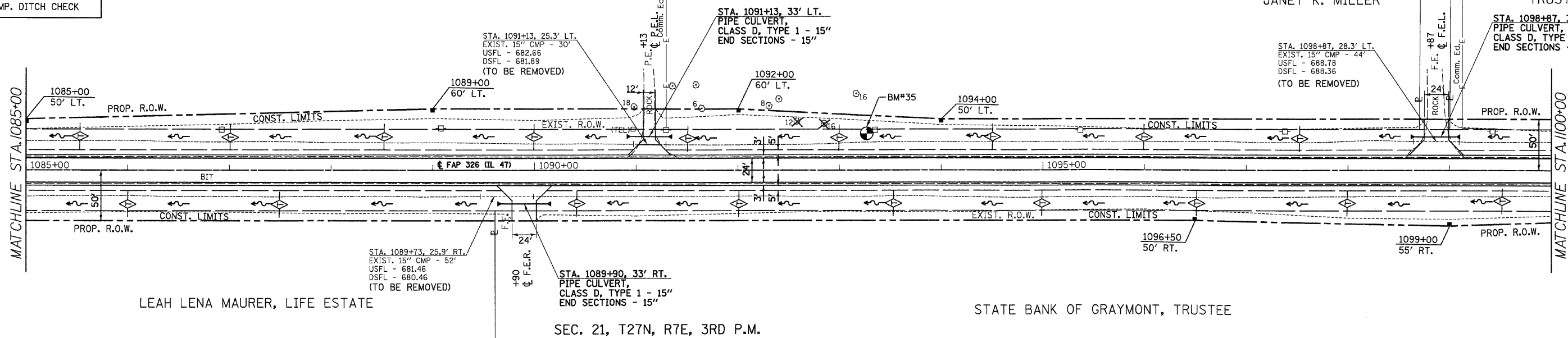

BM*35 NAIL IN POWER POLE
38.7' LT. STA. 1093+36.5 ELEV. 687.91

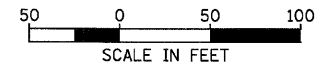

PLAN

DATE	
BY	
REVIEWED	
PLOTTED	
NOTED	
NO. _____	

PROFILE

DATE	
BY	
REVIEWED	
PLOTTED	
NOTED	
NO. _____	

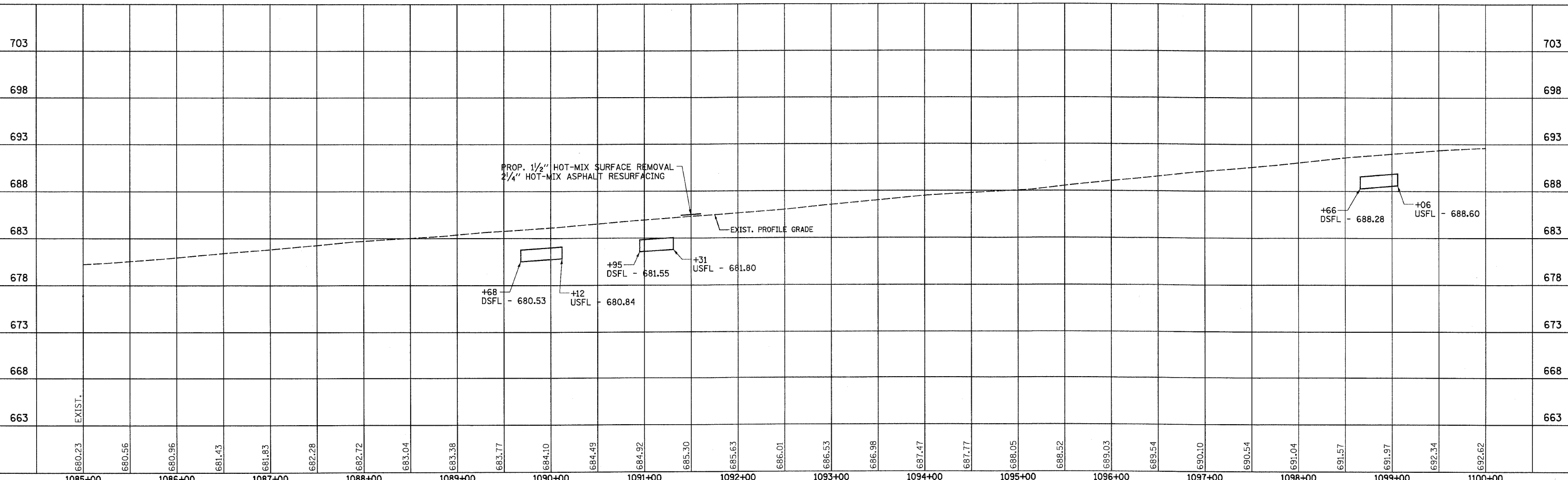

IL 47 STA. 1085+00 TO STA. 1100+00