

F.A.P. RTE.	SECTION	COUNTY	TOTAL SHEETS	SHEET NO.
326		LIVINGSTON	354	64
STA. 1205+00		TO STA. 1220+00		
FED. ROAD DIST. NO.		ILLINOIS FED. AID PROJECT		
		*(123,123)RS-3,(124)RS-5,(123)BR-3		

LEGEND

- X - TREE REMOVAL
- [Hatched Box] - PAVEMENT REMOVAL & CLASS D PATCH
- [Dashed Line] - SPECIAL DITCH
- [Solid Line] - STANDARD DITCH
- [Cross-hatched Box] - RIPRAP
- [Diamond] - TEMP. DITCH CHECK

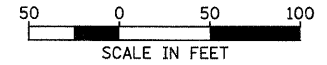
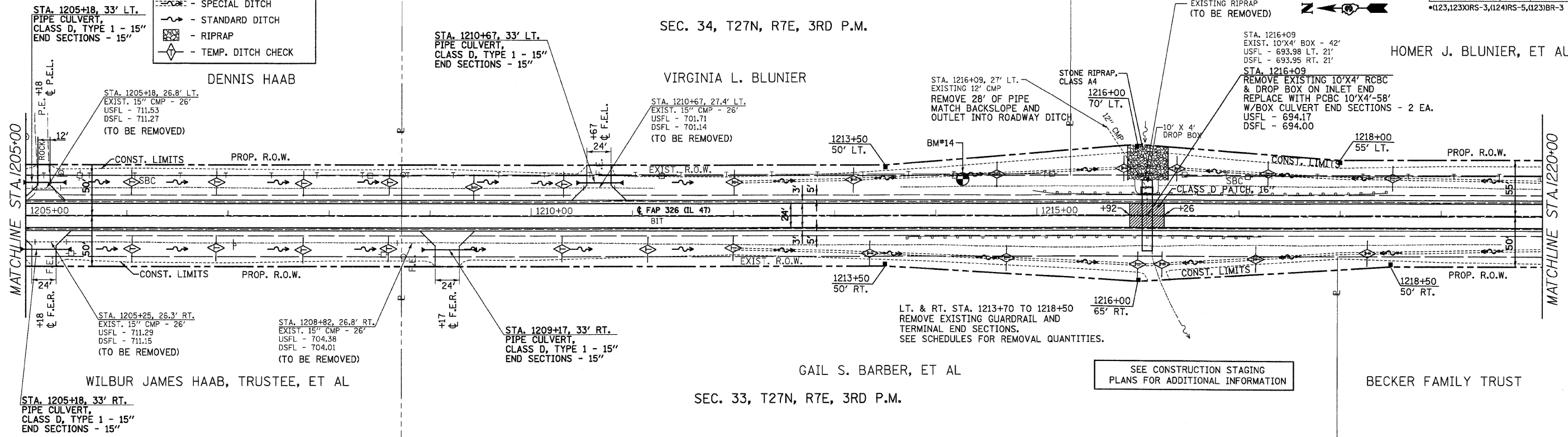

BM*14 NAIL IN POWER POLE
38.6' LT. STA. 1214+21.6 ELEV. 700.43

PLAN

DATE	
BY	
REVIEWED	
NOTED	
NO. _____	

PROFILE

DATE	
BY	
REVIEWED	
NOTED	
NO. _____	

