

F.A.P. RTE.	SECTION	COUNTY	TOTAL SHEETS	SHEET NO.
326		LIVINGSTON	354	65
STA. 1220+00 TO STA. 1234+00				
FED. ROAD DIST. NO.			ILLINOIS FED. AID PROJECT	
*(123,123)RS-3,(124)RS-5,(123)BR-3				

LEGEND

- X - TREE REMOVAL
- [Hatched Box] - PAVEMENT REMOVAL & CLASS D PATCH
- [Dashed Line] - SPECIAL DITCH
- [Wavy Line] - STANDARD DITCH
- [Cross-hatched Box] - RIPRAP
- [Diamond] - TEMP. DITCH CHECK

SEC. 34, T27N, R7E, 3RD P.M.

EXIST. CURVE EXCL-4
 PI STA. = 1228+27.19
 $\Delta = 0^\circ 30' 50''$ (RT)
 $D = 0^\circ 04' 46''$
 $R = 72,108.13'$
 $T = 323.37'$
 $L = 646.73'$
 $E = 0.73'$
 $e = N.C.$
 P.C. STA. = 1225+03.83
 P.T. STA. = 1231+50.56

STA. 1227+71 FAP 326 =
 STA. 10+00 DRAINAGE BASELINE

STA. 1227+71
 EXIST. 3'X2' BOX - 52.5'
 USFL - 692.76 LT. 26'
 DSFL - 692.72 RT. 26.5'

STA. 1227+71
 REMOVE EXISTING 3'X2' RCBC
 REPLACE WITH PCBC 7'X2'-58'
 W/ BOX CULVERT END SECTIONS - 2 EA.
 USFL - 692.77
 DSFL - 692.60

HOMER JOHN BLUNIER

HOMER J. BLUNIER, ET AU

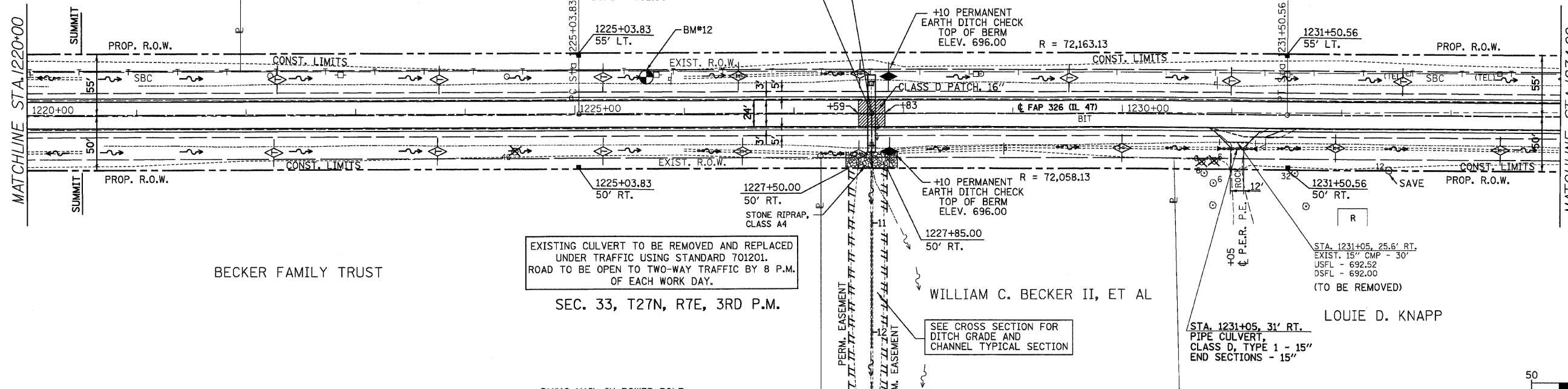

BM#12 NAIL IN POWER POLE
 36.0' LT. STA. 1225+76.7 ELEV. 697.95

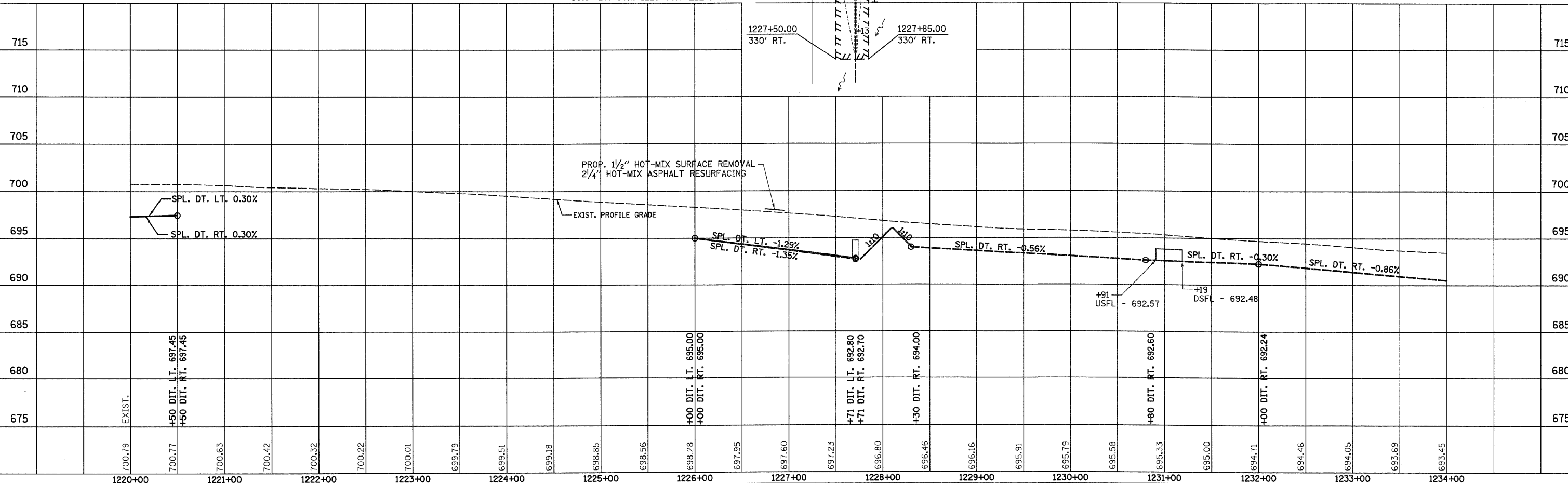
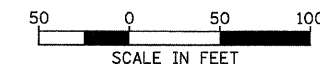

PLAN

DATE	
BY	
SURVEYED	
PLOTTED	
CHECKED	
NO. OF WAY CHECKED	
CADD FILE NAME	

PROFILE

DATE	
BY	
SURVEYED	
PLOTTED	
CHECKED	
NO. OF WAY CHECKED	
STRUCTURE NOTATIONS CHECKED	