

F.A.P. RTE.	SECTION	COUNTY	TOTAL SHEETS	SHEET NO.
326		LIVINGSTON	354	72
STA. 1252+00		TO STA. 1258+00		
FED. ROAD DIST. NO.		ILLINOIS FED. AID PROJECT		
		•(123,123)RS-3,(124)RS-5,(123)BR-3		

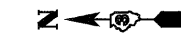

LEGEND

- X - TREE REMOVAL
- [Hatched Box] - PAVEMENT REMOVAL & CLASS D PATCH
- [Dashed Line] - SPECIAL DITCH
- [Wavy Line] - STANDARD DITCH
- [Cross-hatched Box] - RIPRAP
- [Diamond with X] - TEMP. DITCH CHECK

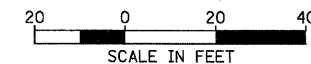
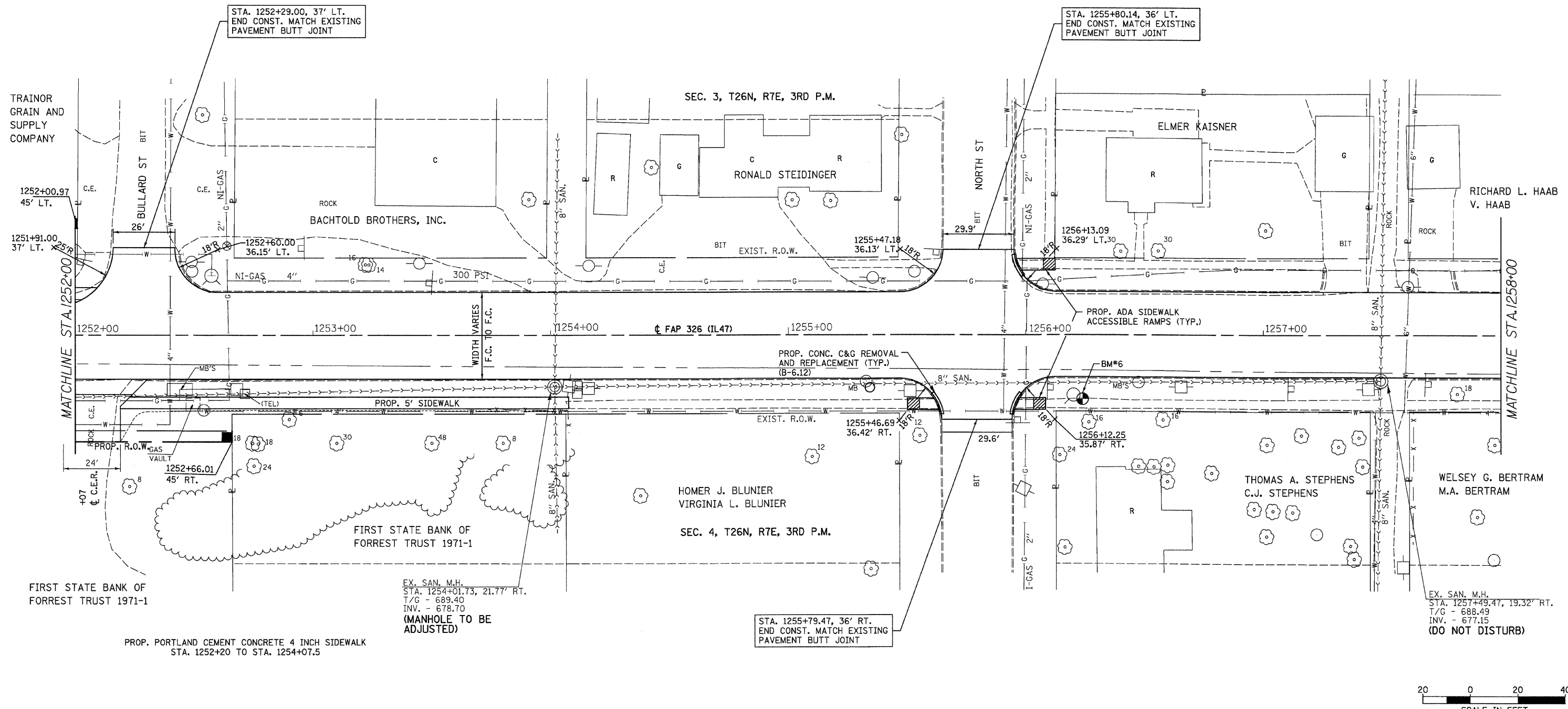

REVISIONS		ILLINOIS DEPARTMENT OF TRANSPORTATION
NAME	DATE	
		IL 47 STA. 1252+00 TO STA. 1258+00

SCALE: VERT. DATE
HORIZ. DRAWN BY CHECKED BY

BM#6 CHISLED "X" ON NORTHEAST BOLT, FIRE HYDRANT 24.2' RT. STA. 1256+23.1 ELEV. 691.44

K:\110127\geopak\PlanSheet20.dgn