

F.A.P. RTE.	SECTION	COUNTY	TOTAL SHEETS	SHEET NO.
326		LIVINGSTON	354	89
STA.		TO STA.		
FED. ROAD DIST. NO.		ILLINOIS FED. AID PROJECT		
•(123,123)RS-3,(124)RS-5,(123)BR-3				

EXIST. CURVE EXCL-5  
 PI STA. = 1241+73.46  
 $\Delta = 1^\circ 07' 50''$  (LT)  
 $R = 43,568.72'$   
 $T = 429.83'$   
 $L = 859.64'$   
 $e = 2.12'$   
 $e = N.C.$   
 P.C. STA. = 1237+43.62  
 P.T. STA. = 1246+03.26

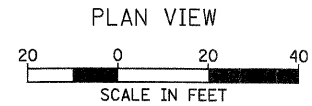
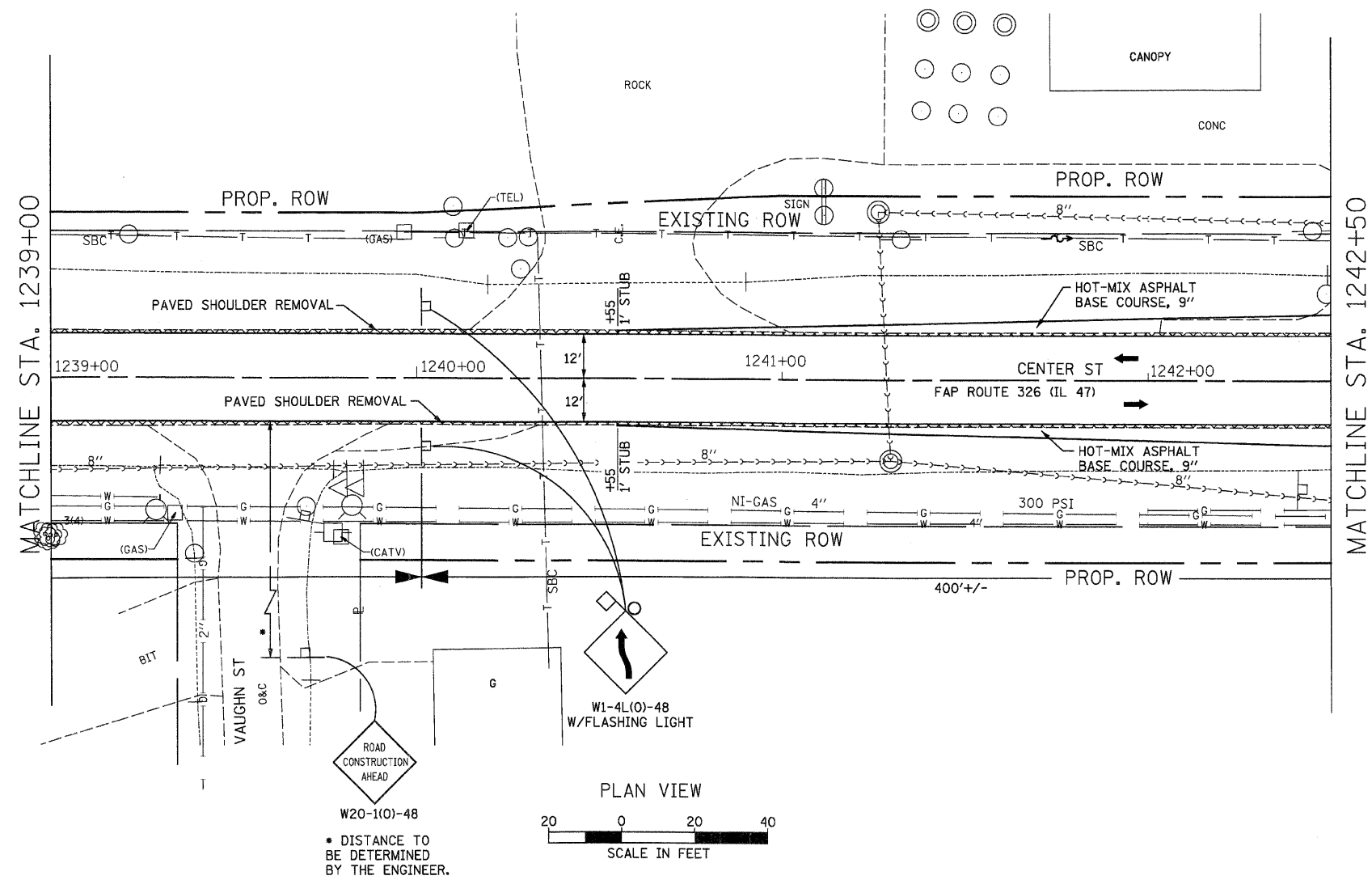
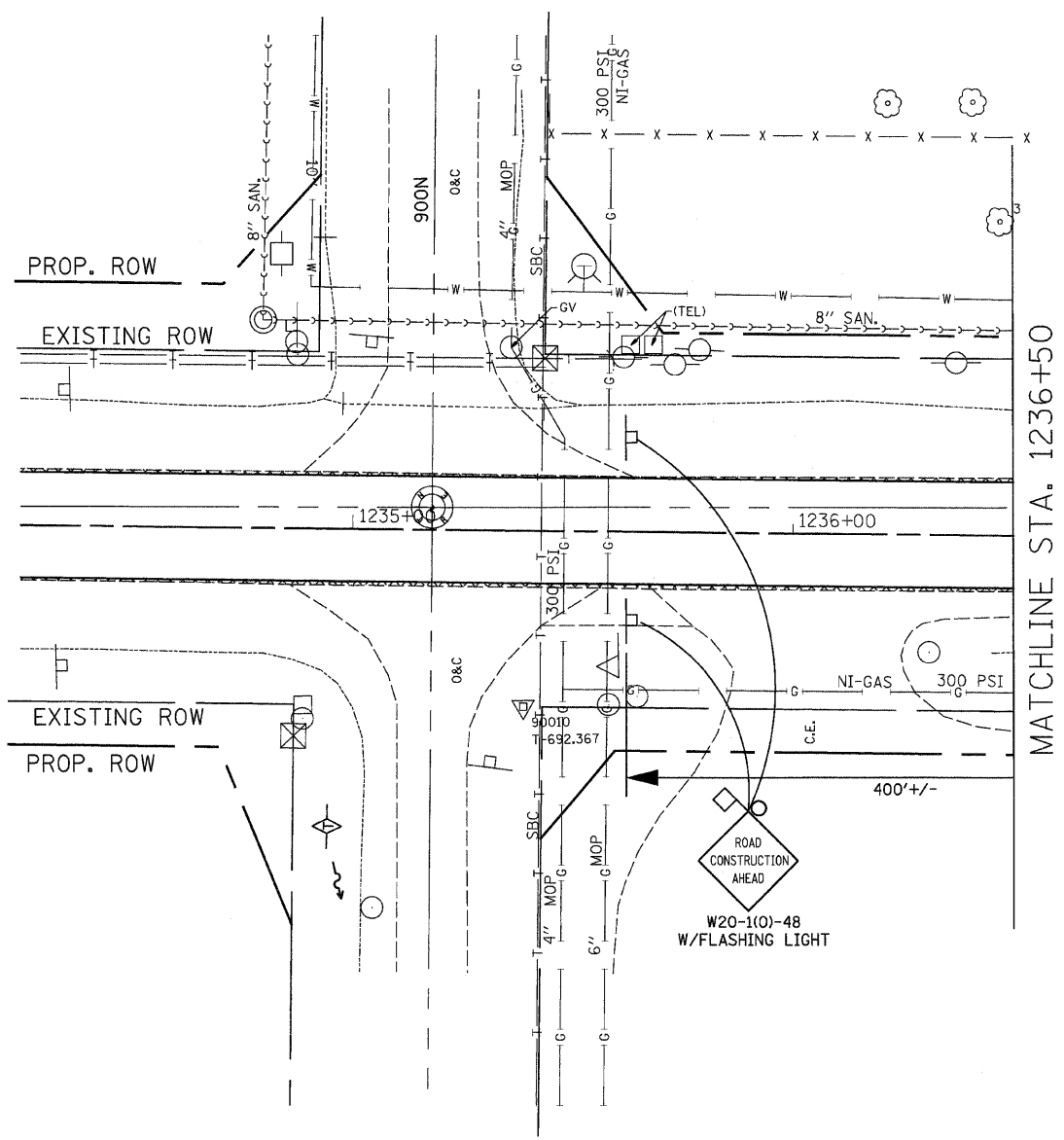

W20-1(O)-48  
 \* DISTANCE TO BE DETERMINED BY THE ENGINEER.

W1-4L(O)-48  
 W/FLASHING LIGHT

REVISIONS	
NAME	DATE

ILLINOIS DEPARTMENT OF TRANSPORTATION  
 TRAFFIC CONTROL AND PROTECTION (SPECIAL)  
 STATION 1245+85  
 STAGE I CONSTRUCTION PLANS  
 SCALE: VERT. \_\_\_\_\_  
 HORIZ. \_\_\_\_\_  
 DATE \_\_\_\_\_ DRAWN BY \_\_\_\_\_  
 CHECKED BY \_\_\_\_\_