

F.A.P. RTE.	SECTION	COUNTY	TOTAL SHEETS	SHEET NO.
326		LIVINGSTON	354	122
STA.		TO STA.		
FED. ROAD DIST. NO.	ILLINOIS FED. AID PROJECT			
* (123,123)RS-3, (124)RS-5, (123)BR-3				

CLASS D PATCHES, 6 INCH OR AGGREGATE BASE CSE., TY. A 8" (SEE SIDEROAD DETAIL)

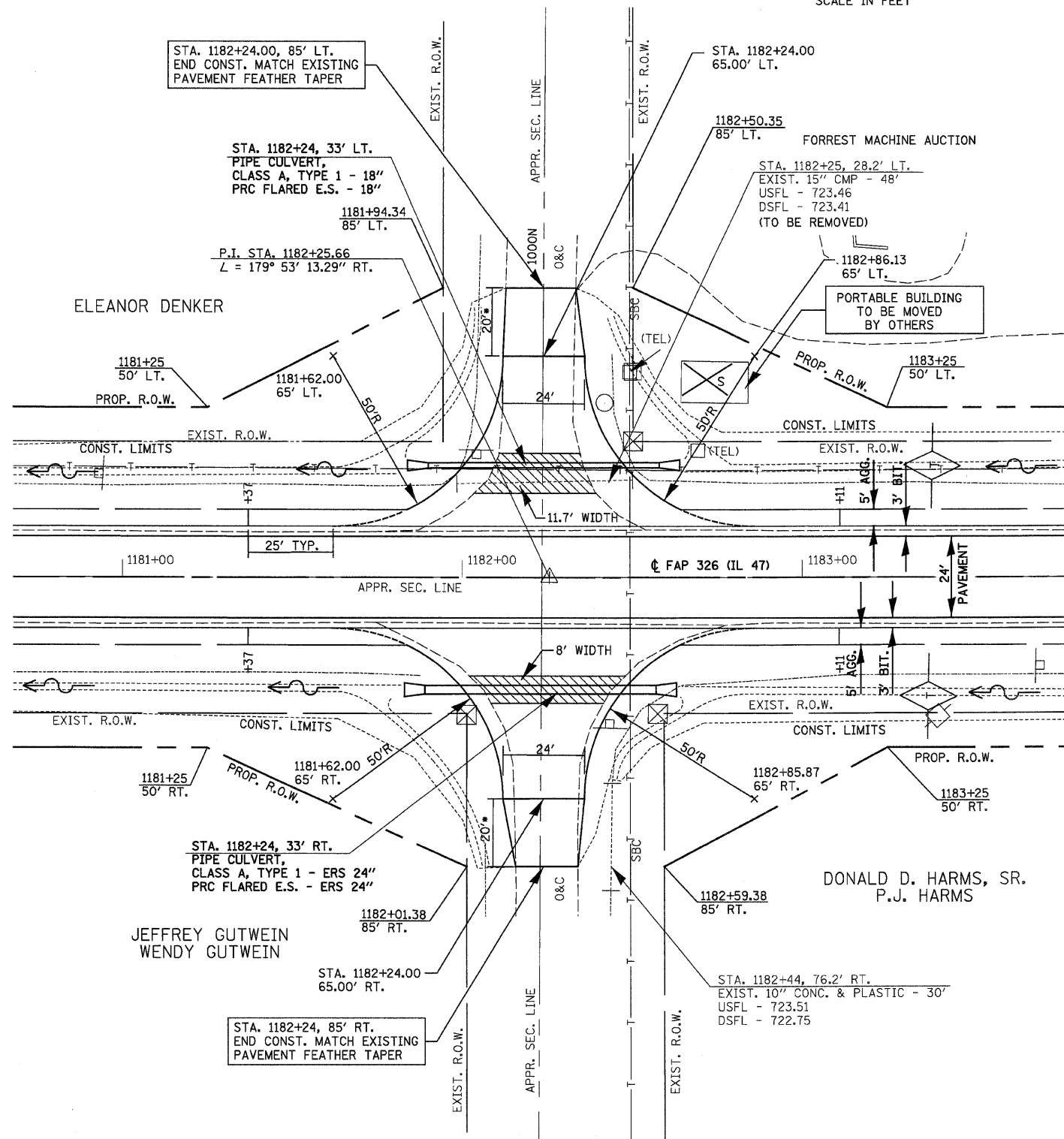
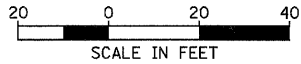

FOR SIDEROADS: (SEE 20' SCALE PLAN AND PROFILE SHEETS FOR DETAILS)

900 N
VAUGHN ST.
STEWART ST.
BULLARD ST.
NORTH ST.
JAMES ST.
MARTIN ST.
WATSON ST.
JONH ST.
KRACK ST.

STA. 1182+24.00
FAP RTE. 326 (IL. RTE. 47) &
1000 N ROAD
INTERSECTION DETAILS

* SEE SIDEROAD DETAILS

REVISIONS	
NAME	DATE

ILLINOIS DEPARTMENT OF TRANSPORTATION

INTERSECTION DETAILS
FAP 326 (IL RTE. 47) & 1000 N

SCALE: VERT. _____
HORIZ. _____
DATE _____ DRAWN BY _____
CHECKED BY _____