

F.A.P. RTE. 326	SECTION •	COUNTY LIVINGSTON	TOTAL SHEETS 354	SHEET NO. 198
STA.		TO STA.		
FED. ROAD DIST. NO.		ILLINOIS FED. AID PROJECT		
•1123,123XIRS-3;1124IRS-5;1123IBR-3				

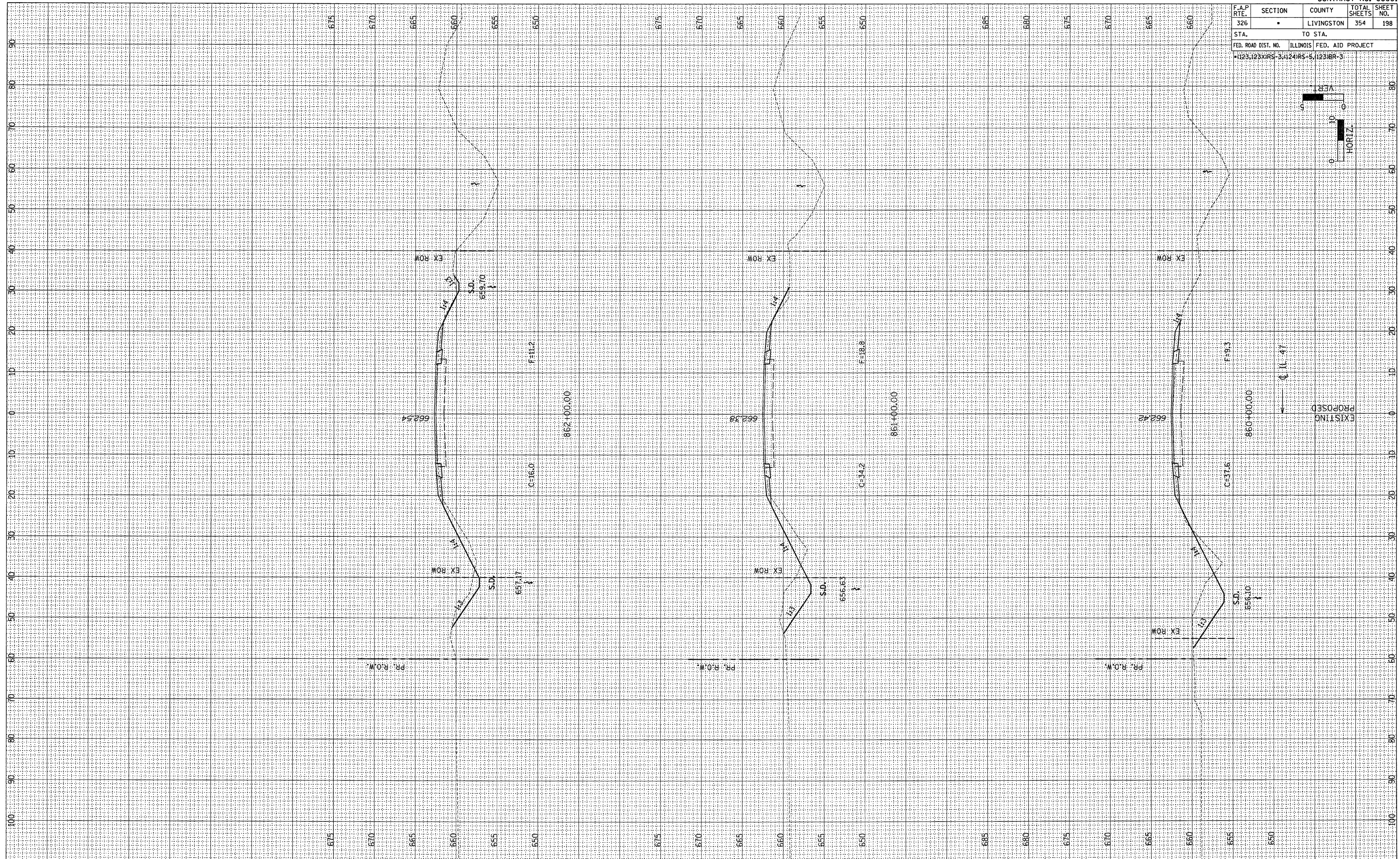
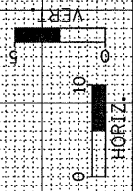

FINAL SURVEY	DATE
REVIEWED	BY
PLOTTED	
TEMPLATE	
AREAS	
CHECKED	
NO.	

ORIGINAL SURVEY	DATE
REVIEWED	BY
PLOTTED	
TEMPLATE	
AREAS	
CHECKED	
NO.	