

F.A.P. RTE. 326	SECTION •	COUNTY LIVINGSTON	TOTAL SHEETS 354	SHEET NO. 212
STA.		TO STA.		
FED. ROAD DIST. NO.		ILLINOIS		FED. AID PROJECT
•11231123XJRS-3;41241RS-5;11231BR-3				

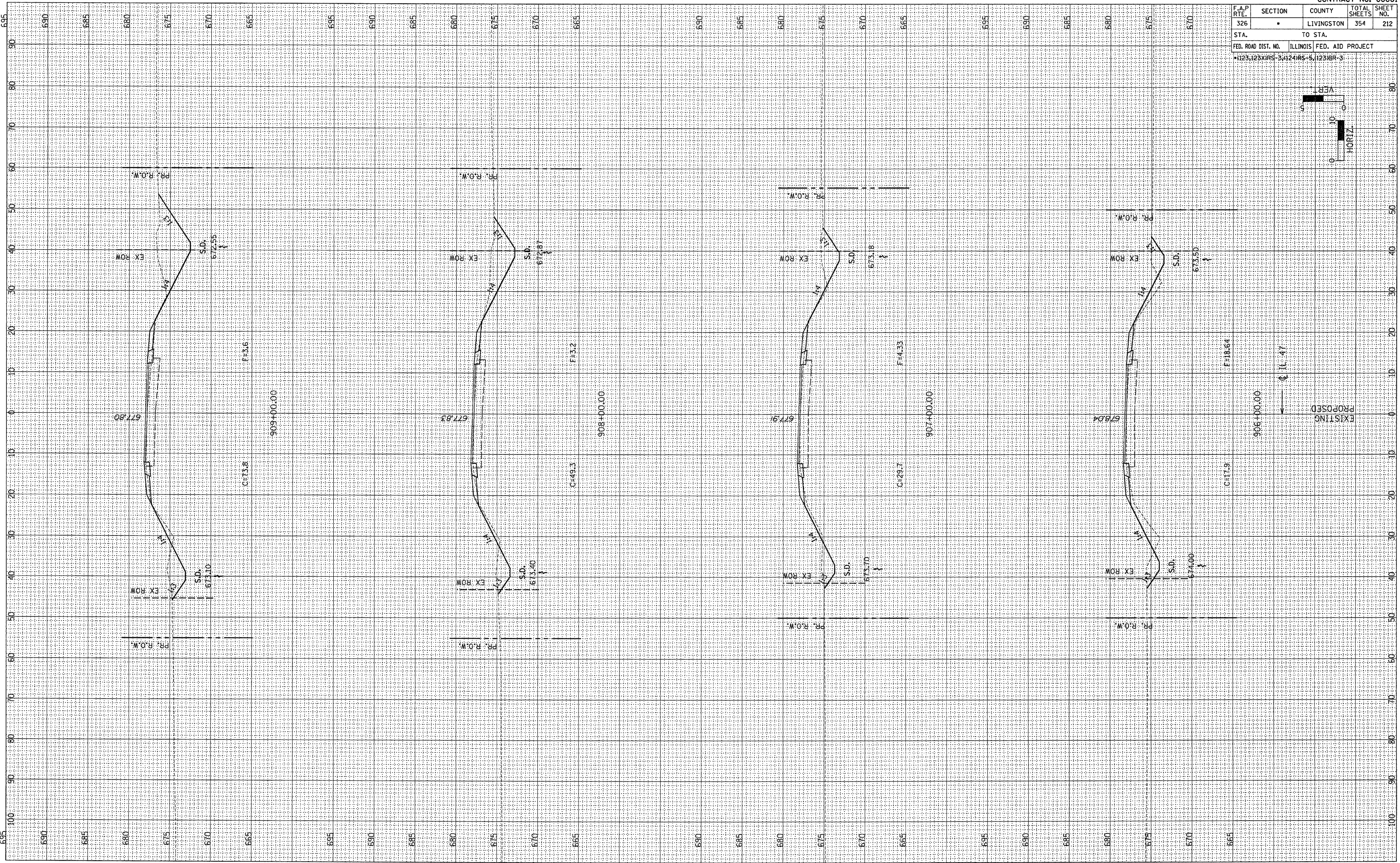
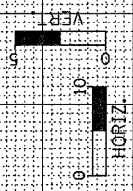

FINAL SURVEY	BY	DATE
REVIEWED		
PLOTTED		
TEMPLATE		
AREAS		
CHECKED		

ORIGINAL SURVEY	BY	DATE
REVIEWED		
PLOTTED		
TEMPLATE		
AREAS		
CHECKED		